

<b>A.P.N. No.:</b>	003-021-16
<b>R.P.T.T.</b>	\$ 748.80
<b>File No.:</b>	2285446 CM
<b>Recording Requested By:</b>	
Stewart Title Company	
<b>Mail Tax Statements To:</b>	<i>Same as below</i>
<b>When Recorded Mail To:</b>	
Grover C. Dils Medical Center	
P.O. Box 1010	
Caliente, NV 89008	

LINCOLN COUNTY, NV **2024-166880**  
 \$785.80  
 RPTT:\$748.80 Rec:\$37.00 **05/14/2024 04:16 PM**  
 STEWART TITLE LAS VEGAS WARM SPRINGS NV 89015-5 KC  
 OFFICIAL RECORD  
 AMY ELMER, RECORDER

## GRANT, BARGAIN, SALE DEED

THIS INDENTURE WITNESSETH: That **Richard D. Harding, Successor Trustee of the Charlie Richard Lee and Lavette Marie Lee Family Trust dated June 13, 1998 and Christopher Harding, an unmarried man and Chesnee Clingman, a married woman who acquired title as Chesnee Harding**

for valuable consideration, the receipt of which is hereby acknowledged, does hereby Grant, Bargain, Sell and Convey to

**Grover C. Dils Medical Center,**

all that real property situated in the County of Lincoln, State of Nevada, bounded and described as follows:

See Exhibit "A" attached hereto and made a part hereof.

\*SUBJECT TO:

1. Taxes for the fiscal year;
2. Reservations, restrictions, conditions, rights, rights of way and easements, if any of record on said premises.
- 3.

Together with all and singular the tenements, hereditaments and appurtenances thereunto belonging or in anywise appertaining, and any reversions, remainders, rents, issues or profits thereof.

Dated:           May 5, 2024          

SIGNATURES AND NOTARY ON PAGE 2  
 THIS GRANT BARGAIN SALE DEED MAY BE SIGNED IN COUNTERPART.

Charlie Richard Lee and Lavette Marie Lee Family  
Trust dated June 13, 1998

By: [Signature]  
Richard D. Harding, Successor Trustee

\_\_\_\_\_  
Christopher Harding

\_\_\_\_\_  
Chesnee Harding

State of Nevada )  
County of Eureka ) ss

This instrument was acknowledged before me on the 5<sup>th</sup> day of May, 2024  
By: Richard D. Harding, Successor Trustee of the Charlie Richard Lee, Lavette Marie Lee Family Trust  
dated June 13, 1998 ~~Christopher Harding, and Chesnee Harding.~~

Signature: [Signature]  
Notary Public

My Commission Expires: 8/31/2027

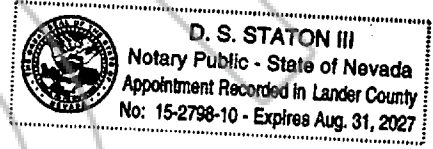

(One inch Margin on all sides of Document for Recorder's Use Only)

Charlie Richard Lee and Lavette Marie Lee Family  
Trust dated June 13, 1998

By: \_\_\_\_\_  
Richard D. Harding, Succesor Trustee

Christopher Harding  
Christopher Harding

\_\_\_\_\_  
Chesnee Harding

State of Oklahoma )  
County of Oklahoma ) ss

This instrument was acknowledged before me on the 10 day of May, 2024  
By: ~~Richard D. Harding, Succesor Trustee of the Charlie Richard Lee, Lavette Marie Lee Family Trust dated June 13, 1998, Christopher Harding, and Chesnee Harding~~

Signature: Stephanie Fernandez  
Notary Public

My Commission Expires: 09/15/27

STEPHANIE FERNANDEZ  
Notary Public, State of Oklahoma  
Commission # 23012561  
My Commission Expires 09-15-2027

Charlie Richard Lee and Lnette Marie Lee Family  
Trust dated June 13, 1998

By: \_\_\_\_\_  
Richard D. Harding, Succesor Trustee

\_\_\_\_\_  
Christopher Harding  
*Chesnee Clingman*  
Chesnee Clingman

State of Nevada )  
County of Clark ) ss

This instrument was acknowledged before me on the 6 day of May, 2024  
By: ~~Richard D. Harding, Succesor Trustee of the Charlie Richard Lee, Lnette Marie Lee Family Trust~~  
~~dated June 13, 1998, Christopher Harding, and Chesnee Clingman~~

Signature: *C Martin*  
Notary Public

My Commission Expires: 6/9/27

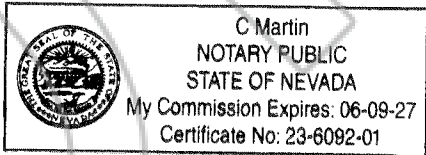

## **EXHIBIT "A" LEGAL DESCRIPTION**

Situate in the City of Caliente, Nevada, within a portion of Section 5, Township 4 South, Range 67 East, M.D.M., described as follows:

Parcel A-1 of that certain Amended Plat for L. David Love and Jean R. Love, recorded March 21, 1997, in Book B of Plats, Page 26, as File No. 108388, in the Office of the County Recorder of Lincoln County, Nevada.

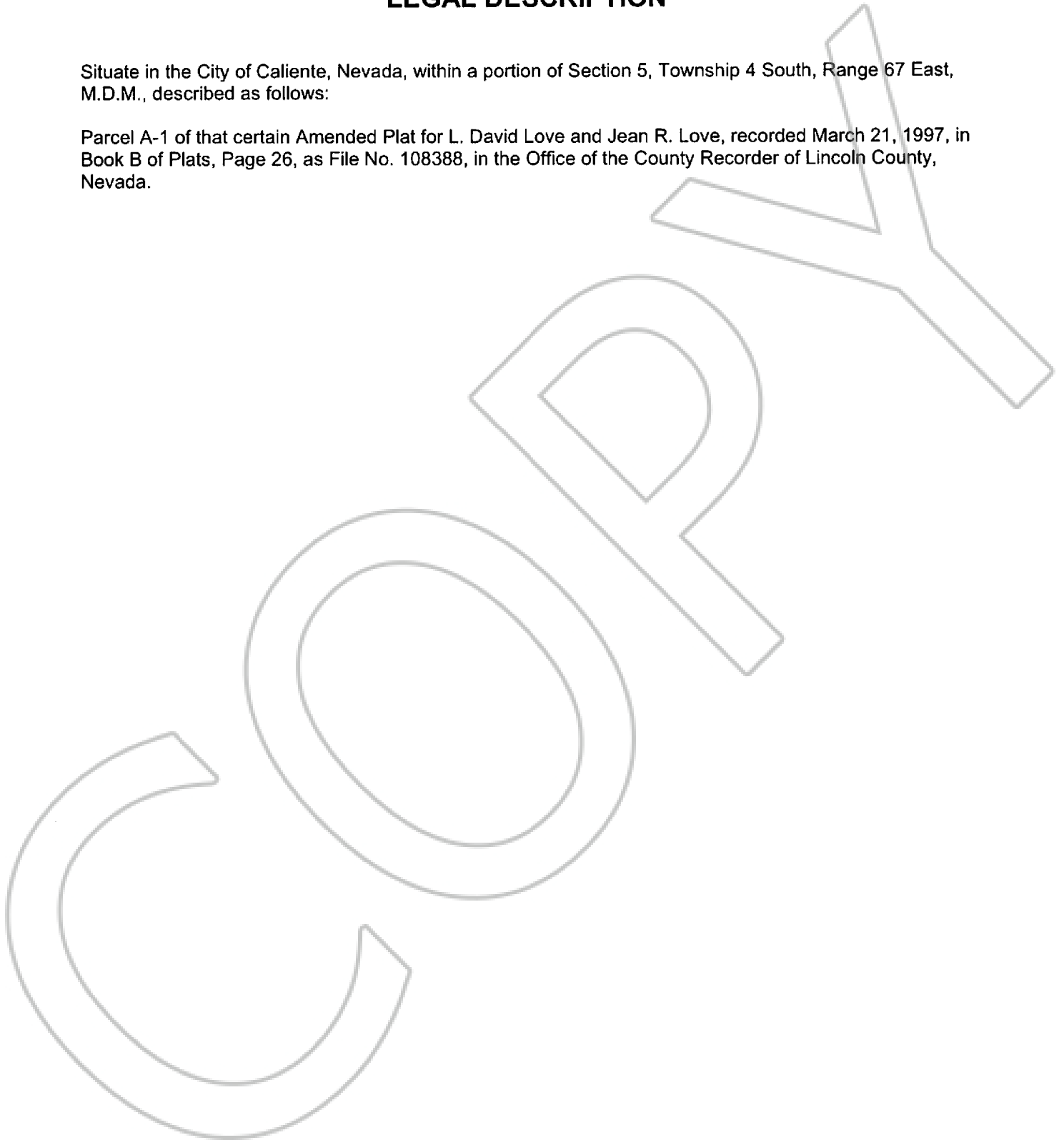

**(One inch Margin on all sides of Document for Recorder's Use Only)**

**STATE OF NEVADA  
DECLARATION OF VALUE FORM**

1. Assessor Parcel Number(s)  
 a) 003-021-16  
 b) \_\_\_\_\_  
 c) \_\_\_\_\_  
 d) \_\_\_\_\_

2. Type of Property:  
 a.  Vacant Land                      b.  Single Fam. Res.  
 c.  Condo/Twnhse                    d.  2-4 Plex  
 e.  Apt. Bldg.                          f.  Comm'l/Ind'l  
 g.  Agricultural                        h.  Mobile Home  
 Other \_\_\_\_\_

<b>FOR RECORDERS OPTIONAL USE ONLY</b>	
Book _____	Page: _____
Date of Recording: _____	
Notes: _____	

3. a. Total Value/Sales Price of Property                      \$ 192,000.00  
 b. Deed in Lieu of Foreclosure Only (value of property)    ( \_\_\_\_\_ )  
 c. Transfer Tax Value:    \$ 192,000.00  
 d. Real Property Transfer Tax Due                                \$ 748.80

4. **If Exemption Claimed:**  
 a. Transfer Tax Exemption per NRS 375.090, Section \_\_\_\_\_  
 b. Explain Reason for Exemption: \_\_\_\_\_

5. Partial Interest: Percentage being transferred: 100 \_\_\_\_\_ %  
 The undersigned declares and acknowledges, under penalty of perjury, pursuant to NRS 375.060 and NRS 375.110, that the information provided is correct to the best of their information and belief, and can be supported by documentation if called upon to substantiate the information provided herein. Furthermore, the parties agree that disallowance of any claimed exemption, or other determination of additional tax due, may result in a penalty of 10% of the tax due plus interest at 1% per month. Pursuant to NRS 375.030, the Buyer and Seller shall be jointly and severally liable for any additional amount owed.

Signature Chesnee Clingman                      Capacity                      Grantor  
 Signature \_\_\_\_\_                                      Capacity                      Grantee

**SELLER (GRANTOR) INFORMATION**  
**(REQUIRED)**  
 Print Name: Richard D. Harding, Successor Trustee of the Charlie Richard Lee, Lavette Marie Lee Family Trust dated June 13, 1998, Christopher Harding, and Chesnee Clingman  
 Address: 4043 Eureka Ave  
 City: Crescent Valley  
 State: NV                      Zip: 89821

**BUYER (GRANTEE) INFORMATION**  
**(REQUIRED)**  
 Print Name: Grover C. Dils Medical Center  
 Address: P.O. Box 1010  
 City: Caliente  
 State: NV                      Zip: 89008

**COMPANY/PERSON REQUESTING RECORDING (required if not seller or buyer)**  
 Print Name: Stewart Title Company                      Escrow # 2285446 CM  
 Address: 7251 W Lake Mead Blvd, Suite 350  
 City: Las Vegas    State: NV                      Zip: 89128