

The following Document contains no Personal Information as defined by NRS 603A.040.

CERTIFICATE OF LOCATION

Lode Mining Claim



OFFICIAL RECORD
AMY ELMER, RECORDER

NOTICE IS HEREBY GIVEN: The undersigned located the Snow Gypsy Lode Mining Claim in accordance with laws and regulations of the United States and the State of Nevada.

DATE OF LOCATION: November 8, 2023.

LOCATION OF CLAIM:

PL 359 SRHA
NOITL Serial #: _____

1/4	Section	Township	Range	Meridian	County	Mining District
NE	26	12S	68E	MDB&M	Lincoln	Gourd Springs
NW	26	12S	68E	MDB&M	Lincoln	Gourd Springs

METES AND BOUNDS DESCRIPTION: Discovery monument is located approximately 1610 feet North of South and 2040 feet East of West from the NE corner of Section 26 Township 12S Range 68E, MDB&M, at which point Notice of Location was duly posted. Point of beginning along center line bears N 42°16'47" E a distance of 175 feet from the discovery monument and running;
thence S 47°43'13" E a distance of 300 feet to the NE corner of monument #1;
thence S 42°16'47" W a distance of 1500 feet to the SE corner of monument #2;
thence N 47°43'13" W a distance of 600 feet to the SW corner of monument #3;
thence N 42°16'47" E a distance of 1500 feet to the NW corner of monument #4;
thence S 47°43'13" E a distance of 300 feet to the point of beginning. Excluding any patented claims.

Each corner has claim name and applicable corner engraved on aluminum tags nailed to 2"x4' wood post. The undersigned certifies that work of location included making a claim map as provided in NRS 514.040.

CLAIMANT NAME AND MAILING ADDRESS:

Hinkinite Resources LLC
3438 W 5200 S
Lake Shore, UT 84660

SIGNATURE: [Signature]
Bryson Hinkins
Authorized Agent for Hinkinite Resources LLC

DATE: 11/10/2023

NOTARY:

State of Utah, County of Utah
Subscribed and sworn before me on the 10 day of November, 2023, by Bryson Hinkins.

[Signature]
Notary Signature

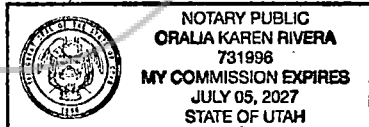

MAP SKETCH:

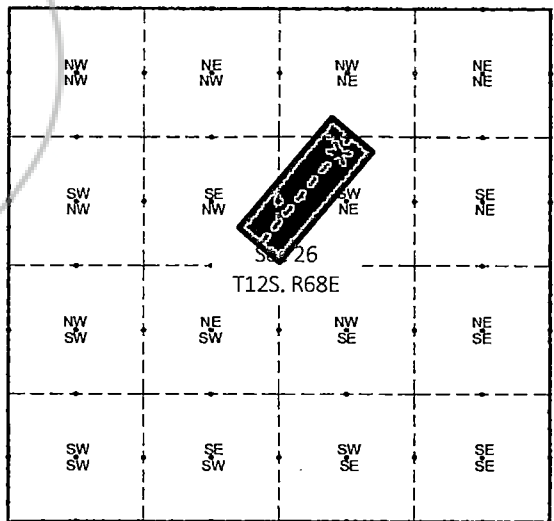

X Monument Location
Claim Boundary Area
N
0' 660' 1320'