

The following Document contains no Personal Information as defined by NRS 603A.040.

CERTIFICATE OF LOCATION

Mill Site



OFFICIAL RECORD
AMY ELMER, RECORDER

NOTICE IS HEREBY GIVEN: The undersigned located the Tung Mill 2 Mill Site in accordance with laws and regulations of the United States and the State of Nevada.

DATE OF LOCATION: October 18, 2023.

| 1/4 | Section | Township | Range | Meridian | County | Mining District |
|-----|---------|----------|-------|----------|---------|-----------------|
| SE | 25 | 3S | 56E | MDB&M | Lincoln | Tem Piute |
| | | | | | | |
| | | | | | | |
| | | | | | | |

Said locator is the proprietor or owner of the Dome, Sheelite, et al patented mining claims generally located in Lincoln County, Nevada.

Discovery monument is located approximately 850 feet North or South and 450 feet East of West from the SE corner of Section 25 Township 3S Range 56E, MDB&M, at which point Notice of Location was posted.

The Mill Site is approximately 660 feet in the E to W direction and 330 feet in the N to S direction. Said Mill Site contains 5 acres or less. Excluding any patented claims. As erected on the ground, each corner has mill site name and applicable corner engraved on aluminum tags nailed to 2"x4' wood post. The undersigned certifies that work of location included making a claim map as provided in NRS 514.040.

CLAIMANT NAME AND MAILING ADDRESS:

Hinkinite Resources LLC
3438 W 5200 S
Lake Shore, UT 84660

SIGNATURE: [Signature]
Bryson Hinkins
Authorized Agent for Hinkinite Resources LLC

DATE: 11/10/2023

NOTARY:
State of Utah, County of Utah
Subscribed and sworn before me on the 10th day of November, 2023, by Bryson Hinkins.
[Signature]
Notary Signature

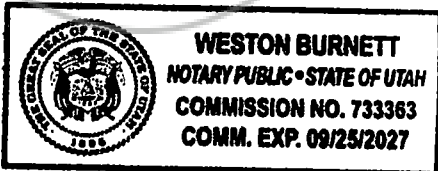

MAP SKETCH:

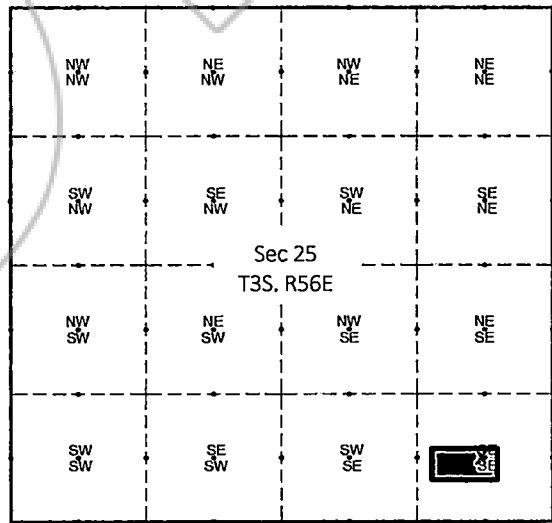

X Monument Location
[Shaded Box] Mill Site Boundary Area
N
0' 660' 1320'