

Recording Requested By:  
M.L.WICKS BEN S.P.R.R.

Return To:  
MAG HOLDINGS TRIST  
% M.L.Wicks and it's Assigns  
37951 47Th  
Palmdale, California 93552

LINCOLN COUNTY, NV

2023-166010

Rec:\$37.00

Total:\$37.00

10/05/2023 03:01 PM

M. L. WICKS

Pgs=70 KC



OFFICIAL RECORD  
AMY ELMER, RECORDER

---

**DOCUMENT TITLE**

---

---

**ASSIGNMENT**

---

COPY

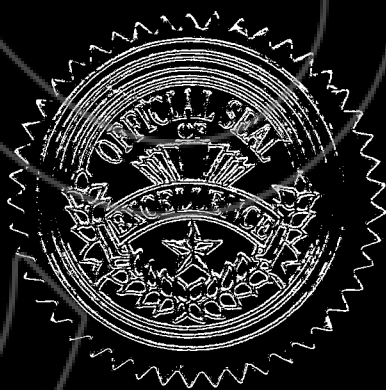

RECORDING REQUESTED BY  
M.L.Wicks BEN S.P.R.R.  
AND WHEN RECORDED MAIL TO

Name. Assignor Mumina A.Rahman  
% MAG HOLDING TRUST  
Address 37951 47TH  
Palmdale ,California 93552

**ASSIGNMENT**

**OPERATION M.L.Wicks  
WICKS SYSTEM22**

The undersigned assignor hereby assigns to **UNDERWRITING TITLE SERVICES** of California, assignee, as additional security, all rents leases and profits pertaining to that certain **ASSETS CLAIMS -OPERATION M.L.WICKS, WICKS SYSTEM 22**, filed in Lincoln County Nevada in book 2020-1590332 Page \_\_\_\_\_

**Document Number**

**2020-159032**

**Recording Date**

10/02/2020 03:36:46 PM

**Document Type**

**ASSIGNMENT**

of Real Estate recorder's official records and more particularly described as follows:  
The real estate hereby described as follows to wit : *Document NO 2020-159032 PAGE 13*  
Situating in the county of Anaheim , California  
**ANAHEIM WATER COMPANY DITCH** CERTIFICATE NO 312 BOOK 68d PAGE 109 OF  
MISCELLANEOUS RECORDS

Dated December 31,2020  
See Assignment M.O.U and Exhibits

①

# State of California

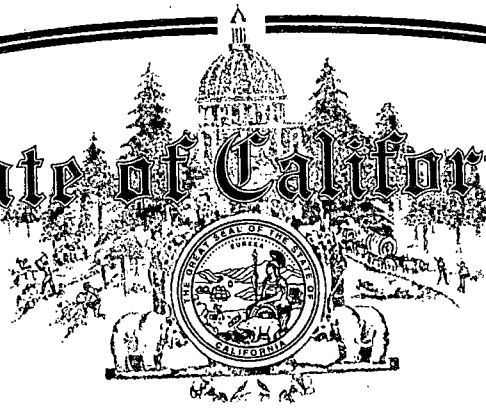

## SECRETARY OF STATE

I, ALEX PADILLA, Secretary of State of the State of California, hereby certify:

That, Dean C. Logan whose name appears on the annexed certificate, was on November 20, 2013, the duly qualified and acting Registrar-Recorder/County Clerk of the County of Los Angeles, in said State.

That the seal affixed thereto is the seal of said County; that the signature thereon appears to be the signature of Dean C. Logan and that the annexed certificate is in due form and by proper officer.

In Witness Whereof, I execute  
this certificate and affix the  
Great Seal of the State of  
California this 6th  
day of October 2016.



*Alex Padilla*

Secretary of State

BY \_\_\_\_\_

(2)

This indenture, made the first day of March in the year of our Lord one thousand eight hundred and seventy nine, between William Mc Kee, Mrs M. J. Wade Shorb and M. L. Wickes all of the Los Angeles County, State of California, parties of the first part, and The Anaheim Water Company a corporation, the party of the second part, Witnesseth, That the said parties of the first part, for and in consideration of the sum of one thousand dollar coin of the United States of America, to them in hand paid by the said party of the second part, the receipt whereof is here by acknowledged, do by these presents grant, bargain, sell, and convey unto the said party of the second part and to its successors and assigns forever, a right of way for an irrigation ditch through the 5<sup>th</sup> class land of the parties of the first part, said right extending over a strip ten feet wide and nineteen hundred and two feet (1902) long through the land of M. L. Wickes and of the same width and thirteen hundred & thirty one (1331) feet long through the combined tracts of Mrs Shorb & Wm Mc Kee - being located according to the present survey for a connecting ditch between the Cajon Irrigation Co. Canal and the Anaheim Water Co's ditch - Said right is granted on these conditions - Parties of the first part are to have water from said connecting ditch for stock & domestic purposes free of cost. The party of the second part is when called upon to construct at its own expense two bridges over said ditch in the lands of Mrs Shorb & Wm Mc Kee and to construct if necessary three bridges over said ditch in the lands of M. L. Wickes or his grantees, and also at its own expense to construct wherever needed means of conveying water above or below, across said ditch so constructed - That the right of way hereby by Mrs Shorb given is out of her separate property.

Together with all and singular the tenements hereditaments and appurtenances thereto belonging or in anywise appertaining, and the reversion and reversions, remainders and remainders, rents, issues and profits thereof. To have and to hold all and

in gular the said premises together with the appurtenances, unto the said party of the second part, and to its successors and assigns forever.

In Witness Whereof, the said parties of the first part have hereunto set their hands and seals the day and year first above written.

Signed, Sealed and Delivered }  
in the presence of. — }  
Mr. L. Wickes Seal  
Wm Mc Kee Seal  
Maria Jesus de Shorb Seal

State of California, County of Los Angeles, sp.

On this Fourth day of March A. D. one thousand eight hundred and seventy nine, before me Albert M. Stephenson, County Judge in and for the County of Los Angeles, personally appeared Mrs M. J. W. de Shorb wife of J. De B. Shorb known to me to be the person whose name is subscribed to the annexed instrument, described as a married woman, and upon examination, without the hearing of her said husband, I made her acquainted with the contents of said instrument and thereupon she acknowledged to me that she executed the same, and that she does not wish to retract such execution.

In Witness Whereof, I have hereunto set my hand and affixed my private seal at my office in the County of Los Angeles, the day and year in this certificate first above written.

Albert M. Stephenson Seal

County Judge of Los Angeles County, California.

State of California }  
County of Los Angeles } sp. On this 1<sup>st</sup> day of March A. D. one thousand eight hundred and seventy nine, before me, J. J. Warner, a Notary Public in and for the County of Los Angeles, personally appeared Mr. L. Wickes and William Mc Kee known to me to be the same persons whose names are subscribed to the annexed instrument, and they severally acknowledged to me that they each executed the same.

In Witness Whereof, I have hereunto set my hand and affixed my official seal at my office in the County of Los Angeles the day  
Seal

13

and year in this certificate first above written.

J. J. Warner Notary Public

A full, true and correct copy of the original, recorded at request of A. Rimpaw April 10<sup>th</sup> 1879 at 31 min past 10 A. M.

Chas. E. Miles Rec. Recorder

By Geo. E. Gard Deputy

This Indenture made this Eighth day of April A.D. 1879  
 Between J. L. Reynolds, Constable of Los Nietos Township, Los  
 Angeles County, State of California, of the first part, and  
 M. C. Frankel and Samuel Frankel, copartners under the  
 firm name of Frankel Brothers, of the second part: Whereas  
 by virtue of a writ of execution issued out of the Justices  
 Court of said Los Nietos Township, tested the 26<sup>th</sup> day of  
 August A. D. 1878, upon a judgment recovered in said Court  
 on the said 26<sup>th</sup> of August A. D. 1878 in favor of said Frankel  
 Brothers and against Ch. Korlowitz, to the said Constable  
 directed and delivered, commanding him that out of the per-  
 sonal property of the said judgment debtor in his bailwick  
 he should cause to be made certain moneys in the said  
 writ specified; and if sufficient personal property of the  
 said judgment debtor could not be found, that then he  
 should cause the amount of said judgment to be made  
 out of the real property belonging to him; and Whereas,  
 because sufficient personal property of the said judgment  
 debtor could not be found, whereas the said Constable  
 could cause to be made the moneys specified in said  
 writ, the said Constable did in obedience to said command  
 levy on take and seize all the estate, right, title and interest  
 which the said judgment debtor so had, of in and to the lands  
 tenements, real estate and premises hereinafter particularly  
 set forth and described with the appurtenances, and did, on  
 the 24<sup>th</sup> day of September A. D. 1878, sell the said premises at

Te

and year in this certificate first above written.

J. J. Warner Notary Public  
 A full, true and correct copy of the original, recorded at request  
 of A. Rimpaw April 10<sup>th</sup> 1879 at 3:11 min past 10 A. M.  
 Chas. E. Miles Not. Recorder  
 By Geo. E. Gard Refg.

This Indenture made this eighth day of April A. D. 1879  
 Between J. S. Reynolds, Constable of Los Nietos Township, Los  
 Angeles County, State of California, of the first part and  
 M. C. Frankel and Samuel Frankel, copartners under the  
 firm name of Frankel Brothers, of the second part: Whereas  
 by virtue of a writ of execution issued out of the Justices  
 Court of said Los Nietos Township, dated the 26<sup>th</sup> day of  
 August A. D. 1878, upon a judgment recovered in said Court  
 on the said 26<sup>th</sup> of August A. D. 1878 in favor of said Frankel  
 Brothers and against Chas. Emilowitz, to the said Constable  
 directed and delivered, commanding him that out of the per-  
 sonal property of the said judgment debtor in his business  
 he should cause to be made certain moneys in the said  
 writ specified; and if sufficient personal property of the  
 said judgment debtor could not be found, that then he  
 should cause the amount of said judgment to be made  
 out of the real property belonging to him; and Whereas  
 because sufficient personal property of the said judgment  
 debtor could not be found, whereas the said Constable  
 could cause to be made the moneys specified in said  
 writ, he the said Constable, did in obedience to said comman-  
 ley or take and seize all the estate, right, title and interest  
 which the said judgment debtor so had, of in and to the same  
 tenements, real estate and premises hereinafter particularly  
 set forth and described with the appurtenances, and did, on  
 the 24<sup>th</sup> day of September A. D. 1878, sell the said premises at



in quibus the said premises together with the appurtenances, unto  
 the said party of the second part, and to its successors and assigns forever  
 In Witness Whereof the said parties of the first part have here-  
 unto set their hands and seals the day and year first above written

Signed, Sealed and Delivered }  
 in the presence of. — }

Mr. L. Wicks Seal

Wm. M. Rice Seal

Maria Jesus de Shorb Seal

State of California, County of Los Angeles Co.

On this Fourth day of March A. D. one thousand eight  
 hundred and seventy nine, before me Albert M. Stephenson, County  
 Judge in and for the County of Los Angeles personally appear-  
 ed Mrs M. J. W. de Shorb wife of J. de B. Shorb known to me  
 to be the person whose name is subscribed to the annexed  
 instrument, described as a married woman, and upon ex-  
 amination, without the hearing of her said husband, I  
 made her acquainted with the contents of said instrument,  
 and thereupon she acknowledged to me that she executed the  
 same, and that she does not wish to retract such execution.

In Witness Whereof, I have hereunto set my hand and  
 affixed my private seal at my office in the County of Los Angeles,  
 the day and year in this certificate first above written.

Albert M. Stephenson Seal

County Judge of Los Angeles County, California.

State of California

County of Los Angeles Co. On this 14<sup>th</sup> day of March A. D.  
 one thousand eight hundred and seventy nine, before me J. J.  
 Warner, a Notary Public in and for the County of Los Angeles,  
 personally appeared Mr. L. Wicks and William M. Rice known  
 to me to be the same persons whose names are subscribed to  
 the annexed instrument, and they severally acknowledged to me  
 that they each executed the same.

Dear

In Witness Whereof, I have hereunto set my  
 hand and affixed my official seal at my  
 office in the County of Los Angeles the day

This indenture, made the first day of March in the year of our Lord one thousand eight hundred and seventy nine, between William Mc Kee, Mrs M. J. de Shorb and M. L. Wicks, all of the Los Angeles County, State of California, parties of the first part, and The Anaheim Water Company a corporation, the party of the second part, Witnesseth, That the said parties of the first part, for and in consideration of the sum of one Dollar and no part of the United States of America, to have in hand paid by the said party of the second part, the receipt whereof is hereby acknowledged, do by these presents grant, bargain, sell, and convey unto the said party of the second part and to its successors and assigns forever, a right of way for an irrigation ditch through the 5<sup>th</sup> class land of the parties of the first part, said right extending over a strip ten feet wide and nineteen hundred and two feet (1902) long through the land of M. L. Wicks and of the same width and thirteen hundred and thirty one (1331) feet long through the combined tracts of Mrs Shorb & Mrs Mc Kee - being located according to the present survey for a connecting ditch between the Cajon Irrigation Co Canal and the Anaheim Water Co's ditch - Said right is granted on these conditions - Parties of the first part are to have water from said connecting ditch for stock & domestic purposes free of cost - The party of the second part is when called upon to construct at its own expense two bridges over said ditch in the lands of Mrs Shorb & Mrs Mc Kee and to construct if necessary three bridges over said ditch in the lands of M. L. Wicks or his grantees, and also at its own expense to construct wherever needed means of conveying water above or below, across said ditch so constructed - That the right of way hereby by Mrs Shorb given is across her separate property.

Together with all and singular the tenements hereditaments and appurtenances therunto belonging or in anywise appertaining, and the reversion and reversions, remainders and remainders, rents, issues and profits thereof. To have and to hold all and

# 340

340 340

(9)

Certificate

Anaheim

Water

Company

Dated September

5<sup>th</sup> 1868.

338

*Articles of Incorporation  
of the Cactus Water  
Company.*

Charter forfeited Dec. 13, 1905, for  
failure to pay license tax for the year  
ending June 30, 1905.

*Filed Dec 16 1899*

*Reuben B. Cook*

*Secretary*

*H. P. Cooke*

*Clark*

(10)

## Anaheim Water Co. v. Semi-Tropic Water Co.

64 Cal. 185 (Cal. 1883) · 30 P. 623

Decided Sep 27, 1883

APPEAL from a judgment of the Superior Court of Los Angeles County, and from an order refusing a new trial.

### COUNSEL:

Bicknell & White, and Glassell, Smith & Patton, for Appellant, on the question of estoppel by deed, cited *Zimmler v. San Luis W. Co.*, 57 Cal. 221; *Lajoie v. Primm*, 3 Mo. 529; *McComb v. Gilkey*, 29 Miss. 146; *Dutchess of Kingston's Case*, 2 Smith L.C. 675; *Ware v. Cowles*, 24 Ala. 446; *Tainter, Treasurer, v. Winter*, 53 Me. 348; *Brace v. Yale*, 4 Allen, 393; *Rich v. Atwater*, 16 Conn. 418; *Osborne v. Endicott*, 6 Cal. 194. And on the question of estoppel in pais, cited *Dutchess of Kingston's Case*, 1 Leach, 146; *Cronin v. Gore*, 38 Mich. 385; *Herman*, §§ 324-424; *Parker v. Barker*, 2 Met. 423; *Lawrence v. Brown*, 5 N.Y. 394; *Morris v. Moore & Hancock*, 11 Humph. 433; *Royston Adm'r v. Howie*, 15 Ala. 309; *Leicester v. Rehoboth*, 4 Mass. 180; *Owen v. Bartholomew*, 9 Pick. 520; *Bolling v. Mayor of Petersburg*, 3 Rand. 563; *Holmes v. Crowell*, 73 N.C. 613; *Dorlarque v. Cress*, 71 Ill. 380; *Mayo v. Cartwright*, 30 Ark. 407; *McAfferty v. Conover's Lessee*, 7 Ohio St. 99; *Danforth v. Adams*, 29 Conn. 107; *Brewster v. Striker*, 2 N.Y. 19; *Junction R.R. Co. v. Harpold*, 19 Ind. 347; *Woodward v. Wilcox*, 27 Ind. 207; *Taylor v. Ely*, 25 Conn. 250; *Crest v. Jack*, 3 Watts, 238; *Alexander v. Kerr*, 2 Rawle, 83; 19 Am. Dec. 619; *Ward v. Packard*, 18 Cal. 391. As to title by prescription, counsel cited *Wood on Limitation of Actions*, 379; *Kimball v. Gearhart*, 12 Cal. 29; *N.C. & S.C. Co. v. Kidd*, 37 Cal. 311; *Kelly v. Natoma W. Co.* 6 Cal. 105; *Ortman v. Dixon*, 13

Cal. 33; *American Co. v. Bradford*, 27 Cal. 360; *Palmer v. Wright*, 58 Ind. 489; 37 Conn. 136; *Wilkins v. McCue*, 46 Cal. 657; *Pope v. Kinman*, 54 Cal. 3; *Washburne on Easements*, 131; *McCardle v. Barricklow*, 68 Ind. 358; *Peterson v. McCullough*, 50 Ind. 41; *Wharton's Ev.* § 1350; *Greenleaf on Ev.* 539 a; 3 Me. 120; 21 Me. 220; 41 Me. 291; 46 Me. 288; 17 Me. 123; 23 Pick. 141; 12 N.Y. 118; 2 Allen, 287; *Pentland v. Keep*, 41 Wis. 490; *Farmer v. Ukiah W. Co.* 56 Cal. 13; *Goddard on Easements*, 461-464; *Angell on Water Courses*, §§ 200-237; *High on Injunctions*, § 507; *Creighton v. Evans*, 53 Cal. 55.

Smith & Hupp, for Respondents, cited *American Co. v. Bradford*, 27 Cal. 306; *Crandall v. Woods*, 8 Cal. 136; *Union Water Co. v. Crary*, 25 Cal. 504; *Davis v. Gale*, 32 Cal. 26; also as to estoppel in pais, *Parke v. Kilham*, 8 Cal. 77; *Herman on Estoppel*, § 409; *Liggins v. Inge*, 7 Bing. 682; *Bealey v. Shaw*, 6 East, 208; *Williams v. Morland*, 2 Barn. & C. 910; *Irwin v. Phillips*, 5 Cal. 140; *Conger v. Weaver*, 6 Cal. 557; *Hoffman v. Stone*, 7 Cal. 46; 5 Wend. 464; *Eddy v. Simpson*, 3 Cal. 249; *Kidd v. Laird*, 15 Cal. 161; *McKinney v. Smith*, 21 Cal. 381; *Phoenix W. Co. v. Fletcher*, 23 Cal. 488; *Hill v. Smith*, 27 Cal. 462; *Broder v. Water Co.* 11 Otto, 276; *Atchison v. Peterson*, 20 Wall. 507.

\*185

### OPINION

ROSS, Judge

In Bank

The facts are stated in the opinion of the  
186 court. \*186 In its course through Los Angeles  
County the Santa Ana River forms the dividing  
line between the ranchos Canon de Santa Ana, San  
Juan y Cajon de Santa Ana, and Las Bolsas on the  
one side, and the ranchos Santiago de Santa Ana  
and Lomas de Santiago on the other. Between the  
ranchos Canon de Santa Ana and the San Juan y  
Cajon de Santa Ana and also fronting on the river  
is a small piece of land belonging to the  
government. From a map furnished us by the  
respective parties it appears that the rancho  
Santiago de Santa Ana has a frontage on the river  
almost equal to the combined frontage of the  
ranchos Canon de Santa Ana, San Juan y Cajon de  
187 Santa \*187 Ana, Las Bolsas and the government  
land, and reaches from the sea to a point on the  
river but a little distant from where the river enters  
the boundary of the county.

The plaintiffs assert a right to divert from the  
river sufficient water to keep their ditch, which is  
alleged and found by the court below to be six feet  
wide at the bottom, eight feet wide at the top, and  
two feet deep (grade not given), flowing full at all  
times and seasons of the year; and in this asserted  
right the decree of the court below secures them,  
without regard to the quantity of water that may be  
left in the river when such a quantity is so diverted  
and irrespective of the wants and the necessities of  
the owners of the Santiago de Santa Ana Rancho,  
under and for whom the defendant asserts the right  
to divert a portion of the water of the said river.  
Counsel for the plaintiffs contend that the right  
thus asserted and adjudged them is founded, (1) in  
grant; (2) upon prescription; (3) upon prior  
appropriation, and (4) upon an estoppel in pais.

It will be convenient to consider these  
grounds in their order.

1. Omitting details, the plaintiffs' title by  
grant rests, first, upon a deed executed September  
1, 1857, by Bernardo Yorba, the then owner of the  
rancho Canon de Santa Ana, to Juan Pacificus  
Ontiveras, the then owner of the lower rancho, San

[30 P. 624] Juan y Cajon de Santa Ana; and  
secondly, on two deeds executed September 12,  
1857, by Ontiveras and wife to George Hansen  
and John Frohling -- the two last named persons  
being the predecessors in interest of the plaintiffs.

By the deed of September 1, 1857, Bernardo  
Yorba conveyed to Ontiveras, for the expressed  
consideration of two hundred dollars, a right of  
way in and over a certain strip of the rancho  
Canon de Santa Ana commencing at a point one  
hundred varas below a dam in the river on his said  
rancho "which leads a portion of the water of said  
river into a ditch running through a portion of said  
lands and into and through a portion of the  
aforesaid lands of the said Juan Pacificus  
Ontiveras (to wit, the rancho San Juan y Cajon de  
Santa Ana), and which is now used by him for  
irrigating a portion of said lands and running from  
said point in a westerly direction to the boundary  
line of the rancho Cajon de Santa Ana," said strip  
of land to be sufficiently wide for the construction  
188 of a water ditch of capacity to hold \*188 and  
convey water sufficient to irrigate 1,200 acres of  
land and for the passage of a man on horseback on  
either side of the ditch for the purpose of  
inspecting and keeping it in order. .. "and also the  
right to construct a sufficient dam at the before-  
mentioned point in the said river in order to supply  
the said ditch with water for the uses and purposes  
above mentioned."

By one of the aforesaid deeds of September  
12, 1857, Ontiveras conveyed to Hansen and  
Frohling the same rights and interests conveyed to  
him by the aforesaid deed from Yorba, and by the  
other deed of September 12, 1857, Ontiveras  
conveyed to Hansen and Frohling 1,165 acres of  
the rancho San Juan y Cajon de Santa Ana,  
afterwards and now known as the Anaheim tract,  
"and also the right of way in and over a strip of  
land twelve varas wide running through the said  
rancho San Juan y Cajon de Santa Ana, for the  
purpose of making a ditch of capacity to carry  
water sufficient to irrigate the said piece of land;  
said ditch to be commenced at a point on the

eastern boundary line of the aforesaid rancho (San Juan y Cajon de Santa Ana), which may be most convenient for the purpose, and to run as directly as the nature of the soil and the conformation of the ground will permit, to the said tract of 1,165 acres; and also the privilege of using so much of the water from the Santa Ana River as appertains to the said rancho (San Juan y Cajon de Santa Ana) for the purpose of irrigating the same, by virtue of the grant of said rancho by the former Mexican government, and by the laws and customs of the country at the time of such grant, and by virtue of the existing laws and customs as may be sufficient for the purpose of irrigating the aforesaid tract of 1,165 acres of land, together with the privilege of making such other ditches through the said rancho (San Juan y Cajon de Santa Ana) as may be necessary for irrigating and cultivating said tract of land."

There can be no doubt that by the deed last mentioned Ontiveras conveyed to Hansen and Frohling the privilege of using so much of the water of the Santa Ana River as appertained to the rancho San Juan y Cajon de Santa Ana as should be necessary for the irrigation of the Anaheim tract of 1,165 acres, provided the quantity of water appertaining to that rancho and previously  
189 unconveyed by Ontiveras was sufficient \*189 for that purpose. But of course this grant by Ontiveras could not affect any right of the owners of the rancho Santiago de Santa Ana to the use of the water of the river.

It is said, however, that at the time of the execution of the deed from Yorba to Ontiveras of date September 1, 1857, Yorba was the owner of an undivided interest in the rancho Santiago de Santa Ana, and that by his deed to Ontiveras he conveyed to him the right (subsequently vested in the predecessors of the plaintiffs) to divert sufficient of the water of the river for the irrigation of 1,200 acres of land upon the rancho San Juan y Cajon de Santa Ana. It is not necessary to decide whether the deed of September 1, 1857, from Yorba to Ontiveras conveyed to the latter the right

to divert any of the water of the river that pertained to the rancho Canon de Santa Ana; for while those who have succeeded to the rights of Yorba in that rancho were originally made defendants to this suit, the action was subsequently dismissed as to them, and the contest continued only as to those holding under the Santiago grant.

Whatever else might be held with respect to the deed from Yorba to Ontiveras, we think it perfectly clear that no right to divert any of the water of the river that appertained to the rancho Santiago was conveyed by it. The deed starts with the recital that "whereas the parties of the first part (Yorba and wife) are seized in fee of a certain rancho or tract of land called Canon de Santa Ana, .. lying on and near to the river, said river being one of its boundaries, and the said party of the second part (Ontiveras) being seized in fee of a certain tract of land called San Juan y Cajon de Santa Ana, .. bounding also on said river Santa Ana, and lying near to and below the lands of said Bernardo and Andrea Yorba, now, therefore," etc., in consideration of two hundred dollars, the grantors convey to Ontiveras the right of way over a strip of the rancho Canon de Santa Ana, commencing and running as already described, sufficiently wide for the construction of a water ditch of capacity to hold and convey water sufficient for the irrigation of 1,200 acres of land, and also the right to construct a sufficient dam in the river at the point of commencement of the strip over which the right of way is conveyed in order to supply the said ditch with water for the  
190 irrigation of the 1,200 acres. There is no \*190 express grant in this deed by Yorba -- and we speak of him as the grantor because the court below found that, though his wife joined him in the deed, she had no interest in the property -- of any right on the part of Ontiveras to divert any of the water of the river, and certainly no express grant of the privilege of diverting any of the water of the river that pertained to the grantor, as owner of an undivided interest in the rancho Santiago de

Santa Ana. Impliedly [30 P. 625] it undoubtedly recognized the right in Ontiveras to divert a part of the water, but it must be remembered that by reason of his proprietorship of the rancho San Juan y Cajon de Santa Ana, Ontiveras then possessed the right to divert such portion of the water of the river for the purposes of irrigation as appertained to his rancho. And the fact that he was then diverting a portion of the said water for that purpose is expressly recited in the deed; for by its terms the strip of the Canon Rancho over which Yorba conveys to him the right of way for a ditch is made to commence at a point one hundred varas below a dam in the river, on the Canon Rancho, "which leads a portion of the water of said river into a ditch running through a portion of said lands, and into and through a portion of the aforesaid lands of the said Juan Pacificus Ontiveras, and which is now used by the said Juan Pacificus Ontiveras for irrigating a portion of his said lands." But no reference whatever is made in the deed to the rancho Santiago. Irrigation upon that rancho, as well as upon the ranchos Canon and Cajon, with the water of the river was then carried on, and had been carried on for many years. There was then, according to the findings of the court below, and continued to be until within a year or two prior to the commencement of this action in 1877, sufficient water flowing in the river to supply the wants of all the parties bordering on the stream. Under these circumstances, certainly, the owners of each of these were entitled to divert, for the purposes of irrigation upon their respective tracts, such portion of the water of the river as appertained to their respective ranchos, due regard being had to the rights of each and all the others. Ontiveras, as owner of the San Juan y Cajon de Santa Ana, was entitled to divert, for the purposes of irrigation upon his rancho, such portion of the water as  
191 rightly appertained thereto; and in the \*191 deed by which he conveyed to Hansen and Frohling the Anaheim tract of 1,165 acres, he expressly granted to them the privilege of using so much of the water of the river appertaining to his rancho as

should be sufficient for the irrigation of that tract. But in the deed from Yorba to Ontiveras, executed but a few days before, there is no such language. Yorba thereby conveyed to Ontiveras a right of way over his rancho Canon for the construction of a ditch of capacity to hold and convey water sufficient for the irrigation of 1,200 acres of the rancho San Juan y Cajon de Santa Ana, and also the right to construct a sufficient dam in the river at a designated point upon the Canon Rancho in order to supply the ditch with water for the 1,200 acres. Whether the water thus to be diverted was the water that appertained to Ontiveras, as the owner of the rancho San Juan y Cajon de Santa Ana, or water that appertained to Yorba, as the owner of the rancho Canon de Santa Ana, need not be determined for the reason already assigned, but by no construction of the deed consistent with reason or authority can it be held to be any part of the water appertaining to the owners of the rancho Santiago de Santa Ana, which is situated upon the opposite side of the river, and which is in no manner alluded to in the Yorba deed. And even were this otherwise, it is clear that Yorba's deed could not affect the rights of the other owners of the Santiago Rancho.

2. The title by prescription relied on by the plaintiffs is based on the fact found by the court below to the effect that from the 1st of January, 1858, until within a year or two prior to the commencement of this action, the plaintiffs, their predecessors, etc., quietly, openly, notoriously, and continuously appropriated, used, and enjoyed enough of the water of the river to keep their ditch, which was constructed in and over the strip of land described in the deed from Yorba to Ontiveras, flowing full to its utmost capacity at all times and seasons of the year, claiming the right and title so to do, adversely to the whole world, and so diverted, appropriated, used, and enjoyed the said water without let, hindrance, or objection by any person whomsoever; and that the owners of the Santiago Rancho, with knowledge thereof, stood by and made no objection. But the court



below also found that during the same time the  
192 water \*192 of the river was diverted, appropriated,  
used, and enjoyed by the owners of the ranchos  
Santiago and Canon for the irrigation of their  
respective tracts, and further, that while the  
diversion and use of the water by the respective  
parties, and upon the respective ranchos and tracts  
of land as stated in the findings, "has been done  
and claimed as of right, and claimed to be done  
adversely to all others, still, until within a year or  
two prior to the commencement of this action,  
there has been no interference of serious  
importance with the diversion or attempted  
diversion of any one by any of the others, there  
having prior to that time been sufficient water  
flowing in the river to supply the respective wants  
and demands of all the parties; but since then, that  
is, within a year or two prior to this suit, on  
account of the increased appropriations and  
diversions above the ditches of all the parties,  
water has become scarce and insufficient to supply  
the demands and necessities of all the parties. That  
except as to non-interference and failure to object  
under the circumstances aforesaid, there has never  
been any acquiescence or consent to the use of  
water as to any person, party, or corporation, by  
the owners or claimants of any of the ranchos  
mentioned in these findings, or of any of the  
parties hereto or their predecessors or grantors.  
But ever since water has become scarce, as  
aforesaid, each party has respectively asserted, and  
at all times attempted as best they could, to  
maintain the rights as respectively claimed by  
them."

In the face of such facts as these, how can  
we be expected to hold that as against the owners  
of the Santiago Rancho the plaintiffs have  
established any prescriptive right? In order to  
establish a right by prescription, the acts by which  
it is sought to establish it must operate as an  
invasion of the right of the party against whom it  
is set up. The enjoyment relied upon must be of  
such a character as to [30 P. 626] afford ground for  
an action by the other party. This is thoroughly

settled. Now it is very clear that while there was  
sufficient water flowing in the river to supply the  
wants and demands of all the parties, its use by  
one could not be an invasion of any right of any  
other; and as the court below found, as a fact, that  
until within a year or two prior to the  
commencement of the action, there was sufficient  
water flowing in the river to supply the wants and  
193 demands of \*193 all the parties, it is plain that the  
plaintiffs as against the owners of the Santiago  
Rancho have acquired no right by prescription.

3. As against the owners of the rancho  
Santiago, have the plaintiffs established a right to  
divert the water in question by reason of its prior  
appropriation and beneficial use?

This claim of the plaintiffs is negated by  
the facts found by the court below. As seen  
already, there was, according to the finding,  
sufficient water flowing in the river to supply the  
wants and demands of the owners of each of the  
ranchos mentioned, until within a year or two  
prior to the commencement of this action in 1877.  
It also appears from the record that from an early  
day irrigation with the water of the river was  
carried on upon the rancho Santiago by its owners  
and their tenants. It was so carried on in 1857,  
when the conveyances from Ontiveras were made  
to the predecessors of the plaintiffs under which  
the plaintiffs' ditch was constructed, and sufficient  
of the water of the river diverted and appropriated  
to keep it flowing full to its utmost capacity at all  
times and seasons of the year, for the purpose of  
irrigating the Anaheim tract of 1,165 acres. But  
this appropriation by the predecessors of the  
plaintiffs was, according to the findings of the  
court below, neither prior to the use of the water of  
the river by the owners of the Santiago Rancho,  
nor did it in any manner interfere with the use of it  
by the latter; for, according to the findings, there  
was then enough water flowing in the river to  
supply the wants and demands of all of the parties,  
and continued to be until within a year or two  
prior to 1877.

As observed already, the court below found that, at the time of the purchase by the predecessors of the plaintiffs from Ontiveras in 1857, and for years before, the owners of the Santiago Rancho were and had been using the water of the river for the irrigation of their rancho; but the court further found that prior to 1871 "said irrigation and cultivation was irregular both as to time and place, and also as to ditches, some years more and some years less, at one place one year and at a different place another year, and during some years some of the ditches were not used, so that during some years not more than three irrigating heads, being each one hundred square  
194 inches \*194 under four inches pressure, were diverted and used during some years, and their ditches were often neglected and filled with weeds and dirt and their capacity at times greatly diminished, and such was their condition in 1857."

But that irrigation upon the Santiago Rancho was, prior to 1871, "irregular, some years more and some years less, at one place one year, and at a different place another year," and that during some years some of the ditches were not used, and other years some of them were neglected is unimportant. The fact remains that the owners of the rancho did use the water of the river according to their wants and demands, and were so using three irrigating heads of it in 1857, and, further, there was at all times an abundant supply in the river for all parties until within a year or two prior to 1877.

It may be added that while the court below found that the water diverted and appropriated by the predecessors of the plaintiffs in 1857, that is to say, sufficient of the water of the river to keep their ditch flowing full to its utmost capacity at all times and seasons of the year, for the purpose of irrigating the Anaheim tract of 1,165 acres, "was then, ever since has been, and now is necessary for that purpose," it also found as a fact that the plaintiffs have sold water to parties on said Cajon Rancho, outside of the Anaheim tract, "commencing about 1869, and gradually

increasing said outside supply to about six hundred or eight hundred acres, except in very dry seasons, as existing at the time of the diversions complained of, when about all the water in the ditch is necessary for the Anaheim tract."

These findings are not only inconsistent, but it certainly cannot be that water diverted and appropriated for the purpose of irrigating the Anaheim tract can be sold by the plaintiffs to supply other lands, to the injury of the owners of the rancho Santiago, who, from a time long anterior to the purchase of the plaintiffs' predecessors have been accustomed to use a portion of the water of the river for the irrigation of that rancho.

4. With respect to the estoppel relied on by the plaintiffs it is sufficient to say that, as the findings of the court below show that there was sufficient water flowing in the river in 1857 and for nearly twenty years thereafter to supply the wants and demands of the owners of each of the  
195 ranchos bordering on the \*195 stream, the owners of the Santiago Rancho were neither called upon to object to the diversion and appropriation by the predecessors of the plaintiffs, nor had they any right to object thereto. No right of theirs was interfered with. Nor does it appear that there was any fraud, misrepresentation, or concealment of any kind practiced upon the predecessors of the plaintiffs by the owners of the rancho Santiago. In a recent case we had occasion to quote with approval what was held here in the case of Biddle Boggs v. Merced Mining Co. 14 Cal. 368: "There must be some degree of turpitude in the conduct of a party before a court of equity will estop him from the assertion of his title -- the effect of the estoppel being to forfeit his property and transfer its enjoyment to another."

The findings in this case show that the scarcity of water in the river that first made itself felt within a year or two prior to the commencement of this action, was caused by diversions made by parties above the highest ditch

of any of the parties to this controversy. With the scarcity of the water arose disputes between the respective [30 P. 627] claimants. It is not strange that this was so, for in the region in question, water for irrigation is essential to the proper cultivation and enjoyment of the land. Upon the Anaheim tract as well as upon the rancho Santiago numerous and extensive and valuable vineyards and orchards have been raised with the aid of the water of this river. Its continued use is all-important to all parties concerned. The plaintiffs, by virtue of the purchase of their predecessors from Ontiveras, and their subsequent appropriation and use, are undoubtedly justly entitled to such portion of the water of the river appertaining to the rancho San Juan y Cajon de Santa Ana as is sufficient for the proper irrigation of the Anaheim tract. Whether, if the portion of the water appertaining to that rancho is insufficient for that purpose, the plaintiffs are entitled to enough of the water of the river appertaining to the rancho Canon de Santa Ana to make good the deficiency, by virtue of the deed from Yorba to Ontiveras, we cannot now decide for the reason already explained. But as, for the reason already given, the plaintiffs have acquired no right to any portion of the water that appertains to the owners of the rancho Santiago de Santa Ana, the decree of the court below which secures  
196 to the plaintiffs \*196 sufficient of the water of the river to keep their ditch flowing full to its utmost capacity at all times and seasons of the year, without regard to the quantity of water that may be left in the river after such diversion, and irrespective of the wants and necessities of the owners of the rancho Santiago de Santa Ana, cannot be sustained. We must therefore reverse the judgment, and remand the cause for a new trial. In doing so, we think it not improper to suggest, in view of the value of the water in dispute and the large interests at stake, whether it is not advisable for the parties to the controversy to divide the water upon an equitable basis, and devote the

money that may otherwise be expended in litigation in the proper development and judicious use of it.

Judgment and order reversed, and cause remanded for a new trial.

MYRICK, J., concurred.

**CONCUR**

THORNTON; McKEE

THORNTON, J. -- I concur: I am of opinion that the plaintiffs have failed to make out any case for relief upon the grounds of prescription or estoppel in pais. The reasoning on these points in the opinion of JUSTICE ROSS is conclusive.

On whatever rules the rights of the parties herein are to be admeasured, whether by the rules applicable to appropriation, or those applicable to the common-law doctrine of riparian rights, the rights of the parties are at least equal; neither has made out a claim superior to the other. There has never been any exclusive appropriation by plaintiffs prior to that of defendant, and the same may be said of the appropriation by defendant. I can see no exclusive appropriation by either party of the water of the stream, or any part of it. The use of the water has always been had by either party with the observance of the right of the other to a reasonable use of it for irrigation. Under these circumstances, the parties must be held to have at least equal rights to use the water for the purpose indicated. The court, therefore, in adjudging that the plaintiffs have, under all circumstances, the right to have their ditch flow full of water to the exclusion of the defendant, has violated the equality of right above mentioned, and has fallen  
197 into an error for which the case must be \*197 tried anew. The foregoing, in my opinion, is the substance of the able and elaborate opinion of JUSTICE ROSS, and I therefore concur in it. It is apparent that no question is made, in this case, as to the right to the use of the water for domestic purposes, and of course nothing is herein ruled in that regard.

McKee, J. -- The case as made out in the court below failed to establish an exclusive right of ownership arising out of prescription or estoppel, in the water of the Santa Ana River, to the extent claimed by the plaintiffs.

In my judgment, the rights of the respective parties originated in a riparian source, are held by them in common, and invest each with equal rights to the use and enjoyment of the water of the stream. Being held in common, it is well settled that in a controversy between such owners as to their rights it is the duty of a court of equity to determine the respective rights of the parties so as to give to each the just proportion to which he

may be entitled, and if necessary, regulate them between them according to their rights. (McLaughlin, 32 Vt. 423; Arthur v. Case, 1 N.H. 447; Belknap v. Trimble, 3 Paige, 601; Webb v. Gage, 39 N.H. 182; Bardwell v. Ames, 22 Pick. 353; Ballou v. Hopkinton, 4 Gray, 324; Booth v. Driscoll, 20 Conn. 535; Brown v. Ashley, 16 Nev. 311.) That principle was not observed in the adjudication of this case, and I agree that the judgment should be reversed and the cause remanded for a new trial.

 casetext

COOPER

LINCOLN COUNTY, NV

2020-159032

Rec:\$37.00

Total:\$37.00

10/02/2020 03:36 PM

M.LWICKS BEN S.P.R.R

Pgs=47 KE

Recording Requested By:  
M.LWICKS BEN S.P.R.R

Return To:  
MAG HOLDINGS TRUST  
C/O M.L.Wicks and Its Assigns  
3705148<sup>Th</sup>  
Palmdale, California 93552



00005555202001590320470475

OFFICIAL RECORD  
AMY ELMER, RECORDER

---

**DOCUMENT TITLE**

---

---

**ASSIGNMENT**

---

(11)

RECORDING REQUESTED BY

AND WHEN RECORDED MAIL TO

Name Mumina A.Rahman  
% MAG TRUST through M.L.WICKS  
Address 37051 48TH  
Palmdale ,California 93552

**ASSIGNMENT**

**OPERATION M.L.Wicks  
TRUST ASSETS NO 22**

FOR VALUE RECEIVED # 5 TO 886 ASSETS OF CLAIMS -OPERATION M.L.WICKS22, the undersigned hereby grants , assigns and transfers Trust Assets and property to Assignee Michelle A. Gardner , forever the lands described attached hereto.

Exhibits 524 BKA 37 - BKA 39 - BKA 43 DOC 3364 - BKA 46  
BKA 47 - BKA 36 BKA 14 See Attached. AFFIDAVIT 22 EXHIBITS

Interest under that certain Court Orders and Judgments Jennie L.Wicks to M.L.Wicks Through MOYE JARVIS WICKS TRUST and Assignee Michelle A. Gardner at 37051 48TH Palmdale ,California 93552 and recorded as instrument Book see ABOVE page 920 entered on. of Official Records in the office of the county Recorder of Santa Clara County, State of California and more parti- cularly described as to wit: TWN 2 N. R 67 EAST  
Situating in the county of Santa Clara, State of California and consists of an undivided IN STATE OF NEVADA COUNTY OF LINCOLN

*[Handwritten Signature]*

Executed by MAG TRUST in behalf of M.L.Wicks ,M.L.WICKS TRUST.

Dated August 7, 2020 see Assignment 22 and M.O.U

Assignor MAG TRUST *[Handwritten Signature]*

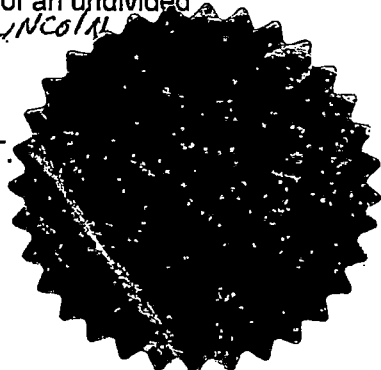

ACKNOWLEDGMENT

A notary public or other officer completing this certificate verifies only the identity of the individual who signed the document to which this certificate is attached, and not the truthfulness, accuracy, or validity of that document.

State of California  
County of ALAMEDA

On 08-18-2020 before me, NISHA RANI SINGH (NOTARY PUBLIC)  
(insert name and title of the officer)

personally appeared Muina Abdul Rahman  
who proved to me on the basis of satisfactory evidence to be the person(s) whose name(s) is/are subscribed to the within instrument and acknowledged to me that he/she/they executed the same in his/her/their authorized capacity(ies), and that by his/her/their signature(s) on the instrument the person(s), or the entity upon behalf of which the person(s) acted, executed the instrument.

I certify under PENALTY OF PERJURY under the laws of the State of California that the foregoing paragraph is true and correct.

WITNESS my hand and official seal.

Signature *Muina* (Seal)

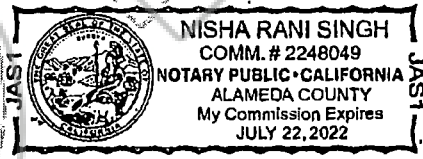

1  
2  
3  
4  
5  
6  
7  
8  
9  
10  
11  
12  
13  
14  
15  
16  
17  
18  
19  
20  
21  
22  
23  
24  
25  
26  
27  
28  
29  
30  
31  
32  
33  
34  
35



**SYLAWC**

**AFFIDAVIT AND EXHIBITS(22 )**

California Code, Civil Code - CIV § 3344.1

**OPERATION M.L WICKS22©**

**WICKS SYSTEM22©**

**EXHIBITS \_\_\_\_\_**

**No Filing Fee 6103**

**Executive Order 13565 Establishment of Intellectual Property Enforcement Advisory Committee**

**Conditional Acceptance and Notice of Intent to Preserve Interest Title 5 (commencing with**

**Sections 888.20) of Part 2 Division of the Civil Code Marketable Record Title**

**Assignee Mumina Abdur Rahman, Michelle Artice Gardner, DNA Olmec, December 22,2019, 22:22**

**APPOINTMENT AND NOTICE OF INTEREST RIGHTS AND RIGHT TO CONTROL THE DISPOSITION OF ALL ASSETS OF M.L.Wicks Trust & the natural man birthed in Aberdeen, Mississipi and Jennie Langley Wicks, maiden name Bowman ,birthed in Cairo, Illinois.**

**Holders of Private Bills Payable in Gold Bonds, at Forty- eight thousand (48), Forty- four thousand (44), Seven Series, issued by Gerrit L. Lansing and Charles F. Crocker, D.O. Mills, J.L. Wilcutt on April 1, 1887. Made-payable thirty years later from that dated Gold Bonds To be designated by the letter of the alphabet commencing with letter(A) followed by the succeeding letters in regular order to be including the letter(G) Series. (A) to consist of thirteen thousand bonds for one thousand dollars both inclusive and four thousand bonds for five hundred dollars. Series(B)to (F) Series(G). Value in (46) Forty-Six Millions of Dollars. By the SOUTHERN PACIFIC TRANSPORTATION COMPANY BOOK 222-page 172**

Exhibit \_\_\_\_\_

**Including deeds ,voice, signatures, birth certificates, photographs of likeness with or without commercial value at the time of his and her death, because of his or her death, whether or not during the lifetime of that natural person the person used his or her name, On or in treaties old and new, land patents by the Department of Interior, ships, harbors, rivers ,bridges, products, land ,machinery, telegraph technology , toys ,birds, electricity ,gas ,light beams and the unseen.**

**ACTS OF CONGRESS**

**P/ L/95-586 H.R.7971 -CONFIRMATION TO M.L. WICKS BY SOUTHERN PACIFIC TRANSPORTATION COMPANY\_\_\_\_\_**

14



36

**ACTS OF CONGRESS**

37

**PL/ L95-586 H.R.7971 -CONFIRMATION TO M.L WICKS BY SOUTHERN PACIFIC TRANSPORTATION COMPANY**—

38

39

**PL/95-466 A joint resolution to restore posthumously full rights citizenship to Jefferson F. Davis S.J.**

40

**Res.16**

41

42

**PL/Rivers and Harbors Appropriation Act of 1899 (33 U.S.C. 403; Chapter 425, March 3, 1899; 30**

43

**BALLONA HARBOR & IMPROVEMENT COMPANY, LOS ANGELES, WILMINGTON RAILWAY, SAN DIEGO RAILWAY,**

44

**OTAI MESA LAKE, Pasadena, Fontana, Ontario, Etiwanda, Hermosa, Colton, Centre Citrus, Covina, Puente,**

45

**Alhambra, Savannah, Monrovia, Lamada Park, San Fernando, Santa Monica, Norwalk, Downey City, Artesia,**

46

**Long Beach, Iron Sulphur Springs, Newhall, City of Bell, Bellflower, Redlands, Los Angeles River, Cuyahoga,**

47

**Ohio, Pennsylvania, Tennessee, New York, New Stat. 1151, H.R. 407 Jersey, Missouri, Illinois,**

48

**Louisiana, Alabama; Texas; Mexico; New Mexico, Arizona; Oregon; Florida.**

49

50

**PL/595 Rivers and Harbors**

51

52

**HR. 5485. To amend the Agricultural Marketing Act of 1946 to provide for State and Tribal regulation of**

53

**hemp production, and for other purposes. Exhibits 22**

54

55

**OPERATION M.L. WICKS THROUGHOUT THE WHOLE WORLD AND SPACE VALUATION ON**

56

**DECEMBER 22,2019, IS 1,022,000,000,000,000. TRILLION DOLLARS.**

57

**GREETINGS : To whom it may concern: Nationally and Internationally NAICS221119 OTHER POWER**

58

**GENERATION. The undersigned hereby gives Notice of her appointments as Assignees of M.L.Wicks**

59

**and Jennie L .Wicks, Moye Jarvis Wicks, WICKS FAMILY TRUST of 1913 ,MOSES JARVIS WICKS**

60

**FAMILY TRUST, held by Moye Jarvis Wicks , Internationally and within the Republic of California,**

61

**Northern and Southern, the county of San Diego and the United Mexican States, Department of,**

62

**State Department, Attorney General's Office in the District of Columbia. who continuously became**

7

63 aware of certain Unresolved Assets for recovery and release by the Courts of Justice.

64 **ASSIGNMENTS AND LAWFUL APPOINTMENTS**

65 To appoint a Minister Plenipotentiary to establish ministerial places of worship and travel abroad, holding  
66 two delegates, as well as a **Special Minister of Administration**, Edgar Ibarra Lozano, purpose is for  
67 securing documents and artifacts and writings, holding on to Grandfather clauses precluding merchandise,  
68 goods, artifacts, subdivisions, books, track maps, survey maps, maintain dedications, seek and recover  
69 lost property and unlawful hypothecated lands, to void unlawful contracts, settle court cases, investigate  
70 and maintain title insurances, account for all chattel property, take account of all lawful money exchanges  
71 and mergers and compounded interests accounts, bank accounts, trust accounts, all kinds of bonds,  
72 promissory notes, gold, silver, rocks, dinosaurs, diamonds, borax, tar, rocks, mountains, rivers, streams,  
73 oysters, ostriches, minerals, prisons and warehouses, flags, lawsuits, cars, trains, newspapers clippings  
74 for purposes of advertising and prove up, receive and deliver summons, lead transportation on  
75 water, land or sea, maintain conveyances, secure licenses, develop and maintain water rights,  
76 above, below surfaces of the earth, recover copper, lithomarge, kaolin, deposit asbestos deposits,  
77 graphite deposit, borax deposits, lead, mines. Maintain highways, airports, helicopters, landing strips,  
78 airplanes, satellites in the Americas, and Mexico and global abroad. Produce and claiming the blood line  
79 and claims of Calafia and M.L. Wicks, recognizing and claiming his and her nationality, treaties, the  
80 constitution of united states and land grants, excepting disclaimers submitted world-wide that  
81 acknowledges our ownership. Establish and maintaining diplomacy and peace, and on land and sea,  
82 utilizing, Title 22 Foreign Relations and Intercourse, Private Bills from 1817 throughout.

83 **LODIAL TITLES- LAND GRANTS & LAND PATENT**

84	<u>Patents # 5565-5725-074165-04271206</u>	- Interest Rights to M.L. Wicks
85	<u>Patents # 40937</u>	- Interest Rights to M.L. Wicks
86	<u>Patents# 43101 South Yuba Mining and Development</u>	- Interest Rights to M.L. Wicks
87	<u>Patents # 5165 The Pomona Land and Water Company</u>	- Interest Rights to M.L. Wicks
88	<u>Patents # 5508 Del Sur Ranch Company</u>	- Interest Rights to M.L. Wicks
89	<u>Patents# 5182 The Ontario Land and Improvement Company of Los Angeles</u>	-Interest Rights to M.L.
90	<u>Patent #5715-5726-5727 South Antelope Valley Irrigation</u>	- Interest Rights to M.L. Wicks

13

8

- 91 Patents # 1141 Chariot Mill and Mining Company - Interest Rights to M.L. Wicks
- 92 Patents # 5591 Big Rock Creek Irrigation District - Interest Rights to M.L. Wicks
- 93 Patents # 1-2-4-6-36-55-62-120-152- 190 Southern Pacific Railroad -Interest Rights to M.L. Wicks
- 94 Patents # 022999 Atlantic And Pacific Railroad - Interest Rights to M.L. Wicks
- 95 Patents # 8 Central Pacific Railroad Interest Rights to M.L. Wicks - Interest Rights to M.L. Wicks
- 96 Patents # 034421-200062 Santa Fe Pacific Railroad - Interest Rights to M.L. Wicks
- 97 Patents # 5766 John Griffin - Interest Rights to M.L. Wicks
- 98 Patents # 005140 Miguel Antonio Chavez - Interest Rights to M.L. Wicks
- 99 Patents# 5619 Issac Chapman - Interest Rights to M.L. Wicks
- 100 Patents # 2482 Emilio Cantua -Interest Rights to M.L. Wicks
- 101 Patents #16804 Juan Cantua - Interest Rights to M.L. Wicks
- 102 Patents # 5716 Nathan Cole Jr. - Interest Rights to M.L. Wicks
- 103 Patents # 468 Abel Sterns - Interest Rights to M.L. Wicks
- 104 Patents # 499 Theodocio Yorba - Interest Rights to M.L. Wicks
- 105 Patents # 473 Juan Pacifico Ontiveros - Interest Rights to M.L. Wicks
- 106 Patents # 484 -432-Vincante Sepulveda - Interest Rights to M.L. Wicks
- 107 Patents # 490 Luis Vignes - Interest Rights to M.L. Wicks
- 108 Patents # 014307 Augustine Machado - Interest Rights to M.L. Wicks
- 109 Patents # 114904 -378 -378-683-701 John Cross - Interest Rights to M.L. Wicks
- 110 Patents # 3600 -7488 and 3600- 080785 Herman Wruck - Interest Rights to M.L. Wicks
- 111 Patent # 533 Joseph Ladoc Almany - Interest Rights to M.L. Wicks
- 112 Patents # 737 Jose A. Arguello - Interest Rights to M.L. Wicks
- 113 Patent # 532 Santiago Arquello - Interest Rights to M.L. Wicks
- 114 Patent # 113421-413 -425-113421- 556 David W. Alexander - Interest Rights to M.L. Wicks
- 115 Patents # 2896 and 230-William Lane with Interest to SOUTHERN PACIFIC RAILROAD to M.L. Wicks
- 116 June 6-1874 to November 10-1874

16

9

117 **Township 19 South Range 1 west lots 6,9,10, 1.31 ACRES OF LAND, more or less, situated in the**  
118 **City of San Diego,**  
119

---

120 **Land described in the assignment as, 1.31 ACRES OF LAND, more or less, situated in City of San**  
121 **Diego, County of San Diego 2.7 ACRES OF LAND, more or less, situated in City of San Diego, County of**  
122 **San Diego 0.537 ACRES OF LAND, more or less, situated in City of San Diego, County of San Diego.**  
123 **33.7 ACRES OF LAND, more or less, situated in City of San Diego, County of San Diego, Exhibit \_\_\_\_\_**  
124

---

125 **Bakersfield-Decimal Coordinates (Latitude, Longitude):35.373 and -119.019 (Lat./Lng.) Coordinates by**  
126 **Time: N 35° 22' 23" and W -119° 1' 7"**  
127

---

128 **San Bernardino -Decimal Coordinates (Latitude, Longitude):34.108 and -117.290 (Lat./Lng.) Coordinates**  
129 **by Time: N 34° 6' 30" and W -117° 17' 23"**  
130

---

131 **Los Angeles -Decimal Coordinates (Latitude, Longitude):34.052 and -118.244 (Lat./Lng.) Coordinates by**  
132 **Time: N 34° 3' 8" and W -118° 14' 37"**  
133

---

134 **M.L. Wicks Subdivision Book 23-page 33 Huntington Repo Longitude: -118.408°Latitude: 33.943°**  
135 **Hawthorne -Decimal Coordinates (Latitude, Longitude):33.916 and -118.353 (Lat./Lng.) Coordinates by**  
136 **Time: N 33° 54' 59" and W -118° 21' 9"**  
137

---

138 **El CAMPITO Decimal Coordinates (Latitude, Longitude):30.149 and -115.801 (Lat./Lng.) Coordinates by**  
139 **Time: N 30° 8' 54" and W -115° 48' 5"**  
140

---

141 **Mexicali -32.628 and -115.454 (Lat./Lng.) Coordinates by Time: N 32° 37' 40" and W -115° 27' 16"**  
142

---

143 **Ensenada- Decimal Coordinates (Latitude, Longitude):31.871 and -116.601 (Lat./Lng.) Coordinates by**  
144 **Time: N 31° 52' 17" and W -116° 36' 2"**  
145

---

146 **Yuma -Decimal Coordinates (Latitude, Longitude):32.725 and -114.624 (Lat./Lng.) Coordinates by Time:**  
147 **N 32° 43' 31" and W -114° 37' 27"**  
148

---

149 **Peninsula of the Republic of Mexico Antecedent Interest Rights in concession of lands of the Mexican**  
150 **International Colonization Company, Louis Huller Jr. Estate, George Sisson, Santiago Huller estate,**  
151 **railways, water concessions. (18) Eighteen million acres through land grants of President Porfirio**  
152 **Diaz, Surveyed by United States Hydrographic Office of the Navy Department. Carmen Island**  
153 **and its, sulphur deposits, gold, silver bronze, lithium, all agriculture and farming, machinery,**  
154 **telegraph, railroads and highways.**  
155

---

156 **ROSARIO – EL GALLO -750 Metros De Norte A Sur Por 150 Metros De Este A Oeste. Las Medidas Se**  
157 **Toman De LA Zona Federal, Ubicacion En El Rosario La Playa, De Acuerdo**  
158 **750 Meters From North To South For 150 Meters From East To West. The Measures Are Taken From**  
159 **The Federal Zone, Location In Rosario The Beach Exhibit \_\_\_\_\_**  
160 **Retrieving the remains of specimen # 22654. Interest Rights to Barbara Ray Wicks & Moye J.**  
161 **Wicks**  
162

---

163 **ROSARIO-Contralto Escritura No 100,406,806, Barbara Ann Ray Wicks and Moye Jarvis Wicks and**  
164 **Ejido Centro Turista El Consuelo S De.R. I 50-1813-24 hectares Act no 78,346 Volume 616 Centro**  
165 **Turista El Consuelo De.R. fraction 19,379,926.34 square meters lease with option to purchase then paid**  
166 **in full then Ratified in the Republic of Mexico Act No 80.385 parcela 173,174, Exhibit \_\_\_\_\_**  
167 **Poligino / Parcels A, B, C, D, F, 1, 2, 3, 4, 5, 6, 7, REFORMA A INTEGRAL Per Map**  
168 **All electric lines placed illegally in and on land is the property of the Moye Jarvis Wicks Trust property**  
169 **CFE 00049 -12 C-750-200 IEA 3 Unpaid debt 138,000,00.00 LOR MANGEMENT SA. DE C.V.**

(M)

(10)

170 LOR PROPERTIES, VIN LOR PROPERTIES, KSI CAPITAL CORP, DIAMANTE DEL MAR, LLC,  
171 DESARROLLADORA DDM S. DE.CV, IMOBILIARIA DDM S.DE R.L.DE C.V. LITTLE ISLE IV, LLC Ula  
172 Makika, Llc, Phillip A. Kenner, Joe Juneau, Eric R. Fish, Willard C. Shih, embezzlement. NCN PAYMENT.  
173

174 **ROSARIO-Tierra Dentro Turístico El Consuelo Norte Bocana El Rosario-Baja california Norte Moye-**  
175 **Wicks, oferta Fin, Enero 1999. Parcela De Zona Federale, Norte Poligino Grupo A (hector) Sur Grupo**  
176 **Santiago Resek Este Hasta Carreta D1 Approximated 2300 metros Del Mar, paid in full \$328,700**  
177 **Three Hundred Twenty- Eight Thousand -Seven Hundred Dollars. Baja, California. Acceptance of**  
178 **Ancient Lands of Calafia with right to exist freely without constraints. Exhibit**  
179

180 **Puerto San Carlos in Republic of Mexico LAND described as:**  
181 **Interest Rights to Barbara Ray Wicks & Moye J. Wicks**  
182

183 **LAND DESCRIBED AS PUNTA BAJA - LA BOCANA Senior Buried at location**  
184 **Decimal Coordinátes (Latitude, Longitude):29.955 and -115.807 (Lat./Lng.) Coordinates by Time: N 29°**  
185 **57° 18' and W -115° 48' 25"**  
**29°56'59.2"N 115°48'42.4"W**  
**29.949768, -115.811780**

**Interest Rights to Barbara Ray Wicks & Moye J. Wicks**

**JUDGEMENTS /ORDERS AND DECREES**

191 **Abstract of Judgment Case 33514 Northcutt vs M.L. Wicks, et al Value 140 B**

192 **SOUTHERN PACIFIC R.R. U.S. OF AMERICA ENTRIES EX A LANDS CONFIRMED BY JUDGE**

194 **Civil Judgment Case C549524 Redevelopment Agency of Los Angeles vs Jennie L. Wicks et, al**  
195 **In Favor of Mumina A. Rahman Assignee for Moye Jarvis Wicks et, al**  
196 **\$328,000.00 Three Hundred Twenty-Eight Thousand Dollars plus offset**  
197

198 **UNITED STATES DISTRICT COURT SOUTHERN DISTRICT OF CALIFORNIA**  
199 **Case 3:11-cv-00949-MMA-WMC Document 55 and 54**

**\$660,000.00 Six Hundred Sixty Thousand Dollars**

**FILED DISCLAIMERS OF:**

203 **The SAN DIEGO GAS ELECTRIC COMPANY**

204 **The STATE OF CALIFORNIA**

205 **The STATE OF CALIFORNIA Acting Through the DEPARTMENT OF TRANSPORTATION**

206 **The CITY OF SAN DIEGO**

207 **The COUNTY OF SAN DIEGO**

208 **PACIFIC BELL TELEPHONE COMPANY**

209 **The REDEVELOPMENT AGENCY OF THE CITY OF SAN DIEGO**

210 **J.M. International, A Calif, Limited Partnership**

211 **GREYHOUND LINES**  
212  
213  
214

**ASSIGNMENTS & RECOVERY HOLDOVERS TRUST AND CORPORATIONS**

217 **Los Angeles County Bar**

**-Interest Rights to M.L. Wicks**

219 **The Herald Newspaper Interest Rights**

**- Interest Rights to M.L. Wicks, Stephens**

221 **The Abstract and Title Insurance Company**

**- Interest Rights to M.L. Wicks F.A. Gibson**

223 **Occidental University /College**

**Interest Rights to M.L. Wicks.**

18

16

224 NEW YORK LIFE INSURANCE 0007798 NOV 29-1899. M.L. WICKS

225 Los Angeles Title Insurance Company - Interest Rights to M.L. Wicks

226 Title Insurance and Trust Company - Interest Rights to M.L. Wicks

227 Imperial Valley Irrigation District - Interest Rights to M.L. Wicks

228 Los Angeles Chamber of Commerce - Interest Rights to M.L. Wicks

229 American Institute of Banking - Interest Rights to Milton L. Wicks

230 Bank of New York - Interest Rights to Milton L. Wicks

231 State Banking Department 80 Centre St NY Joseph A. Broderick - Interest Rights to Milton L. Wicks

232 W.C. Becker - Interest Rights to Milton L. Wicks

233 United States Trust Company, 45 Wall Street NY - Interest Rights to Milton L. Wicks

234 Guaranty Trust Company, 140 Broadway NY - Interest Rights to Milton L. Wicks

235 National State Bank, Newark, New Jersey, Charles W. Cary - Interest Rights to Milton L. Wicks

236 Room 805, 100 East 142nd NY, C.H. Cheney Milton L. Wicks - Interest Rights to Milton L. Wicks

237 Citizens Savings Bank, 56 Bowery NYC, William Clemente - Interest Rights to Milton L. Wicks

238 Chase National Bank, 18 Pine St NY, Charles Feuerstein - Interest Rights to Milton L. Wicks

239 Chemical Bank & Trust Co, 165 Broadway NYC, J.M. Harding - Interest Rights to Milton L. Wicks

240 First National Bank, 2 Wall St. NYC, W. Heinkel - Interest Rights to Milton L. Wicks

241 31 Nassau St. NYC C.R. Judd - Interest Rights to Milton L. Wicks

242 9220 52nd St. Elmhurst, LI William J. Liebertz - Interest Rights to Milton L. Wicks

243 Chase National Bank, 18 Pine St. NYC - Interest Rights to Milton L. Wicks

244 123 William St. Syosset, Long Island - Interest Rights to Milton L. Wicks

245 Value of Bank Examination by Committee Of Its Clerks Instructions - Interest Rights to Milton L. Wicks

246 Dow Jones & Co Wall Street Journal, RESERVE BANK, Document Serrano Pratt - Interest Rights to Milton L. Wicks

247 ABETNA INSURANCE - 01908 42 THE ABETNA CASUALTY AND SURETY COMPANY

248 Carolina Insurance Company, Bonds 5000 shares, Jefferson F. Davis President - Interest Rights to M.L. Wicks, VP, Moses Jarvis Wicks Witness 1871

249 Certificate of Incorporation of the ACCOUNTANCY INVESTIGATION BUREAU, 1 Hudson, New York, 220 Broadway, New York, 5 W. 125 Street, New York, Milton L. Wicks, Perpetual-Existence

250 Ventura Farms Frozen Foods - Interest Rights to Milton L. Wicks

251 Hotel Imperial, Broadway & Thirty Second Street, NYC - Interest Rights to Milton L. Wicks

252 Southern Pacific Placer CA 015 010-098 ET AL

MAR

19

12

280	Colyears Documents address 507-509-511 Main St	- Interest Rights to Milton L. Wicks
281		
282	W.H. Woodham Furniture Documents address 507-506-511 Main St Los Angeles	
283		
284	<i>PACIFIC Telephone AND Telegraph Co. M.L. Wicks</i>	Milton L. Wicks
285	First National Bank of the City of New York Geo Baker 1923 Letter of Credit upon presentment	
286	Perpetual to Milton L. Wicks	
287		
288	WICKS RANCH MOORPARK CALIFORNIA by Percy L. Wicks to Milton L. Wicks February 20, 1930	
289		
290	Department of Justice Bureau of Investigations Washington August 23, 1921 correspondence by	
291	William Burns	- Interest Rights to Milton L. Wicks
292		
293	Department of Justice Correspondence by George Wickersham	- Interest Rights to Milton L. Wicks
294		
295	Family manuscript and instructions by Dr. Marion Wicks Freyman, daughter of Moye Wicks, presented to	
296	Moye Wicks III in October 1979 then first delivered to delivered to Assignee Murrina Abdur Rahman.	
297		
298	E.T. Wright Collection of Maps and personal correspondence and instructions belonging to M.L. Wicks,	
299	located at Loyola College of Los Angeles in and on M.L. Wicks Subdivision Map Book 23-33. witnessed	
300	and identified by Clay Stalls and Bill Frank.	
301		
302	Retrieval of letters, agreements, maps, court cases of M.L. Wicks located at Huntington Library Art	
303	Collection & Botanical Gardens witnessed and identified by Clay Stalls and Bill Frank.	
304		
305	Los Angeles Trust and Savings Bank Deposit 1,500,000.00 One Million Five Hundred Thousand Dollars.	
306	by the Estate of Sarah Amanda Wicks behalf of beneficiaries. July 2, 1913 in gold coin.	
307		
308	M.L. Wicks Subdivision Moorpark of part of Tract U and Addition to Moorpark in Rancho Simi	
309		
310	Lyle Creek Water Company	- Interest Rights to M.L. Wicks
311		
312	Anaheim Water Company	- Interest Rights to M.L. Wicks
313		
314	Citizens Water Company	- Interest Rights to M.L. Wicks
315		
316	Crystal Springs Water Company	- Interest Rights to M.L. Wicks
317		
318	Griffith Park	- Interest Rights to M.L. Wicks
319		
320	German Savings and Loan	- Interest Rights to M.L. Wicks
321		
322	Los Angeles Water Company	- Interest Rights to M.L. Wicks
323		
324	Beaudry Water Works	- Interest Rights to M.L. Wicks
325		
326	Coronado Railway	- Interest Rights to Babcock and M.L. Wicks
327		
328	Nadeau Township Company	- Interest Rights to M.L. Wicks
329		
330	Simi Land water Company	- Interest Rights to M.L. Wicks &
331	Bard, John C. Fremont, Pio Pico	
332		
333	San Jose Ranch Company	- Interest Rights to M.L. Wicks
334		
335	Santa Monica Land & Water Company C0026210	Interest Rights to M.L. Wicks

MAR 20

336 *John D. Brooks / Huntington Boulevard Library M.L. Wicks*  
337 South Antelope Valley Irrigation Company interest Rights to M.L. Wicks

338  
339 Imperial Water Company No 1 - Interest Rights to M.L. Wicks

340  
341 California Bank - Interest Rights to M.L. Wicks

342  
343 Occidental University C0016192 - Interest Rights to M.L. Wicks

Tennell

344  
345 Iron and Brass Foundry Company - Interest Rights to M.L. Wicks } TWO

346 Agriculture Park *RAIL ROAD MAIN STREET* - Interest Rights to M.L. Wicks

347  
348 California Telephone Company - Interest Rights to M.L. Wicks

349  
350 The California Club C0017980 - Interest Rights to M.L. Wicks

351  
352 New York Life Insurance Company C002798 - Interest Rights to M.L. Wicks

353  
354 Aetna Insurance Company of Hartford, Connecticut - Interest Rights to M.L. Wicks

355  
356 Mutual Reserve Life Association - - Interest Rights to M.L. Wicks

357  
358 The Central Trust Co of New York Trustee - Interest Rights to M.L. Wicks

359  
360 Wicks Realty Syndicate - Interest Rights to M.L. Wicks

361  
362 Redondo Beach Hotel - Interest Rights to M.L. Wicks

363  
364 Arcadia Hotel - Interest Rights to M.L. Wicks, M.J.W.

365  
366 Ballona Harbor and Improvement Co- Interest Rights to M.L. Wicks, Moye Wicks, Machado, Juan Bernard

367  
368 Temecula Land Water Company - Interest Rights to M.L. Wicks, Crosswaite's Family

369  
370 The White peak Group Mining Company - Interest Rights to M.L. Wicks, Percy L. Wicks

371  
372 Phoenix Development Company - Interest Rights to M.L. Wicks

373  
374 San Diego Land Town Land - Interest Rights to M.L. Wicks

MAR

375  
376 *NORTHROPT CORR 3078900 MAYE STEPHENS WICKS Robert F. MAQUIRE III*  
377 **TREATIES & PROCLAMATIONS AND DECREES**

378  
379 Adams-Onís Treaty. 1819 agreement between U.S. Secretary of State John Quincy Adams and Spanish

380 Envoy Lord Don Luis de Onís 42° N 100° W 32° N - Interest Rights to M.L. Wicks, Moses

381 Jarvis Wicks  
382  
383 Peace Friendship, Limits of Settlement Guadalupe Hidalgo & the United States of America, Moses

MAR

384 Jarvis Wicks, Pope, Jefferson Finis Davis, Jay Cooke Associates, 3 Nicholas Phillip Trist,  
385 Authenticated Record *BANK OF JAY COOKE & ASS Exhibit*

386  
387 Gadsden Purchase of the Mesilla, 1854 - Interest Rights to M.L. Wicks, Moses Jarvis Wicks,  
388 Jefferson F. Davis.

389

21

17



390 Nanticoke Lenne- Lenape, Delaware's, William Penn, Willem Ussellinex - Interest Rights to M.L.  
391 Wicks, Eleanor Davis Jordan, Penelope Jordan at 1237 Wyle Street Philadelphia, Pennsylvania

MAR

392 ~~INTERSTATE NATIONAL HWY~~ M.L. WICKS  
393 Deal Estates Monmouth New Jersey Margeret Chapman - Interest Rights to M.L. Wicks

**OWNERSHIP & ASSETS**

394  
395  
396 Redondo Beach Hotel - Interest Rights to M.L. Wicks

397  
398 Arcadia Hotel - Interest Rights to M.L. Wicks, Wicks Family

400  
401 Ballona Harbor and Improvement Company - Interest Rights to M.L. Wicks, Moye Wicks,  
402 Machado's, Juan Bernard

403  
404  
405 The White peak Group Mining Company - Interest Rights to M.L. Wicks, Percy L. Wicks

406  
407 Phoenix Development Company - Interest Rights to M.L. Wicks

408  
409 Hollenbeck, H.W. Hellman, Trask, Shankland, O'Melveny, Meyers, Leland Stanford, Edward E.

410  
411 Henry E. Huntington, Joseph Wickes, Jefferson Finis Davis, Charles. F Crocker, Timothy Guy  
412 Phelps, Leland Stanford, Collis P. Huntington, Charles Melville Hays, E.H. Harriman, Robert S.  
413 Lovett, William Sproule, Julius Kruttschnitt.

414  
415 St Paul's Hospital - Interest Rights to M.L. Wicks

416  
417 St Mary's Hospital - Interest Rights to M.L. Wicks

418  
419 California Hospital - Interest Rights to M.L. Wicks

420  
421 Episcopal Church - Interest Rights to M.L. Wicks

422  
423 Los Angeles Golden Rule Lodge IOOF #35 - Interest Rights to M.L. Wicks

424  
425 Young Men's Christian Association Y.M.C.A. - Interest Rights to M.L. Wicks

426  
427 Los Angeles Hospital and home for invalid - Interest Rights to M.L. Wicks

428  
429 The Pomona Land and Water Company - Interest Rights to M.L. Wicks

430  
431 Wicks & Wicks Attorneys At Law Interest Rights to M.L. Wicks, Moye Wicks

432  
433 Los Angeles County Pomological Society - Interest Rights to M.L. Wicks

434  
435 Soldiers Home Santa Monica Land Water- Abstract title Insurance Co Huntington Repo

436 Arcadia Bandini de Baker, Senator John P. Jones, and John Wolfkill, the site for the Pacific Branch of the

437 National Home for Disabled Volunteer Soldiers and Sailors - Interest Rights to M.L. Wicks

438  
439 WICKS REALTY SYNDICATE - Interest Rights to M.L. Wicks

440 ~~LOS ANGELES PACIFIC LAND CO~~ M.L. WICKS

MAR

441 Cucamonga Land and Water Company - Interest Rights to M.L. Wicks

442 SOUTHERN PACIFIC LAND CO M.L. WICKS

443 Cucamonga Fruit Company - Interest Rights to M.L. Wicks

444 LOS ANGELES WATER CO EVALUATOR M.L. WICKS

MAR

22

15

445	First Street Improvement Company	- Interest Rights to M.L. Wicks
446		
447	Fruit Land in Olay Mesa	- Interest Rights to M.L. Wicks
448		
449	Germain Fruit Company	- Interest Rights to M.L. Wicks
450		
451	Santa Clara Oil And Gas Company	- Interest Rights to M.L. Wicks
452		
453	Pomona Land Water company	- Interest Rights to M.L. Wicks
454		
455	Townsite of Lancaster	- Interest Rights to M.L. Wicks
456		
457	Townsite of Moorpark	- Interest Rights to M.L. Wicks
458		
459	Townsite of Hawthorne	- Interest Rights to M.L. Wicks
460		
461	Townsite of Torrance	- Interest Rights to M.L. Wicks
462		
463	Townsite Arcadia	- Interest Rights to M.L. Wicks
464		
465	Townsite of Monrovia	- Interest Rights to M.L. Wicks
466		
467	Townsite of Lamanda	- Interest Rights to M.L. Wicks
468		
469	Townsite of Duarte	- Interest Rights to M.L. Wicks
470		
471	Townsite of Beaumont	- Interest Rights to M.L. Wicks
472		
473	Townsite of Gorgonio	- Interest Rights to M.L. Wicks
474		
475	Townsite of Venice	- Interest Rights to M.L. Wicks
476		
477	Townsite of Redwood	- Interest Rights to M.L. Wicks
478		
479	Townsite of San Joaquin 500 acres	- Interest Rights to M.L. Wicks
480		
481	<i>SURFACE TRANSFER NOTICE M.L. Wicks</i>	
482	<b><u>An Act to Aid in the Construction of a Railroad and Telegraph Line from the Missouri River to the Pacific Ocean, and to Secure to the Government the Use of the Same for Postal, Military, and Other Purposes</u></b>	
483		
484		
485		
486	Los Angeles and the Ostrich Farm at Los Feliz Ranch	- Interest Rights to M.L. Wicks
487		
488	Los Angeles Railway Company	- Interest Rights to M.L. Wicks
489		
490	California Central Railroad Company	- Interest Rights to M.L. Wicks
491		
492	Atchison Topeka & Santa Fe, A.T.&S.F.	- Interest Rights to M.L. Wicks
493		
494	New York, Pennsylvania and Ohio Railroad	- Interest Rights to M.L. Wicks
495		
496	California Southern Railway Company	- Interest Rights to M.L. Wicks
497		
498	Los Angeles San Gabriel Valley Railway	- Interest Rights to M.L. Wicks
499		
500	Los Angeles Wilmington Railroad	- Interest Rights to M.L. Wicks

MAP

23

16

501	<i>SANTA FE PACIFIC RR. - M.L. Wicks</i>	
502	Los Angeles San Bernardino Railroad	- Interest Rights to M.L. Wicks
503		
504	Chicago, Burlington and Quincy Railroad 222 South Spring	- Interest Rights to M.L. Wicks
505		
506	Chicago & Northwestern Railroad, - Interest Rights	- Interest Rights to M.L. Wicks
507		
508	SOUTHERN PACIFIC COMPANY, SOUTHERN PACIFIC RAILROAD COMPANY, SOUTHERN	
509	PACIFIC TRANSPORTATION COMPANY, SAN DIEGO ARIZONA RAILWAY, SAN DIEGO & ARIZONA	
510	EASTERN RAILWAY 107-042-022	Beneficiary Interest Rights to M.L. Wicks
511		
512	SOUTHERN PACIFIC TRANSPORTATION COMPANY 1969, SP, Espee Arizona, Arkansas, California, Colorado, Louisiana, Missouri, Nevada, New Mexico, Oklahoma, Oregon, Tennessee, Texas, Utah	
513	amalgamation of the Union Pacific Railroad 4ft 8 1/2 in 1'435 standard gauge with some 3ft-914mm gauge	
514	branches 1885 the <u>Central Pacific Railroad</u> through leasing. By 1900, the Southern Pacific system was a	
515	major railroad system incorporating many smaller companies, such as the <u>Texas and New Orleans</u>	
516	<u>Railroad</u> and <u>Morgan's Louisiana and Texas Railroad</u> . It extended from <u>New Orleans through Texas to El</u>	
517	<u>Paso, Texas</u> , across <u>New Mexico</u> and through <u>Tucson</u> , to <u>Los Angeles</u> , through most of <u>California</u> ,	
518	including <u>San Francisco</u> and <u>Sacramento</u> . Central Pacific lines extended east across <u>Nevada</u> to <u>Ogden</u> ,	
519	<u>Utah</u> , and reached north through <u>Oregon</u> to <u>Portland</u> . Other subsidiaries eventually included the <u>St. Louis</u>	
520	<u>Southwestern Railway</u> (Cotton Belt), <u>El Paso and Southwestern Railroad</u> , the <u>Northwestern Pacific</u>	
521	<u>Railroad</u> at 328 miles (528 km), the 1,331-mile (2,142 km) <u>Southern Pacific Railroad of Mexico</u> , and a	
522	variety of 3 ft (914 mm) <u>narrow gauge</u> routes	
523		
524	<i>SAN PEDRO &amp; SANGRE SALTE LAKE RR</i>	- Interest Rights to M.L. Wicks Moses Jarvis
525	Wicks, M.L. Wicks, Jennie, Wicks, Percy Wicks, Milton L. Wicks, Moyer Jarvis Wicks	
526		
527	LOS ANGELES UNION TERMINAL, INC C0173576	
528	Merger SOUTHERN PACIFIC TRANSPORTATION	- Interest Rights to M.L. Wicks
529		
530	Articles of Consolidation, Amalgamation and Incorporation	
531	SOUTHERN PACIFIC RAILROAD COMPANY, NORTHERN RAILWAY COMPANY, THE NORTHERN	
532	CALIFORNIA RAILWAY COMPANY, AND THE CALIFORNIA PACIFIC RAIL COMPANY	
533		
534	LOS ANGELES & SAN DIEGO RAILWAY	- Interest Rights to M.L. Wicks
535		
536	California Through Transportation	- Interest Rights to M.L. Wicks
537		
538	SAN DIEGO DEPOT	- Interest Rights to M.L. Wicks
539		
540	S. P. MEXICO	- Interest Rights to M.L. Wicks
541		
542	CHICAGO & NORTH WESTERN RAILWAY COMPANY	- Interest Rights to M.L. Wicks
543		
544	NEW YORK, CHICAGO, BURLINGTON AND QUINCY RAILROAD CB&Q now known as BURLINGTON	
545	NORTHERN SANTA FE RAILWAY BNSF	
546		
547	<i>SOUTHERN CALIFORNIA RAILWAY SAN BERNARDINO SANTA ANITA RR</i>	- Interest Rights to M.L. Wicks
548		
549	BURLINGTON CHICAGO & ST. LOUIS RAILROAD	- Interest Rights to M.L. Wicks
550		
551		
552	CHICAGO and AURORA RAILROAD, PENNSYLVANIA RAILROAD COMPANY,	
553		
554	<i>LOS ANGELES AND SANTA MONICA RR.</i>	- Interest Rights to M.L. Wicks
555	PACIFIC CENTRAL RAILROAD COMPANY	- Interest Rights to M.L. Wicks
556		

Patent  
Doc 3 BLM  
120649

24

17

557 FERROCARRIL SUD PACIFICO DE MEXICO - Interest Rights to M.L. Wicks  
558  
559 FERROCARRIL DEL PACIFICO - Interest Rights to M.L. Wicks  
560  
561 FERREOCARRIL NACIONALES DE MEXICO SANTA FE PACIFIC RAILROAD COMPANY  
562 - Interest Rights to M.L. Wicks  
563  
564 SONORA RAILWAY COMPANY - Interest Rights to M.L. Wicks  
565  
566 SAN DIEGO & IMPERIAL VALLEY RAILROAD CO, INC - Interest Rights to M.L. Wicks  
567  
568 ATCHISON, TOPEKA & SANTA FE RAILWAY COMPANY - Interest Rights to M.L. Wicks  
569  
570 BRITISH MEXICAN LAND and COLONOLIZATION COMPANY - Interest Rights to M.L. Wicks  
571  
572 UNION PACIFIC RAILROAD COMPANY Merger with SOUTHERN PACIFIC RAILROAD  
573  
574 LOWER CALIFORNIA DEVELOPMENT COMPANY OF MEXICO - Interest Rights to M.L. Wicks  
575  
576 INTERNATIONAL COMPANY OF MEXICO - Interest Rights to M.L. Wicks  
577  
578 INTERURBAN RAILROAD COMPANY - Interest Rights to M.L. Wicks  
579  
580 THE BALTIMORE AND OHIO RAILROAD CHESAPEAKE AND OHIO RAILWAY COMPANY (VA CORP.  
581  
582 MEMPHIS CHARLESTON RAILROAD 35°07'56.3"N 90°03'33.3"W35.132306, -90.059250, merger  
583 NORFOLK SOUTHERN RAILWAY 00028001- 7700454823 Virginia & Ohio et, al Merger SOUTHERN  
584 RAILROAD COMPANY OF VIRGINIA 02080265- Merger TCS LEASING - F1122862 330 Church Street  
585 Northwest, Huntsville, Madison County, AL - Interest Rights to M.J.Wicks & M.L.Wicks  
586

587 **SOUTHERN CALIFORNIA CO-OPERATIVE WAREHOUSE AN SHIPPING ASSOCIATION**

588 Transmitting Utility on the Gila River to Tia Juana River to the Pacific Ocean.  
589 GILBERT MENDEZ CARABALLO ESTATE 81-6398640 -7394- CUSIP 316389105(22)  
590 VESSEL 15-cr00068 -00cr548 Release- Warehousing - Interest Rights to M.L. Wicks  
591 No Bill of Laden- Production of Falsified Documents Title 18 U.S.C.1004- 18 Title U.S.C 1658 Plundering  
592 a Vessel 279747394- Deemed Alien Civiliter Resident Mortuus 05-19-1977 -  
593 Value- Twenty-Two Million Dollars Missing - Article VI Peace Friendship, Limits of Settlement Guadalupe  
594 Hidalgo & the United States of America  
595 General Services Administration Bonds 276-278 held by Solomon Oliver Jr. Trustee IRS Form 56,  
596 Michael White, Sarah Peloquin,  
597 Twenty-One Silver Release Bonds 1922 held by Solomon Oliver Jr. Michael White, Sarah Peloquin  
598 Trustee IRS Form 56  
599 Steve A. Hicks, Defendant-Appellant. No. 01-30146. D.C. No. CR-00-00001-DWM  
600 22 U.S.C. § 2657 - U.S. Code - Unannotated Title 22. Foreign Relations and Intercourse § 2657. Custody  
601 of seals and property.  
602 **SOUTHERN CALIFORNIA CO-OPERATIVE WAREHOUSE AN SHIPPING ASSOCIATION**  
603 Pacific Coast Steamship Company Bond of Moya Jarvis Wicks Surety  
604 Bond of Milton L. Wicks Surety Bond of Assignee Michelle Article Gardner Surety  
605 Bond of Moses. Jarvis Wicks Surety Bond of Gilbert Mendez Caraballo Surety  
606 Bond of Moses Langley Wicks Surety  
607

608 **INDENTURES AND ACCOUNTING**

MAR 609 **SECURITY CONTROL AGREEMENT**  
610 Book 1564 of Judgment of Norcutt in favor of Jennie L. Wicks - Interest Rights to M.L. Wicks.

25

18

MAR

SAN JOAQUIN CALIFORNIA  
Book 428 PAGE Jennie W. Wicks Sale to M.L. Wicks 18947 judgment Book 1664 pg 17 value.

- 611 Book 319-page 47 Indenture- - Interest Rights to M.L. Wicks
- 612
- 613
- 614 Book 2-page 507 Wilmington Port 1871 David W. Alexander, B. D. Wilson, Banning, Jennie L Wicks
- 615 Wilmington
- 616
- 617 Book. 322-page 6070 Indenture Los Angeles - Interest Rights to M.L. Wicks
- 618
- 619 Book 400-page 292 Indenture Los Angeles - Interest Rights to M.L. Wicks
- 620
- 621 Book 512-page 38 Indenture Los Angeles - Interest Rights to M.L. Wicks
- 622
- 623 Book 587-page 90 Indenture Los Angeles 6507-90 - Interest Rights to M.L. Wicks
- 624
- 625 Book 579-page 90 Indenture Los Angeles - Interest Rights to M.L. Wicks
- 626
- 627 Book 1727-page 160 Indenture Los Angeles - Interest Rights to M.L. Wicks
- 628
- 629 Book 5542-page 88 Indenture Los Angeles - Interest Rights to M.L. Wicks
- 630
- 631 Book 68d page 100 Indenture Los Angeles - Interest Rights to M.L. Wicks
- 632
- 633 Book -page Indenture - Interest Rights to M.L. Wicks
- 634
- 635 Book -page Indenture - Interest Rights to M.L. Wicks
- 636
- 637 Book -page Indenture San Joaquin - Interest Rights to M.L. Wicks
- 638
- 639 Book -page Indenture - Interest Rights to M.L. Wicks
- 640
- 641 Book -page Indenture - Interest Rights to M.L. Wicks
- 642
- 643 Book -page Indenture - Interest Rights to M.L. Wicks
- 644
- 645 Book 14-page 748 Indenture Los Angeles - Interest Rights to M.L. W
- 646
- 647 Book 1069 of Deeds 98 / Monmouth County, New Jersey Margaret Chapman 560280953
- 648 Indenture - Interest Rights to M.L. Wicks

MAR

Book 1095 pg 204 of Deeds The Title Guaranty AND Trust Co M.L. Wicks

**ASSIGNMENTS AND MEMORANDUM OF UNDERSTANDING CONDITIONAL ACCEPTANCE**

- 653 Assignment of Wicks Treasury Trove of Assets CFAR Ranch 117046 -115088 Phillip Lemans Shiver Just
- 654 Compensation - Interest Rights to Percy L. Wicks
- 655
- 656 Assignment of Erick Fimbres Ramos - Interest Rights to M.L. Wicks
- 657
- 658 Assignment and Appointment of Edgar Ibarra Lozario - Interest Rights to M.L. Wicks
- 659
- 660 Assignment of Eugenio Clemente Pratts - Interest Rights to M.L. Wicks
- 661 John D. Stephens
- 662 Assignment of Special Visual Reporter Emanuel - Interest Rights to M.L. Wicks
- 663
- 664 Assignments Of M.J. Wicks Assigned to T.W. Temple - Interest Rights to M.L. Wicks
- 665
- 666 Benito Juarez - Interest Rights to M.L. Wicks

MAR

20

19

MR 2667

JAY BANKING House of JAY COOK M L Wicks

668	Porfirio Diaz	- Interest Rights to M.L. Wicks
669		
670	Louis Huller Jr. Estate	- Interest Rights to M.L. Wicks
671		
672	George Sisson	- Interest Rights to M.L. Wicks
673		
674	Santiago Arguello	- Interest Rights to M.L. Wicks
675		
676	Jose Arguello	- Interest Rights to M.L. Wicks
677		
678	Vicente Cantua TT of Monterey Claims Approved	- Interest Rights to M.L. Wicks
679		
680	Augustine F. Machado TT	- Interest Rights to M.L. Wicks
681		
682	David W. Alexander	- Interest Rights to M.L. Wicks
683		
684	Ramona Sepulveda	- Interest Rights to M.L. Wicks
685		
686	Vincente Sepulveda	Interest Rights to M.L. Wicks
687		
688	Antonio Lopez De Santa Anna	- Interest Rights to M.L. Wicks
689		
690	Hidalgo Guadalupe	- Interest Rights to M.L. Wicks
691		
692	Nicholas Phillip Trist	- Interest Rights to M.L. Wicks
693		
694	F.A. HYDE COMPANY	- Interest Rights to M.L. Wicks
695		
696	Giovanni Maria Mastai Ferretti	- Interest Rights to Moses Jarvis Wicks and M.L. Wicks
697		
698	George Hyde	- Interest Rights to M.L. Wicks
699		
700	Louisiana Purchase Henry Turner Claims Supreme Court	- Interest Rights to Eugene Turner El
701		
702	Florence Potts Wicks	- Interest Rights to M.L. Wicks
703		
704	A.W. Potts	- Interest Rights to M.L. Wicks
705		
706	C.W. Smith	- Interest Rights to M.L. Wicks
707		
708	Pacific Mutual Life Insurance Company Leland Stanford	- Interest Rights to Moye Jarvis Wicks
709		
710	Stanford Heights Subdivision San Francisco	- Interest Rights to Leland Stanford M.L. Wicks
711		
712	National Bank of D.O. Mills and Company 629 J Street Sacramento C	- Interest Rights to M.L. Wicks
713		
714	The Baltimore and Ohio Railroad Company D00520344	- Interest Rights to M.L. Wicks
715		
716	Joseph Wickes Huntington New York	- Interest Rights to M.L. Wicks
717		
718	Isle of Wight County Virginia Book 1,30 Hodges Council	- Interest Rights Mary F. Council
719		
720	Henry Edward Huntington	- Interest Rights to M.L. Wicks
721	The German and Savings and Loan	- Interest Rights to M.L. Wicks

27

70

722 Poindexter & Wadsworth Brokers - Interest Rights to M.L. Wicks  
 723 The Mutual Reserve Fund Life Association - Interest Rights to M.L. Wicks  
 724 John D. Spreckels - Interest Rights to M.L. Wicks  
 725 JOHN BICKNELL PROBATE

**CURRENT UNRESOLVED RELATED EMINENT DOMAIN CASES**

727  
 728 In the matters of CASE NO.: 11CV0949 JLS (POR) CASE NO.: 11CV0949 MMA(WMC), CASE NO.:  
 729  
 730 11CV0952LBGS, CASE NO.: 09CV2068BTM, CASE NO.: 09CV2069, CASE NO.: 37-2015-  
 731  
 732 00043366CCU-MC-CTL CITY OF SAN DIEGO, CASES C549523 CITY OF LOS ANGELES, C549524  
 733  
 734 CITY OF LOS ANGELES, BAC7419 11746 DOT 115788, DOT 964485 CITY OF  
 735  
 736 BELL, CASE NO.: C736241. <sup>SUMMA TREN</sup> ~~CHIRNSIDE~~ CHIRNSIDE.: RELEASE OF VESSEL GILBERT MENDEZ CUSIP

737 # FOCPIX & BOND.  
 738  
 739 ~~CERTIFICATE OF DEPOSIT~~ BAC 74193 - LAVERNE  
 740

**AUTHENTICATED AFFIDAVITS OF CUSTODIAN OF RECORDS, RE CASE FILE UNAVAILABLE OR PUBLIC INSPECTION**

744	Case P58439	M.L. Wicks Jr.	Probate / Missing
745	-----		
746	Case:	M.L. Wicks	Probate / Missing
747	-----		
748	Case P057729	M.L. Wicks Jr.	Trust / Missing
749	-----		
750	Case	M.L. Wicks Jr	Probate / Missing
751	-----		
752	Case C549524	Jennie L. Wicks	Community Redevelopment Agency/ Missing
753	-----		
754	Case C549524	Jennie L. Wicks	Timothy J. Chung / Missing
755	-----		
756	Case C549523	Victor Beaudry et, al	Community Redevelopment Agency/ Missing
757	-----		
758	All Cases Unknown to Claimants	Interest Rights to Moye Jarvis Wicks Trust, Mumina A. Rahman	

**STATE OF CALIFORNIA SECRETARY OF STATE REGISTRATION OF CLAIM AS SUCCESSOR IN-INTEREST CIVIL CODE Section 3344.1**

763 2016-057 -- Authenticated Certified  
 764 2017-10004 -- Authenticated Certified  
 765 2016-069 -- Authenticated Certified  
 766 2016-058 -- Authenticated Certified

768 All Extraordinary Claims are due in lawful money payable in gold & silver as proclaimed before the  
 769 ACT of Congress, House Joint Resolutions' 192 in the year of 1933 as it applies to all judgment's  
 770 residual claims, indentures, orders and resolved or unresolved,

MAR 771 SPS TRUS DEED LAWRENCE E. MUELLER JR T.  
 MAR 772 ~~INTERESTS~~ MAPS SURVELLS  
 773  
 774  
 MAR 775 PUBLICATIONS  
 MAR 776 Patents LIBS LAB BRADP

28

21

777  
778

**TRUST & CONTRACTUAL ASSIGNMENTS OF CLAIMS 31 U.S. Code 3727  
OPERATION M.L. WICKS THROUGHOUT THE WORLD AND SPACE**

779 Northern and Southern, the County of San Diego , United Mexican States, Department of/  
780 State Department, Attorney General's Office in the District of Columbia. who continuously became  
781 aware of certain Unresolved Assets for recovery and release by the Courts of Justice. Our Interest  
782 are in diverse places.  
783  
784

785

**DEBTORS OF M.L. WICKS TRUST**

786 Henry Edwards Huntington, Huntington Partnerships, The Maguire Partnership Inc, 1800 Century  
787 Park East and 550 Hope Street Los Angeles, California, 1010 Wilshire Los Angeles, California ,  
788 123 FIGUEROA Los Angeles, California , Engstrom Partnership 623 Fifth Street Los Angeles,  
789 California, Peters Landing, C.L. Peck Contractors, Forty Thieves at 225 Broadway New York ,NY,  
790 BANK OF ITALY aka Bank of America ,individually Lloyd John Sugaski Estate, Edward Helfeld  
791 Estate , Arnold Wisper Estate, Library Square Associates , Ltd, ,Douglas Gardner, Nelson C.  
792 Rising, Rising Realty Partners Lic 200617310055, Rising Realty Partners GP, Inc, Catellus  
793 Development Corporation, Catellus Development ,Lic, Estate of John D. Bicknell, GIBSON , DUNN,  
794 CRUTCHER LLP, Russel Lloyd Johnson #29240, O'Melveny & Myers, C0581066 Martin S. Checov ,  
795 Thomas Properties, Inc, C0745758, Steer Davis Gleave acting , Laurence S. Markowitz, Onni  
796 California Lic, Onni 800 Wilshire Llp ,Rossano De Cotlis Individually, at 200 Lasalle Chicago Ill,  
797 2200 East Camelback Road Phoenix Arizona, Olympia & York/OM&M Holding Company, Olympia  
798 &York California Development Company C0947179, Olympia &York Wilshire Holding Company,  
799 237 Park Avenue New York, MGP X Olympia II Lic, 201631910371, 425 California Street San  
800 Francisco California, Olympia & York Homes Corporation, C0951400, 200 Vesey Street New York,  
801 G. Mark Brown, Pembroke Lane, Inc ,C0631677, 333 S. Grand Avenue Los Angeles  
802 California ,John C. Cushman, John C. Cushman III, Comcast Corporation, Cushman Wakefield Lic  
803 Cushman Realty Corporation, Fainting Goats Lic 201216710199, Brookfield DTLA Fund Office  
804 Trust, Inc, Richard S. Volpert ,Metro Exposition Metro Line Construction Authority ,LA Commons,

29

2



833 Michelson Manager, Llc, 201112610074, Phil Choi, Maguire Properties-2600 Michelson, Llc, MPG  
834 OFFICE TRUST ,individually Jonathan L. Abrams, IPAC Mortgage Holdings, Inc C1959663,  
835 Southern Pacific Secured Assets Corp C1932449, individually Kasey Hannah, CBRE Strategic  
836 Partners U.S. Value 8 REIT Operating, LP individually John M. Gilb, Security Capital Industrial  
837 Management, Corp C2054925 Jeffery A. Klopff, Catellus Commercial Development, Corp  
838 C1516431, Catellus Development ,Corp C11264889, Santa Fe Pacific Realty, Corp, L.W.Telford,  
839 1264889 Delaware, Catellus Gateway, Inc 1520457 Catellus Commercial Development, Corp  
840 C1516431, Eileen M. Malley, Catellus Residential Financial Corp C1804147 Robin Bennet 2049  
841 Century Park East PROGILIS Inc AMB Property Corp, S. Davis Carniglia, AMB Property Corp  
842 C2061707 Hamid R. Moghadam, Summa Corp, Howard B Hughes, O'Melveny & Myer ,Perry  
843 Lerner, 3161 Michelson Drive Llc, Los Angeles Title Insurance Company C0019523, Ticor Title  
844 Insurance Company, Chicago Title Insurance Company 001088508, Fidelity National Financial, Inc  
845 C1601793 Edward Crosby Johnson I, Edward Crosby Johnson II, Edward Crosby Johnson III,  
846 Abigail Pierrepont Johnson, FMR, LLC, 043532603 ,individually Abigail P. Johnson, Vornado Realty  
847 Trust, at 555 California Street, San Francisco California, Shorenstein MB, Inc, KPMG Corporate  
848 Finance ,LLC, Donna Stroberg, Metropolitan Transportation Authority New York, National Railroad  
849 Passenger Corporation C0194028 ,individually Peter J. Davoren ,Turner Construction, Baja  
850 California Rail Road Inc, C2598210 ,San Diego Transit Corporation C0511662 ,Rock -Bunker,  
851 Inc ,Rockefeller Realty Corporation, One Bunker Hill Company, Central Plants, Inc, Fred C. Trump,  
852 Cadillac Fairview/ California, Inc ,Peter J. Barbeta, Irvine Company, Llc , United Parcel Service,  
853 Metropolitan Transportation Authority, Metropolitan Transportation Authority METRO of Los  
854 Angeles, Metropolitan Museum of Art, Met, Mexican National Railways, Ferrocarril Sonora Baja  
855 California, Kenneth Jowdy, Fernando Manuel Garcia Campuzano, Davis Love II ,Centro Turístico  
856 El Consuelo SA. DE PR. R. I, LOR Management S. A D.E.CV., Najam William Jowdy , DIAMANTE  
857 CABO SAN LUCAS ,DCSL, DIAMANTE DEL MAR ,LLC, KSI CAPITAL CORPORATION,  
858 DESARROLLADORA DDM S.DE CV., INMOBILIARIA DDM S. DE R.I., Teodoro Valladelid Dc,  
859 Sergio Martinez Espinoza, Manuel Valladelid Dc, Maria Elena Espinoza Vdade, Mt, Alicia Espinoza  
860 Vada de Marquez, FCa Espinoza Vda Martinez, Zoila Rosa Espinoza de Vda Espinoza, Maria Garcia

(930)

23

861 Vda de Duarte, Cecilio Aguilar Duarte. Pedro Munoz Saucedo, Grupo 8 Heiberto Duarte Duarte,  
862 Jesus Manuel, Alhumada Duarte, Leobardo Espinoza Duarte, UNIDAD ESPECIALARES AGRIA y  
863 GRANADERA K8, Hector de la Toba Duarte, Presidente Grupu Consuelo, Violeta De Latoba  
864 Lucero, Maria Guadalupe Soledad Lucero, International Gateway of Americas, Llc, Gateway Retail  
865 Group, Llc, International Gateway Associates, Llc, Latham Watkins 701 B Street, LAND GRANT  
866 DEVELOPMENT UNLIMITED C1783132, C. Samuel Marasco, CROSS BORDER XPRESS E-510523  
867 CHULA VISTA ,CA 91910 736 BEECH AVENUE, EDWARD K. KUBOTA, ,DEWESTANDARD  
868 &POORS FINANCIAL SERVICES ,LLC, INTERNATIONAL GATEWAY ASSOCIATES,LLC,RBF  
869 CONSULTING aka HUDSON PACIFIC PROPERTIES,INC,CSX MINERALS,INC F00432328 CLEVELAND OHIO THE  
870 BALTIMORE OHIO RAILROAD D00520304,,BURLINGTON NORTHERN SANTA FE LLC 27-4754839  
871 2462318,BNSF, THE BANK OF NEW YORK MELLON TRUST COMPANY,NA,SOUTHER PACIFIC  
872 SECURED ASSETS C1932449 ,SOUTHERNPACIFIC TRANSPORTATION COMPANY AKS UNION  
873 PACIFICRAILROAD COMPANY 284900,SOUTHERN PACIFIC RAIL CORPORATION,SOUTHERN  
874 PACIFIC LAND CORPORATION C1896901,CITY OF YUMA MUNICIPAL PROPERTY CORPORATION  
875 Individually Donald Wicks, LOS ANGELES TRANSIT ,LLC,LOS ANGELES JUNCTIONRAILWAY  
876 COMPANY, C0104097,John F. Curry, GERALD S.DAY, CORETRUST CAPITAL, INC C3696318  
877 Thomas Ricci CORE GROUPFUND LP,TPGI 550 Hope Street Los Angeles ,California CORE  
878 TRUST CAPITAL C3696318, COREGROUP CAPITAL PARTNERS 201527100020, CORE TRUST  
879 MANAGEMENT ,INC C3962367,COREGROUP FUND,LP 201527100021,CVFI-444S FLOWER,  
880 LP ,Prison Realty Corporation aka Corrections Corporation of America Prison Realty Trust, Inc,  
881 aka CoreCivic,Inc,2124250  
882  
883 Release of Monies held by All District Courts CRIS Accounts, Security Account Control  
884 Agreements, Indentures, U.S. Treasury Accounts, Department of Energy Accounts, per ,  
885 Memorandum Of Understanding through Patents and Intellectual Property Rights by the  
886 Department of Interior, Judgments., Utilizing Executive Order-13565

(31)

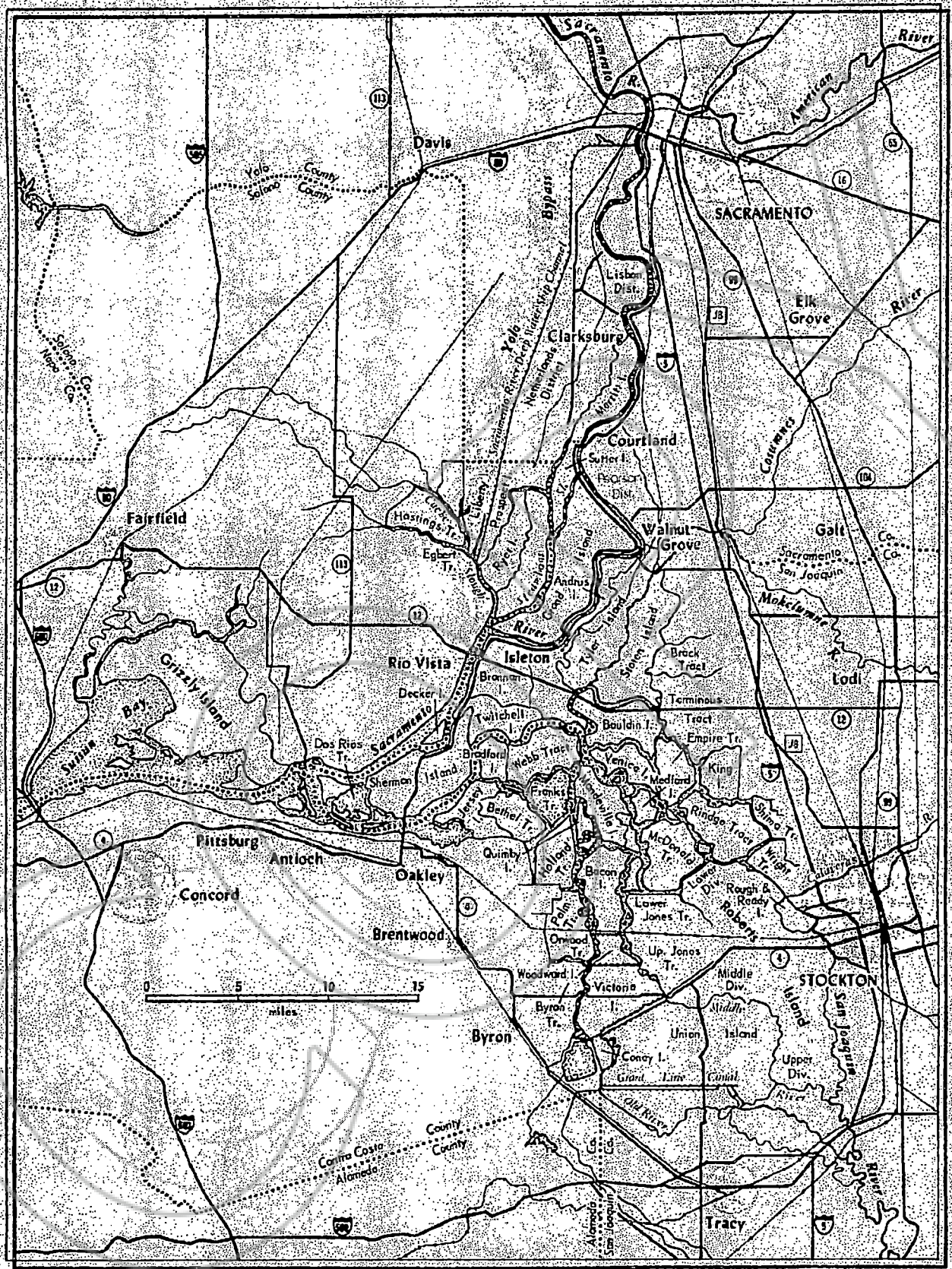

**Map of the Sacramento-San Joaquin Delta.**  
 Courtesy John Thompson.

22

887

888 OPERATION M.L. WICKS System22

889 Assignee Erick Fimbres Ramos

890 Assignee UNDERWRITING TITLE SERVICES TR

891 Special Minister/Administrator Edgar Ibarra Lozano

892

893

894

895

896

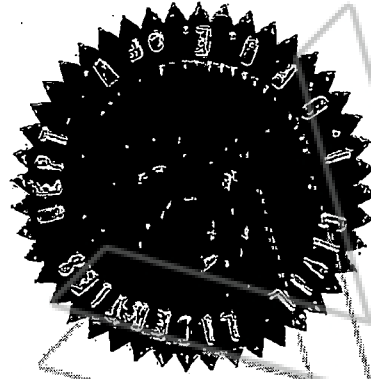

Moye Jarvis Wicks Family Trust TT  
Moye Jarvis Wicks  
By Assignee Mumina A. Rahman.



897

898

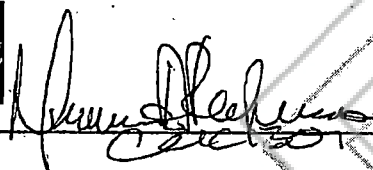
899

900 A notary public or other officer completing this certificate verifies  
901 only the identity of the individual who signed the document to which  
902 this certificate is attached, and not the truthfulness, accuracy, or validity  
903 of that document.

904 ACKNOWLEDGMENT

905

906

State of California County of Tulare

907

908

On Aug 7<sup>th</sup>, 2020 before me,

909

910

Maninder Kaur, Notary Public (insert name and title of the officer)

911

912

913

914

915

916

917

918

919

personally appeared Mumina Abdur Rahman, who  
proved to me on the basis of satisfactory evidence to be the person(s) whose name(s) is/are subscribed  
to the within instrument and acknowledged to me that he/she/they executed the same in his/her/their  
authorized capacity(ies), and that by his/her/their signature(s) on the instrument the person(s), or the  
entity upon behalf of which the person(s) acted, executed the instrument.

I certify under PENALTY OF PERJURY under the laws of the State of California that the foregoing  
paragraph is true and correct.

920

921

922

WITNESS my hand and official seal.

923

924

925

926

Signature  (Seal)

927

928

929

930

931



(3)

14

# CERTIFICATION OF COPY

State of Nevada }  
County of Lincoln } ss.

I, Amy Elmer, the duly elected, qualified and acting County Recorder of Lincoln County,  
in the State of Nevada, do hereby certify that the foregoing is a true, full and correct copy  
of the original PARCEL MAP  
now on file in this office,  
in Book A of PLATS Page 14  
as Document Number 926

IN WITNESS WHEREOF, I have set my hand and  
affixed the Seal of my office, in Pioche, Nevada,  
on Thursday, October 01, 2020 at 10:01 AM

  
Amy Elmer

Recorder

Amanda Kulani

Deputy Recorder

Krysten Elizondo

Deputy Recorder

LINCOLN COUNTY RECORDER/AUDITOR  
OFFICE OF AMY ELMER  
PO BOX 218 PIOCHE, NV 89043  
PHONE (775)962-8076 FAX (775)962-5482

34

54

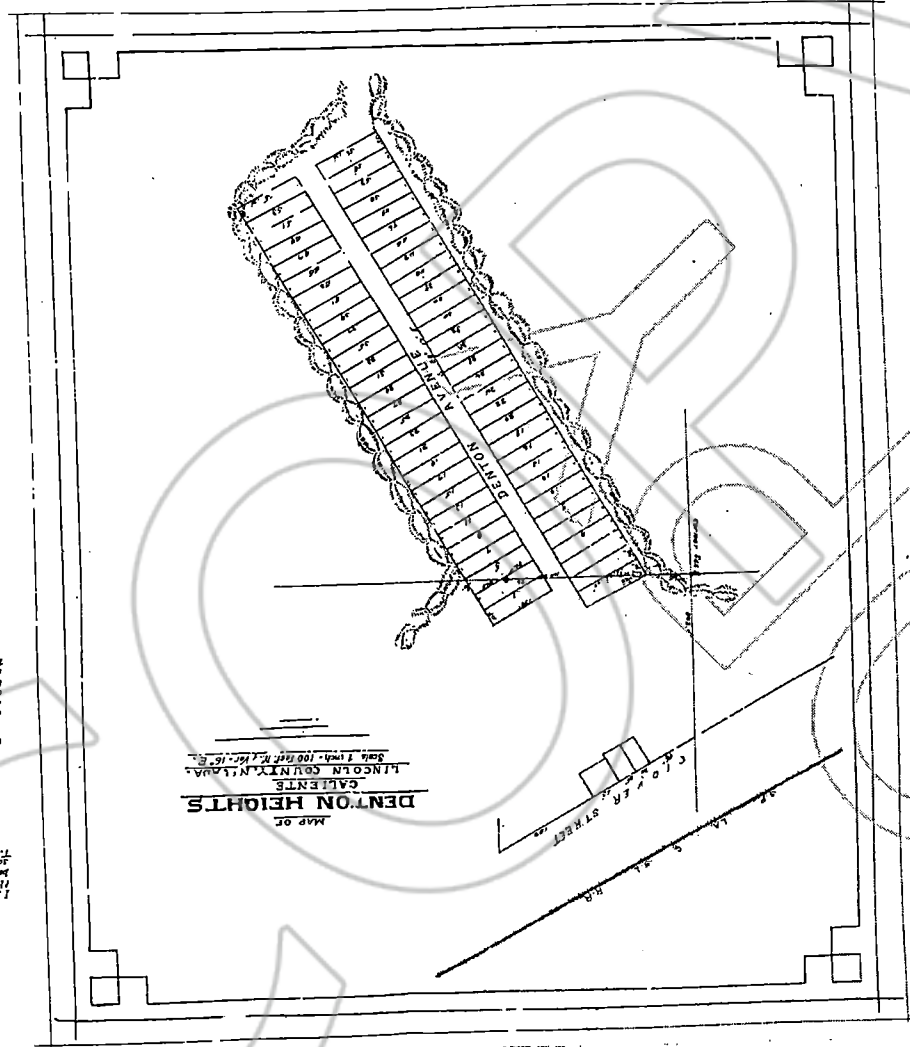

MAP OF  
DENTON HEIGHTS  
CABIENTE  
LINCOLN COUNTY, LOUISIANA  
Scale 1 inch = 100 feet N. 16° E.

No. 27  
Filed and approved at request of  
J. J. Denton, Sheriff of Lincoln County, Louisiana,  
this 15th day of February, A. D. 1904.  
J. J. Denton, Sheriff of Lincoln County, Louisiana.  
In Book \_\_\_\_\_ of the Public Records of Lincoln County, Louisiana, page \_\_\_\_\_.

The town and parishes of Louisiana, State of Louisiana, Sheriff of Lincoln County, State of Louisiana, do hereby certify that the above described land is the same as that shown on the plat of the Denton Heights, Cabiente, Lincoln County, Louisiana, filed in the Public Records of Lincoln County, Louisiana, on the 15th day of February, A. D. 1904, and that the same is now being offered for sale by public auction.

On the 15th day of February, A. D. 1904, the Denton Heights, Cabiente, Lincoln County, Louisiana, was divided into lots numbered 1 through 100, as shown on the above described plat, and the same are now being offered for sale by public auction. The lots are of various sizes and shapes, and are situated in the town of Denton Heights, Cabiente, Lincoln County, Louisiana. The plat of the Denton Heights, Cabiente, Lincoln County, Louisiana, is on file in the Public Records of Lincoln County, Louisiana.

I, J. J. Denton, do hereby declare that this is a true and correct copy of the original plat of the Denton Heights, Cabiente, Lincoln County, Louisiana, as filed in the Public Records of Lincoln County, Louisiana, on the 15th day of February, A. D. 1904, and that the same is now being offered for sale by public auction.

Dated February, 1904.  
J. J. Denton, Sheriff of Lincoln County, Louisiana.  
In the presence of \_\_\_\_\_  
\_\_\_\_\_

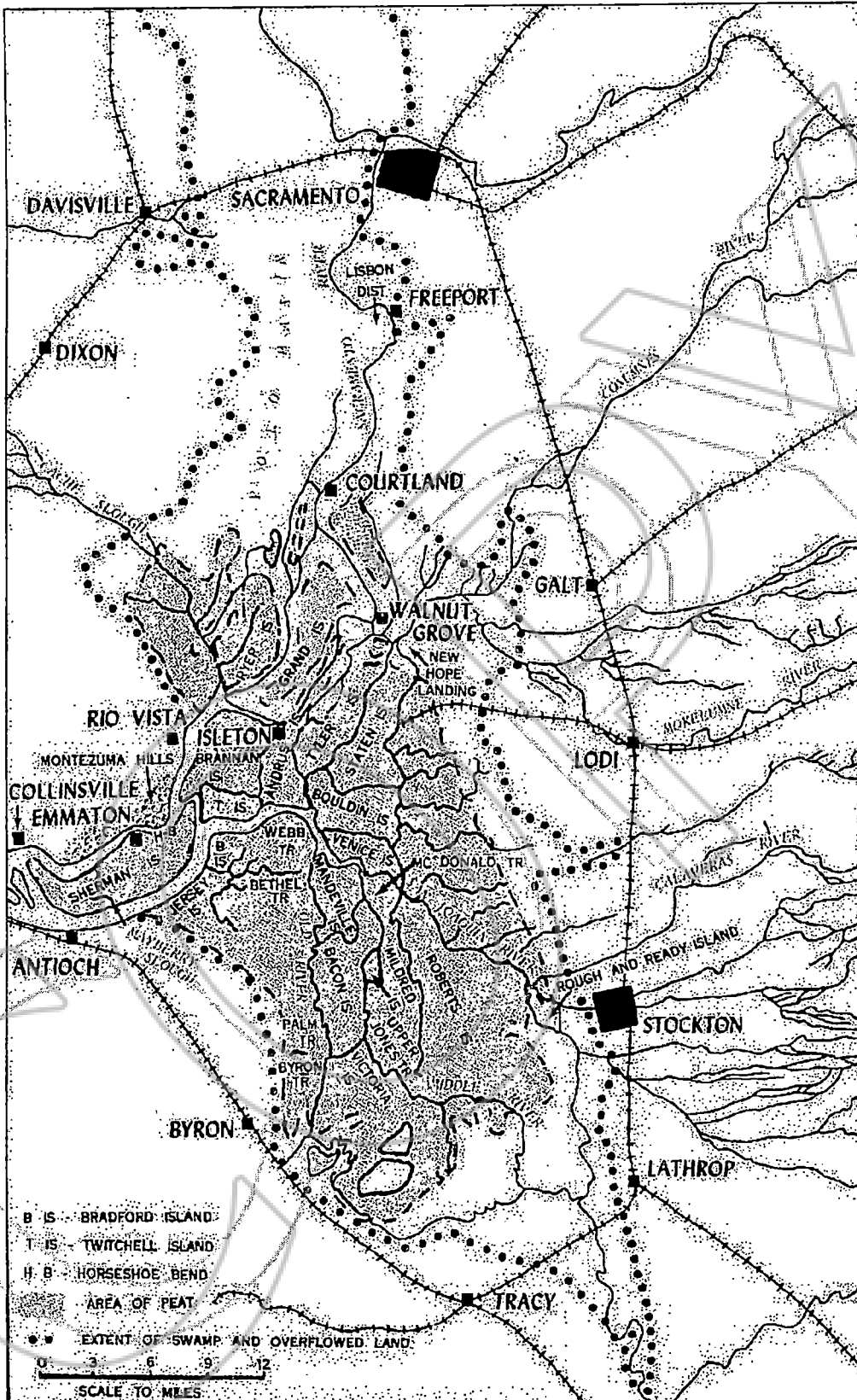

*This map illustrates the "pristine delta" of the 1880s before largescale reclamation. Note the changes to Sherman Island, as seen in the map on page 42.*

Courtesy of John Thompson

36

**Figure 3 California Major Reservoirs and Conveyance Facilities**

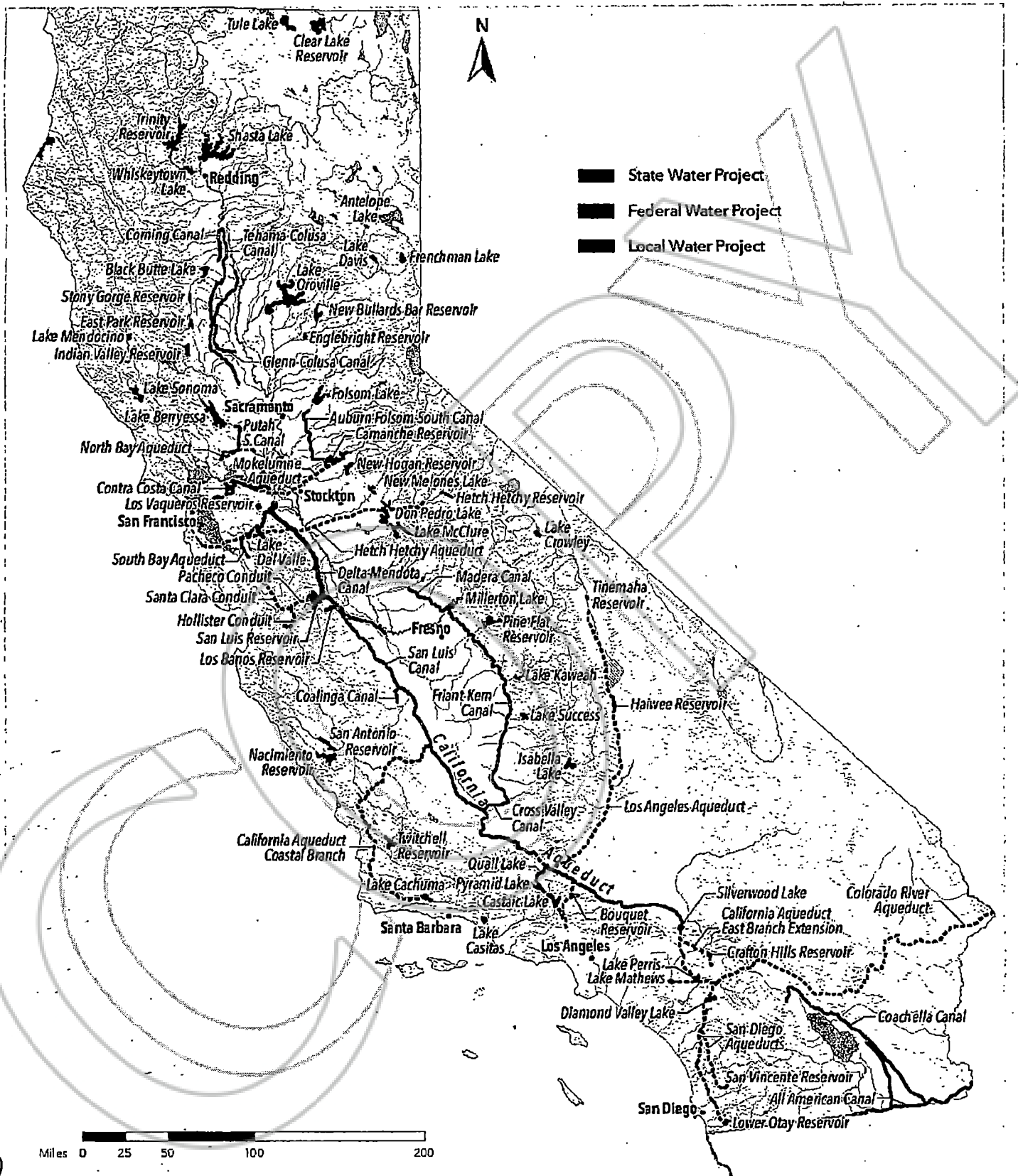

31

Federal, state, and local governments have built separate systems of dams, reservoirs, and conveyance facilities to move water to cities and farms and provide flood protection. This map shows the largest such facilities.



ACTUAL

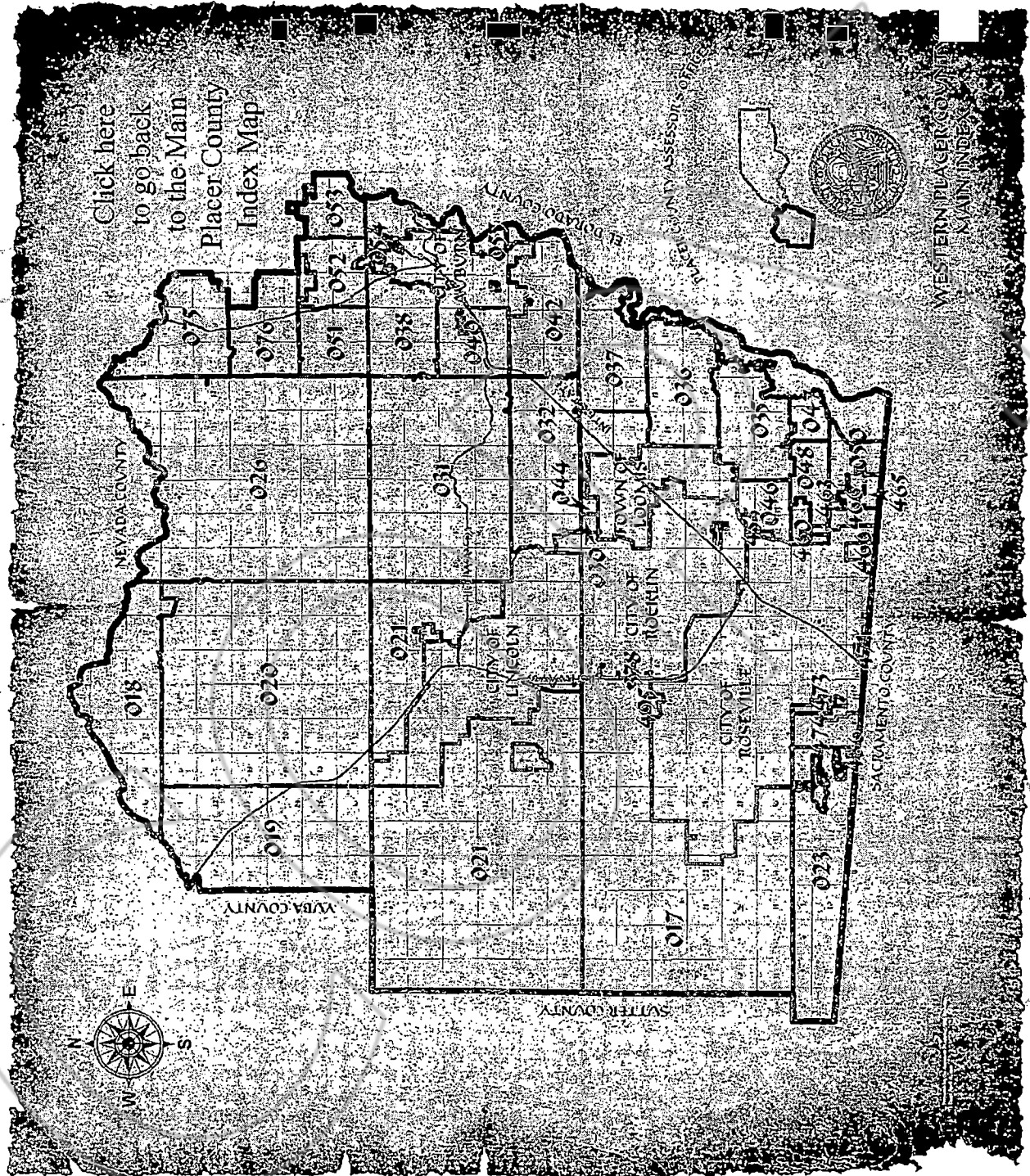

72

3

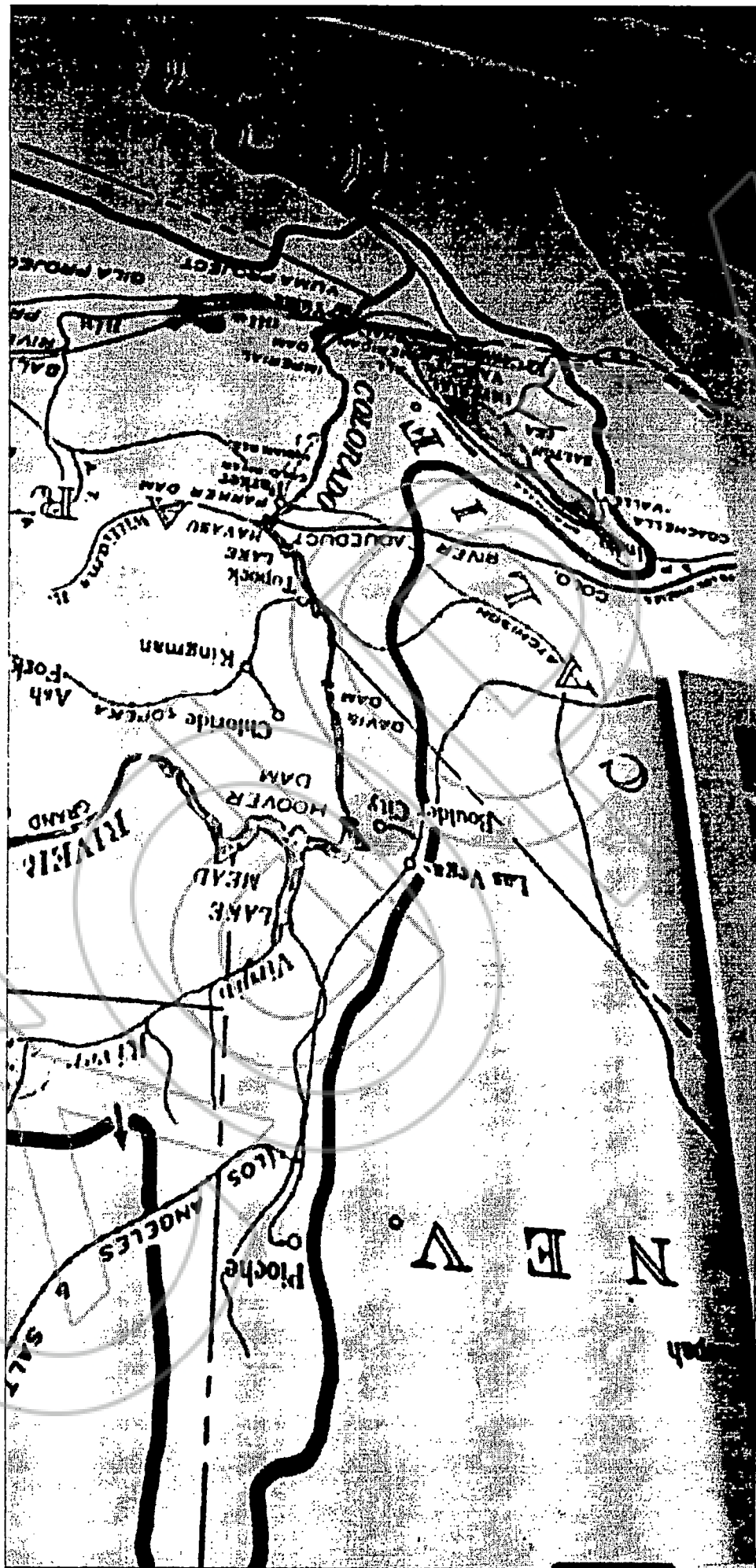

— THE —

# New Railroad Center!

## Junction of the Two Great Railway Systems

OF THE PACIFIC COAST.

The A. T. & S. F.'s Ballona Road and the S. P. R. R.

### TWELVE TRAINS DAILY!

The Electric Railroad, Now Building to Florence, Passes the East Boundary of the Tract, and the Central Avenue Horse-Car Line, also Under Construction, will Run Near the West Boundary.

### ONLY FIVE MILES FROM THE CITY PLAZA

**BOARD OF DIRECTORS:**

M. L. WICKS, C. E. FRENCH, JAMES CAMPBELL, E. A. CLARKE, J. W. GARDNER,  
S. D. NORTHCUTT, C. C. DAVIS, C. N. WILSON.

We Guarantee Two Lines of Railroad, with at Least Twelve Trains Daily; Water piped to Every Lot; Graded Streets; Cement Sidewalks; Rapid Advance in Values. Do You Want Anything Else?

San Diego Union and Daily Bee, Volume XXXVI, Number 8363, 8 November 1891 — Page 6 Advertisements Column 6 [ADVERTISEMENT]

Back

**LINES OF TRAVEL.**

**SOUTHERN CALIFORNIA RAILWAY.**

**SANTA FE ROUTE**

The only route running cars without change from San Diego to the east. Time Table in effect Sunday, April 29, 1891.

Northward.		STATIONS.	Southward.	
Ar. Daily.	Dept. Daily.		Ar. Daily.	Dept. Daily.
8:35 p.	7:10 a.	lv. National City.	8:20 p.	1:15 p.
4:00 p.	7:40 a.	San Diego.	8:00 p.	12:50 p.
5:40 p.	9:17 a.	Oceanside.	6:20 p.	11:15 a.
7:50 p.	11:02 a.	Santa Ana.	4:15 p.	9:28 a.
7:57 p.	11:10 a.	Orange.	4:10 p.	9:20 a.
9:00 p.	12:10 p.	Los Angeles.	3:05 p.	8:15
.....	1:05 p.	San Bernardino.	2:15 p.	.....
.....	12:38 p.	Riverside.	2:41 p.	.....
.....	12:55 p.	Colton.	2:24 p.	.....
7:20 p.	.....	ar. Escondido.	.....	7:05 a.
.....	5:40 p.	San Jacinto.	.....	12:00 p.

\*Trains to and from Escondido and San Jacinto daily except Sunday.

DAILY SERVICE, San Diego to Chicago and Kansas City without change of cars. Pullman and Tourist Sleeping Cars on all through trains. Only one change of cars to New York, Boston, Philadelphia, etc. Through tickets to all points in the United States, Canada, Mexico and Europe. For rates on freight and tickets address agents at local stations or

- K. H. WADE, Gen'l Manager, Los Angeles, Cal
- W. B. BEAMER, Supt, San Bernardino, Cal.
- E. B. HYNES, G. P. & P. A., Los Angeles, Cal
- H. B. KEELER, Agent, San Diego, Cal.

**GENERAL FREIGHT AND TICKET AGENCY OF THE SOUTHERN PACIFIC COMPANY.**

Through tickets for all the principal railway and steamship lines. Reservation secured for Pullman Palace Sleeping Cars. All information given at the General Office, 921 Fifth street, San Diego, Cal.

- G. H. McMILLAN, City Ticket Agent.
- RICHARD GRAY, Gen'l Traffic Manager.
- T. H. GOODMAN, Gen. Pass. & Ticket Agt.
- A. N. TOWNE, General Manager.

**CORONADO RAILROAD---BAY BELT LINE.**

Time Card No. 10--Sept. 1, 1890.

**For National City.**

Fare inside city limits 5 cents, and 10 cents between San Diego and National City.

Train leave foot of Fifth street, San Diego at 11 a. m. and 3 and 6:10 p. m.

Leave National City for San Diego--7:35 and 10:30 a. m. and 2:30 and 5:35 p. m.

**Around the Bay.**

Fare 60 cents between San Diego and Hotel del Coronado, and 65 cents between San Diego and Coronado ferry wharf.

41

Trains leave foot of Fifth street, San Diego, for Coronado at 8 and 11 a. m., 3 and 6:10 p. m.  
 Leave Coronado Ferry Wharf for San Diego at 6:50 and 9:30 a. m., 1:30 and 4:50 p. m.  
 All "Around the Bay" trains pass through National City, Chula Vista, La Punta, South San Diego and Coronado Heights.

E. S. BABCOCK, Presiden  
 T. FITZGERALD, General Superintendent.

**SAN DIEGO, CUYAMACA & EASTERN.**

Time Card No. 7—July 5, 1891.

Trains leave foot of Tenth street at 9:10 a. m. and 5 p. m. for Richland, Spring Valley, Allison, Ft. Robinson, Cajon, Cowles, Riverview, Lakeside, Moreno and Foster, daily except Sunday. Leave Foster 6:45 a. m. and 2:15 p. m. Stage connections at Foster and Lakeside.

Sunday trains leave San Diego 9:30 a. m. and 5:45 p. m. Leave Foster 7:30 a. m. and 3:45 p. m. Trains stop at Mt. Hope Cemetery on Sundays and Thursdays for passengers.

WALDO S. WATERMAN, Gen. Mang.  
 A. E. KINNEY, Superintendent.

**PACIFIC COAST STEAMSHIP COMPANY.**

Dispatch Steamers as follows:

From San Francisco for San Diego.

QUEEN—Nov. 5, 14, 23, at 11 a. m.

CORONA—Nov. 9, 18, 27, at 11 a. m.

From San Diego for San Francisco.

QUEEN—Nov. 8, 17, 26, at 5 p. m.

CORONA—Nov. 3, 12, 21, 30, at 5 p. m.

F. M. SIMPSON, Agent.

**SAN DIEGO, OLD TOWN & PACIFIC BEACH RAILWAY CO.**

Time Table in effect Sunday, Oct. 25, 1891. Trains leave San Diego daily, from D and Arctic streets, for Old Town, Moreno, Driving Park, Rose Canyon, Asbestos Works, College and Pacific Beach—9:00 a. m., 1:30 p. m., 5:10 p. m. Leave Pacific Beach for San Diego and way points daily, except Sunday—7:30 a. m., 12:00 m., 4:00 p. m. Sunday leave Pacific Beach—8:00 a. m., 12:00 m., 4:00 p. m. Daily stage to La Jolla and Ocean Beach, connecting with the 9:00 a. m. train from San Diego; returning in time to connect with the train leaving Pacific Beach at 4:00 p. m. Round Trip Tickets—San Diego to Pacific Beach, 25 cents; San Diego to Old Town, 15 cents; Ocean Beach, 65 cents; La Jolla-Caves, 75 cents. JERRY TOLES, Pres't and Manager.

**THE LOWER CALIFORNIA DEVELOPMENT CO.**

Steamer Carlos Pacheco will call for Ensenada and San Quintin as follows:

San Diego to Ensenada only, Nov. 3, 10, 17 and 24.

San Diego to Ensenada and San Quintin Nov. 5 and 19.

Ensenada to San Diego, Nov. 4, 8, 11, 18, 22 and 25.

Ensenada to San Quintin, Nov. 6 and 20.

Above dates are subject to change without notice.

**Notice to Shippers of Freight to Lower California.**

Will take freight to Ensenada for \$5.00 U. S. coin, per ton, and lumber \$6. U. S. coin, per 1,000 feet, including the hauling at Ensenada from steamer to the custom house. Manifests will remain open until 10 a. m. day of sailing.

For freight and passenger rates apply to

F. A. HOLDS-WORTHY, General Manager,  
 Ticket office, 1022 Fourth street.

F. A. FLORES, Freight Agent,  
 755 Sixth street, San Diego

## NATIONAL CITY & OTAY RAILROAD.

Trains leave San Diego, foot of Fifth street, for National City—9 and 10 a. m., 1, 2, 4:05, 5:20 and 9:30 p. m. Returning arriving San Diego—8:34 and 9:30 a. m., 12:15, 1:50, 3:45, 5:00 and 7:25 p. m.

For Chula Vista—Leave San Diego at 10 a. m., 2:00, 4:05, 5:20, 9:30 p. m. Returning arrive San Diego—8:34 a. m., 1:50, 5:00, 7:25 p. m.

For La Presa and Sweetwater Dam—9 a. m., and 4:05 p. m. Returning arrive San Diego—12:15, 3:45 and 7:25 p. m.

For Tia Juana and Otay—10 a. m., 2, and 6:20 m.

For Omeonta—10 a. m.

Excursions to Tia Juana (Old Mexico) and Sweetwater Dam leaves San Diego at 10 a. m. every Wednesday, Saturday and Sunday. Round trip \$1.

GEO. J. LOCKIE, Gen. Mang.

BENJAMIN KIMBALL, President.

## ATLANTIC AND PACIFIC STEAMSHIP LINE.

The First-class American Steel Steamer

### MINEOLA,

(2,500 tons register)

Will be despatched from San Francisco for New York (via San Diego) about November 10th, 1891 to be followed by steamers "Mackinaw" and "Keweenaw."

For information apply to

CHILDS & WALTON, Agents,  
115 S. Main St., Los Angeles.

## SANTA FE ROUTE.

Southern California Railway.

Is the shortest line from Southern California to DENVER, KANSAS CITY, CHICAGO, BOSTON, New York and all Eastern cities.

Time from 12 to 24 hours quicker than any other line. Pullman Palace Sleeping Cars run through from SAN DIEGO to CHICAGO every day in the year.

Personally conducted Tourist Excursions through to Boston.

### Leave California Every Thursday.

Pullman Tourist Sleeping Cars used on these excursions are carpeted and curtained and supplied with mattresses, blankets, seats, pillows, and lunch tables. A Pullman porter is in charge of each car to attend to the comfort of our patrons.

Remember that the SANTA FE ROUTE makes 48 hours quicker time to Boston than any other line. Rates for these excursions are the LOWEST RATES MADE from California to the East.

For full information call on or address

H. B. KEELING, Agent, 4th and D sts., San Diego.

Or C. A. WARNER, Excursion Manager.

129 North Spring St., Los Angeles, Cal.

K. H. WADE, General Manager.

S. B. HYNES, Gen. Pass. Agt.

## \$500 REWARD.

We will pay the above reward for any case of Liver Complaint, dyspepsia, sick Headache, Indigestion, Constipation or Acidity, when the cure with West's Vegetable Liver Pills, when the directions are strictly complied with. They are

(4)

T2N R67E

006-301-15  
41, 240

R68E

01-30  
ALSO SEE  
Φ-3Φ

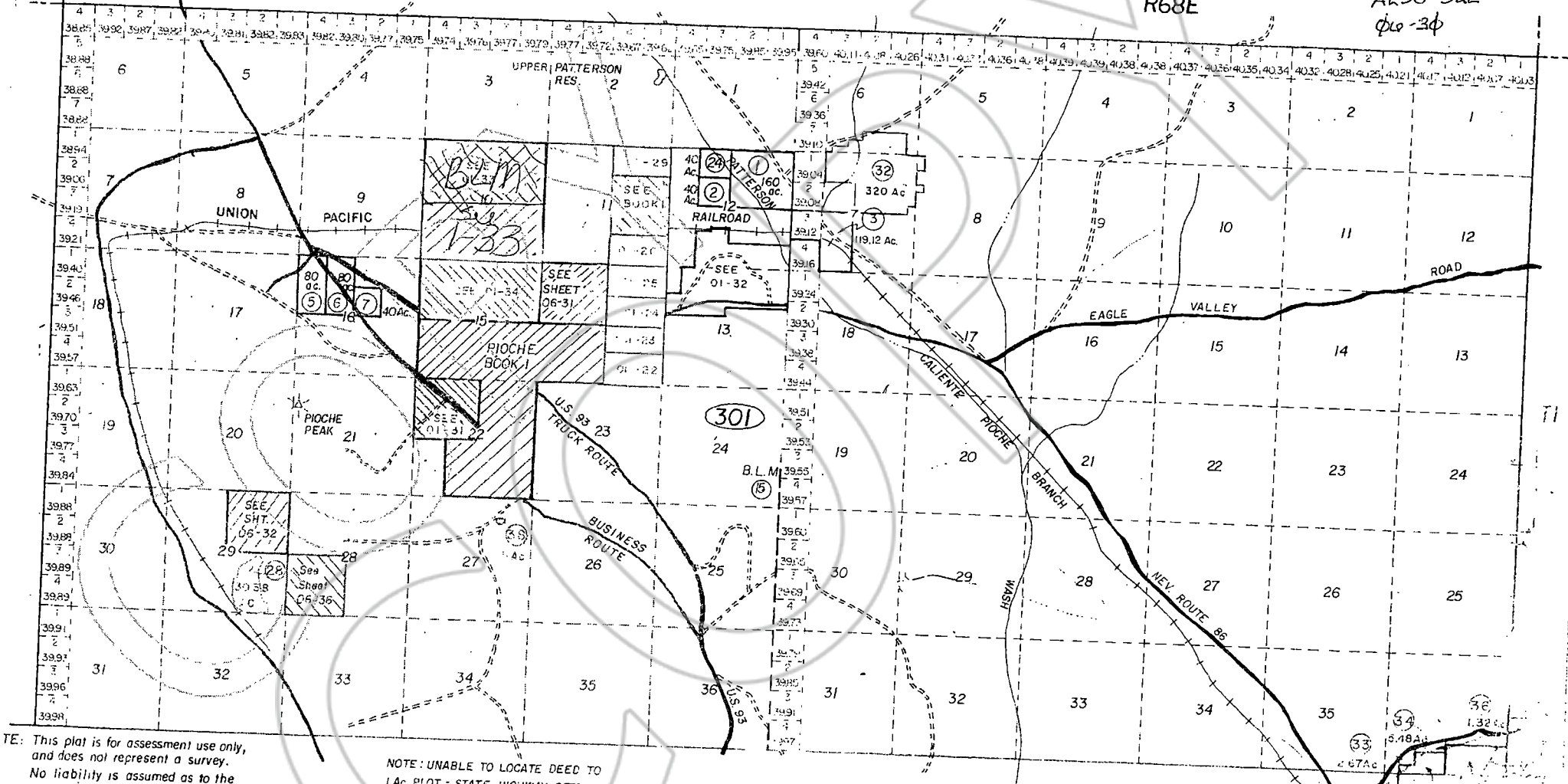

TE: This plat is for assessment use only,  
and does not represent a survey.  
No liability is assumed as to the  
accuracy of the data delineated  
hereon.  
NEVADA TAX COMMISSION

NOTE: UNABLE TO LOCATE DEED TO  
1 Ac. PLOT - STATE HIGHWAY DEPT.

Ek  
12

34  
3.48 A  
1.32 Ac  
35  
4.85 Ac

# CERTIFICATION OF COPY

State of Nevada }  
County of Lincoln } ss.

I, Amy Elmer, the duly elected, qualified and acting County Recorder of Lincoln County,  
in the State of Nevada, do hereby certify that the foregoing is a true, full and correct copy  
of the original DEED  
now on file in this office,  
in Book V of REAL ESTATE Page 28  
as Document Number ---

IN WITNESS WHEREOF, I have set my hand and  
affixed the Seal of my office, in Pioche, Nevada,  
on Wednesday, September 30, 2020 at 4:03 PM

**DESCRIPTION**

SAN PEDRO LA SALT LAKE R.R.  
GRANTOR

MAG HOLDINGS TRUST  
GRANTEE

AS FINALLY LOCATED THROUGH OVERLAP ACROSS  
WEST 1/2 OF NW 1/4 OF SECTION 12 T11N 20  
RANGE 01 E MT 17.13  
BEGINNING AT POINT IN N LINE OF NW 1/4  
OF SECT 12 OF SAID POINT BEING P1ST  
692 FT E OF NW 1/4 CORNER  
OF SEC 12, THENCE S 31 DEGREES  
AND 1 MIN, WEST 1385 FT, MORE OR LESS  
TO W LINE OF NW 1/4 OF SEC 12  
SAID STRIP OF LAND CONTAINING  
318 ACRES.

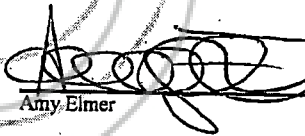

Amy Elmer

Recorder

Amanda Kulani

Deputy Recorder

Krysten Elizondo

Deputy Recorder

LINCOLN COUNTY RECORDER/AUDITOR  
OFFICE OF AMY ELMER  
PO BOX 218 PIOCHE, NV 89043  
PHONE (775)962-8076 FAX (775)962-5482

45



# CERTIFICATION OF COPY

State of Nevada }  
County of Lincoln } ss.

I, Amy Elmer, the duly elected, qualified and acting County Recorder of Lincoln County,  
in the State of Nevada, do hereby certify that the foregoing is a true, full and correct copy  
of the original DEED  
now on file in this office,  
in Book V of REAL ESTATE Page 44  
as Document Number ----

## DESCRIPTION

SPLA, SLRRO  
SW 1/4 of S.E. 1/4 of SEC 11 T2N 20 S. RANGE  
61 EAST LINCOLN COUNTY NEV.  
3.55 ACRES.

IN WITNESS WHEREOF, I have set my hand and  
affixed the Seal of my office, in Pioche, Nevada,  
on Thursday, October 01, 2020 at 8:40 AM

Amy Elmer

Recorder

Amanda Kulani

Deputy Recorder

*W. Justin Elizondo, Deputy*  
Krysten Elizondo  
Deputy Recorder

LINCOLN COUNTY RECORDER/AUDITOR  
OFFICE OF AMY ELMER  
PO BOX 218 PIOCHE, NV 89043  
PHONE (775)962-8076 FAX (775)962-5482

46

# CERTIFICATION OF COPY

State of Nevada }  
County of Lincoln } ss.

I, Amy Elmer, the duly elected, qualified and acting County Recorder of Lincoln County,  
in the State of Nevada, do hereby certify that the foregoing is a true, full and correct copy  
of the original DEED  
now on file in this office,  
in Book V of REAL ESTATE Page 46  
as Document Number ----

*Description*  
SPLA, SLRRO

GRANTOR

MAG HOLDINGS  
GRANTEE

SW 1/4 of SEC 9 T2N 21 S  
RANGE 61 EAST MT D B, M  
3.81 ACRES

IN WITNESS WHEREOF, I have set my hand and  
affixed the Seal of my office, in Pioche, Nevada,  
on Thursday, October 01, 2020 at 8:40 AM

Amy Elmer

Recorder

Amanda Kulani

Deputy Recorder

Krysten Elizondo

Deputy Recorder

*Krysten Elizondo*  
Deputy Recorder

LINCOLN COUNTY RECORDER/AUDITOR  
OFFICE OF AMY ELMER  
PO BOX 218 PIOCHE, NV 89043  
PHONE (775)962-8076 FAX (775)962-5482

47

# CERTIFICATION OF COPY

State of Nevada }  
County of Lincoln } ss.

I, Amy Elmer, the duly elected, qualified and acting County Recorder of Lincoln County,  
in the State of Nevada, do hereby certify that the foregoing is a true, full and correct copy  
of the original DEED  
now on file in this office,  
in Book V of REAL ESTATE Page 66  
as Document Number ----

*Description*

*S.P. LA # S L.R.R.  
GRANTORS*

*MAG HOLDINGS TRUST  
GRANTEE*

*SW 1/4 of SEC 34 T1N 20 S RANGE  
61 EAST MDB M LINCOLN COUNTY*

**IN WITNESS WHEREOF**, I have set my hand and  
affixed the Seal of my office, in Pioche, Nevada,  
on Thursday, October 01, 2020 at 8:40 AM

Amy Elmer

Recorder

Amanda Kulani

Deputy Recorder

Krysten Elizondo

Deputy Recorder

*KRISTEN ELIZONDO, Deputy*

LINCOLN COUNTY RECORDER/AUDITOR  
OFFICE OF AMY ELMER  
PO BOX 218 PIOCHE, NV 89043  
PHONE (775)962-8076 FAX (775)962-5482

48

# CERTIFICATION OF COPY

State of Nevada }  
County of Lincoln } SS.

I, Amy Elmer, the duly elected, qualified and acting County Recorder of Lincoln County,  
in the State of Nevada, do hereby certify that the foregoing is a true, full and correct copy  
of the original DEED  
now on file in this office,  
in Book V of REAL ESTATE Page 82 --  
as Document Number ----

## DESCRIPTION

SAN PEDRO LA SALT LAKE BR

GRANTOR

MAG HOLDINGS TRUST

NW QUARTER 1/4 of SW Quarter 1/4 of Sec  
27 TWN 1 South, RANG 68 EAST  
MT DIABLO. LINCOLN NEV

IN WITNESS WHEREOF, I have set my hand and  
affixed the Seal of my office, in Pioche, Nevada,  
on Thursday, October 01, 2020 at 8:38 AM

Amy Elmer

Recorder

Amanda Kulani

Deputy Recorder

*Krysten Elizondo*  
Krysten Elizondo  
Deputy Recorder

LINCOLN COUNTY RECORDER/AUDITOR  
OFFICE OF AMY ELMER  
PO BOX 218 PIOCHE, NV 89043  
PHONE (775)962-8076 FAX (775)962-5482

# CERTIFICATION OF COPY

State of Nevada }  
County of Lincoln } ss.

I, Amy Elmer, the duly elected, qualified and acting County Recorder of Lincoln County,  
in the State of Nevada, do hereby certify that the foregoing is a true, full and correct copy  
of the original DEED  
now on file in this office,

in-Book V of REAL ESTATE Page 95

as Document Number \_\_\_\_\_

*DESCRIPTION*

*SP LA ISLER  
GRANTOR*

*MAG HOLDINGS TRUST  
GRANTEE*

*N.W. 1/4 of NW 1/4 of SECT 24  
LINCOLN Nev  
3.03 ACRES*

IN WITNESS WHEREOF, I have set my hand and  
affixed the Seal of my office, in Pioche, Nevada,  
on Thursday, October 01, 2020 at 8:51 AM

Amy Elmer

Recorder

Amanda Kulani

Deputy Recorder

*Krysten Elizondo*  
Krysten Elizondo

*Krysten Elizondo*  
Deputy Recorder

LINCOLN COUNTY RECORDER/AUDITOR  
OFFICE OF AMY ELMER  
PO BOX 218 PIOCHE, NV 89043  
PHONE (775)962-8076 FAX (775)962-5482

# CERTIFICATION OF COPY

State of Nevada }  
County of Lincoln } ss.

I, Amy Elmer, the duly elected, qualified and acting County Recorder of Lincoln County, in the State of Nevada, do hereby certify that the foregoing is a true, full and correct copy of the original DEED

now on file in this office,

in Book V of REAL ESTATE Page 92-94

as Document Number -----

*Description*

*SIP. LA. ; SLIP RD  
GRANTOR.*

*MAG HOLDINGS TRUST*

*THE EAST 1/2 of SEC 12 TWN 1 NORTH  
RANGE 67 EAST THE SW 1/4 of  
SEC 7 TWN 1 N. RANGE 68  
EAST AND LOT 4 of NW 1/4  
of SEC 2 TWN 15 S, RANGE  
66 EAST  
LINCOLN NEVADA.*

IN WITNESS WHEREOF, I have set my hand and affixed the Seal of my office, in Pioche, Nevada, on Thursday, October 01, 2020 at 9:04 AM

\_\_\_\_\_  
Amy Elmer Recorder

\_\_\_\_\_  
Amanda Kulani Deputy Recorder

*Krysten Elizondo*  
\_\_\_\_\_  
Krysten Elizondo Deputy Recorder

LINCOLN COUNTY RECORDER/AUDITOR  
OFFICE OF AMY ELMER  
PO BOX 218 PIOCHE, NV 89043  
PHONE (775)962-8076 FAX (775)962-5482

(51)

# CERTIFICATION OF COPY

State of Nevada }  
County of Lincoln } ss.

I, Amy Elmer, the duly elected, qualified and acting County Recorder of Lincoln County,  
in the State of Nevada, do hereby certify that the foregoing is a true, full and correct copy  
of the original DEED

now on file in this office,

in Book V of REAL ESTATE Page 118-119

as Document Number

IN WITNESS WHEREOF, I have set my hand and  
affixed the Seal of my office, in Pioche, Nevada,  
on Thursday, October 01, 2020 at 9:03 AM

*Description*

*SP. LA 4 SL R R CO.*

*GRANTOR*

*MAG HOLDINGS TRUST*

*GRANTEES*

*NORTH 1/2 and SW 1/4 of  
SEC 30 T19N 19 SOUTH RANGE  
62 EAST MT DB. M. LINCOLN  
County*

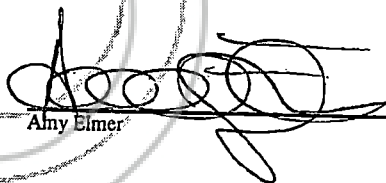
  
Amy Elmer Recorder

\_\_\_\_\_  
Amanda Kulani Deputy Recorder

\_\_\_\_\_  
Krysten Elizondo Deputy Recorder

LINCOLN COUNTY RECORDER/AUDITOR  
OFFICE OF AMY ELMER  
PO BOX 218 PIOCHE, NV 89043  
PHONE (775)962-8076 FAX (775)962-5482

(52)

# CERTIFICATION OF COPY

State of Nevada }  
County of Lincoln } SS.

I, Amy Elmer, the duly elected, qualified and acting County Recorder of Lincoln County,  
in the State of Nevada, do hereby certify that the foregoing is a true, full and correct copy  
of the original DEED  
now on file in this office,  
in Book V of REAL ESTATE Page 120-123  
as Document Number ---

IN WITNESS WHEREOF, I have set my hand and  
affixed the Seal of my office, in Pioche, Nevada,  
on Thursday, October 01, 2020 at 8:34 AM

Amy Elmer

Recorder

Amanda Kulani

Deputy Recorder

Krysten Elizondo

Deputy Recorder

LINCOLN COUNTY RECORDER/AUDITOR  
OFFICE OF AMY ELMER  
PO BOX 218 PIOCHE, NV 89043  
PHONE (775)962-8076 FAX (775)962-5482

DESCRIPTION

S.P.L.A. & SLRRO

MAC HOLDINGS TRUST  
NE 1/4 of NW 1/4 of Lots 2 & 3 of  
SEC 18 TWN 4 SOUTH RANGE  
67 EAST 1/4 of N.E. 1/4 of SEC 24  
TWN 4 SOUTH, RANGE 66 E  
MT D, 13 MERIDIAN  
LINCOLN COUNTY.

53



# CERTIFICATION OF COPY

State of Nevada }  
County of Lincoln } ss.

I, Amy Elmer, the duly elected, qualified and acting County Recorder of Lincoln County,  
in the State of Nevada, do hereby certify that the foregoing is a true, full and correct copy  
of the original DEED  
now on file in this office,  
in Book V of REAL ESTATE Page 124  
as Document Number

IN WITNESS WHEREOF, I have set my hand and  
affixed the Seal of my office, in Pioche, Nevada,  
on Wednesday, September 30, 2020 at 4:01 PM

Description

S P LA 1/2 RR

GRANTOR

MAG HOLDINGS TRUST

GRANTEE

SOUTH HALF 1/2 of NW 1/4 of  
SEC 34 and SE 1/4 of NE  
1/4 of SEC 33 TWN 20 SOUTH  
RANGE 01 EAST MT DIABLO  
LINCOLN COUNTY

  
Amy Elmer Recorder

Amanda Kulani Deputy Recorder

Krysten Elizondo Deputy Recorder

LINCOLN COUNTY RECORDER/AUDITOR  
OFFICE OF AMY ELMER  
PO BOX 218 PIOCHE, NV 89043  
PHONE (775)962-8076 FAX (775)962-5482

54

# CERTIFICATION OF COPY

State of Nevada }  
County of Lincoln } SS.

I, Amy Elmer, the duly elected, qualified and acting County Recorder of Lincoln County,  
in the State of Nevada, do hereby certify that the foregoing is a true, full and correct copy  
of the original DEED

now on file in this office,

in Book V of REAL ESTATE Page 137-138

as Document Number ---

IN WITNESS WHEREOF, I have set my hand and  
affixed the Seal of my office, in Pioche, Nevada,  
on Wednesday, September 30, 2020 at 4:00 PM

  
\_\_\_\_\_  
Amy Elmer Recorder

\_\_\_\_\_  
Amanda Kulani Deputy Recorder

\_\_\_\_\_  
Krysten Elizondo Deputy Recorder

DESCRIPTION  
SP. EA'S SLRR  
GRANTOR  
MAG HOLDINGS TRUST  
GRANTEE  
SW 1/4 of NE 1/4 of SEC 22 T20N20  
SOUTA RANGE 6E1 EAST MT DIXIE  
LINCOLN COUNTY

LINCOLN COUNTY RECORDER/AUDITOR  
OFFICE OF AMY ELMER  
PO BOX 218 PIOCHE, NV 89043  
PHONE (775)962-8076 FAX (775)962-5482

59

# CERTIFICATION OF COPY

State of Nevada }  
County of Lincoln } ss.

I, Amy Elmer, the duly elected, qualified and acting County Recorder of Lincoln County,  
in the State of Nevada, do hereby certify that the foregoing is a true, full and correct copy  
of the original DEED  
now on file in this office,

in Book V of REAL ESTATE Page 36

as Document Number ----

DESCRIPTION  
SAN PEDRO LA SALT LAKE RR  
MAG HOLDINGS TRUST  
GRANTEE

IN WITNESS WHEREOF, I have set my hand and  
affixed the Seal of my office, in Pioche, Nevada,  
on Thursday, October 01, 2020 at 8:51 AM

SECTION 22  
A STRIP OF LAND  
N.W. 1/4 of S.E. 1/4 of Sect 22  
TWN 20 RANGE 61 E MD. BM

Amy Elmer Recorder

Amanda Kulani Deputy Recorder

Krysten Elizondo Deputy Recorder

LINCOLN COUNTY RECORDER/AUDITOR  
OFFICE OF AMY ELMER  
PO BOX 218 PIOCHE, NV 89043  
PHONE (775)962-8076 FAX (775)962-5482

66

**SIGNATURE PAGE.**

This page constitutes the signature page for the Grant of Assignment and Assignment relating to the agreement of a grantor .

Execution of this signature page constitutes a full understanding of the Agreement.

ASSIGNEE FOR M.L.Wicks Ben of S.P.R.R.

Michelle Gardner acc 13-8

Assignor Michelle A. Gardner

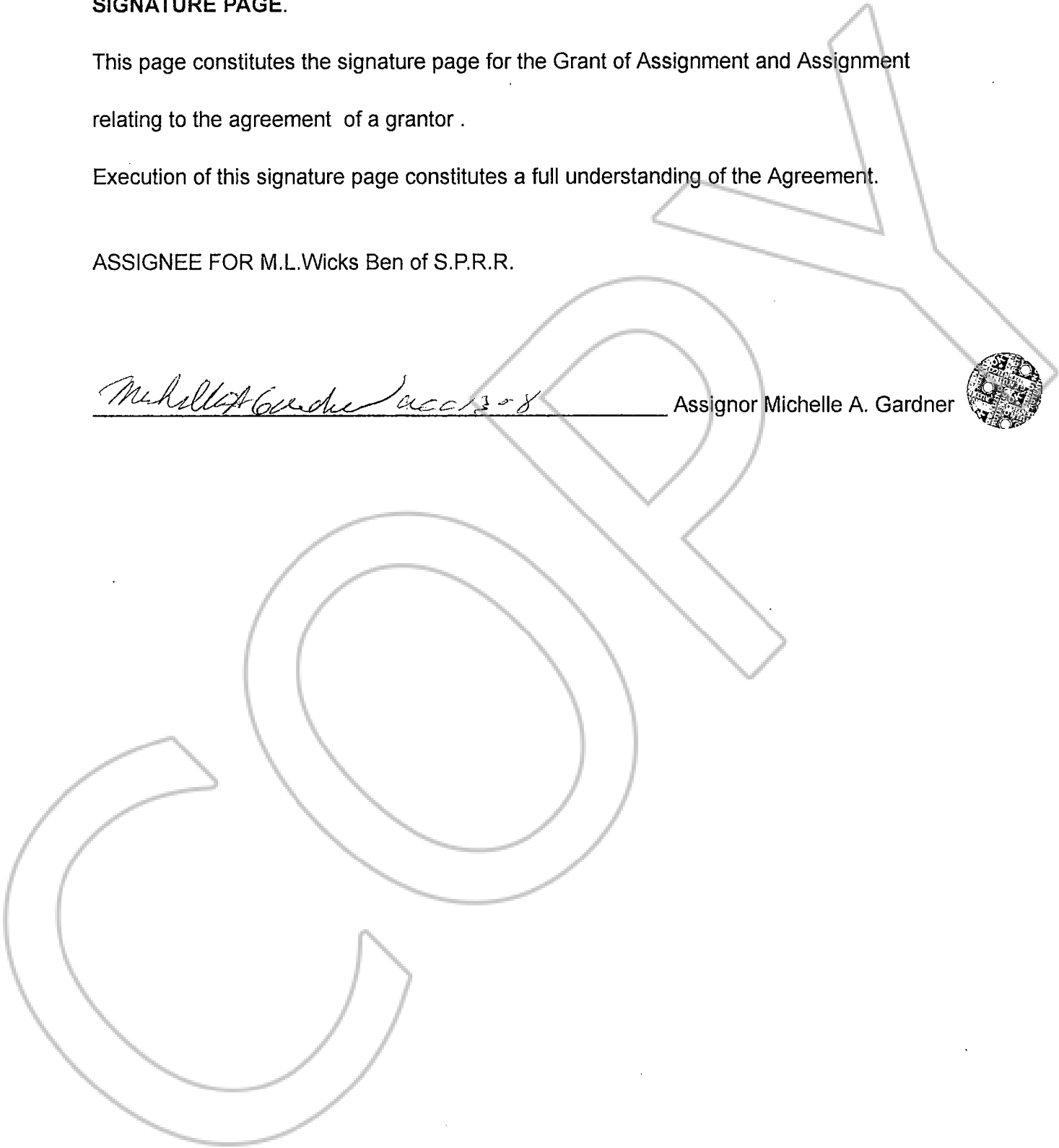

M.L.Wicks BEN S.P.R.R.

ACKNOWLEDGMENT

A notary public or other officer completing this certificate verifies only the identity of the individual who signed the document to which this certificate is attached, and not the truthfulness, accuracy, or validity of that document,

State of California

County of Los Angeles

On December 31, 2020

personally appeared **MAG HOLDING TRUST**

*Michelle Artice Gardner*

before me *Hugo Israel Estrada, Notary Public*

Michelle Artice Gardner Assignor

who proved to me on the basis of satisfactory evidence to be the person(s) whose name(s) is/are subscribed to the within instrument and acknowledged to me that he/she/they executed the same in his/her/their authorized capacity(ies), and that by his/her/their signature(s) on the instrument the person(s), or the entity upon behalf of which the person(s) acted, executed the instrument

I certify under PENALTY OF PERJURY under the laws of the State of California that the foregoing paragraph is true and correct.

WITNESS my hand and official seal.

Signature

*[Handwritten signature]*



COPY

