

APN: 004-062-04
R.P.T.T.: \$0

**After Recording, Return and
Mail Tax Statements To:**

Donald B. Shumway
PO Box 155
Alamo, NV 89001

Send Subsequent Tax Bills To:

Donald B. Shumway
PO Box 155
Alamo, NV 89001

LINCOLN COUNTY, NV
Rec:\$37.00
Total:\$37.00
KATSCHKE LAW, LLC

2023-165419
07/06/2023 09:38 AM

Pgs=4 KC



OFFICIAL RECORD
AMY ELMER, RECORDER

E05

ADMINISTRATOR'S DEED

THIS INDENTURE WITNESSETH THAT,

STEPHANIE HARRIS as the Administrator appointed for the Estate of NEDRA WADSWORTH SHUMWAY, deceased, in the Seventh Judicial District in and for the County of Lincoln, State of Nevada case number PR 0600821. Further, the Administrator was granted to convey the deceased's interest in the land as shown in the attached order.

FOR GOOD AND VALUABLE CONSIDERATION, the receipt of which is hereby acknowledged, does hereby CONVEY AND QUITCLAIM to:

DONALD B. SHUMWAY

Whose mailing address is PO Box 155, Alamo, NV 89001.

All of the following described real estate situated in the County of Lincoln, State of Nevada:

SEE EXHIBIT "A" ATTACHED HERETO AND BY THIS REFERENCE MADE A PART HEREOF.

SUBJECT TO: the Restrictions, Conditions, Covenants, Rights, Rights of Way, and Easements that are now of record, if any.

TOGETHER with all and singular the tenements, hereditaments and appurtenances thereunto belonging or in anywise appertaining.

(SPACE INTENTIONALLY LEFT BLANK)

Dated this 1 day of June, ~~2022~~ ²⁰²³.

Stephanie Harris

STEPHANIE HARRIS – Administrator

State of Nevada

County of Clark

This instrument was acknowledged before me on this 1 day of June, ~~2022~~ ²⁰²³,
by STEPHANIE HARRIS

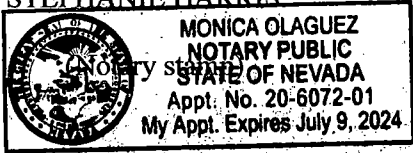

Monica Olaguez
(Signature of notarial officer)

The undersigned hereby affirm that this document submitted for recording does not contain a social security number.

Stephanie Harris
STEPHANIE HARRIS

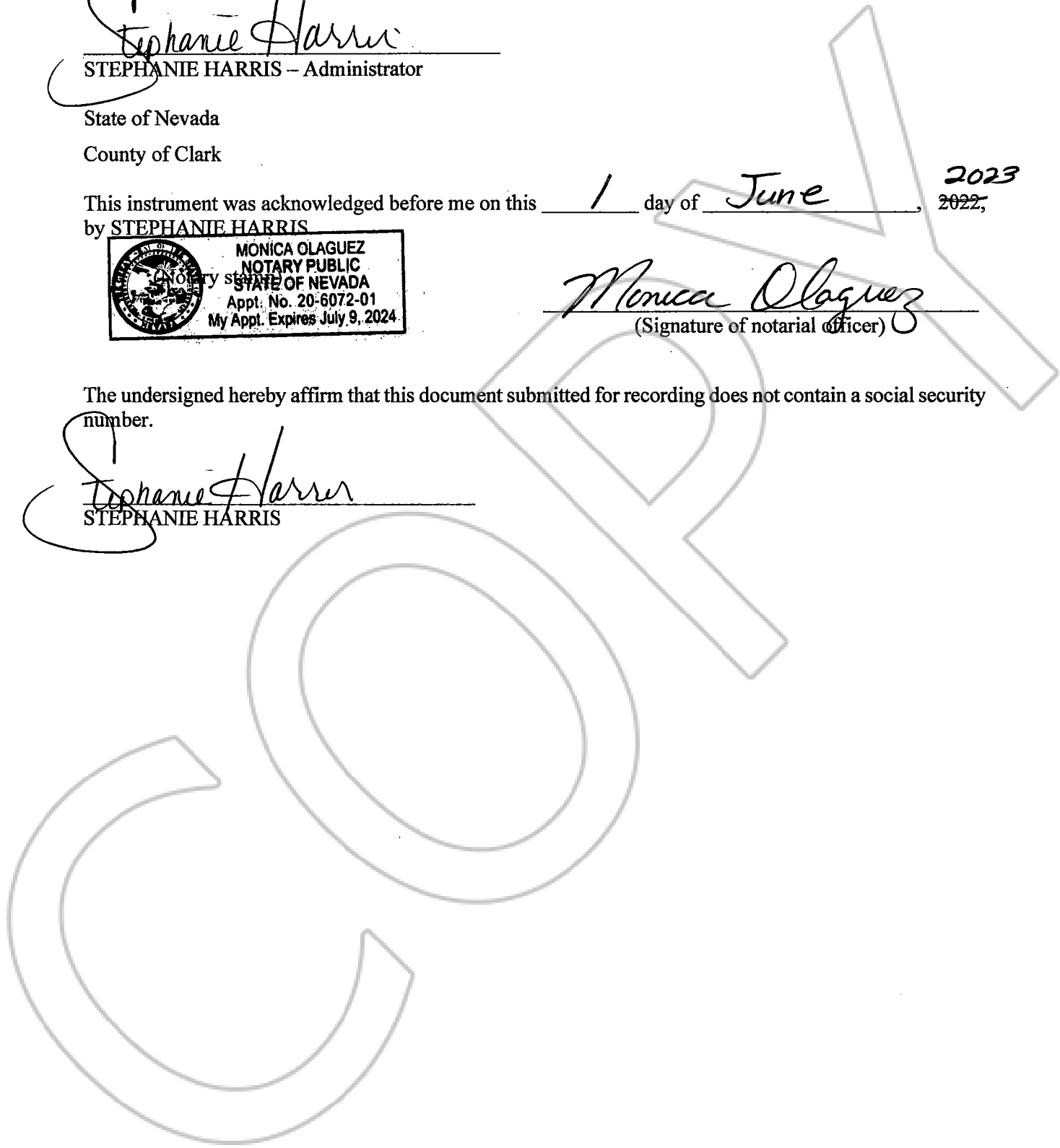
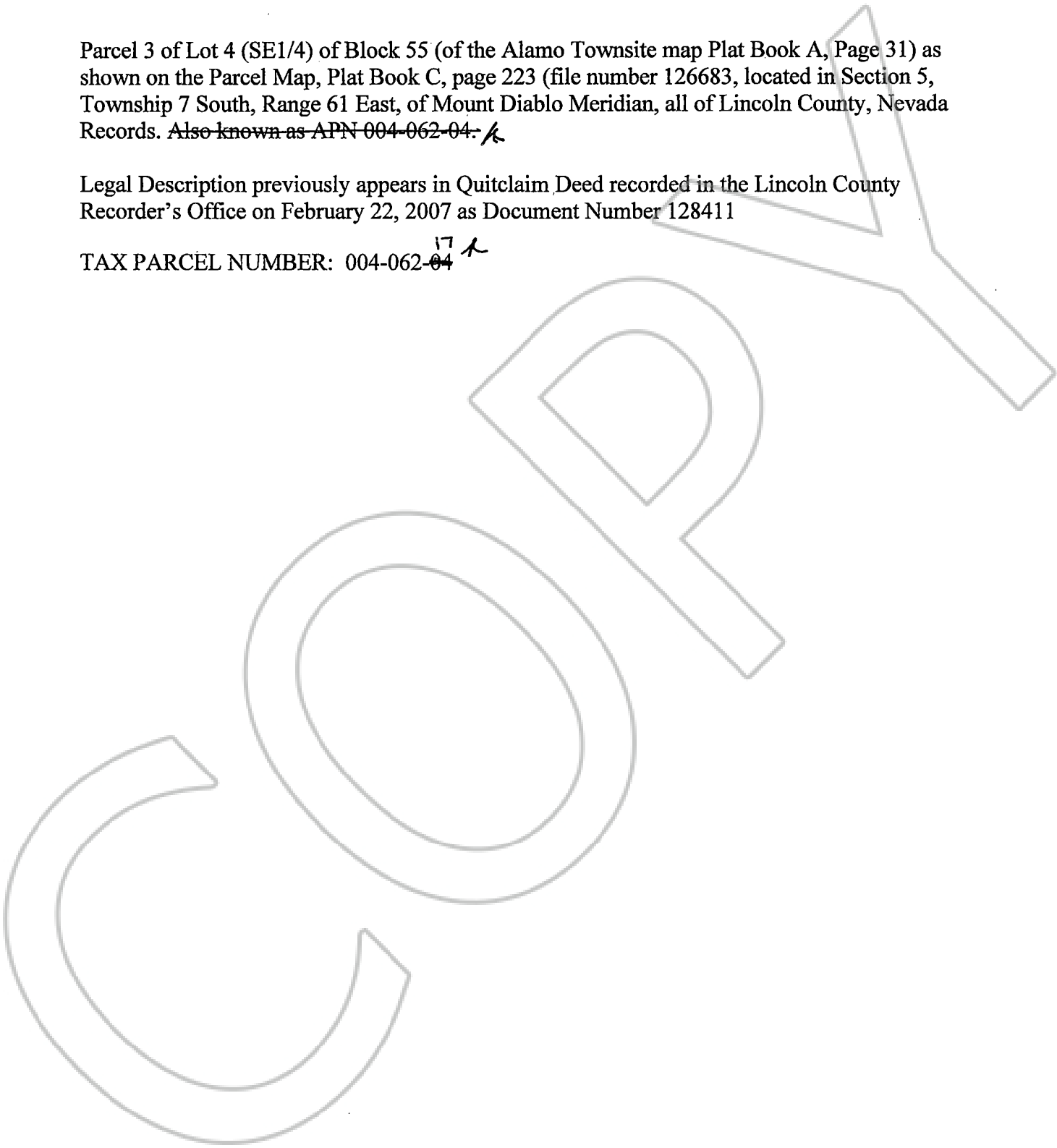

EXHIBIT A

Parcel 3 of Lot 4 (SE1/4) of Block 55 (of the Alamo Townsite map Plat Book A, Page 31) as shown on the Parcel Map, Plat Book C, page 223 (file number 126683, located in Section 5, Township 7 South, Range 61 East, of Mount Diablo Meridian, all of Lincoln County, Nevada Records. Also known as APN 004-062-04. ¹⁷ *h*

Legal Description previously appears in Quitclaim Deed recorded in the Lincoln County Recorder's Office on February 22, 2007 as Document Number 128411

TAX PARCEL NUMBER: 004-062-¹⁷04 *h*



**STATE OF NEVADA
DECLARATION OF VALUE FORM**

1. Assessor Parcel Number(s):
 a. 004-062-04 17 k
 b. _____
 c. _____
 d. _____

FOR RECORDER'S OPTIONAL USE ONLY	
Book: _____	Page: _____
Date of Recording: _____	
Notes: <input type="checkbox"/>	

2. Type of Property:
- | | |
|---|---|
| a. <input type="checkbox"/> Vacant Land | b. <input checked="" type="checkbox"/> Single Fam. Res. |
| c. <input type="checkbox"/> Condo/Townhouse | d. <input type="checkbox"/> 2-4 Plex |
| e. <input type="checkbox"/> Apt. Bldg | f. <input type="checkbox"/> Comm'l/Ind'l |
| g. <input type="checkbox"/> Agricultural | h. <input type="checkbox"/> Mobile Home |
| <input type="checkbox"/> Other: _____ | |

3. a. Total Value /Sales Price of Property: _____
 b. Deed in Lieu of Foreclosure Only (value of property) \$ 0
 c. Transfer Tax Value: \$ _____
 d. Real Property Transfer Tax Due: \$ 0

4. **If Exemption Claimed:**
 a. Transfer Tax Exemption per NRS 375.090, Section: 5
 b. Explain Reason for Exemption: Grantee is the son of the Grantor

5 Partial Interest: Percentage being transferred: 100 %

The undersigned declare and acknowledge, under penalty of perjury, pursuant to NRS. 375.060 and NRS 375.110, that the information provided is correct to the best of their information and belief, and can be supported by documentation if called upon to substantiate the information provided herein. Furthermore, the parties agree that disallowance of any claimed exemption, or other determination of additional tax due, may result in a penalty of 10% of the tax due plus interest at 1% per month. Pursuant to NRS 375.030, the Buyer and Seller shall be jointly and severally liable for any additional amount owed.

Signature: *Shumway* Capacity: Grantor
 Signature: _____ Capacity: _____

**SELLER (GRANTOR) INFORMATION
(REQUIRED)**

Print Name: NEDRA WADSWORTH SHUMWAY
 Address: 7517 Council Ave
 City: Las Vegas
 State NV Zip: 89128

**BUYER (GRANTEE) INFORMATION
(REQUIRED)**

Print Name: Donald B. Shumway
 Address: PO Box 155
 City: Alamo
 State: NV Zip: 89001

COMPANY/PERSON REQUESTING RECORDING (required if not seller or buyer)

KATSCHE LAW, LLC
PO Box 703
CALIENTE, NV 89008

AS A PUBLIC RECORD, THIS FORM MAY BE RECORDED/MICROFILMED