

APN: 002-270-22

R.P.T.T.: \$0

After Recording, Return and Mail Tax Statements To:

Alec S. and Kia L. Lloyd
PO Box 423
Panaca, NV 89042

Send Subsequent Tax Bills To:

Alec S. Lloyd and Kia L. Lloyd
PO Box 423
Panaca, NV 89042



OFFICIAL RECORD
AMY ELMER, RECORDER

E05

QUITCLAIM DEED

THIS INDENTURE WITNESSETH THAT,

ROBERT CHARLES PHILLIPS and ROCHELLE RIGGS PHILLIPS

FOR GOOD AND VALUABLE CONSIDERATION, the receipt of which is hereby acknowledged, does hereby CONVEY AND QUITCLAIM to:

ALEC S. LLOYD and KIA L. LLOYD

Whose mailing address is PO Box 423, Panaca, NV 89042

All of the following described real estate situated in the County of Lincoln, State of Nevada:

SEE EXHIBIT "A" ATTACHED HERETO AND BY THIS REFERENCE MADE A PART HEREOF.

SUBJECT TO: the Restrictions, Conditions, Covenants, Rights, Rights of Way, and Easements that are now of record, if any.

TOGETHER with all and singular the tenements, hereditaments and appurtenances thereunto belonging or in anywise appertaining.

Dated this 10 day of May, 2023.

ROBERT CHARLES PHILLIPS



ROCHELLE RIGGS PHILLIPS

State of Nevada

County of Lincoln

This instrument was acknowledged before me on this 10 day of May, 2023,
by ROBERT CHARLES PHILLIPS.

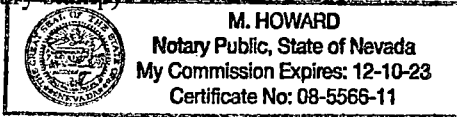
(Notary stamp)



M. Howard
(Signature of notarial officer)

The undersigned hereby affirm that this document submitted for recording does not contain a social security number.

Robert C Phillips
ROBERT CHARLES PHILLIPS

State of Nevada

County of Lincoln

This instrument was acknowledged before me on this 10 day of May, 2023,
by ROCHELLE RIGGS PHILLIPS.

(Notary stamp)

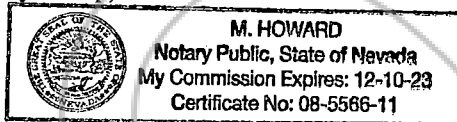

M. Howard
(Signature of notarial officer)

The undersigned hereby affirm that this document submitted for recording does not contain a social security number.

Rochelle Riggs Phillips
ROCHELLE RIGGS PHILLIPS

EXHIBIT A

PARCEL 1 AS SHOWN BY THE PARCEL MAP FOR ROBERT CHARLES PHILLIPS & ROCHELLE RIGGS PHILLIPS ON FILE AS FILE NO. 2020-158319 RECORDED ON MAY 6, 2020 IN THE OFFICE OF THE COUNTY RECORDER FOR THE COUNTY OF LINCOLN, STATE OF NEVADA.

Commonly known as 375 S. 4th Street, Panaca, NV 89042

TAX PARCEL NUMBER: 002-270-22

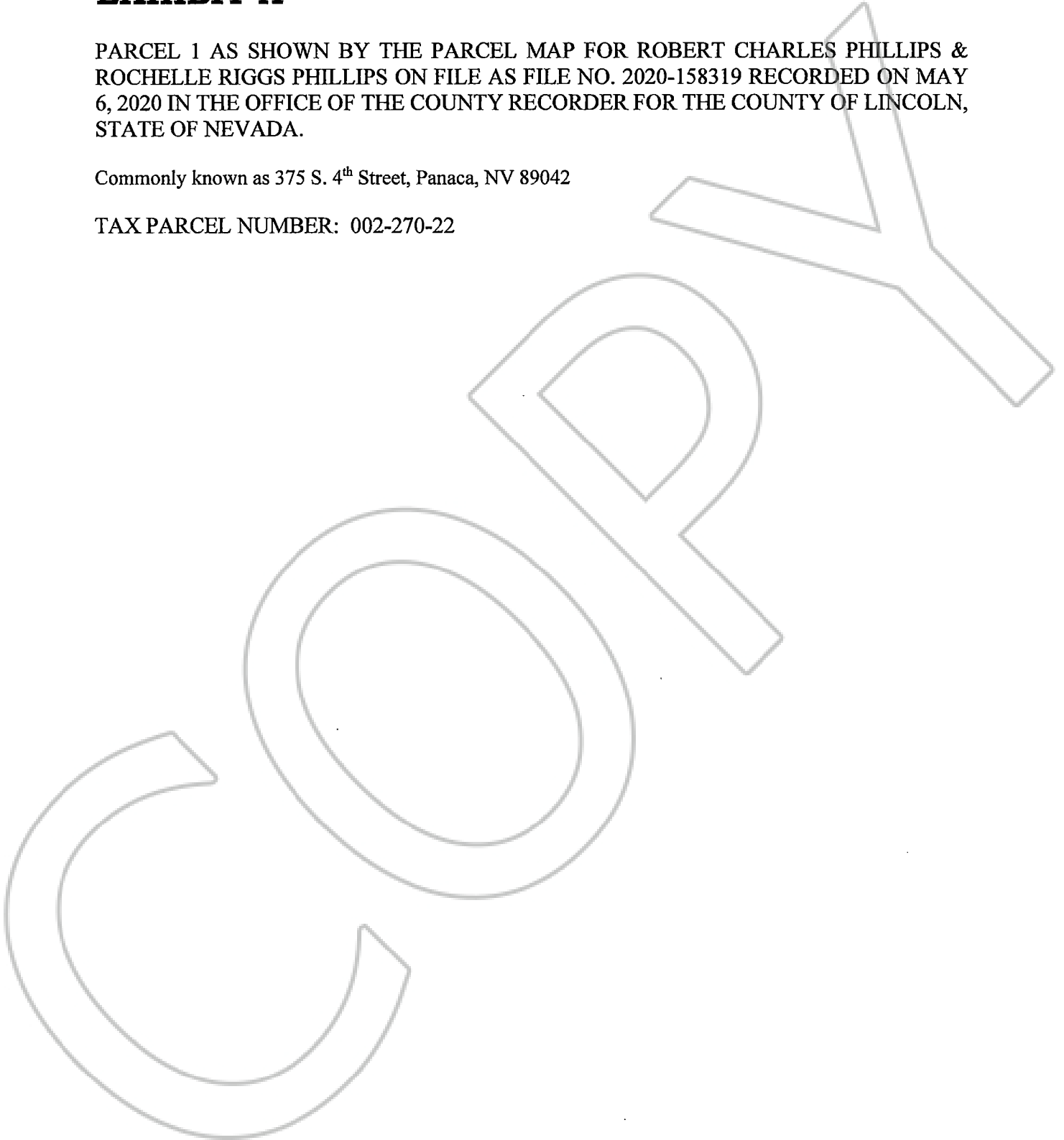

**STATE OF NEVADA
DECLARATION OF VALUE FORM**

1. Assessor Parcel Number(s):

- a. 002-270-22
- b. _____
- c. _____
- d. _____

FOR RECORDER'S OPTIONAL USE ONLY	
Book: _____	Page: _____
Date of Recording: _____	
Notes: _____	

2. Type of Property:

- a. Vacant Land
- b. Single Fam. Res.
- c. Condo/Townhouse
- d. 2-4 Plex
- e. Apt. Bldg
- f. Comm'l/Ind'l
- g. Agricultural
- h. Mobile Home
- Other: _____

3. a. Total Value /Sales Price of Property:

- b. Deed in Lieu of Foreclosure Only (value of property) \$ 140,000.00
- c. Transfer Tax Value: \$ _____
- d. Real Property Transfer Tax Due: \$ 0

4. **If Exemption Claimed:**

- a. Transfer Tax Exemption per NRS 375.090, Section: 5
- b. Explain Reason for Exemption: Grantees are child of Grantor and her spouse

5. Partial Interest: Percentage being transferred: 100 %

The undersigned declare and acknowledge, under penalty of perjury, pursuant to NRS. 375.060 and NRS 375.110, that the information provided is correct to the best of their information and belief, and can be supported by documentation if called upon to substantiate the information provided herein. Furthermore, the parties agree that disallowance of any claimed exemption, or other determination of additional tax due, may result in a penalty of 10% of the tax due plus interest at 1% per month. Pursuant to NRS 375.030, the Buyer and Seller shall be jointly and severally liable for any additional amount owed.

Signature: *Robert C Phillips* Capacity: Grantor

Signature: *Rochelle Riggs Phillips* Capacity:

**SELLER (GRANTOR) INFORMATION
(REQUIRED)**

Print Name: ROBERT CHARLES PHILLIPS AND
ROCHELLE RIGGS PHILLIPS
Address: PO Box 462
City: Panaca
State NV Zip: 89042

**BUYER (GRANTEE) INFORMATION
(REQUIRED)**

Print Name: ALEC S. LLOYD and
KIA L. LLOYD
Address: PO Box 423
City: Panaca
State: NV Zip: 89042

COMPANY/PERSON REQUESTING RECORDING (required if not seller or buyer)