

APN _____

APN _____

APN _____

LINCOLN COUNTY, NV **2023-164434**
Rec:\$2052.00
Total:\$2,052.00 **05/08/2023 11:05 AM**
IVANHÔE ELECTRIC NV HOLDINGS, Pgs=2 KC



OFFICIAL RECORD
AMY ELMER, RECORDER

Mining Claim map
Title of Document

Affirmation Statement

SI I, the undersigned hereby affirm that the attached document, including any exhibits, hereby submitted for recording **does not contain** the social security number, driver's license or identification card number, or any "Personal Information" (as defined by NRS 603A.040) of any person or persons. (Per NRS 239B.030)

_____ I, the undersigned hereby affirm that the attached document, including any exhibits, hereby submitted for recording **does contain** the social security number, driver's license or identification card number, or any "Personal Information" (as defined by NRS 603A.040) of a person or persons as required by law: _____
(State specific law)

[Signature]
Signature Title

Sean Inkster
Print

May 8, 2023
Date

Grantees address and mail tax statement:

342 South Beck St.
Eureka, UT 84628

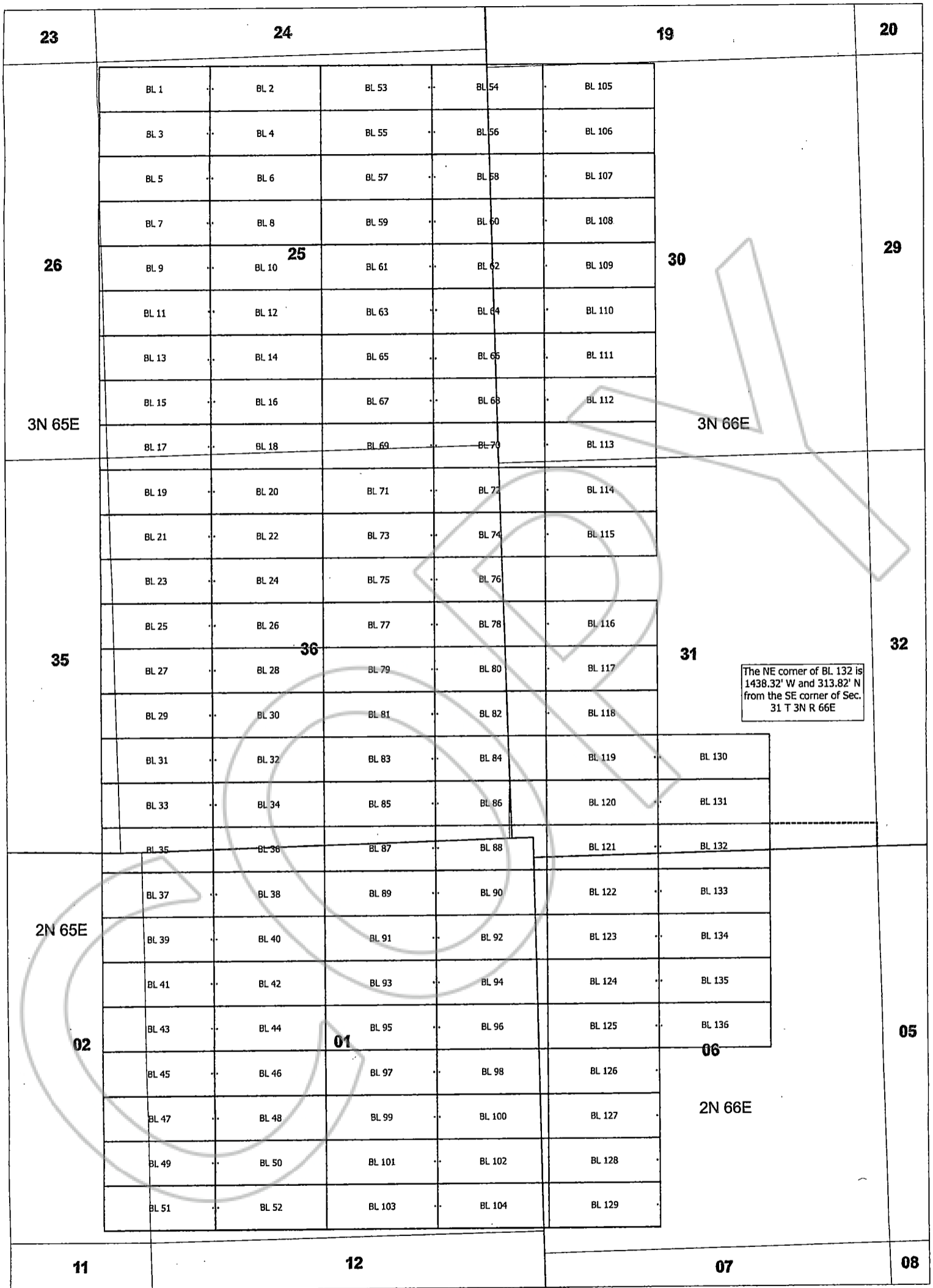

Locator:
 Ivanhoe Electric Nevada Holdings, Inc.
 251 Little Falls Drive
 Wilmington, DE 19808

Ivanhoe Electric Nevada Holdings, Inc.
 136 Lode Claims
 Lincoln County, NV
 T 3N R 65E Sec. 25, 26, 35, 36
 T 3N R 66E Sec. 19, 30, 31
 T 2N R 65E Sec. 01, 02
 T 2N R 66E Sec. 06

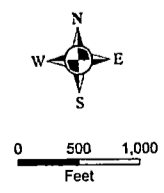

- Legend
- Location Monuments
 - Claim Corner Distance
 - Claim Boundaries
 - PLSS Township
 - PLSS First Division