

APN: 001-331-86

RECORDING REQUESTED BY, AND WHEN RECORDED, RETURN TO:

Kenneth A. Woloson Law Office
1980 Festival Plaza Drive, Ste. 300
Las Vegas, Nevada 89135

MAIL TAX STATEMENTS TO:

Bobby Joe Beam
P.O. Box 464
Pioche, Nevada 89043

LINCOLN COUNTY, NV **2022-163420**
\$37.00
RPTT:\$0.00 Rec:\$37.00 **11/07/2022 01:48 PM**
KENNETH A. WOLOSON LAW OFFICE Pgs=2 AK
OFFICIAL RECORD
AMY ELMER, RECORDER E07

QUITCLAIM DEED

WITHOUT CONSIDERATION, BOBBY JOE BEAM, as sole surviving Trustee of THE BEAM AND CLAWSON FAMILY LIVING TRUST, hereby transfers to BOBBY JOE BEAM all that real property situated in the County of Lincoln, State of Nevada, bounded and described as follows:

SEE EXHIBIT "A" ATTACHED HERETO

- Subject to:
1. Taxes for the current fiscal year, paid current.
 2. Conditions, covenants, restrictions, reservations, rights, rights of way and easements now of record, if any.

Together with all and singular the tenants, hereditaments and appurtenances thereunto belonging or in anywise appertaining.

Witness my hand this 19 day of October, 2022.

Bobby Joe Beam

BOBBY JOE BEAM

STATE OF NEVADA)
) ss:
COUNTY OF LINCOLN)

This instrument was acknowledged before me this this 19th day of October, 2022 by BOBBY JOE BEAM, as sole surviving Trustee of THE BEAM AND CLAWSON FAMILY LIVING TRUST.

 **M. HOWARD**
Notary Public, State of Nevada
My Commission Expires: 12-10-23
Certificate No: 08-5566-11

M Howard

Notary Public

EXHIBIT "A"
Legal Description

143 Maple Way
Pioche, Nevada 89043

THAT PORTION OF THE NORTHEAST QUARTER (NE 1/4) OF THE SOUTHEAST QUARTER (SE 1/4) OF SECTION 10, TOWNSHIP 1 NORTH, RANGE 67 EAST, M.D.B. AND M., LINCOLN COUNTY, NEVADA DESCRIBED AS FOLLOWS:

PARCEL 8, AS SHOWN UPON SUBSEQUENT PARCEL MAP FOR JIM VINCENT RECORDED NOVEMBER 17, 2003 IN PLAT BOOK C, PAGE 18, AS FILE 121256.

APN: 001-331-86

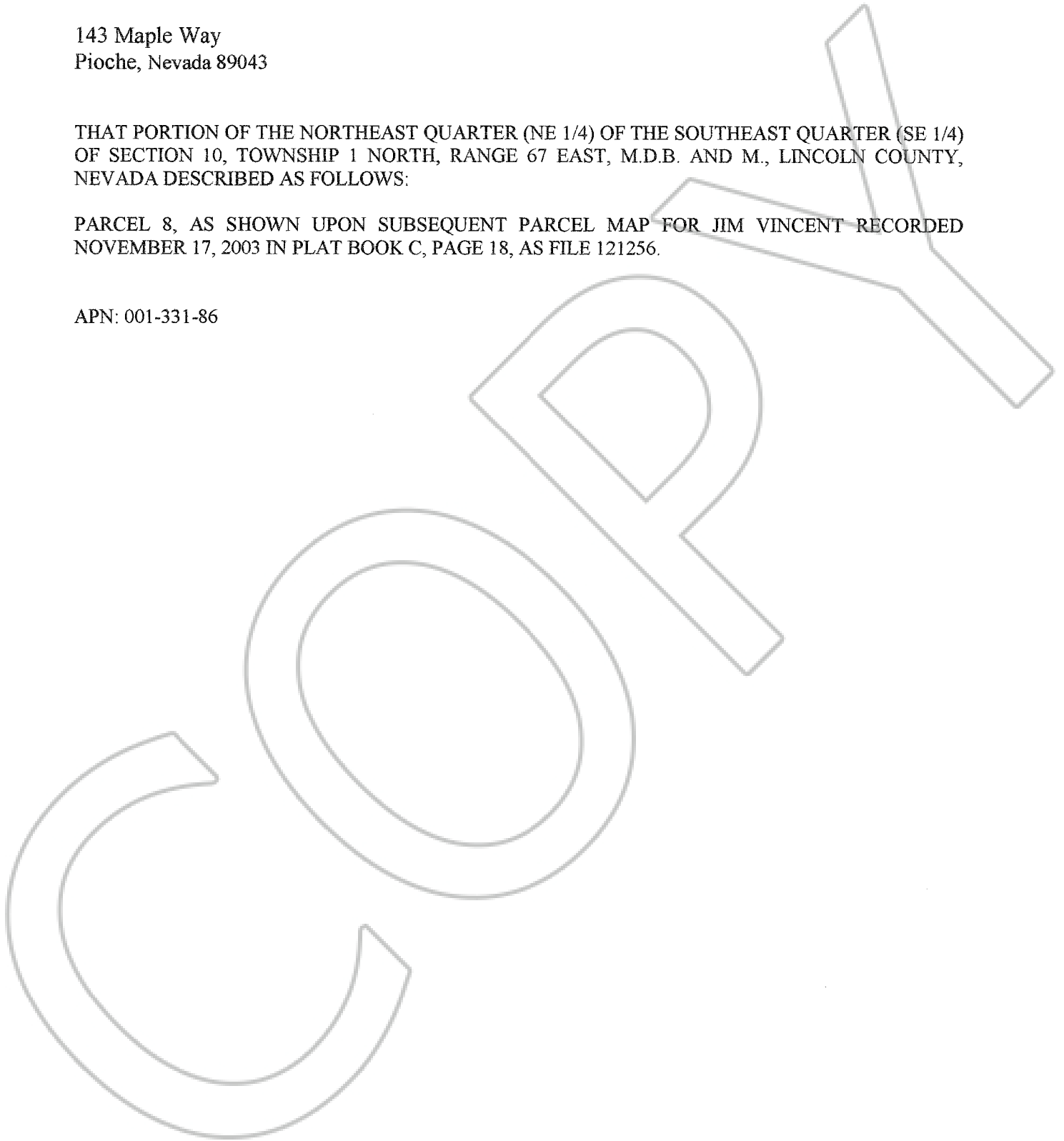

**STATE OF NEVADA
DECLARATION OF VALUE**

1. Assessor Parcel Number(s)
 a. 001-331-86
 b. _____
 c. _____
 d. _____

2. Type of Property:
 a. Vacant Land b. Single Fam. Res.
 c. Condo/Twnhse d. 2-4 Plex
 e. Apt. Bldg f. Comm'l/Ind'l
 g. Agricultural h. Mobile Home
 Other

FOR RECORDERS OPTIONAL USE ONLY	
Book _____	Page: _____
Date of Recording: _____	
Notes: Trust on File - AK	

- 3.a. Total Value/Sales Price of Property \$ N/A
 b. Deed in Lieu of Foreclosure Only (value of property (_____)
 c. Transfer Tax Value: \$ _____
 d. Real Property Transfer Tax Due \$ N/A

4. **If Exemption Claimed:**
 a. Transfer Tax Exemption per NRS 375.090, Section 07
 b. Explain Reason for Exemption: Transfer without consideration to or from a trust

5. Partial Interest: Percentage being transferred: 100 %
 The undersigned declares and acknowledges, under penalty of perjury, pursuant to NRS 375.060 and NRS 375.110, that the information provided is correct to the best of their information and belief, and can be supported by documentation if called upon to substantiate the information provided herein. Furthermore, the parties agree that disallowance of any claimed exemption, or other determination of additional tax due, may result in a penalty of 10% of the tax due plus interest at 1% per month. Pursuant to NRS 375.030, the Buyer and Seller shall be jointly and severally liable for any additional amount owed.

Signature [Signature] Capacity: Paralegal
 Signature [Signature] Capacity: Paralegal

SELLER (GRANTOR) INFORMATION
(REQUIRED)
The Beam and Clawson Family Living Trust
P.O. Box 464
Pioche, Nevada 89043

BUYER (GRANTEE) INFORMATION
(REQUIRED)
Bobby Joe Beam
P.O. Box 464
Pioche, Nevada 89043

COMPANY/PERSON REQUESTING RECORDING (Required if not seller or buyer)
 Print Name: Kenneth A. Woloson Law Office Escrow # _____
 Address: 1980 Festival Plaza Drive, #300
 City: Las Vegas State: Nevada Zip: 89135