



OFFICIAL RECORD
AMY ELMER, RECORDER

CORNER RECORD

SECTION 8, T4S, R67E, MDM.

SURVEYOR'S CERTIFICATE

Sheet 1 of 3

RECORDER NRS 329.150-.170

I, Timothy J. Wolf, a Professional Land Surveyor, registered in the State of Nevada, as agent for Artisan Land Transaction Assistants, LLC, dba Artisan Surveying Group, a NV LLC, hereby certify:

1) This Corner Record represents the establishment or restoration of a corner or accessory to a corner conducted under my direct supervision.

2) The monument or accessories perpetuated lie within the Section 8, Township 4 South, Range 67 East, as noted above, as referenced to the Mount Diablo Meridian, Lincoln County, Nevada, and the establishment or field restoration was completed on June 8, 2022.

3) This Corner Record has been filed pursuant to N.R.S. 329.140 or N.R.S. 329.150 and complies with the provisions of Nevada Administrative Code Section 329 and any local ordinances in effect on the date that the establishment or restoration was completed.

4) The monument or witness corner monument and accessories found are of the character shown, occupy the positions indicated and are of sufficient durability (latter solely if established by Artisan Land Transaction Assistants, LLC).

Timothy J. Wolf
Professional Land Surveyor
Nevada License No. 9677
Agent, ASG, a NV LLC

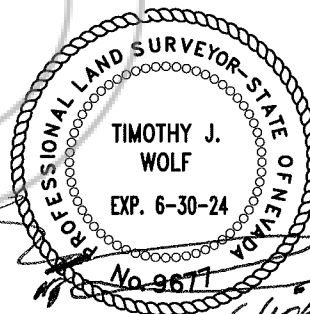

RECORDER:

Please provide official digital copy for fee paid

Attention to: Administrator at ASG, a NV LLC
TWolf@ArtisanSurveying.com

(702) 962-LAND (5263)
www.ArtisanSurveying.com

Sec.8
T.4S.
R.67E.
M.D.M.

CORNER RECORD MONUMENTS

Sheet 2 of 3

ARTISAN
"WHERE ART & MEASUREMENT SCIENCE CONVERGE"
GEODETTIC
NORTH

PRIMARY CONTROL

FOUND 2" DAM PLS 9677
IN CONCRETE IN BALLPARK
LAT: 37°36'56.43437"N
LON: 114°30'54.32906"W

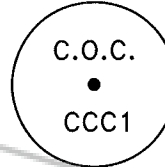

FOUND 2" DAM PLS 9677
IN ROCK OUTCROPPING
LAT: 37°37'07.22199"N
LON: 114°30'58.22807"W

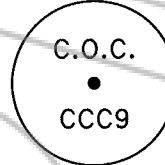

RESTORED
CORNER

3.25" DBM FONGER PLS 4235 IN
CONCRETE.
REPLACED WITH 2" DAM PLS 9677
IN CONCRETE.
"FONGER RESET NO. 20 2022"
LAT: 37°37'17.67426"N
LON: 114°30'42.65595"W



DATUM

PRIMARY CONTROL POINT POSITIONS
FOR WERE ESTABLISHED USING NGS'
OPUS WITH 100'S OF HOURS OVER
AS MANY DAYS OF STATIC DATA,
NGS NAD83 (2010.00 PRE-MYCS2).
[HTTP://WWW.NGS.NOAA.GOV/OPUS](http://www.ngs.noaa.gov/opus)

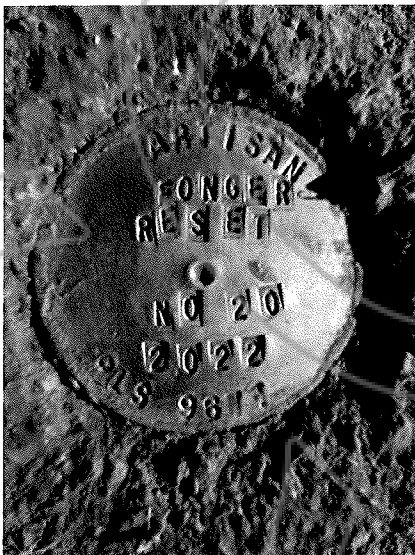

RYAN ST. & N SPRING ST.

REFERENCES

LC DOCS: 15661, 148417, 148460.; BLM PLATS & FIELD NOTES T4S R67E, MDM.
CAVEAT: REPLACED MONUMENTS MAY OR MAY NOT SOLELY REPRESENT
SUBDIVISION CORNERS; RELATIONSHIP TO US93 NOT ESTABLISHED NOR STUDIED.

Artisan Land Transaction Assistants, LLC
"Where Art & Measurement Science Assist"

www.ArtisanGroupUSA.com
(702) 233-3451

Sec.8
T.4S.
R.67E.
M.D.M.

CORNER RECORD MONUMENTS

Sheet 3 of 3

ARTISAN
"WHERE ART & MEASUREMENT SCIENCE CONVERGE"
GEODETTIC
NORTH

PRIMARY CONTROL

FOUND 2" DAM PLS 9677
IN CONCRETE IN BALLPARK
LAT: 37°36'56.43437"N
LON: 114°30'54.32906"W

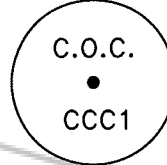

FOUND 2" DAM PLS 9677
IN ROCK OUTCROPPING
LAT: 37°37'07.22199"N
LON: 114°30'58.22807"W

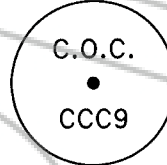

RESTORED
CORNER

3.25" DBM FONGER PLS 4235 IN
CONCRETE.
REPLACED WITH 2" DAM PLS 9677
IN CONCRETE.
"FONGER RESET NO. 21 2022"
LAT: 37°37'13.82644"N
LON: 114°30'40.9857"W



DATUM

PRIMARY CONTROL POINT POSITIONS
FOR WERE ESTABLISHED USING NGS'
OPUS WITH 100'S OF HOURS OVER
AS MANY DAYS OF STATIC DATA,
NGS NAD83 (2010.00 PRE-MYCS2).
[HTTP://WWW.NGS.NOAA.GOV/OPUS](http://www.ngs.noaa.gov/opus)



ADA ST. & N SPRING ST.

REFERENCES

LC DOCS: 15661, 148417, 148460.; BLM PLATS & FIELD NOTES T4S R67E, MDM.
CAVEAT: REPLACED MONUMENTS MAY OR MAY NOT SOLELY REPRESENT
SUBDIVISION CORNERS; RELATIONSHIP TO US93 NOT ESTABLISHED NOR STUDIED.

Artisan Land Transaction Assistants, LLC
"Where Art & Measurement Science Assist"

www.ArtisanGroupUSA.com
(702) 233-3451