

LINCOLN COUNTY, NV

2021-161000

\$37.00

RPTT:\$0.00 Rec:\$37.00

08/18/2021 11:51 AM

JEFFREY BURR LTD.

Pgs=3 AE

OFFICIAL RECORD

AMY ELMER, RECORDER

E07

APN: 12-060-40

When Recorded, Mail to:

Jeffrey Burr, Ltd.
2600 Paseo Verde Pkwy, Ste. 200
Henderson, NV 89074

Mail Tax Statements to:

Marvin Heit and Sherry M. Heit
2908 Frehner Farm Road
Pioche, NV 89043

GRANT, BARGAIN, SALE DEED

THIS INDENTURE WITNESSETH: That MARVIN HEIT and SHERRY M. HEIT, Husband and Wife, as joint tenants, for good and other valuable consideration, do hereby Grant, Bargain, Sell and Convey to MARVIN HEIT and SHERRY M. HEIT, Trustees of the SHERRY AND MARVIN HEIT TRUST, dated August 5, 2021, as amended, or restated, or their successors all of their right, title and interest in that real property situated in the County of Lincoln, State of Nevada, bounded and described as follows:

SEE EXHIBIT "A" ATTACHED HERETO AND MADE A PART HEREOF.

Commonly known as: 2908 Frehner Farm Road, Pioche, NV 89043

GRANTEES' ADDRESS: SHERRY AND MARVIN HEIT TRUST
2908 Frehner Farm Road
Pioche, NV 89043

Together with all and singular the tenements, hereditaments and appurtenances thereunto belonging or in any wise appertaining.

Witness their hands ~~March~~ ^{August} 5, 2021.

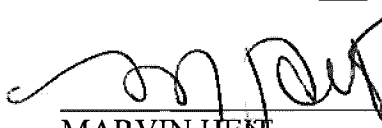

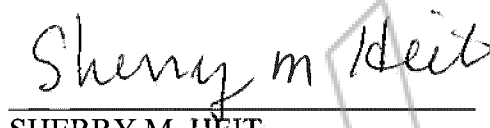
MARVIN HEIT

SHERRY M. HEIT

STATE OF NEVADA)
) ss.
COUNTY OF LINCOLN)

On ~~March~~ ^{August} 5, 2021 before me the undersigned, a Notary Public in and for the said County of Lincoln, State of Nevada, personally appeared MARVIN HEIT and SHERRY M. HEIT personally known to me (or proved to me on the basis of satisfactory evidence) to be the persons whose names are subscribed to the within instrument and acknowledged to me that they executed the same in their authorized capacity, and that by their signatures on the instrument, the persons, or the entity upon behalf of which the persons acted, executed the instrument.

WITNESS my hand and official seal.

NOTARY PUBLIC

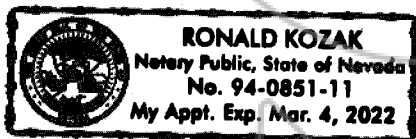
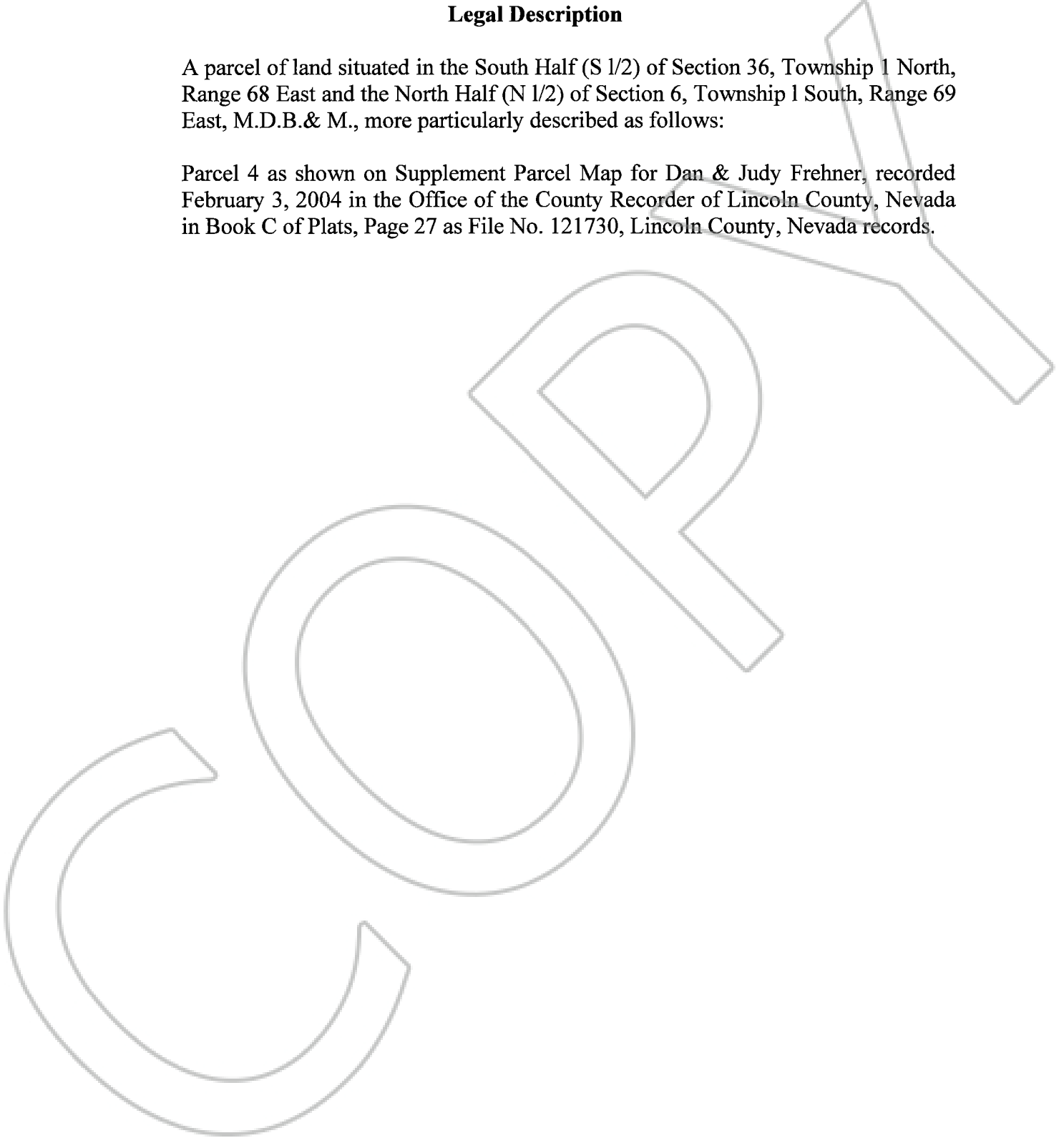

EXHIBIT A
Legal Description

A parcel of land situated in the South Half (S 1/2) of Section 36, Township 1 North, Range 68 East and the North Half (N 1/2) of Section 6, Township 1 South, Range 69 East, M.D.B. & M., more particularly described as follows:

Parcel 4 as shown on Supplement Parcel Map for Dan & Judy Frehner, recorded February 3, 2004 in the Office of the County Recorder of Lincoln County, Nevada in Book C of Plats, Page 27 as File No. 121730, Lincoln County, Nevada records.



**STATE OF NEVADA
DECLARATION OF VALUE FORM**

1. Assessor Parcel Number(s)

- a) 12-060-40
- b) _____
- c) _____

FOR RECORDER'S OPTION USE ONLY
Book: _____ Page: _____
Date of Recording: _____
Notes: TRUST REVIEWED, TRUST ON
FILE. AE

2. Type of Property:

- a) Vacant Land
- b) Single Fam. Res.
- c) Condo/Twnhse
- d) 2-4 Plex
- e) Apt. Bldg
- f) Comm'l/Ind'l
- g) Agricultural
- h) Mobile Home
- Other

3. Total Value/Sales Price of Property

Deed in Lieu of Foreclosure Only (value of property) \$ 0.00
(_____)
Transfer Tax Value \$ 0.00
Real Property Transfer Tax Due \$ 0.00

4. If Exemption Claimed:

- a. Transfer Tax Exemption per NRS 375.090, Section 07
- b. Explain Reason for Exemption: Transfer without consideration to or from a Trust

5. Partial Interest: Percentage being transferred: _____ %

The undersigned declares and acknowledges, under penalty of perjury, pursuant to NRS 375.060 and NRS 375.110, that the information provided is correct to the best of their information and belief, and can be supported by documentation if called upon to substantiate the information provided herein. Furthermore, the parties agree that disallowance of any claimed exemption, or other determination of additional tax due, may result in a penalty of 10% of the tax due plus interest 1% per month. Pursuant to NRS 375.030, the Buyer and Seller shall be jointly and severally liable for any additional amount owed.

Signature *Chris Muller* Capacity Paralegal

**SELLER (GRANTOR) INFORMATION
(REQUIRED)**

Print Name: MARVIN HEIT and SHERRY M. HEIT
Address: 2908 Frehner Farm Road
City: Pioche
State: NV Zip: 89043

**BUYER (GRANTEE) INFORMATION
(REQUIRED)**

Print Name: SHERRY AND MARVIN HEIT TRUST
Address: 2908 Frehner Farm Road
City: Pioche
State: NV Zip: 89043

COMPANY/PERSON REQUESTING RECORDING (required if not seller or buyer)

Print Name: JEFFREY BURR, LTD. Escrow #: _____
Address: 2600 Paseo Verde Pkwy. #200
City: Henderson State: Nevada Zip: 89074

AS A PUBLIC RECORD THIS FORM MAY BE RECORDED/MICROFILMED