

LINCOLN COUNTY, NV

2020-158830

\$37.00

08/10/2020 02:00 PM

Rec:\$37.00

FA NV DIRECT TITLE

Pgs=4 KE

OFFICIAL RECORD

AMY ELMER, RECORDER

**RECORDING REQUESTED BY**

First American Title Insurance  
Company of Nevada

**AND WHEN RECORDED  
RETURN TO AND MAIL TAX  
STATEMENTS TO:**

*Leslie Park  
PO Box 12041  
LV NV 89112*

Space Above This Line for  
Recorder's Use Only

**A.P.N. 001-260-31**

File No.: 116-2596155 (CC)

**Affidavit - Death of Trustee**

State of NEVADA )  
County of CLARK )ss.  
)

**Leslie A. Park** ("Declarant") is of legal age, being first duly sworn, deposes and states under penalty of perjury under the laws of the State of Nevada:

1. **James L. Park** ("Decedent") is the person referenced in the attached certified copy of the Certificate of Death who died on **February 26, 2015** at **Henderson, nNV** (city and state of death).
2. Decedent is the same person named as the trustee named in that certain Declaration of Trust dated **February 23, 2015** executed by **James L. Park** as trustor(s) (the "Trust").
3. Decedent as a trustee is the same person who was named as a grantee in that certain **Grant Bargain Sale Deed** dated **February 23, 2015** which was recorded as Instrument No. **0146901** in Book **na**, Page **na**, of Official Records of **Clark** County, Nevada as legally described as follows:

**Legal Description attached hereto as Exhibit "A" and incorporated herein by this reference**

4. Declarant is the successor trustee under the Trust. The Trust was in effect at the date of the death of the Decedent and has not been revoked. Declarant has consented to act as trustee under the Trust.

Dated: August 5, 2020

DECLARANT:

Leslie A. Park

**Leslie A. Park**

State of NEVADA )  
 )ss  
County of CLARK )

SUBSCRIBED AND SWORN TO (or affirmed) before me the undersigned, a Notary Public in and for said County Clark and State Nevada, this 5 day of August, 20 20 by Leslie A. Park, personally know to me or proved to me on the basis of satisfactory evidence to be the person(s) who appeared before me..

WITNESS my hand and official seal.

*This area for official notarial seal*

Signature [Signature]

My Commission Expires: Aug 15, 2023



Notary Name: Teredith Barcelou Notary Phone: 702-236-0552  
Notary Registration Number: 04-86367-1 County of Principal Place of Business Clark

**EXHIBIT 'A'**

**PARCEL 39 AS SHOWN ON THAT CERTAIN PARCEL MAP 126781, FILED IN THE OFFICE OF THE COUNTY RECORDER OF LINCOLN COUNTY, NEVADA ON JULY 3, 2006, OFFICIAL RECORDS.**

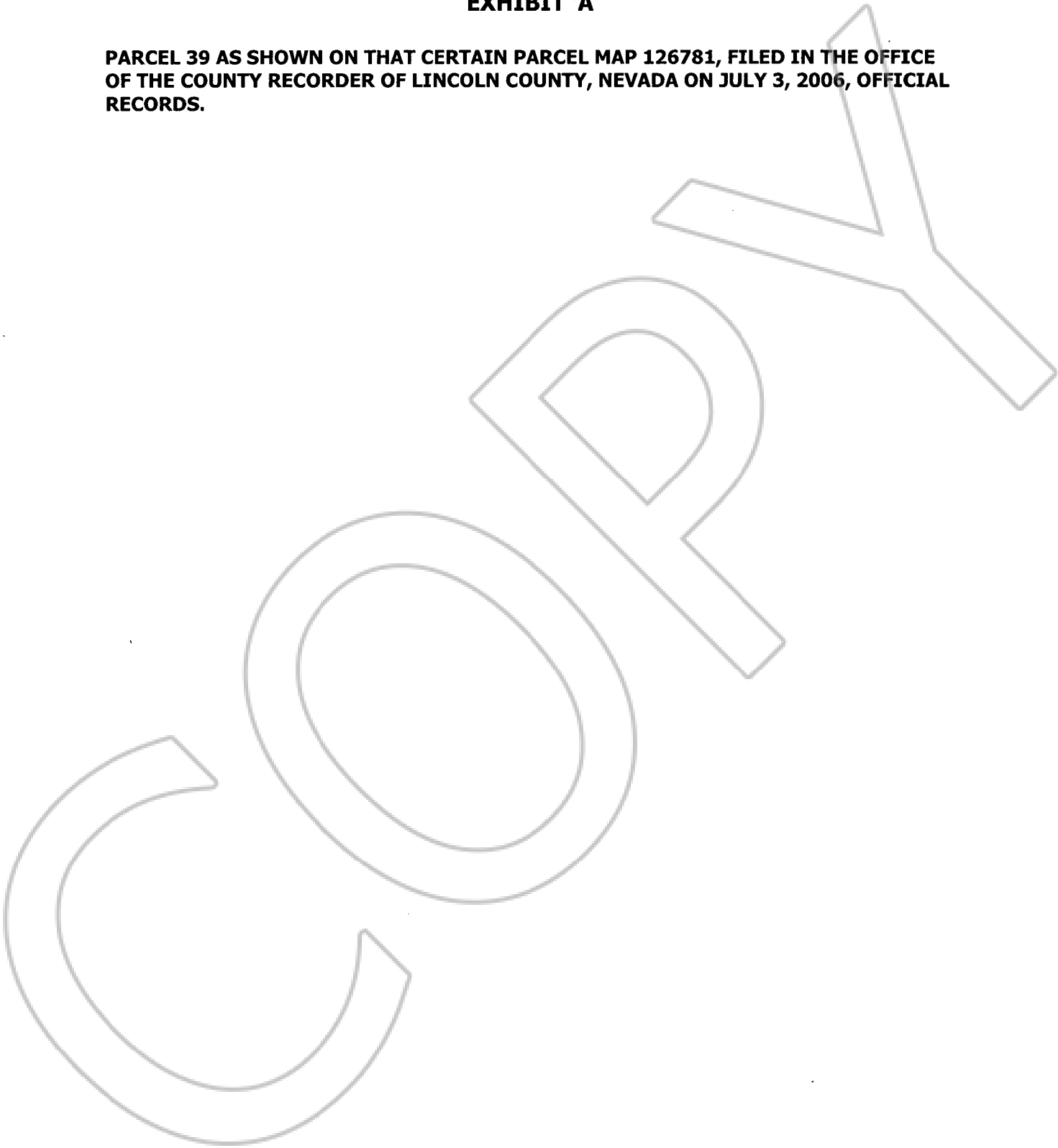



0150251

STATE OF NEVADA DEPARTMENT OF HEALTH AND HUMAN SERVICES DIVISION OF HEALTH - VITAL STATISTICS



DEPARTMENT OF HEALTH AND HUMAN SERVICES DIVISION OF HEALTH - VITAL STATISTICS

CERTIFICATE OF DEATH

2015003329 STATE FILE NUMBER

TYPE OR PRINT IN PERMANENT BLACK INK

DECEDENT

IF DEATH OCCURRED IN INSTITUTION SEE HANDBOOK REGARDING COMPLETION OF RESIDENCE ITEMS

PARENTS

DISPOSITION

TRADE CALL

CERTIFIER

REGISTRAR

CAUSE OF DEATH

CONDITIONS IF ANY WHICH GAVE RISE TO IMMEDIATE CAUSE - STATING THE UNDERLYING CAUSE LAST

1a. DECEASED-NAME (FIRST,MIDDLE,LAST,SUFFIX) <b>James Lee PARK</b>		2. DATE OF DEATH (Mo/Day/Year) <b>February 26, 2015</b>		3a. COUNTY OF DEATH <b>Clark</b>	
3b. CITY, TOWN, OR LOCATION OF DEATH <b>Henderson</b>		3c. HOSPITAL OR OTHER INSTITUTION -Name(If not either, give street and Inpatient(Specify) <b>341 East Long Acres Drive Home</b>		4 SEX <b>Male</b>	
5. RACE White (Specify)		6. Hispanic Origin? Specify No - Non-Hispanic		7a. AGE-Last birthday (Years) <b>68</b>	
9a. STATE OF BIRTH (If not U.S.A., Nevada)		9b. CITIZEN OF WHAT COUNTRY United States		10 EDUCATION 12	
11. MARRIED, NEVER MARRIED, WIDOWED, DIVORCED (Specify) Widowed		12 SURVIVING SPOUSE (Maiden name)		8. DATE OF BIRTH (Mo/Day/Yr) <b>April 20, 1946</b>	
13. SOCIAL SECURITY NUMBER		14a. USUAL OCCUPATION (Give Kind of Work Done During Most of Electrician)		14b. KIND OF BUSINESS OR INDUSTRY Construction	
15a. RESIDENCE - STATE Nevada		15b. COUNTY Clark		15c. CITY, TOWN OR LOCATION Henderson	
15d. STREET AND NUMBER 341 East Long Acres Drive		15e. INSIDE CITY LIMITS (Specify Yes or No) Yes			
16. FATHER/PARENT - NAME (First Middle Last Suffix) <b>Edwin PARK</b>			17. MOTHER/PARENT - NAME (First Middle Last Suffix) <b>Sima KESTI</b>		
18a. INFORMANT - NAME (Type or Print) Leslie PARK			18b. MAILING ADDRESS (Street or R.F.D. No, City or Town, State, Zip) 5030 Park Grove Court Las Vegas, Nevada 89120		
19a. BURIAL, CREMATION, REMOVAL, OTHER (Specify) Burial		19b. CEMETERY OR CREMATORY - NAME Palm Henderson Cemetery		19c. LOCATION City or Town State Henderson Nevada 89015	
20a. FUNERAL DIRECTOR - SIGNATURE (Or Person Acting as Such) <b>NEGIE A MARUCCI</b> SIGNATURE AUTHENTICATED		20b. FUNERAL DIRECTOR LICENSE NUMBER 848		20c. NAME AND ADDRESS OF FACILITY Palm Mortuary-Henderson 800 S Boulder Hwy Henderson NV 89015	
TRADE CALL - NAME AND ADDRESS					
21a. To the best of my knowledge, death occurred at the time, date and place and due to the cause(s) stated. (Signature & Title) <b>MICHAEL KARAGIOZIS DO</b> SIGNATURE AUTHENTICATED			22a. On the basis of examination and/or investigation, in my opinion death occurred at the time, date and place and due to the cause(s) stated. (Signature & Title)		
21b. DATE SIGNED (Mo/Day/Yr) March 02, 2015		21c. HOUR OF DEATH 03:15		22b. DATE SIGNED (Mo/Day/Yr)	
21d. NAME OF ATTENDING PHYSICIAN IF OTHER THAN CERTIFIER (Type or Print)		22c. HOUR OF DEATH		22d. PRONOUNCED DEAD (Mo/Day/Yr)	
23a. NAME AND ADDRESS OF CERTIFIER (PHYSICIAN, ATTENDING PHYSICIAN, MEDICAL EXAMINER, OR CORONER) (Type or Print) Michael Karagiozis DO 4141 Swenson Las Vegas, NV 89119				23b. LICENSE NUMBER 476	
24a. REGISTRAR (Signature) <b>SUSAN ZANNIS</b> SIGNATURE AUTHENTICATED		24b. DATE RECEIVED BY REGISTRAR (Mo/Day/Yr) March 02, 2015		24c. DEATH DUE TO COMMUNICABLE DISEASE YES <input type="checkbox"/> NO <input checked="" type="checkbox"/>	
25. IMMEDIATE CAUSE (ENTER ONLY ONE CAUSE PER LINE FOR (a), (b), AND (c).) PART I (a) <b>Hepatocellular Carcinoma</b> DUE TO, OR AS A CONSEQUENCE OF: (b) DUE TO, OR AS A CONSEQUENCE OF: (c) DUE TO, OR AS A CONSEQUENCE OF: (d) <b>Diabetes Mellitus 2</b>				Interval between onset and death 5 Years Interval between onset and death Interval between onset and death Interval between onset and death	
PART II OTHER SIGNIFICANT CONDITIONS-Conditions contributing to death but not resulting in the underlying cause given in Part 1.				26. AUTOPSY (Specify Yes or No) No	
28a. ACC., SUICIDE, HOM., UNDET. OR PENDING INVEST. (Specify)		28b. DATE OF INJURY (Mo/Day/Yr)		28c. HOUR OF INJURY	
28e. INJURY AT WORK (Specify Yes or No)		28f. PLACE OF INJURY- At home, farm, street, factory, office building, etc. (Specify)		28g. LOCATION STREET OR R.F.D. No. CITY OR TOWN STATE	
28d. DESCRIBE HOW INJURY OCCURRED					

STATE REGISTRAR

381915



"CERTIFIED TO BE A TRUE AND CORRECT COPY OF THE DOCUMENT ON FILE WITH THE REGISTRAR OF VITAL STATISTICS, STATE OF NEVADA." This copy was issued by the Southern Nevada Health District from State certified documents authorized by the State Board of Health pursuant to NRS 440.175.

DATE ISSUED: MAR 04 2015

Registrar of Vital Statistics By: [Signature]

This Copy not valid unless prepared on engraved border displaying date, seal and signature of Registrar. SOUTHERN NEVADA HEALTH DISTRICT • P.O. Box 3902 • Las Vegas, NV 89127 • 702-759-1010 • Tax ID # 88-0151573

