



OFFICIAL RECORD E03  
AMY ELMER, RECORDER

<b>A.P.N. No.:</b>	001-250-25
<b>Escrow No.:</b>	80513
<b>Recording Requested By:</b>	
Cow County Title Co.	
<b>When Recorded Mail To:</b>	
<b>MATTHEW A. MIELE</b>	
1635 Crescent Point Way	
Reno, NV 89523	

(for recorders use only)

**QUITCLAIM DEED**  
**(Title of Document)**

**This document is being re-recorded to add complete legal description per attached Exhibit "B" here to and made a part hereof**



OFFICIAL RECORD  
LESLIE BOUCHER, RECORDER

APN: 001-250-25  
RPTT: \_\_\_\_\_  
WHEN RECORDED MAIL TO and  
MAIL TAX STATEMENT TO:  
MATTHEW A. MIELE  
1635 CRESCENT POINTE WAY  
RENO, NV 89523

**QUITCLAIM DEED**

THIS INDENTURE WITNESSETH: That Matthew A. Miele and Mary Colleen O'Callaghan-Miele, husband and wife as joint tenants in consideration of ONE Dollar, the receipt of which is hereby acknowledged, hereby quitclaim to Matthew A. Miele, an unmarried man as his sole and separate property all that real property in the County of Lincoln, State of Nevada, bounded and described as follows:

Witness her hand on this 17 day of January, 2018

Mary Colleen O'Callaghan-Miele  
Mary Colleen O'Callaghan-Miele

STATE OF Nevada  
COUNTY OF Clark } SS:

This instrument was acknowledged before me on January 17, 2018  
by Mary Colleen O'Callaghan-Miele

[Signature]  
NOTARY PUBLIC

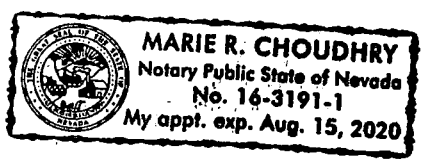

Exhibit A

**LOT 4, PIOCHE TOWN, PCL 4 J&S PROPERTY PARCEL MAP C/208; SUBDIVISION S14, T  
1N, R67E BOOK 218 PAGE 62**

COPY

EXHIBIT "B"

All that certain real property situate in the County of Lincoln , State of Nevada, described as follows:

A portion of the Northwest Quarter (NW1/4) of the Northeast Quarter (NE1/4) of Section 14, Township 1 North, Range 67 East, M.D.B.& M., more particularly described as follows:

Parcel 4 as shown on that certain Parcel Map recorded May 19, 2006 in the Office of the County Recorder of Lincoln County, Nevada in Book C of Plats, page 208 as File No. 126538, Lincoln County, Nevada records.

ASSESSOR'S PARCEL NUMBER FOR 2018 - 2019: 001-250-25

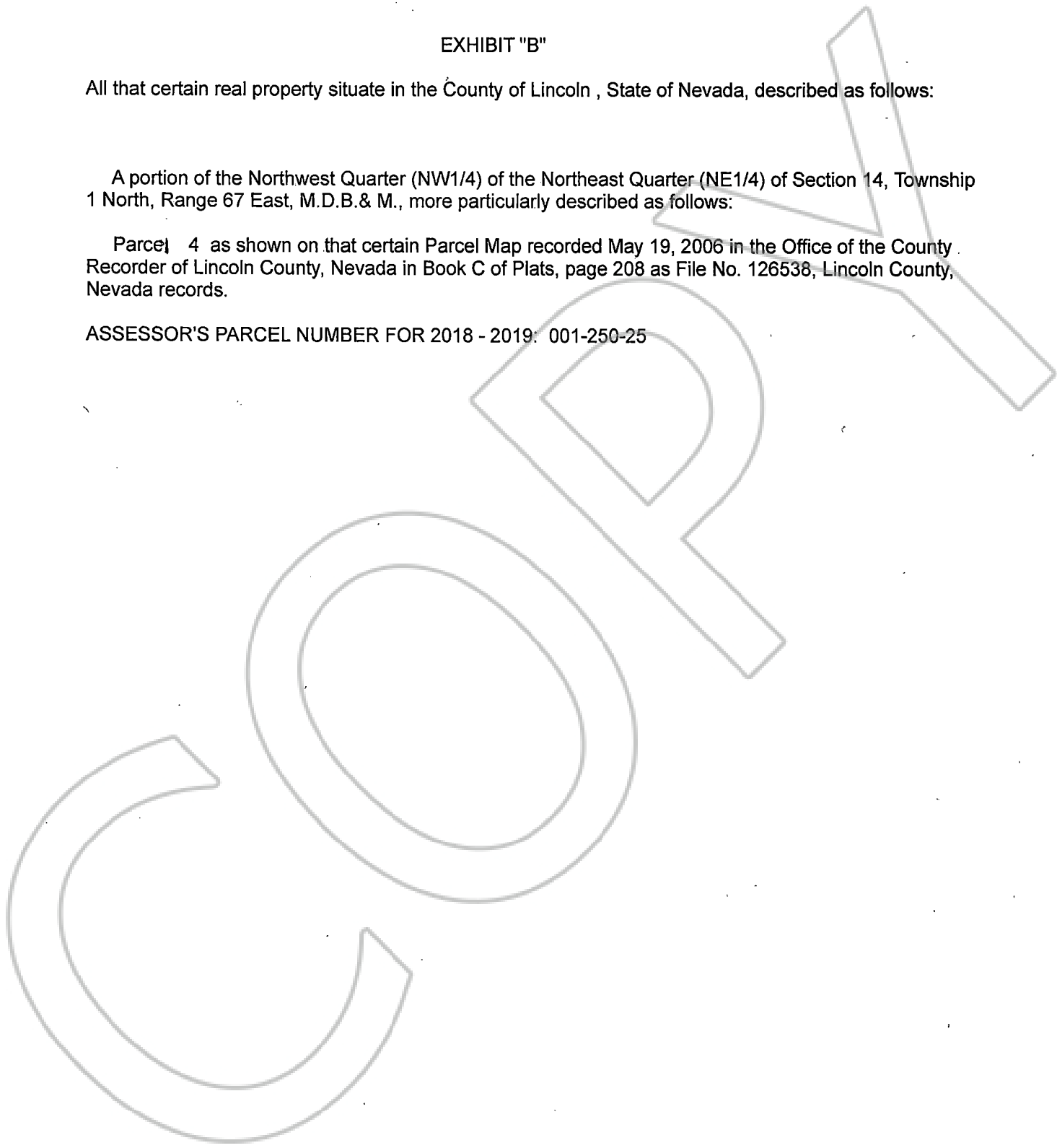

**STATE OF NEVADA  
DECLARATION OF VALUE FORM**

1. Assessor Parcel Number(s)  
 a) 001-250-25  
 b) \_\_\_\_\_  
 c) \_\_\_\_\_  
 d) \_\_\_\_\_

2. Type of Property:  
 a)  Vacant Land      b)  Single Fam. Res.  
 c)  Condo/Twnhse      d)  2-4 Plex  
 e)  Apt.Bldg      f)  Comm'l/Ind'l  
 g)  Agricultural      h)  Mobile Home  
 i)  Other \_\_\_\_\_

<b>FOR RECORDER'S OPTIONAL USE ONLY</b>	
Book: _____	Page: _____
Date of Recording: _____	
Notes: _____	

3. Total Value/Sale Price of Property \_\_\_\_\_  
 Deed in Lieu of Foreclosure Only (value of Property) ( \_\_\_\_\_ )  
 Transfer Tax Value: \_\_\_\_\_  
 Real Property Transfer Tax Due: \_\_\_\_\_

4. If Exemption Claimed:  
 a. Transfer Tax Exemption per NRS 375.090, Section #3  
 b. Explain Reason for Exemption: Re-recording Deed to add complete legal description, RPTT's paid on document 2018-154106

5. Partial Interest Percentage being transferred: 100 %  
 The undersigned declares and acknowledges, under penalty of perjury, pursuant to NRS 375.060 and NRS 375.110, that the information provided is correct to the best of their information and belief, and can be supported by documentation if called upon to substantiate the information provided herein. Furthermore, the parties agree that disallowance of any claimed exemption, or other determination of additional tax due, may result in a penalty of 10% of the tax due plus interest at 1% per month. Pursuant to NRS 375.030, the Buyer and Seller shall be jointly and severally liable for any additional amount owed.

Signature *Matthew A. Miele* Capacity Grantor  
 MATTHEW A. MIELE

Signature \_\_\_\_\_ Capacity Grantee  
 MATTHEW A. MIELE

**SELLER (GRANTOR) INFORMATION  
(REQUIRED)**  
 Print Name: MATTHEW A. MIELE and MARY COLLEEN O'CALLAGHAN-MIELE  
 Address: 1635 Crescent Point Way  
 City: Reno  
 State: NV Zip: 89523

**BUYER (GRANTEE) INFORMATION  
(REQUIRED)**  
 Print Name: MATTHEW A. MIELE and MARY COLLEEN O'CALLAGHAN-MIELE  
 Address: 1635 Crescent Point Way  
 City: Reno  
 State: NV Zip: 89523

**COMPANY/PERSON REQUESTING RECORDING (required if not seller or buyer)**  
 Print Name: Cow County Title Co. Escrow #: 80513  
 Address: P.O. Box 518, 328 Main Street.  
 City: Pioche State: NV Zip: 89043