

GRACIAN UHALDE
JOHN UHALDE AND COMPANY
PO BOX 151088
ELY, NV 89315



0149375

**AFFIDAVIT OF GRACIAN UHALDE
CONCERNING THE PREPARATION AND CONTENTS OF TWO MAPS DEPICTING
EASEMENTS AND RIGHTS-OF-WAY OWNED BY JOHN UHALDE AND COMPANY**

I am Gracian Uhalde and represent the John Uhalde and Company. I have personally hand drawn the locations of John Uhalde and Company livestock trails, water developments, and other existing rights on the two attached maps, or personally directed these locations to be drawn on the attached maps which are identified by the following labels respectively:

- *Easement Map as Hand Drawn by Gracian Uhalde June 30, 2015*
- *Easement Map as Hand Drawn June 30, 2015 by Gracian Uhalde and Robert Steele.*

Base maps were obtained from the Bureau of Land Management (BLM) that consist of USGS quadrangles with the boundaries of various adjudicated grazing allotments depicted by the BLM. These BLM base maps indicate a pattern of roads established prior to the passage of the Federal Land Policy and Management Act of 1976. These roads are all within rights-of-way held by Uhalde or Steele under Federal Statute and in many cases additional public rights-of-way occur in the same alignment. Gracian Uhalde and Robert Steele in turn identified routes of livestock trails and other existing rights that are depicted on the face of the map we prepared jointly.

Gracian N. Uhalde *6-02-16*

Signed Gracian Uhalde Date

State of Nevada, County of Lincoln

Subscribed and sworn to before ~~xx~~ Gracian N. Uhalde ~~xx~~

me this *2nd* day of *June* 20*16*.



Shannon M. Simpson
NOTARY PUBLIC



Fox Mountain

NRS 403.190 Map of county roads filed by board of county highway commissioners, effect of filing of map that includes an R.S. 2477 road; authority of user to file map of minor county road; fees.

1. Except as otherwise provided in subsection 4, upon laying out and designating the county roads as required in NRS 403.170, the board of county highway commissioners shall cause a map of the county to be made, showing the county roads and their designations. The board shall file one copy of the map with the clerk of the board of county highway commissioners, one copy with the Department of Transportation, one copy with the county clerk and one copy with the county recorder.

2. If the map required pursuant to subsection 1 includes a county road located on a right-of-way that the board of county highway commissioners has located, determined the width of and opened for public use pursuant to subsection 2 of NRS 403.191:

(a) The filing of copies of the map pursuant to subsection 1 constitutes the establishment of the existence and location of a right-of-way that is open for public use; and

(b) Acceptance of the map by the Department of Transportation constitutes acknowledgment by the Department of the establishment of the existence and location of a right-of-way that is open for public use.

3. When any road has been designated by the board of county highway commissioners as a standard county road, as provided in NRS 403.180, that designation must be made on the copies of the map on file with the clerk of the board of county highway commissioners, the county clerk, the Department of Transportation and the county recorder.

4. The board of county highway commissioners need not include a minor county road upon the map required by subsection 1. Any person who uses a minor county road may file with the county recorder a map showing the location of the road, appropriately emphasized in black ink upon the map by the person filing it. The map must:

(a) Be a topographical map prepared by the United States Geological Survey, unless the board of county highway commissioners determines that other specific maps are acceptable;

(b) Have written on its face, in black ink, the townships, ranges and sections through which the road traverses.

5. The map so filed is evidence of the existence and location of the road. Each person filing such a map shall pay to the county recorder a fee of \$17 for the first sheet of the map plus \$10 for each additional sheet.

17. Jan. 4, 1975 (S.B. 1919, R.L. p. 2903; NCL § 5377) — (NRS 419.7, 1174, 1993, 1400; 2001, 3220, 2011, 295)

NRS 405.204 Legislative findings and declaration; action by Attorney General authorized.

1. The Legislature hereby finds and declares that the public interest of the State of Nevada is served by keeping accessory roads open and available for use by the residents of this state because:

(a) There exists within this state a large number of accessory roads;

(b) Accessory roads provide access for the control of fire on adjacent lands, the enforcement of laws by peace officers, search and rescue operations, medical personnel and ambulances, and public utilities;

(c) Accessory roads provide access to public lands for members of the general public; and

(d) Accessory roads enhance the taxable value of the private property served by such roads.

2. The Legislature therefore directs that, if an agency of the United States is responsible for the lands over which an accessory road runs pursuant to the closing of an accessory road or demands a fee or permit for the use of an accessory road, the Attorney General may bring an action for a declaratory judgment as soon as practicable on behalf of:

(a) The State and its residents;

(b) Owners of lands served by the road;

(c) Holders of grazing rights served by the road; and

(d) All other users of the road.

3. The Attorney General shall bring an action for a declaratory judgment to vindicate the rights of all users to the unimpeded maintenance, use and enjoyment of the road, and the rights of owners of lands served by the road to just compensation for any closing found necessary.

(Added by NRS by 1993, 1403)

**EASEMENT MAP
AS HAND DRAWN BY GRACIAN UHALDE
JUNE 30, 2015**

RECORDING REQUESTED FOR:

JOHN UHALDE AND COMPANY
C/O GRACIAN UHALDE
PO BOX 151088
ELY, NV 89315

EASEMENTS OR RIGHTS OF WAY AS DEPICTED WERE ESTABLISHED PRIOR TO 1976 AND IN CONTINUOUS USE WITHIN WHAT ARE NOW ADJUDICATED LIVESTOCK ALLOTMENTS INCLUDING, BUT NOT LIMITED TO:

- Those existing property rights acquired under local law, custom, and decision of the courts as confirmed by the Acts of 1866 and 1870.
- RS 2477 RIGHTS-OF-WAY (ROW) for roads and trails used for transportation, and fence lines and ROW used for livestock travel when driven or herded.
- RS 2338 ROW for pipelines, ditches, and canals for water conveyance.
- RS 2340 ROW and Stock Raising Homestead Act (December 29, 1916 as amended January 29, 1929 and June 21, 1949) Easement for site locations including wells, springs, troughs, reservoirs each site is 160 acres and not drawn to scale on this map.

Easement widths along roads, fence lines, water pipelines, and water conveyance ditches are one hundred feet (100ft) or generally 50 feet both ways from the center line.

Easement widths of livestock trails including those trails that follow the alignment of roads or other ROW are all three (3) miles in width. *McClellan v. United States*, 260 U.S. 353 (1922) and others recognized a trail for livestock to be herded or driven as being three (3) miles wide. Both federal regulations and the statutes and police powers of a State are valid within federally controlled public lands. These livestock trails are also valid as established under Section 10 of Stockraising Homestead Act.

Only easements or ROW within those Allotments grazed or traversed by livestock belonging to Uhalde are of concern in this map; easements that belong to other ranches are not included.

**LEGEND
UHALDE EASEMENT MAP**

Base Map has been provided by Bureau of Land Management through their Geographic Information System
Roads shown on the BLM base map are indicated with a solid or dashed line
Unique symbols for BLM maps include
WSA for Wilderness Study Area
HMA for wild horses and burros Herd Management Area
Livestock Grazing Allotment boundaries marked with a solid line
Livestock Grazing Allotments as identified by name on the map
i.e. "Cottonwood", "Black Bluff", etc.

John Uhalde and Company Allotments (Uhalde)
West Timber Mountain
South Coal Valley
Murphy Gap
Batterman Wash
Worthington Mountain
Black Bluff

Livestock Trail Easements approximate centerline
Uhalde Livestock Trail (U)

Road Right-of-Way approximate centerline
Water pipeline Right-of-Way approximate centerline
Uhalde pipeline

Water conveyance ditch Right-of-Way approximate centerline
"livestock water ditch/canal"

Well X
Spring S
Trough T
Reservoir R

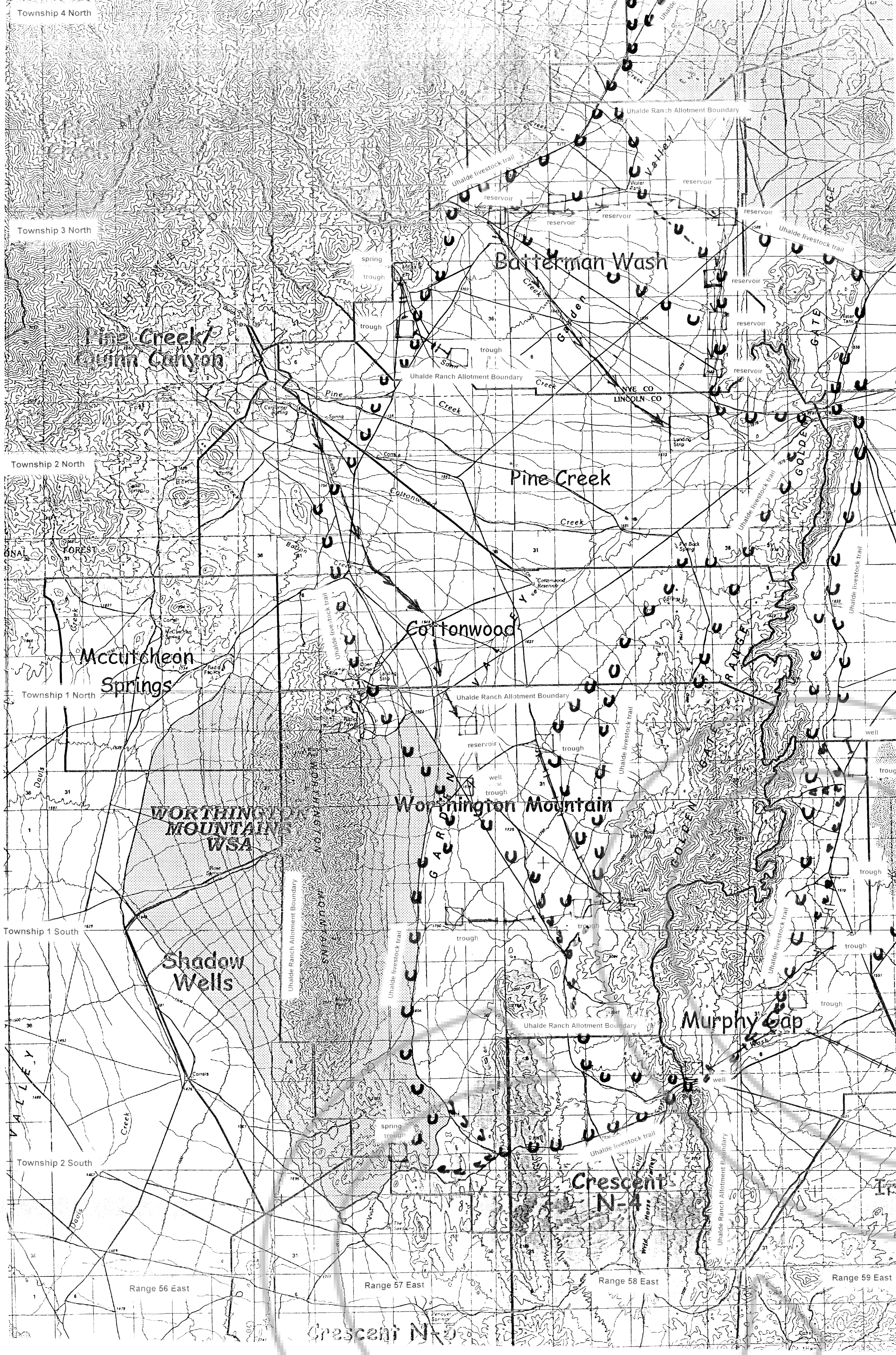

Township 4 North
Township 3 North
Township 2 North
Township 1 North
Township 1 South
Township 2 South

Range 56 East
Range 57 East
Range 58 East
Range 59 East
Range 60 East
Range 61 East
Range 62 East
Range 63 East

Black Bluff
Narrows
Rattlesnake
White River
Oak Springs
Mustang
Pahroc
Crescent N-4
Crescent N-5
Black Horse
Murphy Gap
Worthington Mountain
Cottonwood
Pine Creek
Batterman Wash
NEEDLES
COAL VALLEY
West Timber Mountain
Timber Mountain
Fox Mountain

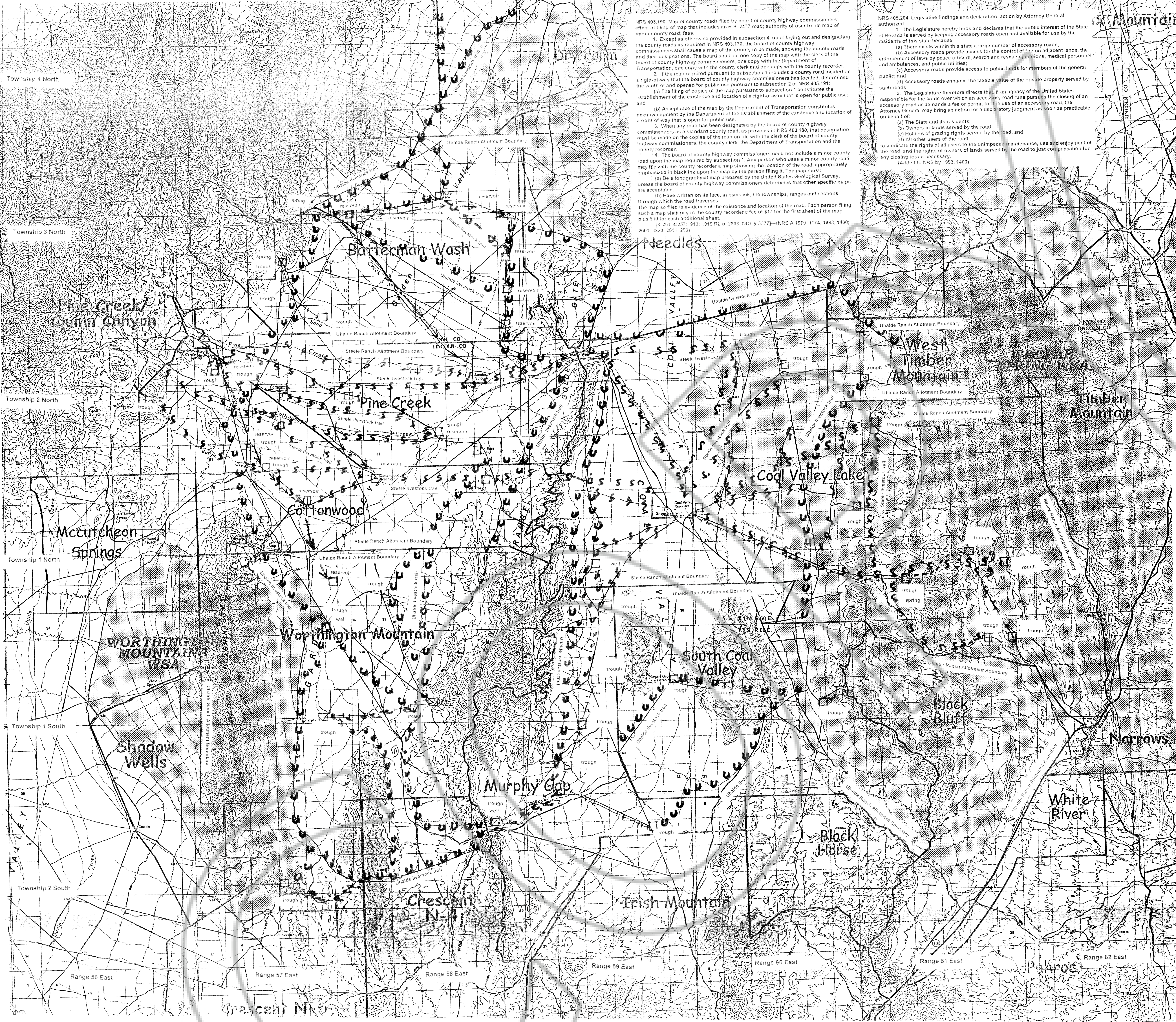

NRS 403.190 Map of county roads filed by board of county highway commissioners; effect of filing of map that includes an R.S. 2477 road; authority of user to file map of minor county road; fees.

1. Except as otherwise provided in subsection 4, upon laying out and designating the county roads as required in NRS 403.170, the board of county highway commissioners shall cause a map of the county to be made, showing the county roads and their designations. The board shall file one copy of the map with the clerk of the board of county highway commissioners, one copy with the Department of Transportation, one copy with the county clerk and one copy with the county recorder.

2. If the map required pursuant to subsection 1 includes a county road located on a right-of-way that the board of county highway commissioners has located, determined the width of and opened for public use pursuant to subsection 2 of NRS 405.191:

(a) The filing of copies of the map pursuant to subsection 1 constitutes the establishment of the existence and location of a right-of-way that is open for public use; and

(b) Acceptance of the map by the Department of Transportation constitutes acknowledgment by the Department of the establishment of the existence and location of a right-of-way that is open for public use.

3. When any road has been designated by the board of county highway commissioners as a standard county road, as provided in NRS 403.180, that designation must be made on the copies of the map on file with the clerk of the board of county highway commissioners, the county clerk, the Department of Transportation and the county recorder.

4. The board of county highway commissioners need not include a minor county road upon the map required by subsection 1. Any person who uses a minor county road may file with the county recorder a map showing the location of the road, appropriately emphasized in black ink upon the map by the person filing it. The map must:

(a) Be a topographical map prepared by the United States Geological Survey, unless the board of county highway commissioners determines that other specific maps are acceptable;

(b) Have written on its face, in black ink, the townships, ranges and sections through which the road traverses.

The map so filed is evidence of the existence and location of the road. Each person filing such a map shall pay to the county recorder a fee of \$17 for the first sheet of the map plus \$10 for each additional sheet.

(3- Art. 4 257-1913; 1919 R.L. 2903; NCL § 5377)-(NRS A 1979, 1174; 1993, 1400; 2001, 3220; 2011, 294)

NRS 405.204 Legislative findings and declaration; action by Attorney General authorized.

1. The Legislature hereby finds and declares that the public interest of the State of Nevada is served by keeping accessory roads open and available for use by the residents of this state because:

(a) There exists within this state a large number of accessory roads;

(b) Accessory roads provide access for the control of fire on adjacent lands, the enforcement of laws by peace officers, search and rescue operations, medical personnel and ambulances, and public utilities;

(c) Accessory roads provide access to public lands for members of the general public; and

(d) Accessory roads enhance the taxable value of the private property served by such roads.

2. The Legislature therefore directs that, if an agency of the United States responsible for the lands over which an accessory road runs pursues the closing of an accessory road or demands a fee or permit for the use of an accessory road, the Attorney General may bring an action for a declaratory judgment as soon as practicable on behalf of:

(a) The State and its residents;

(b) Owners of lands served by the road;

(c) Holders of grazing rights served by the road; and

(d) All other users of the road.

to vindicate the rights of all users to the unimpeded maintenance, use and enjoyment of the road, and the rights of owners of lands served by the road to just compensation for any closing found necessary.

(Added to NRS by 1993, 1403)

**EASEMENT MAP
AS HAND DRAWN JUNE 30, 2015 BY
GRACIAN UHALDE AND ROBERT STEELE**

RECORDING REQUESTED FOR:

JOHN UHALDE AND COMPANY
C/O GRACIAN UHALDE
PO BOX 151088
ELY, NV 89315

ROBERT STEELE
LOIS STEELE
CHAD STEELE
ANTHONY STEELE
PO BOX 355
ALAMO, NV 89001

EASEMENTS OR RIGHTS OF WAY AS DEPICTED WERE ESTABLISHED PRIOR TO 1976 AND IN CONTINUOUS USE WITHIN WHAT ARE NOW ADJUDICATED LIVESTOCK ALLOTMENTS INCLUDING, BUT NOT LIMITED TO:

- Those existing property rights acquired under local law, custom, and decision of the courts as confirmed by the Acts of 1866 and 1870.
- RS 2477 RIGHTS-OF-WAY (ROW) for roads and trails used for transportation, and fences and ROW used for livestock travel when driven or herded.
- RS 2339 ROW for pipelines, ditches, and canals for water conveyance.
- RS 2340 ROW and Stock Raising Homestead Act (December 29, 1916 as amended January 29, 1929 and June 21, 1949) Easement for site locations including wells, springs, troughs, reservoirs each site is 160 acres and not drawn to scale on this map.

Easement widths along roads, fences, water pipelines, and water conveyance ditches are one hundred feet (100ft) or generally 50 feet both ways from the center line.

Easement widths of livestock trails including those trails that follow the alignment of roads or other ROW are all three (3) miles in width. *McKadey v. United States*, 260 U.S. 353 (1922) and others recognized a trail for livestock to be herded or driven as being three (3) miles wide. Both federal regulations and the statutes and police powers of a State are valid within federally controlled public lands. These livestock trails are also valid as established under Section 10 of Stockraising Homestead Act.

Only easements or ROW within those Allotments grazed or traversed by livestock belonging to either Uhalde or to Steele are of concern in this map; easements that belong to other ranches are not included.

**LEGEND
UHALDE AND STEELE EASEMENT MAP**

Base Map has been provided by Bureau of Land Management through their Geographic Information System

Roads shown on the BLM base map are indicated with a solid or dashed line

Unique symbols for BLM maps include

- WSA for Wilderness Study Area
- HMA for wild horses and burros Herd Management Area
- Livestock Grazing Allotment boundaries marked with a solid line
- Livestock Grazing Allotments as identified by name on the map i.e. "Cottonwood", "Black Bluff", etc.

John Uhalde and Company Allotments (Uhalde)

- West Timber Mountain
- South Coal Valley
- Murphy Gap
- Batterman Wash
- Worthington Mountain
- Black Bluff

Robert, Lois, Chad, and Anthony Steele Allotments

- Coal Valley Lake
- Pine Creek
- Cottonwood

Livestock Trail Easements approximate centerline

U Uhalde Livestock Trail (UT) S Steele Livestock Trail (ST)

Road Right-of-Way approximate centerline

Water pipeline Right-of-Way approximate centerline

Uhalde pipeline (UP) Steele pipeline (SP)

Water conveyance ditch Right-of-Way approximate centerline

"livestock water ditch/canal"

Well

Spring

Trough

Reservoir

