

Official RecordRecording requested By
ARTISAN SURVEYING GROUPLincoln County - NV
Leslie Boucher - Recorder

Fee: \$26.00

Page 1 of 13

RPTT:

Recorded By: AE

Book- D Page- 0160

**CORNER RECORD**

SECTIONS: 1, 12, 13, T4S, R66E, MDM.

SECTIONS: 26, T3S, R67E, MDM.

SECTIONS: 5,6,7,8,17,18, T4S, R67E, MDM.

SURVEYOR'S CERTIFICATESheet 1 of 13

I, Timothy J. Wolf, a Professional Land Surveyor, registered in the State of Nevada, as agent for Artisan Surveying Group, A NV LLC, certify;

1) This Corner Record represents the establishment or restoration of a corner or accessory to a corner conducted under my direct supervision.

2) The monument or accessories perpetuated lie within the Sections 1, 12, 13, Township 4 South Range 66 East; Sections 5, 6, 7, 8, 17, 18, Township 4 South, Range 67 East, and Section 26, Township 3 South, Range 67 East, as referenced to the Mount Diablo Meridian, Lincoln County, Nevada, and the establishment, evidence, or restoration was completed in October, 2015.

3) This Corner Record has been filed pursuant to N.R.S. 329.140 or N.R.S. 329.150 and complies with the provisions of Nevada Administrative Code Section 329 and any local ordinances in effect on the date that the establishment or restoration was completed.

4) The monument or witness corner monument and accessories found are of the character shown, occupy the positions indicated and are of sufficient durability (latter solely if established by Artisan Surveying Group, a NV LLC).

*Timothy J. Wolf
Professional Land Surveyor
Nevada License No. 9677
Agent, Artisan Surveying Group, a NV LLC*



RECORDER, PLEASE RETURN TO:
Artisan Surveying Group
P.O. Box 396
Pioche, NV 89043
(775) 962-LAND (5263)
www.ArtisanSurveying.com



0148417

Sec. 7,8,17,18
Twn. 4 South
Rng. 67 East
M.D.M.

CORNER RECORD MONUMENTS

Sheet 2 of 13

ARTISAN
"WHERE ART & MEASUREMENT SCIENCE CONVERGE"
GEODETIC NORTH

PRIMARY CONTROL

SET 2" DIA. ALUMINUM "CCC4"
LAT: 37°35'41.95704"N
LON: 114°32'15.67075"W
E.H.: 1295.606m



SET 2" DIA. ALUMINUM "CCC9"
LAT: 37°37'07.22199"N
LON: 114°30'58.22807"W
E.H.: 1386.059m



CADASTRAL MONUMENT

FOUND 2X4" IRON PLATE ON
3"DIA. I.P. IN MND. STONE.
LAT: 37°36'25.42876"N
LON: 114°31'02.65173"W
E.H.: 1315.750m
(1.5 HOURS STATIC)
FONGER POINT NO. 1

T4S	R67E	CCC10
7 8		
18 17		
11	20 63	RLS
F.W.M&SON		1795

DATUM

PRIMARY CONTROL POINT POSITIONS FOR "CCC4" AND "CCC9" AS SHOWN WERE ESTABLISHED USING NGS' OPUS WITH 50+ HOURS OF STATIC DATA EACH, NGS NAD83 (2010.0000).
[HTTP://WWW.NGS.NOAA.GOV/OPUS](http://www.ngs.noaa.gov/opus)



REFERENCES

RECORD OF SURVEY, CITY OF CALIENTE, RICHARD E. FONGER, JULY 6, 1990.



Sec. 12,13; 7,18
 Twn. 4 South
 Rng. 66; Rng. 67 East
 M.D.M.

CORNER RECORD MONUMENTS

Sheet 3 of 13

ARTISAN
 "WHERE ART & MEASUREMENT SCIENCE CONVERGE"
GEODETIC NORTH

PRIMARY CONTROL

SET 2" DIA. ALUMINUM "CCC4"
 LAT: 37°35'41.95704"N
 LON: 114°32'15.67075"W
 E.H.: 1295.606m

SET 2" DIA. ALUMINUM "CCC9"
 LAT: 37°37'07.22199"N
 LON: 114°30'58.22807"W
 E.H.: 1386.059m

CADASTRAL MONUMENT

FOUND 3-1/4" DIA. ALUMINUM
 MON. ON 3"DIA. A.P, MND. STONE.
 LAT: 37°36'26.44295"N
 LON: 114°32'07.52909"W
 E.H.: 1412.779m
 (0.5 HOURS STATIC)
 FONGER POINT NO. 3

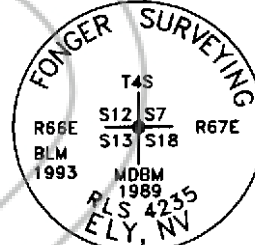

DATUM

PRIMARY CONTROL POINT POSITIONS FOR "CCC4" AND "CCC9" AS SHOWN WERE ESTABLISHED USING NGS' OPUS WITH 50+ HOURS OF STATIC DATA EACH, NGS NAD83 (2010.0000).
[HTTP://WWW.NGS.NOAA.GOV/OPUS](http://www.ngs.noaa.gov/opus)

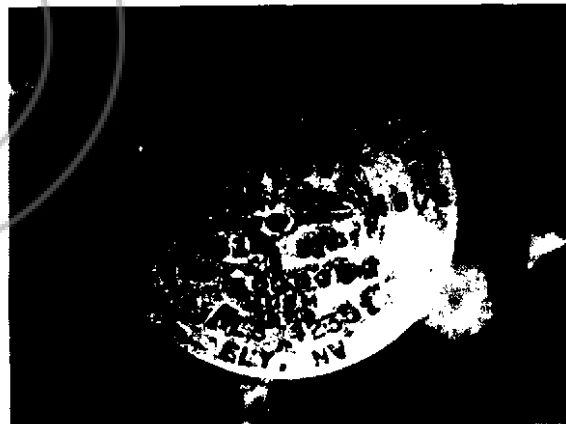
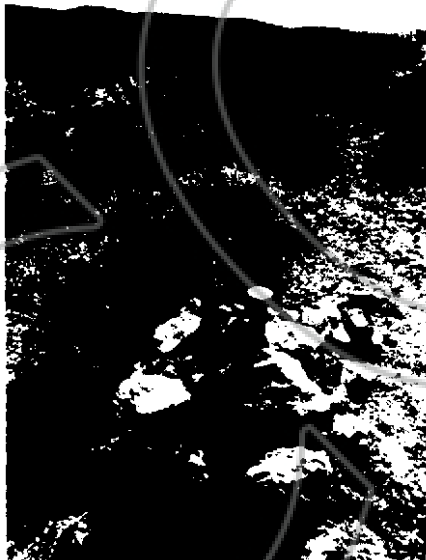

REFERENCES

RECORD OF SURVEY, CITY OF CALIENTE, RICHARD E. FONGER, JULY 6, 1990.



Sec. 1,12; 6,7
Twn. 4 South
Rng. 66; Rng. 67 East
M.D.M.

CORNER RECORD MONUMENTS

Sheet 4 of 13

ARTISAN
GEODETTIC "WHERE ART & MEASUREMENT SCIENCE CONVERGE"
NORTH

PRIMARY CONTROL

SET 2" DIA. ALUMINUM "CCC4"
LAT: 37°35'41.95704"N
LON: 114°32'15.67075"W
E.H.: 1295.606m



SET 2" DIA. ALUMINUM "CCC9"
LAT: 37°37'07.22199"N
LON: 114°30'58.22807"W
E.H.: 1386.059m



CADASTRAL
MONUMENT

FOUND 3-1/4" DIA. ALUMINUM
MON. ON 3"DIA. A.P, MND. STONE.
LAT: 37°37'18.80423"N
LON: 114°32'06.72455"W
E.H.: 1387.947m
(0.5 HOURS STATIC)
FONGER POINT NO. 5

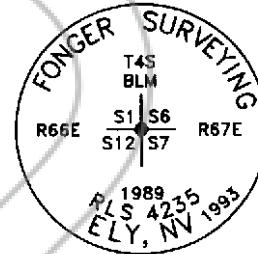

DATUM

PRIMARY CONTROL POINT POSITIONS FOR "CCC4" AND "CCC9" AS SHOWN WERE ESTABLISHED USING NGS' OPUS WITH 50+ HOURS OF STATIC DATA EACH, NGS NAD83 (2010.0000).
[HTTP://WWW.NGS.NOAA.GOV/OPUS](http://www.ngs.noaa.gov/opus)

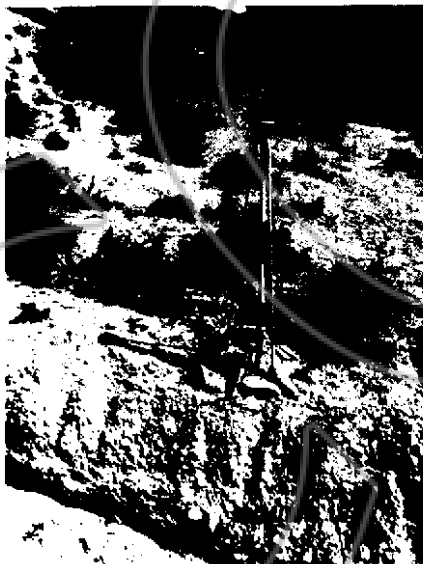

REFERENCES

RECORD OF SURVEY, CITY OF CALIENTE, RICHARD E. FONGER, JULY 6, 1990.

Sec. 5
Twn. 4 South
Rng. 67 East
M.D.M.

CORNER RECORD MONUMENTS

Sheet 5 of 13

ARTISAN
"WHERE ART & MEASUREMENT SCIENCE CONVERGE"
GEODETTIC
NORTH

PRIMARY CONTROL

SET 2" DIA. ALUMINUM "CCC4"
LAT: 37°35'41.95704"N
LON: 114°32'15.67075"W
E.H.: 1295.606m



SET 2" DIA. ALUMINUM "CCC9"
LAT: 37°37'07.22199"N
LON: 114°30'58.22807"W
E.H.: 1386.059m



CADASTRAL
MONUMENT

FOUND 2-1/2" DIA. BRASS MON.
IN CONCRETE IN PAVEMENT
LAT: 37°37'39.48347"N
LON: 114°30'35.00656"W
E.H.: 1328.940m
(0.3 HOURS STATIC)
FONGER POINT NO. 14



DATUM

PRIMARY CONTROL POINT POSITIONS FOR
"CCC4" AND "CCC9" AS SHOWN WERE
ESTABLISHED USING NGS' OPUS WITH
50+ HOURS OF STATIC DATA EACH,
NGS NAD83 (2010.0000).
[HTTP://WWW.NGS.NOAA.GOV/OPUS](http://www.ngs.noaa.gov/opus)

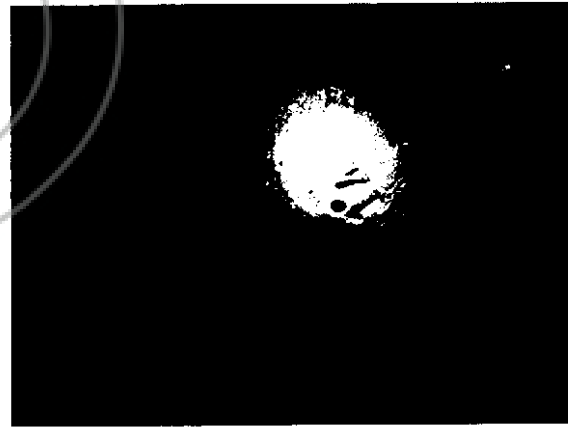

REFERENCES

RECORD OF SURVEY, CITY OF CALIENTE, RICHARD E. FONGER, JULY 6, 1990.



0148417

Sec. 5
Twn. 4 South
Rng. 67 East
M.D.M.

CORNER RECORD MONUMENTS

Sheet 6 of 13

ARTISAN
GEODETTIC "WHERE ART & MEASUREMENT SCIENCE CONVERGE"
NORTH

PRIMARY CONTROL

SET 2" DIA. ALUMINUM "CCC4"
LAT: 37°35'41.95704"N
LON: 114°32'15.67075"W
E.H.: 1295.606m



SET 2" DIA. ALUMINUM "CCC9"
LAT: 37°37'07.22199"N
LON: 114°30'58.22807"W
E.H.: 1386.059m



**CADASTRAL
MONUMENT**

FOUND 2-1/2" DIA. BRASS MON.
IN CONCRETE IN PAVEMENT
LAT: 37°37'46.88437"N
LON: 114°30'49.26524"W
E.H.: 1336.705m
(0.3 HOURS STATIC)
FONGER POINT NO. 16

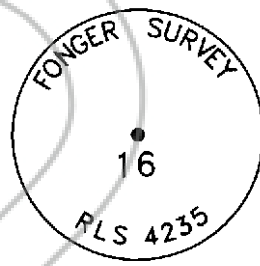

DATUM

PRIMARY CONTROL POINT POSITIONS FOR
"CCC4" AND "CCC9" AS SHOWN WERE
ESTABLISHED USING NGS' OPUS WITH
50+ HOURS OF STATIC DATA EACH,
NGS NAD83 (2010.0000).
[HTTP://WWW.NGS.NOAA.GOV/OPUS](http://www.ngs.noaa.gov/opus)



REFERENCES

RECORD OF SURVEY, CITY OF CALIENTE, RICHARD E. FONGER, JULY 6, 1990.



Sec. 8
Twn. 4 South
Rng. 67 East
M.D.M.

CORNER RECORD MONUMENTS

Sheet 7 of 13

ARTISAN
"WHERE ART & MEASUREMENT SCIENCE CONVERGE"
GEODETIC NORTH

PRIMARY CONTROL

SET 2" DIA. ALUMINUM "CCC4"
LAT: 37°35'41.95704"N
LON: 114°32'15.67075"W
E.H.: 1295.606m



SET 2" DIA. ALUMINUM "CCC9"
LAT: 37°37'07.22199"N
LON: 114°30'58.22807"W
E.H.: 1386.059m



CADASTRAL MONUMENT

FOUND NO.5 REBAR IN 3" DIA.
I.P. ENCASED IN CONCRETE
LAT: 37°36'51.58411"N
LON: 114°30'29.83057"W
E.H.: 1328.321m
(0.3 HOURS STATIC)
FONGER POINT NO. 94

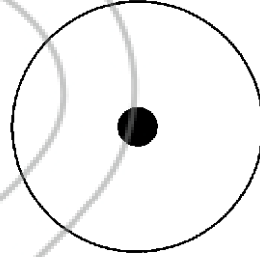

DATUM

PRIMARY CONTROL POINT POSITIONS FOR "CCC4" AND "CCC9" AS SHOWN WERE ESTABLISHED USING NGS' OPUS WITH 50+ HOURS OF STATIC DATA EACH, NGS NAD83 (2010.0000).
[HTTP://WWW.NGS.NOAA.GOV/OPUS](http://www.ngs.noaa.gov/opus)

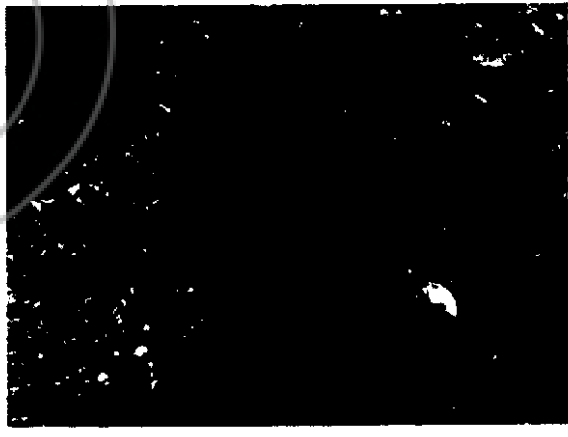
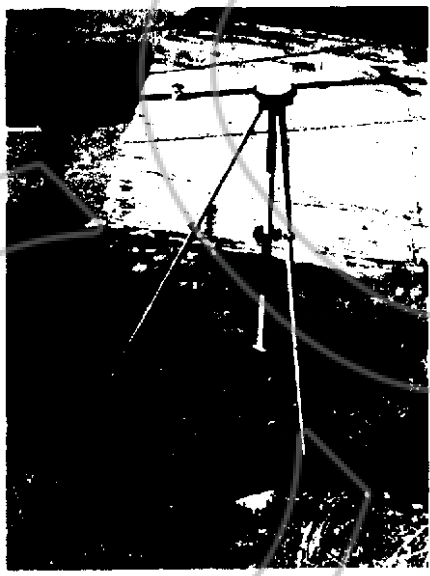

REFERENCES

RECORD OF SURVEY, CITY OF CALIENTE, RICHARD E. FONGER, JULY 6, 1990.



MINUTES OF THE REGULAR MEETING OF THE CITY COUNCIL OF THE CITY OF CALIENTE HELD JULY 6, 1990 AT 7:00 P.M. AT CALIENTE CITY HALL

The regular meeting of the City Council of the City of Caliente was held July 6, 1990 at 7:00 P.M. at Caliente City Hall. Present at the meeting were His Honor Mayor George T. Rowe and Councilmembers Wesley Holt, Harold Charlton and John L Avery, absent was Councilwoman Wilcox. Others present were Glenn Van Roekel, Richard Fonger, Helena Goings, John Hatch, Mr. & Mrs. Robert Thomas, Chief Simmons, Jerry Maeder and Deputy City Clerk Frances Harrington.

Mayor Rowe opened the meeting and proceeded with the Pledge of Allegiance and confirmation of compliance to the Open Meeting Law. Motion was made by Councilman Holt to approve the minutes of the June 20, 1990 meeting as written, motion was seconded by Councilman Charlton and voting was unanimous with Councilwoman Wilcox absent.

Claims against the City (\$43,684.07) and Utilities (\$14,139.18) were approved.

1225

ADMINISTRATIVE

1. Richard Fonger presented the council with Plat 1 Monument Survey, he stated that monument markers had been found in some locations and that he and Lenard Smith had placed new markers showing the different sections. He said they had difficulties with the area from Denton Street to Spring Heights. He agreed to do a Plat 2 Monument Survey of just this area to 50 scale with prescriptive rights. A motion was made by Councilman Holt to approve the Plat 1 Monument Survey, Councilman Avery seconded the motion and voting was unanimous with Councilwoman Wilcox absent. Mr. Fonger will have the Plat map recorded. Mayor Rowe asked Richard Fonger to submit a proposal to have the road Ronal Young donated by BLM designated and also the Cemetery Road, Antelope Canyon and City boundaries determined. Glenn Van Roekel said there was money available through the grant to pay for these to be done.

2. Glenn Van Roekel will update the Council at next meeting on any resolutions that will be brought up at the Nevada League of Cities meeting to be held in Lovelock on August 23, 24 & 25. He said he had reserved 5 rooms, it was agreed that Mayor Rowe, Councilmen Holt and Avery, City Clerk Darlene Prince and Glenn Van Roekel will attend the meetings.

3. A short recess was called so that the councilmember could review the applications for part time clerk. When the meeting readjourned, the Mayor read a recommendation from City Clerk Darlene Prince for Whitney Barnes. Councilman Holt made a motion to hire Whitney Barnes for the part time position. Councilman Avery seconded the motion and voting was unanimous. Councilwoman Wilcox was absent.

4. Mayor Rowe said he had been contacted asking the City to put an ad in the Little League Brochure. Panaca is hosting the District Little League Tournament on July 17 thru 18. He said many of the



visiting players will be housed in Caliente. Councilman Holt made a motion to purchase a full page ad for \$15.00 in the brochure. Councilman Charlton seconded the motion and voting was unanimous, with Councilwoman Wilcox absent.

5. Mayor Rowe said the Groundshakers had donated \$735.00 and a plaque to the City, the also gave the VFD a check for \$424 and said that all profit from T-shirt sales will be donated to the VFD. Jerry Maeder said he though it would be nice if a thank you was put in the paper. Mayor Rowe agreed.

6. Glenn Van Roekel said that the Nuclear Waste Project Office was having a meeting on July 18th and he would go with Geri Ann Stanton so that he could introduce her to the other members and then she would be the representative from this area at any future meetings.

7. Mayor Rowe read a thank you letter from the Lincoln County Rodeo Association to the City for their cooperation.

ECONOMIC DEVELOPMENT

Glenn Van Roekel said he had talked to Drexel Smith with Wiley Laboratories regarding the Aeojet project on Kane Springs Road, they are still having problems with the tortoise, but are going ahead with their plans.

Glenn said Jim Gottholm had told him that they were only a week away from having something concrete to bring before the council on the property by the LDS church.

1224

PLANNING

Planning Committee meeting is set for July 19, 1990.

PARKS & RECREATION

Councilman Avery said he wanted to know if there were closing hours on the pool when it is rented. Council agreed that the closing time was 11:00 P. M. and that the police had the right to request people to leave after that time. It should also be stated in the rules and regulations given to the people at the time they rent the pool. Mayor Rowe stated that the other parks in town are open to the public and there is no closing time on them.

Councilman Avery said that the life guards will have swimming lessons Monday thru Friday for two weeks from 8:00 to 11:00 A.M. Tonya Perkins will teach the beginners class. All the instructors will be paid \$10.00 per hour, the City will make approximately \$150.00 from these lessons.

UTILITIES

Glenn Van Roekel said he was on the RTC agenda to go before the committee on the 17th Meeting to ask for an advance of funds to finish two streets. It was agreed that Main and 1st Street would be done this year and Alice Street next year. He said he thought that Wilkin would start next week on the paving. The price Wilkin



quoted does not include seal, he said that maybe after next quarter there would be enough money to do the seal. Mayor asked Glenn to see if funding for seal could be obtained when he goes to the 7/17/90 RTC meeting.

Mayor gave a copy of a bid list from General Service to Councilman Charlton to look over and see if he thought any of the vehicles could be purchased for City needs. He said Frank had looked the list over and checked off some pickups, some of the City pickups are in terrible shape and need replacing. Councilman Charlton felt the City did not need any used pickups. Council agreed to send Frank down to look over the vehicles, Councilman Charlton suggested Ernie go with Frank. Glenn will check to see if vehicle could be removed from auction or obtained at minimum bid. Jerry Maeder said that Soil Conservation has a 4 wheel drive vehicle for bid. Glenn will check on this to see what they are asking for minimum bid.

Jerry Maeder asked when street lights would be installed on Cemetery Rd. Mayor Rowe asked that another work order be made. Jerry Mader also stated he had no water pressure, he said he would give right-of-way through his land for water line. Glenn will check on cost of running the line.

Jerry Maeder asked Council why a tire was taken to Beryl Junction for repair when his place could have done it for less. He also said that other repairs to city vehicles have been done out of town that could have been done here. Council agreed that all repairs should be done here if possible.

PUBLIC SAFETY

Chief Simmons said there were no major problems over the July 4th holiday. He reported the air conditioner in the Police Office had gone out, Gaylon has ordered a new motor. Jerry Maeder said he felt the police hours should be changed so that there was coverage from 4:00 AM to 8:00 AM and that it was not necessary to have coverage during the daylight hours. Mayor said there were no set hours on coverage so that noone would know when there was not a police officer on duty.

There being no further business to bring before Council the meeting was adjourned by Mayor Rowe at 9:25 P.M.

1223

Barlene Prince

CITY CLERK
OF BENTON
COUNTY
ARIZONA

George T. Rowe
MAYOR



PUBLIC NOTICE

Fonger City of Caliente Control Map and Official City of Caliente Council Approval

This Notice is hereby provided as an inextricable exhibit of facts and related thoughts concerned with the map sealed by Richard E. Fonger, PLS, on July 6, 1990 for exhibition within the City of Caliente Council meeting that same day of July 6, 1990. Said map was unanimously approved by present City Council Members on the evening of July 6, 1990. And for good and valuable consideration said Fonger Map is included upon the 2015 Caliente City Control map.

General History

In the late 1980's, Mr. Richard E. Fonger, Professional Land Surveyor, U.S. Mineral Surveyor, former Lincoln and White Pine County Surveyor, was commissioned to perform a series of surveys to interrelate various subdivisions that had been platted within the City of Caliente annexation boundaries. Although the terms of that contract are not presently available for review; what is available are the remnant facts; a number of Fonger Survey Company monuments and the subject Record of Survey entitled "Record-of-Survey Showing Plat 1 Monument Survey" for the City of Caliente, Portions of Section 5, 7 and 8, T4S, R67E, MDB&M, located in Lincoln County, NV.

Pursuant to this contract; remnant facts infer that the City of Caliente spend a considerable amount of public funds on behalf of Mr. Richard E. Fonger, PLS, to research, survey, analyze, re-survey and monument exterior boundaries or centerline of dedicated or otherwise roadways for long-term historical use and harmony among land owners and city routes. Fundamental to the purpose of intentionally digging holes in hard rock and pavement surfaces for the purpose of pouring concrete footings for which to construct and erect forged either 3.25" diameter aluminum, or 2" diameter brass monuments within that concrete complete with his company name Fonger Surveying Co. upon them and to imprint the monuments with other identifying features such as corresponding map numbers, and to cause a hand-drafted map to be prepared indicating that he made arrangements and met public meeting notice laws to be placed upon the agenda of the July 6, 1990 City Council Meeting speaks volumes to the value and premeditation associated with the remnant facts of map and monuments.

The subject map was professionally sealed and stamped on July 6, 1990, by Mr. Richard E. Fonger, PLS No. 4253. The subject sealed Record of Survey Control Map depicts that the City of Caliente was to meet, discuss and approve the map. Official records indicate that the map was approved but that additional work was to be included and a second map was to be prepared. Apparently that second work and map was not completed. According to online ancestry sources, Mr. Richard Fonger, PLS, passed away on May 8, 2005. He is therefore no longer accessible to discuss the merits of the work or the reason that the first map was not recorded within 90-days of setting the approximate 100-monuments and mapping this work which cumulatively would complete the survey, as then required by NRS 625.340.

Early statutes were silent in adequate subdivision corner monumentation, protection, and perpetuation. Restoring monuments over the course of an approximate 220-year period of little to no laws, to those that were crafted subject to changing monumentation and perpetuation aspects as well as mapping and other laws; presents a challenging aspect that can have adverse impacts to land values and access to lending assistance. Caliente is no exception where Federal Homestead Entry, Federal Land Grant, Federal Public Land Survey System actions, remnants



concerning Federal and State Highway acquisition and bifurcation, as well as Federal Mineral Patent and unpatented mining activities create a condition that makes land retracement difficult..

Mr. Fonger's work, if based upon the preceding in terms of sufficient research, analysis, documentation, monumentation, investigation and completion surveying could amount to a substantial expenditure. Adding the costs of administration, public meeting attendance, public counsel, map production and other considerations could establish a cost that may exceed one half million dollars (\$500,000.00) in current monetary value.

The undersigned, as an agent for Artisan Surveying Group, a NV LLC, has attempted to work with the Public Entities at the additional insistence of Mr. Lenard Smith, PLS No. 12751, agent, Lenard Smith Land Survey, to materialize a method to preserve the Fonger monuments and mapping. Mr. Smith has been relying on Fonger monuments and mapping for nearly three (3) decades in varying capacity. He has found the spatial locations and resolve invaluable at times. He is therefore steadfast in his resolve to continue his legacy of use in keeping with the intent of continuing to aspire to a harmonious solution to future Caliente land boundary practice. No professional of record has attempted to relate the amount of various subdivisions within the City of Caliente as did Mr. Fonger. And to date; no professional has been re-commissioned to finish the work.

Artisan's primary responsibility for our 2015 contract was to establish an accurate City of Caliente Control Network that can be used to interrelate the many surveys that will be conducted in the future through the development of a forthcoming ordinance requiring use of same. That has been accomplished. Artisan's secondary responsibility with respect to previous Fonger work was solely to evaluate the importance of a handful of monuments to detect if the Fonger Map can be of use in trying to retrace Fonger Monuments, the results of which would be utilized to the level determined on a case-by-case basis by each subsequent professional retracing and utilizing same.

Over the albeit limited time spent, Artisan Surveying Group was able to produce six (6) positively identified monuments that are included in this Corner Record. Other monuments were found but not measured because the scope of funds allocated for this purpose was consumed. However, the fact that the stated six (6) monuments were found and measured, and also that additional monuments were found, proves that the Fonger map is invaluable in searching for and finding original Fonger Monuments, or monuments shown upon the Fonger map.

Professional Land Surveyors who may come upon the presence of the Fonger map are cautioned to remember that the fundamental basis of land boundary law is to evaluate all forms of evidence in order to arrive at the Best Available Evidence. Finding Fonger monuments in the field and having no provenance or record to provide analysis against historic subdivisions and their spatial relationships, when the map is stamped, approved and privately available presents a hardship to the possibility of finding the best available evidence.

Despite their value; the existence of non-recorded privately-held records presents a condition where those analyzing information may or may not have access to all information including the private record. Access and lack of access presents two groups of professional that would have different sets of information and presents a condition where under the best of circumstances would likely produce an ambiguity between the two groups. The best possible solution is for each party to have all the information, as is a fundamental precept of law concerning discovery. This latter precept demands that the Fonger map become an item of public record, especially when a component of his evidence (e.g. concreted brass monuments) remain.



The presence of the Fonger map and monuments does not necessarily impinge upon the decision of the professional should a decision not to utilize same arise. However in addition to deprivation , not having the information creates a condition where that which is otherwise available goes unconsidered.

Caution should be considered in the actual status of the roads labeled on the Fonger map wherein all listed may not be dedicated to the public, may or may not be prescriptive and/or may have been subsequently altered in one manner or another since the date it was stamped by Richard Fonger, PLS, on July 6, 1990.

The reason that the word **Preliminary** is stamped upon this map is unknown other than the obvious facts that the map was not of record at the time the copy was given to Lenard Smith, PLS by Richard Fonger, PLS. It is also known from official City Council minutes that more work was underway for a second map to be labeled Map 2.

Based upon the preceding, and for good and valuable consideration as; a) Considerable Public funds were expended; b) Mr. Fonger caused the construction of approximately one hundred (100) concreted monuments of either brass or aluminum, c) The Bureau of Land Management accepted his monuments when they were established to perpetuate the Public Land Survey System, d) Mr. Fonger sealed and signed his map, e) Of the six (6) monuments found, they sufficiently fit dimensions and spatial relationships, with minor modification for translation, rotation and scale, a condition that is expected retracing 1980's era technology, f) Many more Fonger monuments remain in the field today, g) No one else has expended this amount of effort in attempts to restore and preserve the relationship of boundary for the City of Caliente, h) Land Surveyors of tomorrow deserve the right to know the past despite lack of recordation so that they may faithfully and dutifully arrive at professional boundary resolution decisions that consider all the information as to arrive at the best available evidence; therefore it is of the opinion of the undersigned and Mr. Lenard D. Smith, PLS, that the Fonger map should be included as a foundational component and exhibit to the 2015 City of Caliente Control Project.

The Artisan Surveying Group, Caliente City Control map does not repair the Fonger Coordinate System! However, with slight considerations and professional manipulation the Artisan Surveying Group, Caliente City Control map's coordinate system can and has been used to assist in searching for and recovering Fonger Monuments for independent professional consideration.

Timothy J. Wolf
Professional Land Surveyor
Nevada Certificate No. 9677
Agent, Artisan Surveying Group, a NV LLC

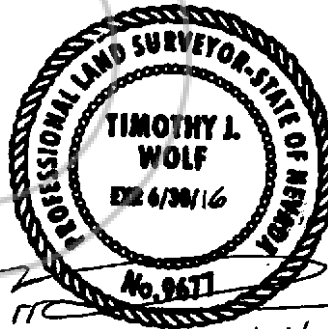

Lenard D. Smith
Professional Land Surveyor
Nevada Certificate No. 12751
Agent, Lenard Smith Land Survey

