

**OWNER'S CERTIFICATE**

We, Richard Moser and Allison Newlon certify that we are the owners of the lands represented and shown on this plat, and that we have requested Lenard D. Smith, a Professional Land Surveyor to prepare this plat for recordation.

*Richard Moser Allison Newlon*  
 Richard Moser Allison Newlon

**ACKNOWLEDGEMENT**

STATE OF NEVADA I SS  
 COUNTY OF Clark

The above persons, Richard Moser and Allison Newlon have personally appeared before me, a Notary Public, and have executed the above Owner's Certificate freely and voluntarily for the purposes stated.

*Heather Eriano*  
 Notary Public



**SURVEYOR'S CERTIFICATE**

I, Lenard D. Smith, a Professional Land Surveyor licensed in the State of Nevada, Certify that:

- This plat has been prepared from information on a recorded map.
- I assume no responsibility for the existence of the monuments or for the correctness of other information shown on or copied from the original map.
- The map from which the parcels of this map are being reverted is recorded in the Lincoln County records as Plat Book B, Page 11, Doc # 121194, recorded on November 3, 2003.

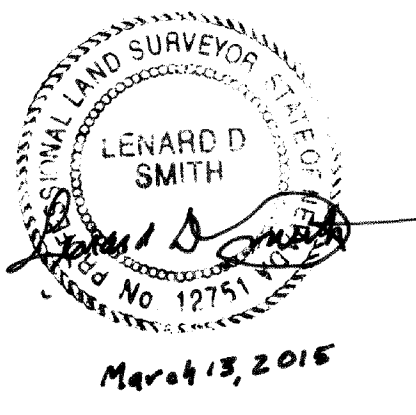

Lenard D. Smith PLS 12751 (Expiration, June 30, 2016)

**COUNTY PLANNING COMMISSION**

The Lincoln County Board of Commissioners, at their regular meeting held this 6<sup>th</sup> day of April, 2015 have examined this plat and do hereby approve it for recordation.

*Kevin Phelan* *Barbara*  
 Chairman Attest: Clerk

**PLANNING COUNTY COMMISSION**

The Lincoln County Planning Commission, at their regular meeting held this 12<sup>th</sup> day of March, 2015 have examined this Subsequent Parcel Map, and do hereby recommend it for approval.

*Director*  
 Chairman DIRECTOR

