

Official Record

Recording requested By
JAMES EBERT

Lincoln County - NV
Leslie Boucher - Recorder

Fee: \$15.00 Page 1 of 2
RPTT: Recorded By: LB
Book- 292 Page- 0365



After recording please return to:

Name: James D. Ebert II
Address: PO Box 1063
City, State, Zip: Caliente NV. 89008
Phone: 702.249.1960
Assessor's Parcel Number: 13-030-22

---Above This Line Reserved For Official Use Only---

QUIT CLAIM DEED

THIS INDENTURE WITNESSETH:

That James Ebert and Pam^P Ebert^P McCullough, in consideration of TEN DOLLARS (\$10.00), the receipt of which is hereby acknowledged, do(es) hereby remise, release, and forever quitclaim to James Ebert as Single man, all that real property situated in the town of Caliente, County of Lincoln, State of Nevada, more particularly described as follows: (Insert legal description and the commonly known address in the space provided.)

See exhibit "A"

Commonly known as _____

TOGETHER WITH all and singular the tenements, hereditaments and appurtenances thereunto belonging or in anywise appertaining.

WITNESS ___ hand(s) this 8th day of Jan, 2015.

P. McCullough
Signature of Grantor
Pam McCullough
STATE OF NEVADA)
COUNTY OF LINCOLN)

James Ebert
Signature of Grantor
JAMES EBERT

This instrument was acknowledged before me on this 8th day of January, 2015 by James Ebert and Pamela McCullough

M. Howard
NOTARY PUBLIC

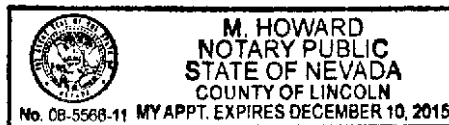



0146711

Book 292
Page 363

01/16/2015
Page 2 of 2

EXHIBIT "A"

LEGAL DESCRIPTION

ESCROW NO.: 19029675

That portion of the East Half (E1/2) of Section 2, Township 3 South, Range 67 East, M.D.B.&M. more particularly described as follows:

Parcel 4 of that certain Parcel Map recorded September 23, 1980 in the Office of the County Recorder of Lincoln County, Nevada in Book A of Plats, page 164 as File No. 69736, Lincoln County, Nevada records.

ASSESSOR'S PARCEL NUMBER FOR 2004 - 2005: 13-030-22

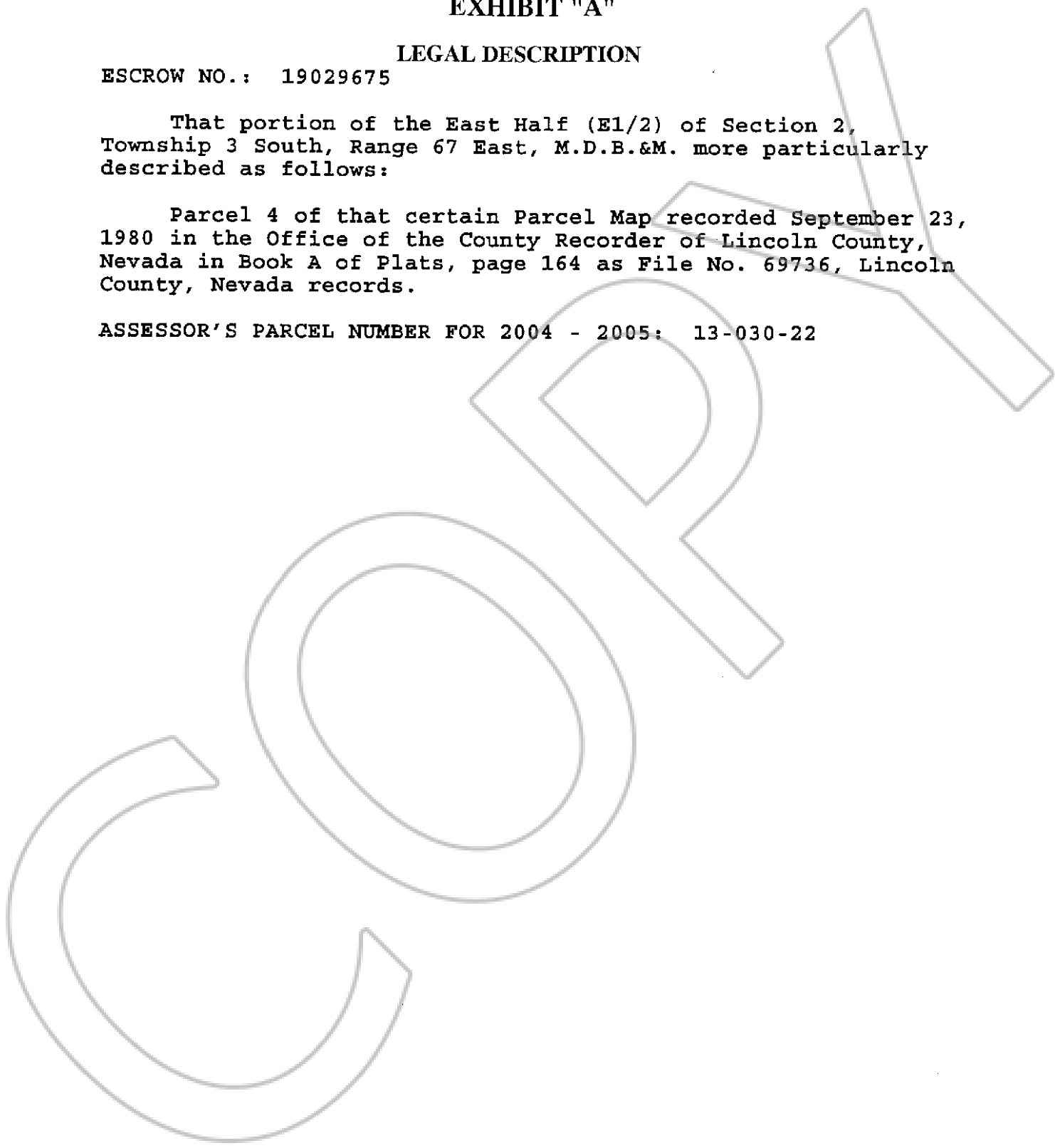

STATE OF NEVADA
DECLARATION OF VALUE FORM

Recording requested By
JAMES EBERT

Lincoln County - NV
Leslie Boucher - Recorder

Page 1 of 1 Fee: \$15.00
Recorded By: LB RPTT:
Book- 292 Page- 0365

1. Assessor Parcel Number(s)
a) 13-030-22
b) _____
c) _____
d) _____

2. Type of Property:
a) Vacant Land b) Single Fam. Res.
c) Condo/Twnhse d) 2-4 Plex
e) Apt. Bldg f) Comm'l/Ind'l
g) Agricultural h) Mobile Home
Other _____

FOR RECORDER'S OPTIONAL USE ONLY
Book: _____ Page: _____
Date of Recording: _____
Notes: _____

3. Total Value/Sales Price of Property \$ _____
Deed in Lieu of Foreclosure Only (value of property) (_____)
Transfer Tax Value: \$ _____
Real Property Transfer Tax Due \$ _____

4. If Exemption Claimed:

- a. Transfer Tax Exemption per NRS 375.090, Section 6
b. Explain Reason for Exemption: Receiving property per divorce decree

5. Partial Interest: Percentage being transferred: _____ %

The undersigned declares and acknowledges, under penalty of perjury, pursuant to NRS 375.060 and NRS 375.110, that the information provided is correct to the best of their information and belief, and can be supported by documentation if called upon to substantiate the information provided herein. Furthermore, the parties agree that disallowance of any claimed exemption, or other determination of additional tax due, may result in a penalty of 10% of the tax due plus interest at 1% per month. Pursuant to NRS 375.030, the Buyer and Seller shall be jointly and severally liable for any additional amount owed.

Signature _____ Capacity _____

Signature _____ Capacity _____

SELLER (GRANTOR) INFORMATION (REQUIRED)

BUYER (GRANTEE) INFORMATION (REQUIRED)

Print Name: JAMES Ebert Pamela McVilbush
Address: PO Box 1063
City: Caliente
State: NV Zip: 89008

Print Name: JAMES Ebert
Address: PO Box 1063
City: Caliente
State: NV Zip: 89008

COMPANY/PERSON REQUESTING RECORDING (required if not seller or buyer)

Print Name: _____ Escrow #: _____
Address: _____
City: _____ State: _____ Zip: _____