

Official Record

Recording requested By
CHICAGO TITLE AGENCY OF NEVADA

Lincoln County - NV

Leslie Boucher - Recorder

Fee: \$57.00

Page 1 of 19

RPTT:

Recorded By: LB

Book- 285 Page- 0652



Lincoln County, Nevada

APNs: 005-131-14; 005-131-27; 005-141-02;
005-141-10; 005-161-03; 005-171-07;
005-171-22; 005-171-26; 005-171-29;
005-171-36; 005-171-38; 005-171-41;
006-061-03; 006-201-06; 006-241-36;
006-241-69; 006-241-73; 006-251-03;
006-261-09; 006-261-10; 006-261-14;
006-261-15; 006-261-29; 006-261-34;
006-261-35; 006-271-21; 006-281-02;
006-281-03; 006-281-08; 006-281-13;
006-281-15; 006-301-07; 012-170-08;
012-170-21; 012-170-38

When Recorded Return To:

Bonnie Blackburn, Title Officer
Chicago Title Agency of Nevada
9075 W. Diablo Drive, Suite 100
Las Vegas, NV 89148.

Escrow No: 12017170-086-JR

SUBSTITUTION OF TRUSTEE

THIS DOCUMENT EXECUTED IN COUNTERPART

WHEREAS, NEVADA RANCHES, LLC, a Nevada limited liability company (formerly known as TUFFY RANCH PROPERTIES, LLC, a Nevada limited liability company), which such entity name was changed pursuant to an amendment to its articles of organization changing the entity's name, filed with the Nevada Secretary of State on December 16, 2013 as Document No. 20130825471-63) is the successor Trustor by assignment and assumption from Pyramid Development, LLC, a Wyoming limited liability company, which was the original Trustor, First American Title Insurance Company of Nevada, a Nevada corporation, was the original Trustee ("Original Trustee"), and Howard McCrosky, Max McCrosky, Robert E. McCrosky and William L. McCrosky ("McCrosky Bros.") were the original Beneficiary and are the owner and holder of the Note secured by that certain Deed of Trust recorded on September 17, 2004 as Document No. 123081 of Official Records in the Office of the County Recorder of Lincoln County, Nevada ("Deed of Trust").



AND WHEREAS, the undersigned McCrosky Bros. and respective assignees as evidenced by their signature on this instrument are the present Beneficiary(ies) under the Deed of Trust.

AND WHEREAS, the undersigned McCrosky Bros. desires to substitute a new Trustee under the Deed of Trust for ALL of the Property and Water Rights Secured by the Deed of Trust described in Exhibit "A" attached to this "SUBSTITUTION OF TRUSTEE" in the place and stead of the Original Trustee, in the manner provided in the Deed of Trust.

NOW THEREFORE, the undersigned BENEFICIARY, McCrosky Bros. hereby substitutes itself, McCrosky Bros., as Trustee under the Deed of Trust for the real property described on Exhibit "A" hereto, in place of First American Title Insurance Company of Nevada, and Successor Trustee hereby accepts said appointment.

WHENEVER the context hereof so requires, the masculine gender includes the feminine and/or neuter, and the singular number includes the plural.

Dated: ~~February~~ ^{March} 3, 2014

BENEFICIARY:
McCROSKY BROS.:

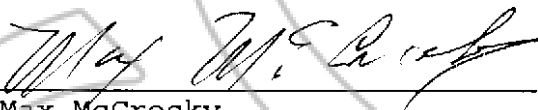

Max McCrosky

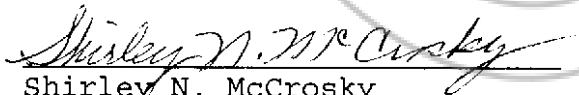

Shirley N. McCrosky

[rest of page intentionally left blank - signature page continues next page]



Robert E. McCrosky
Robert E. McCrosky

Wanda B. McCrosky
Wanda McCrosky

William L. McCrosky
William L. McCrosky

William L. McCrosky
William L. McCrosky as Trustee of the William L. McCrosky and
Mary Jeanett McCrosky Family Living Trust dated March 13, 2005

Jeanett McCrosky
Jeanett McCrosky

Mary Jeanett McCrosky
Mary Jeanett McCrosky* as Trustee of the William L. McCrosky
and Mary Jeanett McCrosky Family Living Trust dated March 13,
2005
*aka Jeanett McCrosky

Linda R. McCrosky Executrix

Linda R. McCrosky as the Executrix of the Estate of Howard McCrosky

Linda R. McCrosky Trustee

Linda R. McCrosky as Trustee of the Howard McCrosky Family Trust

[rest of page intentionally left blank - NOTARY pages follow]

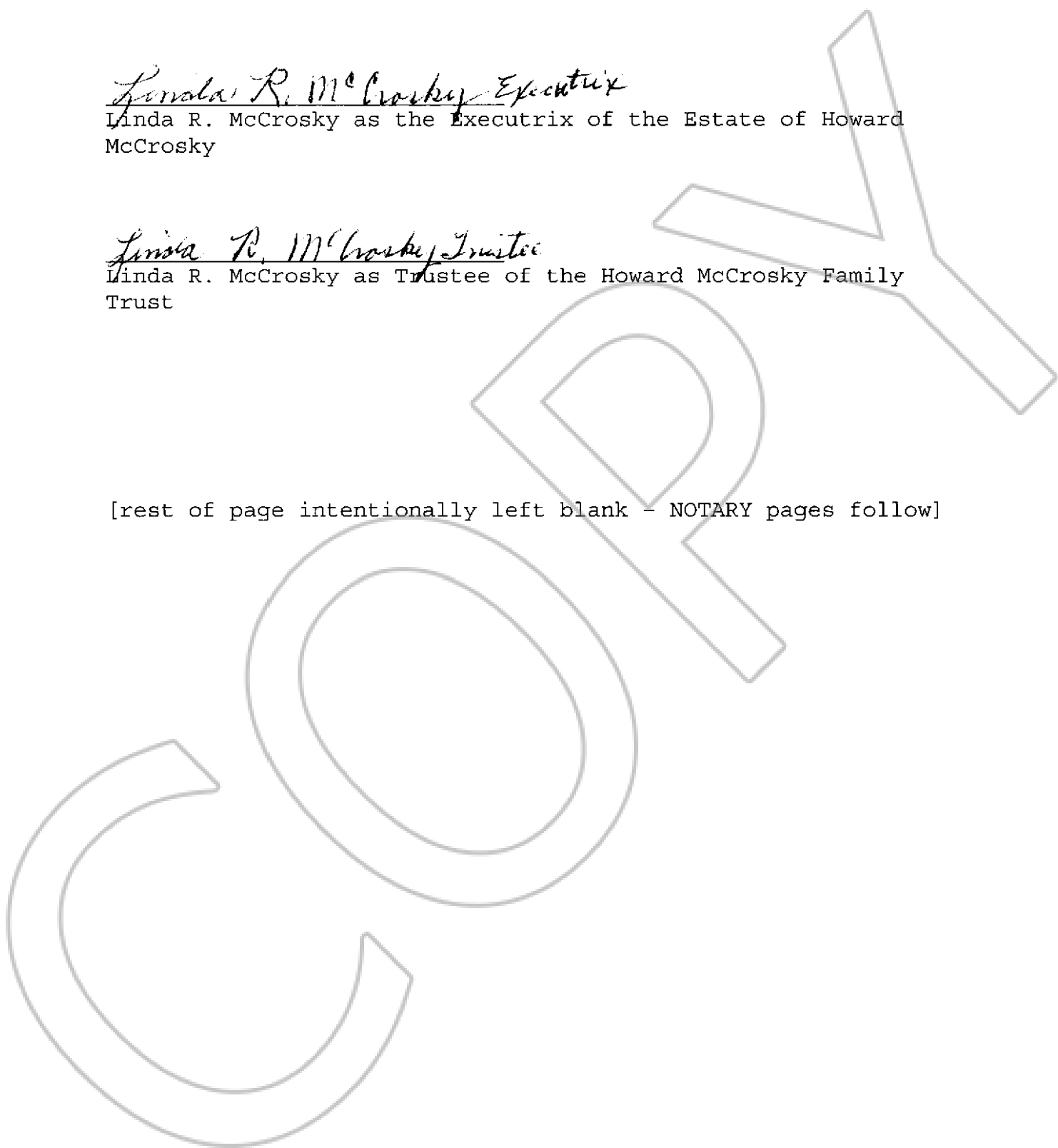

SEE ATTACHED CA. NOTARY. NEG. 3.25.14



NOTARY PAGE FOR MAX & SHIRLEY MCCROSKY

State of Nevada)
County of Lincoln)ss.

This instrument was acknowledged before me by Max McCrosky on ~~February~~ March 3, 2014.

Notary Public Alice C. Simkins



State of Nevada)
County of Lincoln)ss.

exp 1/26/15

This instrument was acknowledged before me by Shirley N. McCrosky on ~~February~~ March 3, 2014.

Notary Public Alice C. Simkins





NOTARY PAGE FOR ROBERT AND WANDA MCCROSKY

State of Nevada)
County of Lincoln)ss.

This instrument was acknowledged before me by Robert E. McCrosky on ~~February~~ March 3, 2014.

Notary Public Alice C. Simkins



State of Nevada)
County of Lincoln)ss.

This instrument was acknowledged before me by Wanda McCrosky on ~~February~~ March 3, 2014.

Notary Public Alice C. Simkins

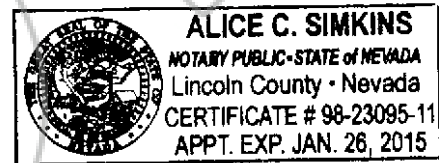



NOTARY PAGE FOR WILLIAM AND JEANETT MCCROSKY

State of Nevada)
County of Lincoln)ss.

This instrument was acknowledged before me by William L. McCrosky in his individual capacity and as Trustee of the William L. McCrosky and Mary Jeanett McCrosky Family Living Trust dated March 13, 2005, on ~~February~~ March 3, 2014.

Notary Public Alice C. Simkins

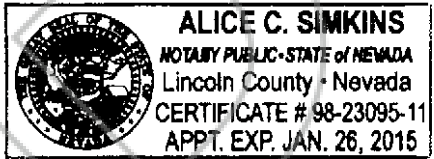

State of Nevada)
County of Lincoln)ss.

This instrument was acknowledged before me by Jeanett McCrosky in her individual capacity and as Trustee of the William L. McCrosky and Mary Jeanett McCrosky Family Living Trust dated March 13, 2005, on ~~February~~ March 3, 2014.

Notary Public Alice C. Simkins

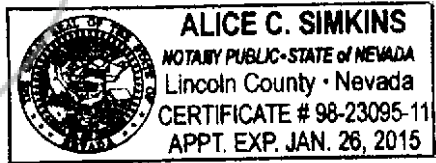



CALIFORNIA ALL-PURPOSE ACKNOWLEDGMENT

STATE OF CALIFORNIA

County of SAN BERNARDINO

On FEB. 25, 2014 before me, MARY ELLEN ZEPEDA (NOTARY PUBLIC)
Date Here Insert Name and Title of the Officer

personally appeared LINDA R. MCCROSKY
Name(s) of Signer(s)

who proved to me on the basis of satisfactory evidence to be the person(s) whose name(s) is/are subscribed to the within instrument and acknowledged to me that he/she/they executed the same in his/her/their authorized capacity(ies), and that by his/her/their signature(s) on the instrument the person(s), or the entity upon behalf of which the person(s) acted, executed the instrument.

I certify under PENALTY OF PERJURY under the laws of the State of California that the foregoing paragraph is true and correct.

Witness my hand and official seal
Signature [Handwritten Signature]
Signature of Notary Public



EXP 10/27/15
NO 1954390

Place Notary Seal Above

OPTIONAL

Though the information below is not required by law, it may prove valuable to persons relying on the document and could prevent fraudulent removal and reattachment of this form to another document.

Description of Attached Document

Title or Type of Document: SUBSTITUTION OF TRUSTEE

Document Date: 2 25 14 Number of Pages: 1

Signer(s) Other Than Named Above: _____

Capacity(ies) Claimed by Signer(s)

- Signer's Name: _____
- Individual
 - Corporate Officer — Title(s): _____
 - Partner — Limited General
 - Attorney in Fact
 - Trustee
 - Guardian or Conservator
 - Other: _____

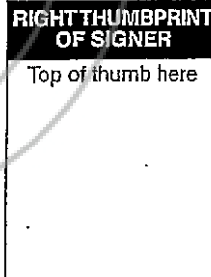

Signer Is Representing: _____

- Signer's Name: _____
- Individual
 - Corporate Officer — Title(s): _____
 - Partner — Limited General
 - Attorney in Fact
 - Trustee
 - Guardian or Conservator
 - Other: _____

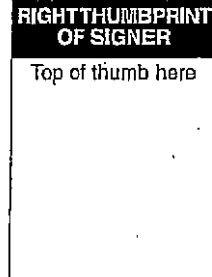

Signer Is Representing: _____



EXHIBIT "A" TO SUBSTITUTION OF TRUSTEE

LEGAL DESCRIPTION OF LAND PARCELS

THAT LAND WITHIN AN UNINCORPORATED AREA WITHIN THE COUNTY OF LINCOLN, STATE OF NEVADA, DESCRIBED AS FOLLOWS:

PARCEL 1:

The Northwest Quarter (NW¼) of the Northeast Quarter (NE¼) of Section 7, Township 5 North, Range 68 East, M.D.B.&M.

PARCEL 2:

The Southeast Quarter (SE¼) of the Northwest Quarter (NW¼) of Section 28, Township 5 North, Range 68 East, M.D.B.&M.

PARCEL 3:

The Southwest Quarter (SW¼) of the Northwest Quarter (NW¼) and the North Half (N½) of the Southwest Quarter (SW¼) of Section 33, Township 5 North, Range 68 East, M.D.B. &M.

PARCEL 4:

The Southeast Quarter (SE¼) of the Southeast Quarter (SE¼) of Section 26, Township 5 North, Range 68 East, M.D.B.&M.

PARCEL 5:

The South Half (S½) of the Southwest Quarter (SW¼) of the Northeast Quarter (NE¼) of Section 12, Township 6 North, Range 68 East, M.D.B.&M.

PARCEL 6:

Lot 2 of Section 7, Township 6 North, Range 69 East, M.D.B.&M.

PARCEL 7:

The Southeast Quarter (SE¼) of the Southwest Quarter (SW¼) of Section 1, Township 5 Range, Range 69 East, M.D.B.&M.

PARCEL 8:

The Northeast Quarter (NE $\frac{1}{4}$) of the Northeast Quarter (NE $\frac{1}{4}$) of Section 19, Township 6 North, Range 69 East, M.D.B.&M.

PARCEL 9:

The Southeast Quarter (SE $\frac{1}{4}$) of the Southwest Quarter (SW $\frac{1}{4}$) of Section 36, Township 6 North, Range 68 East, M.D.B.&M.

PARCEL 10:

That portion of the Southwest Quarter (SW $\frac{1}{4}$) of the Northwest Quarter (NW $\frac{1}{4}$) of Section 8, Township 2 South, Range 68 East, M.D.B.&M. bounded as follows.

On the North by the North Line of said Southwest Quarter (SW $\frac{1}{4}$) of the Northwest Quarter (NW $\frac{1}{4}$):

On the East by the Westerly line of the land conveyed to Caliente & Pioche Railroad Company by deed recorded October 9, 1906 in Book W of Deed Records, page 343;

On the West by the Easterly line of the land conveyed to the State of Nevada Department of Highways by deed recorded March 10, 1924 in Book C-1 of Deed Records, page 91; and on the South by the Northerly line of the land conveyed to the State of Nevada by deed July 15, 1948 in Book H-1 of Deed Records, page 252.

Further provided, that Grantee is taking title to this Parcel subject to the following use restriction imposed by and for the benefit of Grantors:

No commercial auto repairs, sales or services shall occur on this Parcel for a period of twenty (20) years after the date on which this Deed is recorded in the Official Records, Lincoln County, Nevada ("Recording Date"); provided, that this use restriction shall expire by its own terms on the twentieth (20th) anniversary of the Recording Date and shall be of no further force effect and without the need of any other document being required from Grantors for the release of this restriction.

**PARCEL 11:**

That portion of the Southwest Quarter (SW $\frac{1}{4}$) of the Northwest Quarter (NW $\frac{1}{4}$) of Section 8, Township 2 South, Range 68 East, M.D.B.&M. bounded as follows:

On the East by the Easterly line of said Southwest Quarter (SW $\frac{1}{4}$) of the Northwest Quarter (NW $\frac{1}{4}$);

On the North by the Southerly line of the land conveyed to the State of Nevada by deed recorded July 15, 1948 in Book H-1 of Deed Records, page 252;

On the West by the Easterly line of the land conveyed to Caliente & Pioche Railroad Company by deed recorded October 9, 1905 in Book W of Deed Records, page 343; and

on the South by the South line of said Southwest Quarter (SW $\frac{1}{4}$) of the Northwest Quarter (NW $\frac{1}{4}$).

EXCEPTING THEREFROM that portion described as follows:

Commencing at at a point on the Quarter Section line, from which the West Quarter (W $\frac{1}{4}$) corner of Section 8, Township 2 South, Range 68 East, bears West 889.5 feet;

Thence North 25 feet;

Thence East 25 feet;

Thence South 25 feet;

Thence West along the Quarter Section line 25 feet to the place of beginning.

PARCEL 12:

That portion of the Northwest Quarter (NW $\frac{1}{4}$) of the Southeast Quarter (SE $\frac{1}{4}$) of the Northwest Quarter (NW $\frac{1}{4}$) of Section 8, Township 2 South, Range 68 East, M.D.B.&M. described as follows:

Commencing at the center of the Northwest Quarter (NW $\frac{1}{4}$) of said Section 8, and running thence South approximately 660 feet to the North line of State Highway Route 25; Thence Easterly along said North side of said highway 590 feet;

Thence North about 660 feet to the North line of the Southeast Quarter (SE $\frac{1}{4}$) of the Northwest Quarter (NW $\frac{1}{4}$) of said Section 8;

Thence Westerly 590 feet to the point of beginning.



PARCEL 13:

The Southwest Quarter (SW $\frac{1}{4}$) of the Southwest Quarter (SW $\frac{1}{4}$) of Section 35, Township 2 North, Range 67 East, M.D.B.&M.

PARCEL 14:

The Southwest Quarter (SW $\frac{1}{4}$) of the Northeast Quarter (NE $\frac{1}{4}$) of Section 16, Township 1 North, Range 67 East, M.D.B.&M.

PARCEL 15:

All of the East Half (E $\frac{1}{2}$) of the Northwest Quarter (NW $\frac{1}{4}$) and all of the east Half (E $\frac{1}{2}$) of the Southwest Quarter (SW $\frac{1}{4}$) of Section 21; also all the West Half (W $\frac{1}{2}$) of the East Half (E $\frac{1}{2}$) [erroneously recorded West $\frac{1}{2}$ of the West Half (W $\frac{1}{2}$ W $\frac{1}{2}$)] of Section 21 West of the division fence between the Lytle Ranch and the Devlin Ranch in Rose Valley, also the North 800 feet of the Northeast Quarter (NE $\frac{1}{4}$) of the Northwest Quarter (NW $\frac{1}{4}$) of Section 28, and that part of the Northwest Quarter (NW $\frac{1}{4}$) of the Northeast Quarter (NE $\frac{1}{4}$) of said Section 28 which lies West and North of said division fence, all in Township 1 North, Range 69 East, M.D.B.&M., more fully described as:

Beginning at a point 520 feet North of the Southwest corner of the Northeast Quarter (NE $\frac{1}{4}$) of the Northwest Quarter (NW $\frac{1}{4}$) of Section 28, and running thence East along division fence a distance of 1510 feet to corner of said fence;

Thence North about 10° East along said fence to a point on the North boundary of Section 21, said point being 146.5 feet West of the Northeast corner of the Northwest Quarter (NW $\frac{1}{4}$) of the Northeast Quarter (NE $\frac{1}{4}$) of said Section 21;

Thence along the North boundary line of said Section 21 to the Northwest corner of the Northeast Quarter (NE $\frac{1}{4}$) of the Northwest Quarter (NW $\frac{1}{4}$) of said Section 21;

Thence South 6080 feet to the place of beginning.

EXCEPTION THEREFROM any portion lying within the exterior boundary lines of parcel Map for McCrosky Brothers recorded January 20, 2000 in Plat Book B, page 278 as File No. 113871 in the Office of the County Recorder, Lincoln County, Nevada.



PARCEL 16:

The South Half (S½) of the Southwest Quarter (SW¼) of Section 16, Township 1 North, Range 69 East, M.D.B.&M.

PARCEL 17:

The Southwest Quarter (SW¼) of the Southeast Quarter (SE¼) of Section 16, Township 1 North, Range 69 East, M.D.B.&M.

EXCEPTING THEREFROM that portion described as follows:

Commencing at a point on the section line of Section 16 and Section 21, Township 1 North, Range 69 East, M.D.B.&M., from which the 1/4 corner of said section line bears due west for a distance of 1,165.46 feet, said point is also the point of intersection of the division line fence and said section line, running thence North 5°16' East for a distance of 141.95 feet to a fence corner just south of the road; Thence North 63°49' West a distance of 149.58 feet to the center of the North-South road immediately west of a corral constructed by Jimmie Rosa; Thence due north for a distance of 452.65 feet; Thence due west for a distance of 467.78 feet; Thence north for a distance of 100.00 feet; Thence due west for a distance of 576.48 feet; Thence due north for a distance of 560.00 feet along the west line and to the north-west corner of said 40 acre tract; Thence due east for a distance of 1,320.00 feet along the north line to the Northeast corner of said 40 acre tract; Thence due south for a distance of 1,320.00 feet along the east line to the Southeast corner of said 40 acre tract; Thence due west for a distance of 154.54 feet to the point of beginning.

ALSO EXCEPTING THEREFROM that portion described as follows:

Commencing at a point from which the ¼ corner of said Section 16 and Section 21 bears due south for a distance of 374.31 feet; Thence due North along the west boundary of the Southwest Quarter (SW¼) of the Southeast Quarter (SE¼) of said Section 16, for a distance of 385.69 feet; thence due east for a distance of 576.48 feet;



Thence due south for a distance of 472.45 feet;
Thence North 81°14' West for a distance of 583.30 feet to the
point of beginning.

ALSO EXCEPTING THEREFROM any portion lying within the exterior
boundary lines of parcel Map for McCrosky Brothers recorded
January 20, 2000 in Plat Book B, page 278 as File No. 113871
in the Office of the County Recorder, Lincoln County, Nevada.

PARCEL 18:

The West Half (W½) of the Northwest Quarter (NW¼) of Section
21, Township 1 North, Range 69 East, M.D.B.&M.

PARCEL 19:

A triangular piece of land in the Northeast Quarter (NE¼) of
the Northeast Quarter (NE¼) of Section 21, Township 1 North,
Range 69 East, M.D.B.&M., described as follows:

Beginning at the Northeast corner of said Northeast Quarter
(NE¼) of the Northeast Quarter (NE¼) of Section 21, thence
West along the North boundary line of said Northeast Quarter
(NE¼) of the Northeast Quarter (NE¼), 1075 feet;
Thence South 4°30' East 650 feet;
Thence North 57°41' East 1212 feet to place of beginning known
as "Coumerilh Gardens".

PARCEL 20:

An undivided 2/16th interest in and to the West Half (W½) of
the Southeast (SE¼) and the Southwest Quarter (SW¼) of Section
15; Also the East Half (E½) of the Southeast Quarter (SE¼) of
Section 16, all in Township 5 North, Range 67 East, M.D.B.&M.,
commonly known as "Brown Springs Property".

PARCEL 21:

Parcels 1A, 1B and 3 of Parcel Map for McCrosky Brothers
recorded January 22, 2002 in Plat Book B, pages 417 as File
No. 117585 in the Office of the County Recorder, Lincoln
County, Nevada, lying within the NE¼NW¼ of Section 2, Township
1 North, Range 69 East, M.D.B.&M.

**PARCEL 22:**

That portion of the South Half (S½) of the Northwest Quarter (NW¼) of Section 2, Township 1 North, Range 69 East, M.D.B.&M. described as follows:

Beginning at the Northwest corner of the Southwest Quarter (SW¼) of the Northwest Quarter (NW¼) of Section 2, Township 1 North, Range 69 East, M.D.B.&M.; thence East 1110 feet more or less;

Thence South 73° East 1472 feet more or less;

Thence South 23°30' West 87 feet;

Thence South 68° East 160 feet, more or less, to the East line of the Southeast Quarter (SE¼) of the Northwest Quarter (NW¼) of said Section 2;

Thence South 280 feet, more or less;

Thence South 71° West 210 feet;

Thence North 71°45' West 1582 feet;

Thence West across highway right of way to West boundary thereof;

Thence Southerly along the West boundary of highway right of way to the South boundary of the Southwest Quarter (SW¼) of the Northwest Quarter (NW¼) of Section 2;

Thence West 880 feet, more or less, to the section line common to Sections 2 and 3;

Thence North along said section line 1320 feet to the point of beginning.

PARCEL 23:

That portion of the Southwest Quarter (SW¼) of Section 2, Township 1 North, Range 69 East, M.D.B.&M., described as follows:

Beginning at a point 1468 feet North of the Southwest corner of Section 2, Township 1 North, Range 69 East, M.D.B.&M, said point being on the dividing line between said Section 2 and Section 3, thence running East 435 feet;

Thence running South 71°33' East 1058 feet;

Thence running North 19°47' East 179 feet;

Thence running South 70°13' East 525 feet;

Thence running East 647 feet to the quarter section line between the Southwest Quarter (SW¼) and the Southeast Quarter (SE¼) of said Section 2;



Thence running East 425 feet;
 Thence running North 71°40' West, 1446.6 feet;
 Thence running West 842 feet, to the dividing line between
 said Section 2 and Section 3;
 Thence running South along said dividing line 655.7 feet to
 the point of beginning.

PARCEL 24:

That portion of the Northwest Quarter (NW¼) of the Southwest
 Quarter (SW¼) of Section 2, Township 1 North, Range 69 East,
 bounded as follows:

On the North and West by the North and West lines of said
 Section 2;
 on the East by the Westerly line of Nevada State Route 85
 right-of-way, and on the South by that portion described as
 follows:

Beginning at a point 1468 feet North of the Southwest corner
 of Section 2, Township 1 North, Range 69 East, M.D.B.&M, said
 point being on the dividing line between said Section 2 and
 Section 3, thence running East 435 feet;
 Thence running South 71°33' East 1058 feet;
 Thence running North 19°47' East 179 feet;
 Thence running South 70°13' East 525 feet;
 Thence running East 647 feet to the quarter section line
 between the Southwest Quarter (SW¼) and the Southeast Quarter
 (SE¼) of said Section 2;
 Thence running 425 feet;
 Thence running North 71°40' West, 1446.6 feet;
 Thence running West 842 feet, to the dividing line between
 said Section 2 and Section 3;
 Thence running South along said dividing line 655.7 feet to
 the point of beginning.

PARCEL 25:

An undivided one-sixth interest in and to the Northeast
 Quarter (NE¼) of the Southeast Quarter (SE¼) of Section 5,
 Township 3 North, Range 69 East, M.D.B.&M.



PARCEL 26:

An undivided one-sixth interest in and to the Northwest Quarter (NW¼) of the Southwest Quarter (SW¼) of Section 17, Township 3 North, Range 69 East, M.D.B.&M.

PARCEL 27:

The Northeast Quarter (NE¼) of the Southeast Quarter (SE¼) of Section 1, Township 3 North, Range 69 East, M.D.B.&M., and also Lots 6 and 7 in Section 6 and the Southwest Quarter (SW¼) of the Northeast Quarter (NE¼), the Southeast Quarter (SE¼) of the Northwest Quarter (NW¼), the Northeast Quarter (NE¼) of the Northwest Quarter (NW¼) and Lots 1 and 2 in Section 7, Township 3 North Range 70 East, M.D.B.&M.

PARCEL 28:

The East Half (E½) of the Southeast Quarter (SE¼) of the Southeast Quarter (SE¼) of Section 1 and the East Half (E½) of the Northeast Quarter (NE¼) of the Northeast Quarter (NE¼) of the Northeast Quarter (NE¼) and the Northeast Quarter (NE¼) of the Southeast Quarter (SE¼) of the Northeast Quarter (NE¼) of the Northeast Quarter (NE¼) of Section 12, all in Township 3 North, Range 69 East, M.D.B.&M.; together with the West Half (W½) of the Southeast Quarter (SE¼) of the Southwest Quarter (SW¼), the West Half (W½) of the Southeast Quarter (SE¼) of the Southeast Quarter (SE¼) of the Southwest Quarter (SW¼) and the Southeast Quarter (SE¼) of the Southeast Quarter (SE¼) of the Southwest Quarter (SW¼) of Section 6 and the West Half (W½) of the Northwest Quarter (NW¼) of the Northeast Quarter (NE¼), the West Half (W½) of the Southeast Quarter (SE¼) of the Northwest Quarter (NW¼) of the Northeast Quarter (NE¼), the Southeast Quarter (SE¼) of the Southeast Quarter (SE¼) of the Northwest Quarter (NW¼) of the Northeast Quarter (NE¼), the Southwest Quarter (SW¼) of the Northwest Quarter (NW¼) of the Southeast Quarter (SE¼) of the Northeast Quarter (NE¼), the North Half (N½) of the Northeast Quarter (NE¼) of the Southwest Quarter (SW¼), the West Half (W½) of the Southwest Quarter (SW¼) of the Northeast Quarter (NE¼) of the Southwest Quarter (SW¼), the Northeast Quarter (NE¼) of the Southwest Quarter (SW¼) of the Northeast (NE¼) of the Southwest Quarter (SW¼) and the Northwest Quarter (NW¼) of the Southeast Quarter (SE¼) of the Northeast Quarter (NE¼) of the Southwest Quarter (SW¼) of Section 7, all in Township 3 North, Range 70 East, M.D.B.&M.



PARCEL 29:

Parcels 1 and 2 of Parcel Map for McCrosky Brothers recorded December 17, 1993 in Plat Book A, page 401 as File No. 101245, lying within the Southeast Quarter (SE $\frac{1}{4}$) of Section 10, Township 1 North, Range 69 East, M.D.B.&M.

PARCEL 30:

The North 28.74 acres of the Northeast Quarter (NE $\frac{1}{4}$) of the Southwest Quarter (SW $\frac{1}{4}$) of Section 28, Township 5 North, Range 68 East, M.D.B.&M.

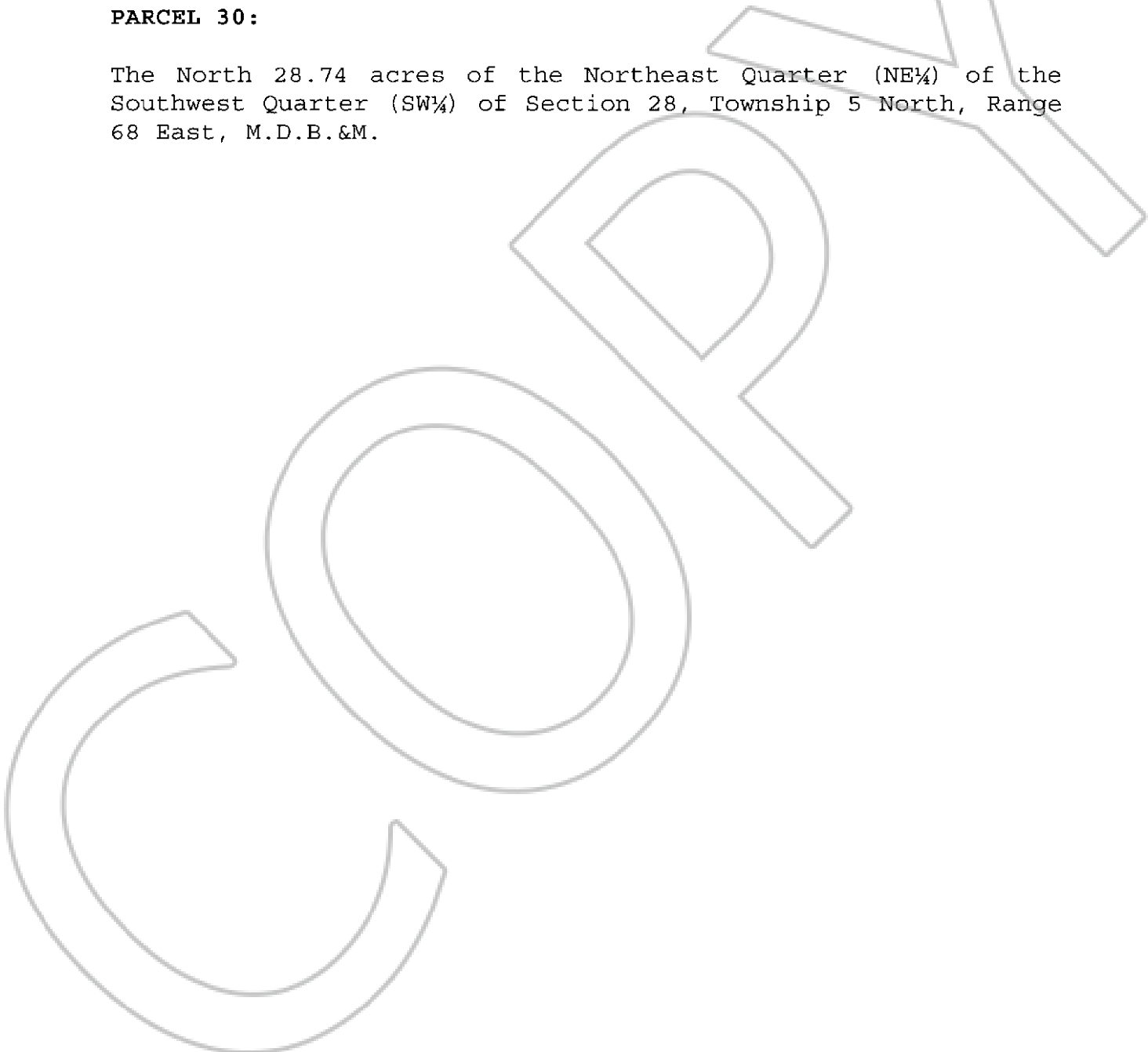



Description of Water Rights

Claim, Proof, Vesting or Permit No.:

V01248

V01249

22486

11060 (Cert. No. 3150) - 0.89 cfs, not to exceed 293 afa

11759 (Cert. No. 3918) - a two-thirds interest at a rate of 2.333 cfs, not to exceed 720 afs

20833 (Cert. No. 7144) - 2.63 cfs, not to exceed 526.5 afa

20861 (Cert. No. 7145) - 2.2 cfs, not to exceed 591 afa

26500 (Cert. No. 13372) - 3.96 cfs, not to exceed 779.16 afa

That portion of Proof No. 02933 in the Matter of the Determination of the Relative Rights in and to the Waters of Camp Valley Creek, Eagle Valley Creek, Panaca Big Spring, Clover Valley Wash, Meadow Valley Wash and their Tributaries in Lincoln and Clark Counties, Nevada dated June 9, 1999, equivalent to 28 units (shares) in the Eagle Valley Irrigation Company, Inc.

V02027 - Sawmill Spring

V02007 - Adams Corral Spring

V02001 - Camp Valley Creek

V01971 - Rosencrante Middle Fork Spring

V01973 - Rosencrante South Fork Spring

V01974 - South Rosencrante Spring

V01975 - Rosencrante

V01990 - Woods - McCullough North Fork Spring

V01991 - Woods - McCullough Middle Fork Spring

V01992 - Woods - McCullough South Fork Spring

V02006 - Meadow Springs

V02002 - Pine Spring

V02004 - Meadow Spring

V02021 - Gleason Basin Spring #4

V02022 - Gleason Basin Spring #1

V02023 - Gleason Basin Spring #2

V01248 (Cert. No. 159) - Parsnip Spring

V01249 - Buster Spring

V02020 - Milk Ranch Spring

V02024 - Lone Trough Spring

V02025 - Monumental Spring

V01972 - Rosencrante

V02006 - Adams Corral

22486 (cancelled)