

Official Record

Recording requested By
FIRST AMERICAN TITLE COMPANY

Lincoln County - NV

Leslie Boucher - Recorder

Fee: \$16.00

Page 1 of 3

RPTT: \$430.95

Recorded By: AE

Book- 285 Page- 0035



0144861

APN NO. 004-141-39

**RECORDING REQUESTED BY:
EQUITY TITLE OF NEVADA
AND WHEN RECORDED MAIL TO:**

**Lexi Holdings, LLC,
5715 W. Alexander #160
Las Vegas, NV 89130**

**AND WHEN RECORDED MAIL
TAX STATEMENTS TO:**

SAME AS ABOVE

Affix RPTT: \$ 78.00

ESCROW NO.: 13480608 SL1

2448972

GRANT, BARGAIN, SALE DEED

THIS INDENTURE WITNESSETH THAT:

Lynda C. Stead, Trustee of the

Lynda C. Stead Family Trust, dated December 30, 2010

in consideration of the sum of Ten Dollars (\$10.00), the receipt of which is hereby acknowledged, do hereby Grant, Bargain Sell and convey to

Lexi Holdings, LLC, a Nevada Limited Liability Company

all that real property situated in the County of Lincoln, State of Nevada, described as follows:

see attached legal description

TOGETHER WITH all and singular the tenements, hereditaments and appurtenances thereunto belonging to in anywise appertaining.



SUBJECT TO:

- 1. General and special taxes for the current fiscal year.
- 2. Covenants, conditions, restrictions, rights of way, easements and reservations of record.

SELLER:

Lynda C. Stead Family Trust, dated December 30, 2010

Lynda C. Stead, Trustee
By: Lynda C. Stead, Trustee

STATE OF WASHINGTON }
COUNTY OF WITACOM } SS:

On JANUARY 22, 2014

Personally appeared before me, a Notary Public

LYNDA C. STEAD

who acknowledged that ~~he~~/she/~~they~~ executed the above instrument.

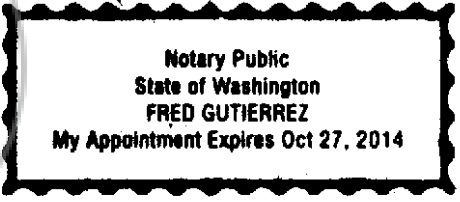

~~Notary Public~~

My commission expires: OCT. 27, 2014



0144861

Book: 295
Page: 37

01/31/2014
Time: 3:54:3

EXHIBIT "A"

The land referred to in this Commitment is situated in the County of Lincoln, State of Nevada and is described as follows:

THAT PORTION OF THE SOUTH HALF(S1/2) OF THE SOUTHWEST QUARTER(SW1/4) OF THE SOUTHWEST QUARTER(SW1/4) OF THE NORTHWEST QUARTER(NW1/4) OF SECTION 5, TOWNSHIP 7 SOUTH, RANGE 61 EAST, M.D.B. AND M., LINCOLN COUNTY, NEVADA DESCRIBED AS FOLLOWS:

PARCEL 5-2, AS SHOWN UPON MAP THEREOF, FOR MARY S. AND GERALD H. WILSON RECORDED SEPTEMBER 21, 1988 IN THE RECORDERS OFFICE IN PLAT BOOK "A", PAGE 292 AS FILE 89878, LINCOLN COUNTY, NEVADA.

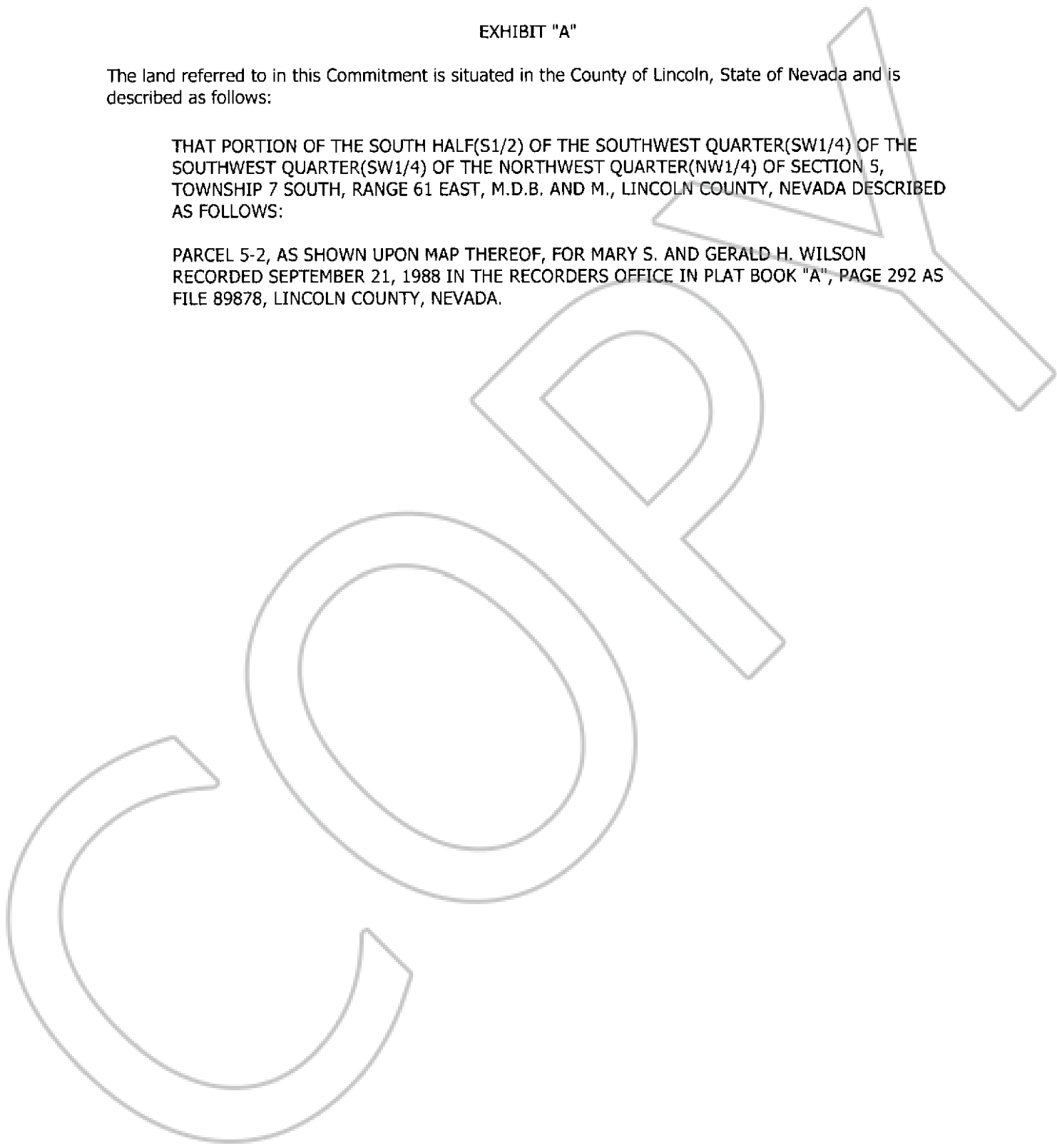

STATE OF NEVADA
DECLARATION OF VALUE FORM

Recording requested by
FIRST AMERICAN TITLE COMPANY

Lincoln County - NV

Leslie Boucher - Recorder

Page 1 of 1 Fee: \$16.00

Recorded By: AE RPTT: \$430.95

Book- 285 Page- 0035

FOR RECORDERS OFFICIAL USE ONLY

Book: _____ Page: _____

Date of Recording: _____

Notes: _____

1. Assessor Parcel Number(s)

a) 004-141-39

b)

c)

d)

2. Type of Property:

- a) Vacant Land
- b) Single Fam. Res
- c) Condo/Twnhse
- d) 2-4 Plex
- e) Apt. Bldg
- f) Comm'l/Ind'l
- g) Agricultural
- h) Mobile Home
- Other _____

3. a) Total Value/Sales Price of Property

\$20,000.00

b) Deed in Lieu of Foreclosure Only (value of property)

()

c) Transfer Tax Value:

~~\$20,000.00~~ 110,049

d) Real Property Transfer Tax Due

~~\$578.00~~ 430.95

4. If Exemption Claimed:

a. Transfer Tax Exemption per NRS 375.090, Section _____

b. Explain Reason for Exemption: _____

5. Partial Interest: Percentage being transferred: 100%

The undersigned declares and acknowledges, under penalty of perjury, pursuant to NRS 375.060 and NRS 375.110, that the information provided is correct to the best of their information and belief, and can be supported by documentation if called upon to substantiate the information provided herein. Furthermore, the parties agree that disallowance of any claimed exemption, or other determination of additional tax due, may result in a penalty of 10% of the tax due plus interest at 1% per month. Pursuant to NRS 375.030, the Buyer and Seller shall be jointly and severally liable for any additional amount owed.

Signature: Lynnda C. Stead Capacity: Trustee

Signature: _____ Capacity: _____

SELLER (GRANTOR) INFORMATION
(REQUIRED)

BUYER (GRANTEE) INFORMATION
(REQUIRED)

Print Name: Lynnda C Stead Family Trust

Print Name: Lexi Holdings LLC

Address: 8299 Fawn Crest
City: Staine
State: WA Zip: 98230

Address: 5715 W. Alexander Rd #160
City: Las Vegas
State: NV Zip: 89130

COMPANY/PERSON REQUESTING RECORDING (required if not seller or buyer)

Print Name: Equity Title of Nevada
Address: 840 Pinnacle Ct Bldg 1 STE A
City, State & Zip: Mesquite, NV 89027

Escrow #: 13480608 SL1

AS A PUBLIC RECORD THIS FORM MAY BE RECORDED/MICROFILMED

clo fatw
2500 Paseo Verde #120 Henderson NV 89074