

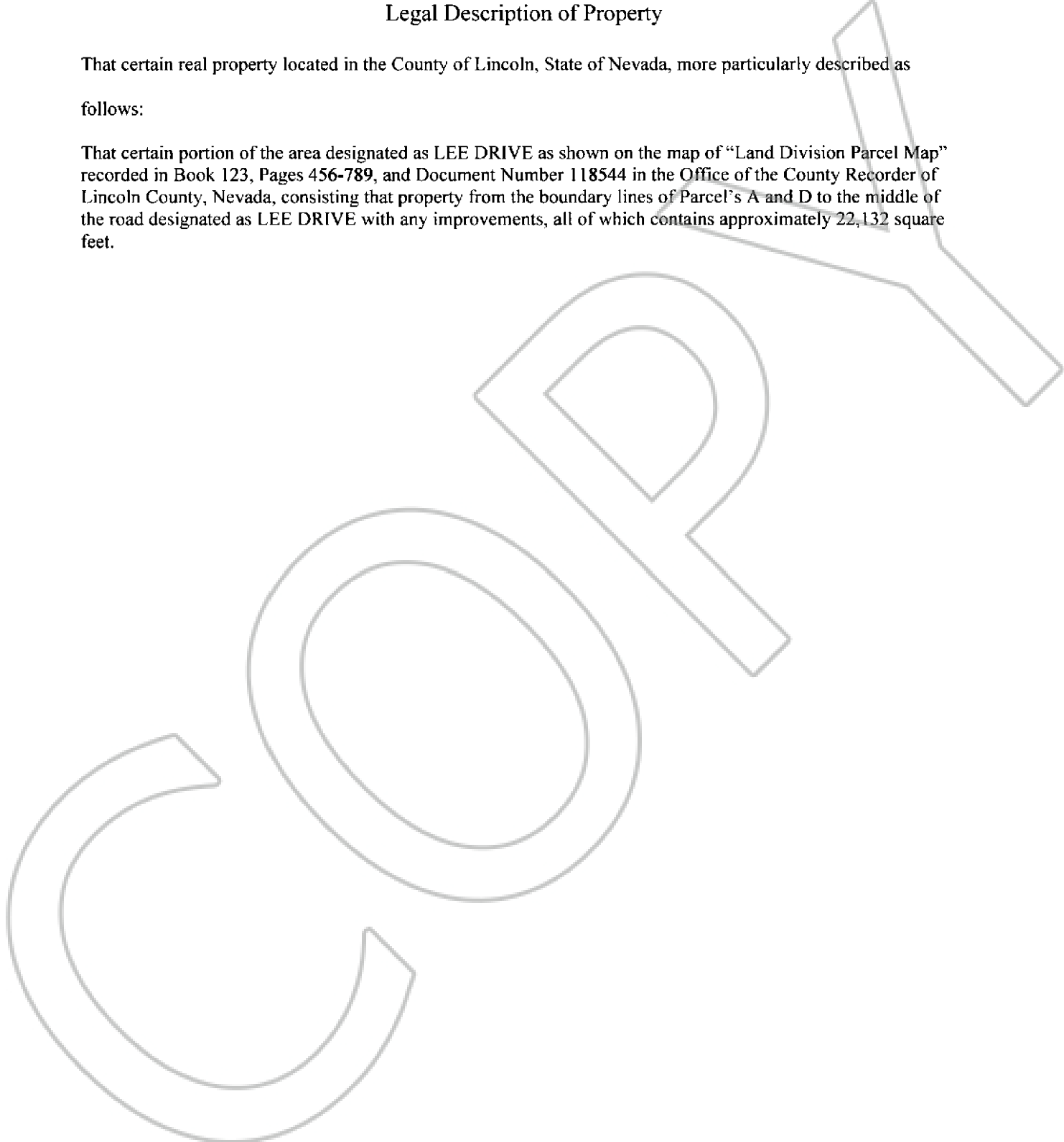

EXHIBIT A TO ROAD DEDICATION AND GRANT DEED

Legal Description of Property

That certain real property located in the County of Lincoln, State of Nevada, more particularly described as follows:

That certain portion of the area designated as LEE DRIVE as shown on the map of "Land Division Parcel Map" recorded in Book 123, Pages 456-789, and Document Number 118544 in the Office of the County Recorder of Lincoln County, Nevada, consisting that property from the boundary lines of Parcel's A and D to the middle of the road designated as LEE DRIVE with any improvements, all of which contains approximately 22,132 square feet.



Recording requested By
LINCOLN COUNTY

STATE OF NEVADA
DECLARATION OF VALUE FORM

Lincoln County - NV
Leslie Boucher - Recorder

Page 1 of 1 Fee:
Recorded By: LB RPTT:
Book-284 Page-0062

1. Assessor Parcel Number(s)

- a) 001-201-~~61~~ 61
- b) _____
- c) _____
- d) _____

2. Type of Property:

- a) Vacant Land
- b) Single Fam. Res.
- c) Condo/Twnhse
- d) 2-4 Plex
- e) Apt. Bldg
- f) Comm'l/Ind'l
- g) Agricultural
- h) Mobile Home
- Other PAVED ROADWAY SECTION

FOR RECORDER'S OPTIONAL USE ONLY
 Book: _____ Page: _____
 Date of Recording: _____
 Notes: _____

3. Total Value/Sales Price of Property \$ _____

Deed in Lieu of Foreclosure Only (value of property) (_____)

Transfer Tax Value: \$ _____

Real Property Transfer Tax Due \$ _____

4. If Exemption Claimed:

a. Transfer Tax Exemption per NRS 375.090, Section #2

b. Explain Reason for Exemption: LOCAL GOVERNMENT ENTITY - ROAD SECTION

5. Partial Interest: Percentage being transferred: _____ %

The undersigned declares and acknowledges, under penalty of perjury, pursuant to NRS 375.060 and NRS 375.110, that the information provided is correct to the best of their information and belief, and can be supported by documentation if called upon to substantiate the information provided herein. Furthermore, the parties agree that disallowance of any claimed exemption, or other determination of additional tax due, may result in a penalty of 10% of the tax due plus interest at 1% per month. Pursuant to NRS 375.030, the Buyer and Seller shall be jointly and severally liable for any additional amount owed.

Signature _____ Capacity _____

Signature [Signature] Capacity LC PLANNING DIRECTOR

SELLER (GRANTOR) INFORMATION (REQUIRED)

Print Name: VANIGANI K PHILLIPS AND DONNAMI PHILLIPS TRUST
Address: PO Box 454
City: PiOCHT
State: NV Zip: 89043

BUYER (GRANTEE) INFORMATION (REQUIRED)

Print Name: LINCOLN COUNTY
Address: PO Box 329
City: PiOCHT
State: NV Zip: 89043

COMPANY/PERSON REQUESTING RECORDING (required if not seller or buyer)

Print Name: LINCOLN COUNTY PLANNING Escrow #: _____
Address: PO Box 329
City: PiOCHT State: NV Zip: 89043