

**PANACA TOWNSITE
LINCOLN COUNTY, NEVADA**

VICINITY MAP
No Scale

SURVEYOR'S CERTIFICATE

I, Lenard D. Smith, a Professional Land Surveyor licensed in the State of Nevada, certify that:
 1. This plat represents the results of a survey conducted under my direct supervision at the instance of John M. Wadsworth.
 2. The lands surveyed lie within Section 9, Township 2 South, Range 68 East, M.D.M. The survey was completed on September 6, 2013.
 3. This plat complies with the applicable state statutes and any local ordinances in effect on the date that the governing body gave its final approval.
 4. The monuments depicted on the plat are of the character shown, occupy the positions indicated and are of sufficient number and durability.

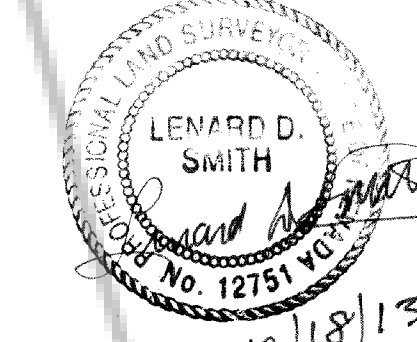

Lenard D. Smith P.L.S. 12751 Exp. June 30, 2014

RECORDERS CERTIFICATE

DOC # 0144141
 10/18/2013 12:28 PM
Official Record
 Recorded & Indexed By
 LENARD SMITH
 Lincoln County - NV
 Leslie Boucher - Recorder
 Fee: \$21.00 Page 1 of 1
 RPT: Recorded By: LB
 Book - 0 Page - 0100
 0144141

PLANNING COMMISSION

This is to certify that the zoning and comprehensive planning, the County of Lincoln, Nevada did approve for the purpose of land division and do hereby accept in behalf of the public this plat and easements offered for public use.

John M. Wadsworth 10-18-13
 Lincoln County Planning Commission

OWNER'S CERTIFICATE

I certify that I am the owner of the properties shown on this plat, we have requested Lenard D. Smith, a Professional Land Surveyor to prepare it, we authorize the recordation thereof, and we approve any easements as shown.

John M. Wadsworth 10-18-13
 John M. Wadsworth Date

ACKNOWLEDGEMENT

STATE OF NEVADA)
 COUNTY OF LINCOLN) ss

This instrument was acknowledged before me on October 18, 2013 by John M. Wadsworth, freely and voluntarily for the purposes stated.

Shannon M. Simpson My commission expires 01-20-2015
 Notary public

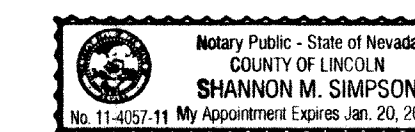

LINCOLN COUNTY ASSESSOR APPROVAL

I hereby certify that the ownership information contained hereon is correct and all owners have signed.

Melanie K. McBride 10-18-13
 Lincoln County Assessor Date

LINCOLN COUNTY TREASURER APPROVAL

Pursuant to NRS 278.468 I hereby certify that the taxes for the fiscal year 2013-2014 on Assessor Parcel Number 002-182-02, assessed John M. Wadsworth, are paid in full.

Shannon M. Simpson, Deputy Treasurer 10-18-13
 Lincoln County Treasurer and Ex-officio Tax Collector Date

LINCOLN COUNTY RECORDER APPROVAL

Pursuant to NRS 278.467 and 278.468, I hereby certify that this map was recorded within 1 year of the Lincoln County Planning Commission approval, the map is in an acceptable form for recording, the treasurer signature date matches the recorder date and that all fees have been paid for the recordation of this document.

Leslie Boucher 10-18-13
 Lincoln County Recorder Date

REFERENCES

- Official Plat of the Town of Panaca Plat Book A at Page 34
- Parcel Map for Beverly Gaffin Plat Book C at Page 0355
- Parcel Map for Richard E. Thornton II and Hilda M. Thornton Plat Book D at Page 0031
- Merger and Resubdivision Map for the Phillips Family Trust, Plat Book C at Page 0038
- Deed: Book N - 1 of Real Estate at Page 166

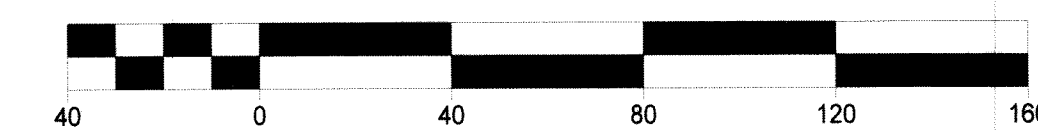

BLOCK 47

Parcel Map

For
John M. Wadsworth

In Section 9, Township 2 South, Range 68 East, Mount Diablo Meridian, Lincoln County, Nevada
 A.P.N. 002-182-02

Lenard Smith Land Survey

509 Main Street
 P.O. Box 443
 Caliente, Nevada 89008
 Phone/Fax 775 726 3365
 Cell Phone 775 962 1196



BLOCK 35

HANSEN STREET

PARCEL 1

42,128 square feet
 (0.967 acres)

Richard Chouquer
 APN 002-182-01

PARCEL 2

28,011 square feet
 (0.643 acres)

Steven J Chouquer
 APN 002-182-06

Michael & Mary Phillips Trust
 APN 002-182-03

JW Family Properties, LLC
 APN 002-182-07

LEGEND

- Set #5 rebar with cap stamped L SMITH PLS 12751
- ⊕ Found #5 rebar & cap stamped L SMITH PLS 12751
- ⊙ Set #5 rebar & cap stamped REF MONUMENT (on line reference monument) PLS 12751
- Parcel boundary line
- - Existing fence (various types)
- - Broken line
- R: 000,00' Map of Record (Distances only, no bearings given) Plat Book A, Page 34

BASIS OF BEARINGS

Bearings of this map based on the South line of the northwest quarter of Section 9, T. 2 S., R. 68 E., M.D.M. on the Annexation Map for the town of Panaca recorded Plat Book B, Page 90 of Lincoln County Records given as N 89°18'40" E.

MAP NOTE

Boundaries of the Lots of this map are justified by the accepted centers of each block at the center post from which property lines are thereby formed by the lines and the distances prorated between them.

BLOCK 27

FOURTH STREET

FIFTH STREET

BLOCK 34

BASIS OF BEARINGS

Bearings of this map based on the South line of the northwest quarter of Section 9, T. 2 S., R. 68 E., M.D.M. on the Annexation Map for the town of Panaca recorded Plat Book B, Page 90 of Lincoln County Records given as N 89°18'40" E.

MAP NOTE

Boundaries of the Lots of this map are justified by the accepted centers of each block at the center post from which property lines are thereby formed by the lines and the distances prorated between them.