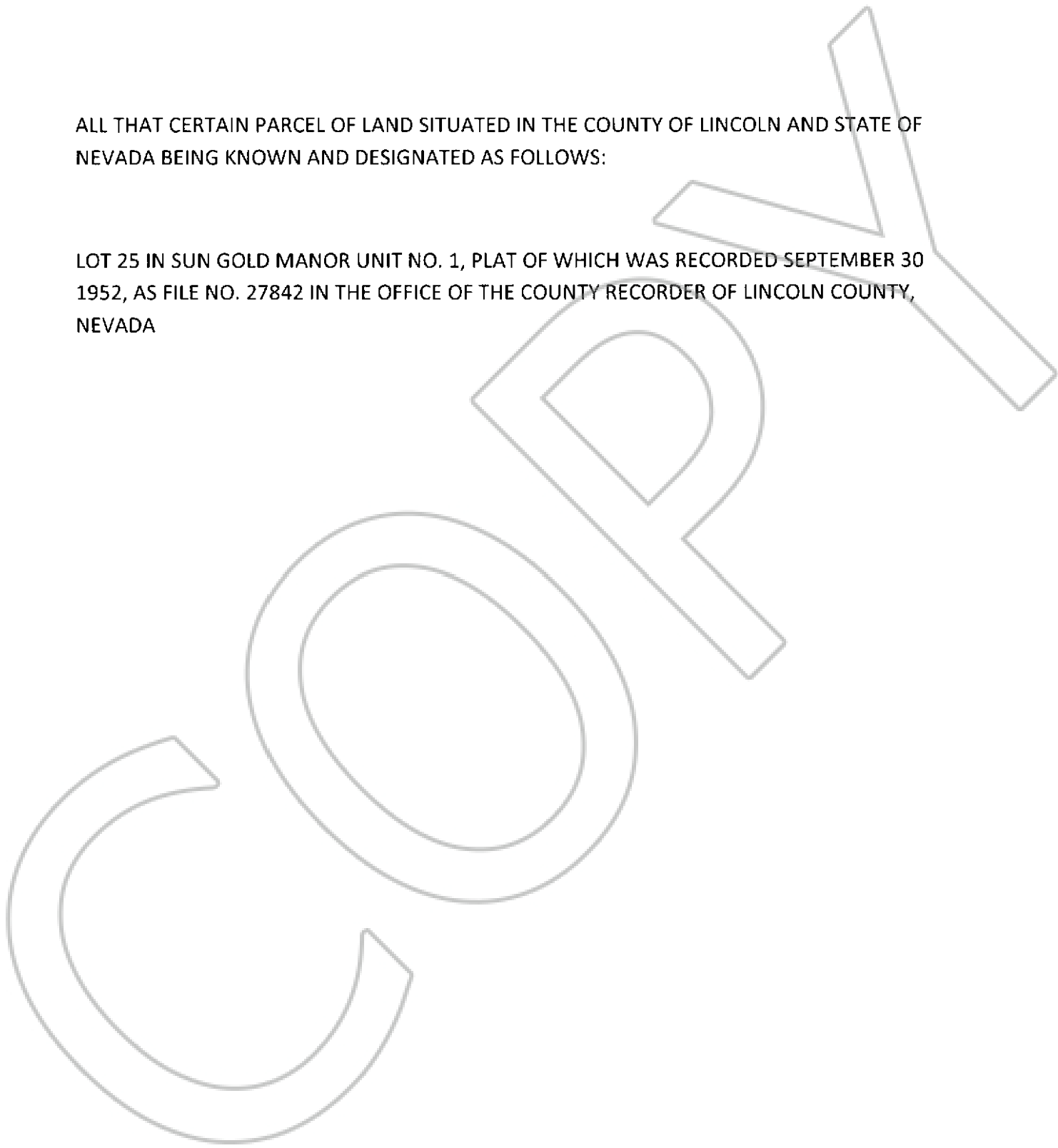



EXHIBIT A

ALL THAT CERTAIN PARCEL OF LAND SITUATED IN THE COUNTY OF LINCOLN AND STATE OF NEVADA BEING KNOWN AND DESIGNATED AS FOLLOWS:

LOT 25 IN SUN GOLD MANOR UNIT NO. 1, PLAT OF WHICH WAS RECORDED SEPTEMBER 30 1952, AS FILE NO. 27842 IN THE OFFICE OF THE COUNTY RECORDER OF LINCOLN COUNTY, NEVADA



**STATE OF NEVADA
 DECLARATION OF VALUE**

Recording requested By
 SPL EXPRESS, INC.

**Lincoln County - NV
 Leslie Boucher - Recorder**

Page 1 of 1 Fee: \$15.00
 Recorded By: LB RPTT: \$136.50
 Book- 281 Page- 0514

1. Assessor Parcel Number(s)
 a) 002-103-14
 b) _____
 c) _____
 d) _____

2. Type of Property:
- | | |
|--|--|
| a) <input type="checkbox"/> Vacant Land | b) <input checked="" type="checkbox"/> Single Fam. Res |
| c) <input type="checkbox"/> Condo/Twnhse | d) <input type="checkbox"/> 2-4 Plex |
| e) <input type="checkbox"/> Apt. Bldg | f) <input type="checkbox"/> Comm'l/Ind'l |
| g) <input type="checkbox"/> Agricultural | h) <input type="checkbox"/> Mobile Home |
| <input type="checkbox"/> Other | |

FOR RECORDER'S OPTIONAL USE ONLY
 Book: _____ Page: _____
 Date of Recording: _____
 Notes: _____

3. Total Value / Sales Price of Property \$34,900.00
 Deed in Lieu of Foreclosure Only (value of Property) ()
 Transfer Tax Value: \$34,900.00
 Real Property Transfer Tax Due \$136.50

4. If Exemption Claimed:

- a. Transfer Tax Exemption, per NRS 375.090, Section:
 b. Explain reason for exemption:

5. Partial Interest: Percentage being transferred: 100%

The undersigned declares and acknowledges, under penalty of perjury, pursuant to NRS 375.060 and NRS 375.110, that the information provided is correct to the best of their information and belief, and can be supported by documentation if called upon to substantiate the information provided herein. Furthermore, the parties agree that disallowance of any claimed exemption, or other determination of additional tax due, may result in a penalty of 10% of the tax due plus interest at 1% per month. Pursuant to NRS 375.030, the Buyer and Seller shall be jointly and severally liable for any additional amount owed.

Federal Home Loan Mortgage Corporation
 By: Malcolm & Cisneros, A Law Corporation
 It's Attorney in Fact

Signature _____ Capacity: Grantor
 By: Rande D Johnsen, It's Assistant Secretary

Signature _____ Capacity: Agent

SELLER (GRANTOR) INFORMATION
(REQUIRED)

Print Name: FEDERAL HOME LOAN Mortgage Corporation
 Address: 17100 GILLETTE AVE
 City: IRVINE
 State: CA Zip: 92614

BUYER (GRANTEE) INFORMATION
(REQUIRED)

Print Name: Robert Knipos ETAL
 Address: 5408 BREEMER DR.
 City: LAS VEGAS
 State: NV Zip: 89120

COMPANY/PERSON REQUESTING RECORDING (required if not seller or buyer)

Print Name: SPL EXPRESS, INC Order Number: 3163811
 Address: 1426 COLORADO BLVD. Escrow Number: 25754FD
 City: LOS ANGELES State: CA Zip: 90041

(AS A PUBLIC RECORD THIS FORM MAY BE RECORDED/MICROFILMED)