

Official Record

Recording requested By
COW COUNTY TITLE COMPANY

Lincoln County - NV

Leslie Boucher - Recorder

Fee: \$15.00 Page 1 of 2
RPTT: \$97.50 Recorded By: AE
Book- 281 Page- 0182

A.P.N. 006-041-48
R.P.T.T. \$97.50
Escrow No. 46284

Recording Requested By:
Cow County Title Co.

Mail Tax Statements To:
Same as below

When Recorded Mail To:
Gerald and Patricia Peterson
HCR 37 Box 645
Sandy Valley, NV 89019



0143844

GRANT, BARGAIN, SALE DEED

THIS INDENTURE WITNESSETH: That ROBERT J. LOZZI, a married man, who acquired title without a vesting and THOMAS LOZZI, a married man who acquired title without a vesting for valuable consideration, the receipt of which is hereby acknowledged, does hereby Grant, Bargain Sell and Convey to GERALD LEE PETERSON and PATRICIA ANNE PETERSON, husband and wife as Joint Tenants with Rights of Survivorship and to the heirs and assigns of such Grantee forever, all that real property situated in the County of Lincoln, State of Nevada, bounded and described as follows:

See Exhibit "A" attached hereto and by reference made a part hereof for complete legal description.

SUBJECT TO:

1. Taxes for fiscal year;
2. Reservations, restrictions, conditions, rights, rights of way and easements, if any of record on said premises.

Together with all and singular the tenements, hereditaments and appurtenances thereunto belonging or in anywise appertaining, and any reversions, remainders, rents, issues or profits thereof.

Dated: August 7, 2013

[Signature]
ROBERT J. LOZZI

[Signature]
THOMAS LOZZI

State of Nevada }
County of Clark } ss.

This instrument was acknowledged before me on August 10, 2013
by ROBERT J. LOZZI, THOMAS LOZZI

Signature: *[Signature]*
Notary Public

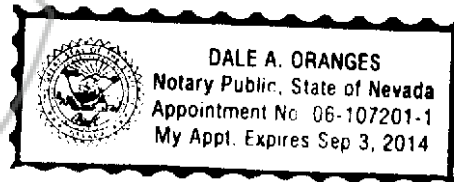



Exhibit A

File Number: 46284

All that certain real property situate in the County of Lincoln, State of Nevada, described as follows:

TOWNSHIP 4 NORTH, RANGE 67 EAST, M.D.B& M.,

Section 2: The East Half (E ½) of the Southeast Quarter (SE ¼) of U.S. Government Lot Numbered Ten (10)

ASSESSOR'S PARCEL NUMBER FOR 2013 – 2014: 006-041-48

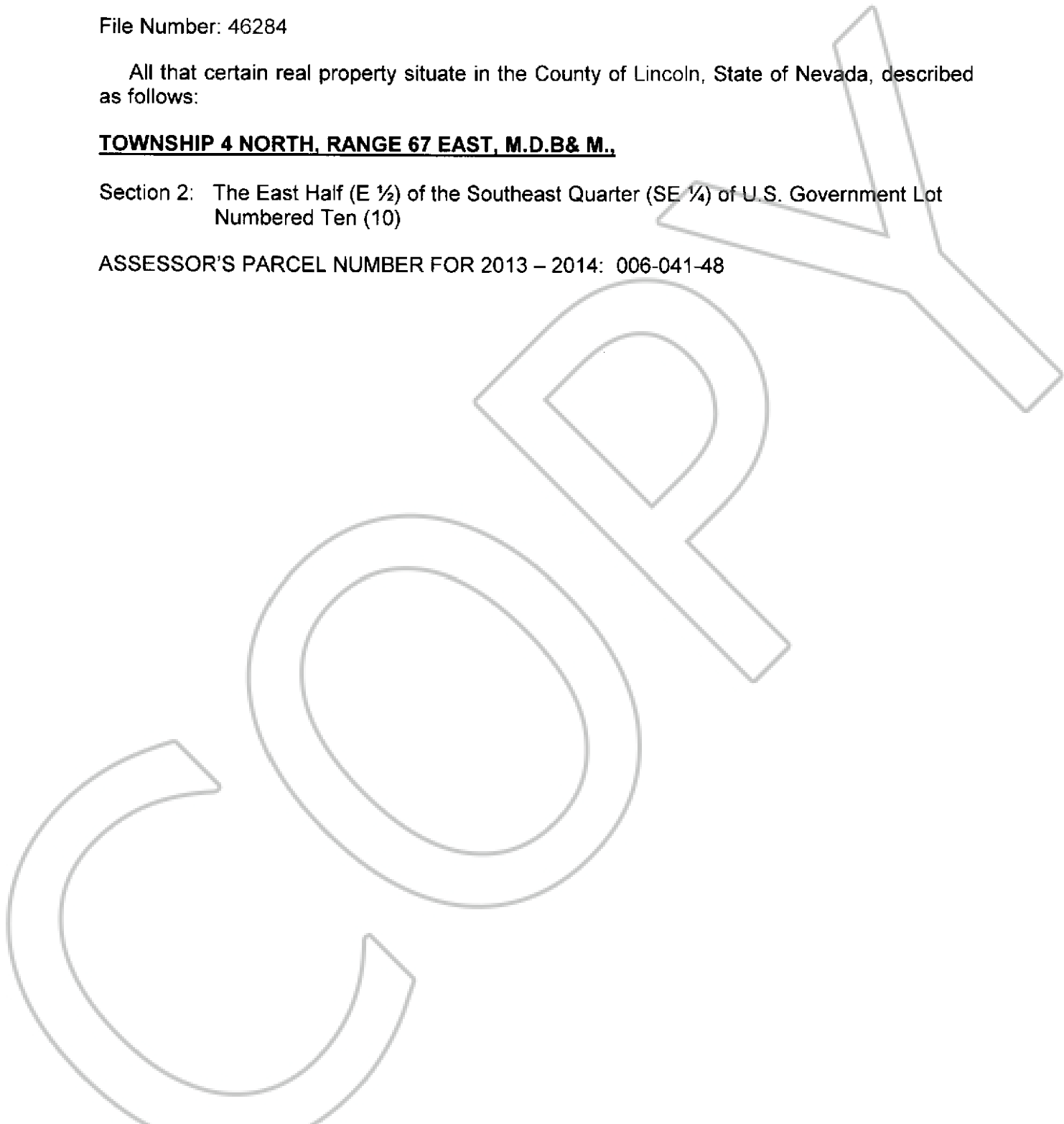

**STATE OF NEVADA
 DECLARATION OF VALUE**

Recording requested By
 COW COUNTY TITLE COMPANY

1. Assessor Parcel Number(s)
 a) 006-041-48
 b) _____
 c) _____
 d) _____

FOR RECORDER'S	
Document/Instrum	_____
Book	_____
Date of Recording:	_____
Notes:	_____

Lincoln County - NV
Leslie Boucher - Recorder
 Page 1 of 1 Fee: \$15.00
 Recorded By: AE RPTT: \$97.50
 Book- 281 Page- 0182

2. Type of Property
- | | |
|--|---|
| a) <input checked="" type="checkbox"/> Vacant Land | b) <input type="checkbox"/> Single Family Residence |
| c) <input type="checkbox"/> Condo/Twnhse | d) <input type="checkbox"/> 2-4 Plex |
| e) <input type="checkbox"/> Apartment Bldg. | f) <input type="checkbox"/> Commercial/Industrial |
| g) <input type="checkbox"/> Agricultural | h) <input type="checkbox"/> Mobile Home |
| i) <input type="checkbox"/> Other _____ | |

3. Total Value/Sales Price of Property \$25,000.00
 Deed in Lieu of Foreclosure Only (Value of Property) (_____)
 Transfer Tax Value \$25,000.00
 Real Property Transfer Tax Due: \$97.50

- 4. If Exemption Claimed:**
 a. Transfer Tax Exemption, per NRS 375.090, Section: _____
 b. Explain Reason for Exemption: _____
 5. Partial Interest: Percentage being transferred: 100 %

The undersigned declares and acknowledges, under penalty of perjury, pursuant to NRS 375.060 and NRS 375.110 that the information provided is correct to the best of their information and belief, and can be supported by documentation if called upon to substantiate the information provided herein. Furthermore, the disallowance of any claimed exemption or other determination of additional tax due, may result in a penalty of 10% of the tax due plus interest at 1% per month.
Pursuant to NRS 375.030, the Buyer and Seller shall be jointly and severally liable for any additional amount owed.

Signature: *Robert J. Lozzi* Capacity: **Seller/Grantor**

Signature: _____ Capacity: **Buyer/Grantee**

SELLER (GRANTOR) INFORMATION
 ROBERT J. LOZZI
 Print Name: THOMAS LOZZI
 Address: 1308 Colony Pine St.
 City/State/Zip Las Vegas, NV 89144

BUYER (GRANTEE) INFORMATION
 GERALD LEE PETERSON
 Print Name: PATRICIA ANNE PETERSON
 Address: HCR 37 Box 645
 City/State/Zip Sandy Valley, NV 89019

COMPANY/PERSON REQUESTING RECORDING (required if not the Seller or Buyer)
 Company Name: Cow County Title Co. Escrow No 46284
 P.O. Box 518
 328 Main St.
 Address: Pioche, Nevada 89043