



**3J CATTLE, LLC
LEGAL DESCRIPTION
EXHIBIT A**

The land described herein is situated in the County of Lincoln, State of Nevada, and is described as follows:

PARCEL 1:

THE SOUTHEAST QUARTER (SE $\frac{1}{4}$) OF THE SOUTHWEST QUARTER (SW $\frac{1}{4}$); THE NORTHWEST QUARTER (NW $\frac{1}{4}$) OF THE SOUTHEAST QUARTER (SE $\frac{1}{4}$); AND THE SOUTHWEST QUARTER (SW $\frac{1}{4}$) OF THE SOUTHEAST QUARTER (SE $\frac{1}{4}$) OF SECTION 15, TOWNSHIP 3 SOUTH, RANGE 67 EAST, M.D.M.

PARCEL 2:

PARCEL 2 AS SHOWN ON MAP OF DIVISION INTO LARGE PARCELS FOR LOM THOMPSON RECORDED FEBRUARY 27, 1996 AS FILE NO. 104837 IN PLAT BOOK A, PAGE 476, IN THE OFFICE OF THE COUNTY RECORDER OF LINCOLN COUNTY, NEVADA, BEING A PORTION OF THE EAST HALF (E $\frac{1}{2}$) OF THE NORTHEAST QUARTER (NE $\frac{1}{4}$) OF SECTION 21, TOWNSHIP 3 SOUTH, RANGE 67 EAST, M.D.M.

PARCEL 3:

ALL OF SECTION 22, TOWNSHIP 3 SOUTH, RANGE 67 EAST, M.D.M.
EXCEPTING THEREFROM ALL THAT PARCEL OF LAND IN THE NORTHWEST QUARTER (NW $\frac{1}{4}$) OF THE NORTHWEST QUARTER (NW $\frac{1}{4}$) OF SECTION 22, TOWNSHIP 3 SOUTH, RANGE 67 EAST, M.D.M., LYING WEST OF U.S. HIGHWAY 93, AND MORE PARTICULARLY DESCRIBED AS FOLLOWS:
BEGINNING AT THE NORTHWEST CORNER OF SAID SECTION 22, MONUMENTED BY A STANDARD BUREAU OF LAND MANAGEMENT BRASS CAP, THENCE NORTH 89°53'16" EAST 908.57 FEET ALONG THE NORTH LINE OF SAID SECTION 22 TO THE U.S. HIGHWAY RIGHT-OF-WAY TO A NDOT CONCRETE MONUMENT AND CENTER PIN; THENCE SOUTH 50°19'15" WEST 1,184.60 FEET ALONG SAID U.S. HIGHWAY RIGHT-OF-WAY TO A REBAR AND CAP STAMPED P.L.S. 6204; THENCE NORTH 00°14'19" EAST 754.58 FEET TO THE POINT OF BEGINNING.

PARCEL 4:

THE NORTHWEST QUARTER (NW $\frac{1}{4}$) OF THE NORTHEAST QUARTER (NE $\frac{1}{4}$); THE NORTH HALF (N $\frac{1}{2}$) OF THE NORTHWEST QUARTER (NW $\frac{1}{4}$); AND THE SOUTHWEST QUARTER (SW $\frac{1}{4}$) OF THE NORTHWEST QUARTER (NW $\frac{1}{4}$) OF SECTION 27, TOWNSHIP 3 SOUTH, RANGE 67 EAST, M.D.M.

PARCEL 5:

THE NORTHEAST QUARTER (NE $\frac{1}{4}$) AND THE NORTHEAST QUARTER (NE $\frac{1}{4}$) OF THE SOUTHWEST QUARTER (SW $\frac{1}{4}$) OF SECTION 28, TOWNSHIP 3 SOUTH, RANGE 67 EAST, M.D.M.

PARCEL 6:

PARCEL NO. 2 AS SHOWN ON PARCEL MAP FOR LOM THOMPSON RECORDED DECEMBER 02, 1996 AS FILE NO. 106560 IN PLAT BOOK B, PAGE 10, IN THE OFFICE OF THE COUNTY RECORDER OF LINCOLN COUNTY, NEVADA, BEING A PORTION OF THE EAST HALF (E $\frac{1}{2}$) OF THE NORTHWEST QUARTER (NW $\frac{1}{4}$) OF SECTION 28, TOWNSHIP 3 SOUTH, RANGE 67 EAST, M.D.M.



**3J CATTLE, LLC
LEGAL DESCRIPTION
EXHIBIT A**

PARCEL 7:

THE EAST HALF (E $\frac{1}{2}$) OF THE SOUTHEAST QUARTER (SE $\frac{1}{4}$) AND THE SOUTH HALF (S $\frac{1}{2}$) OF THE SOUTHWEST QUARTER (SW $\frac{1}{4}$) OF THE SOUTHEAST QUARTER (SE $\frac{1}{4}$) OF SECTION 21, TOWNSHIP 3 SOUTH, RANGE 67 EAST, M.D.M.

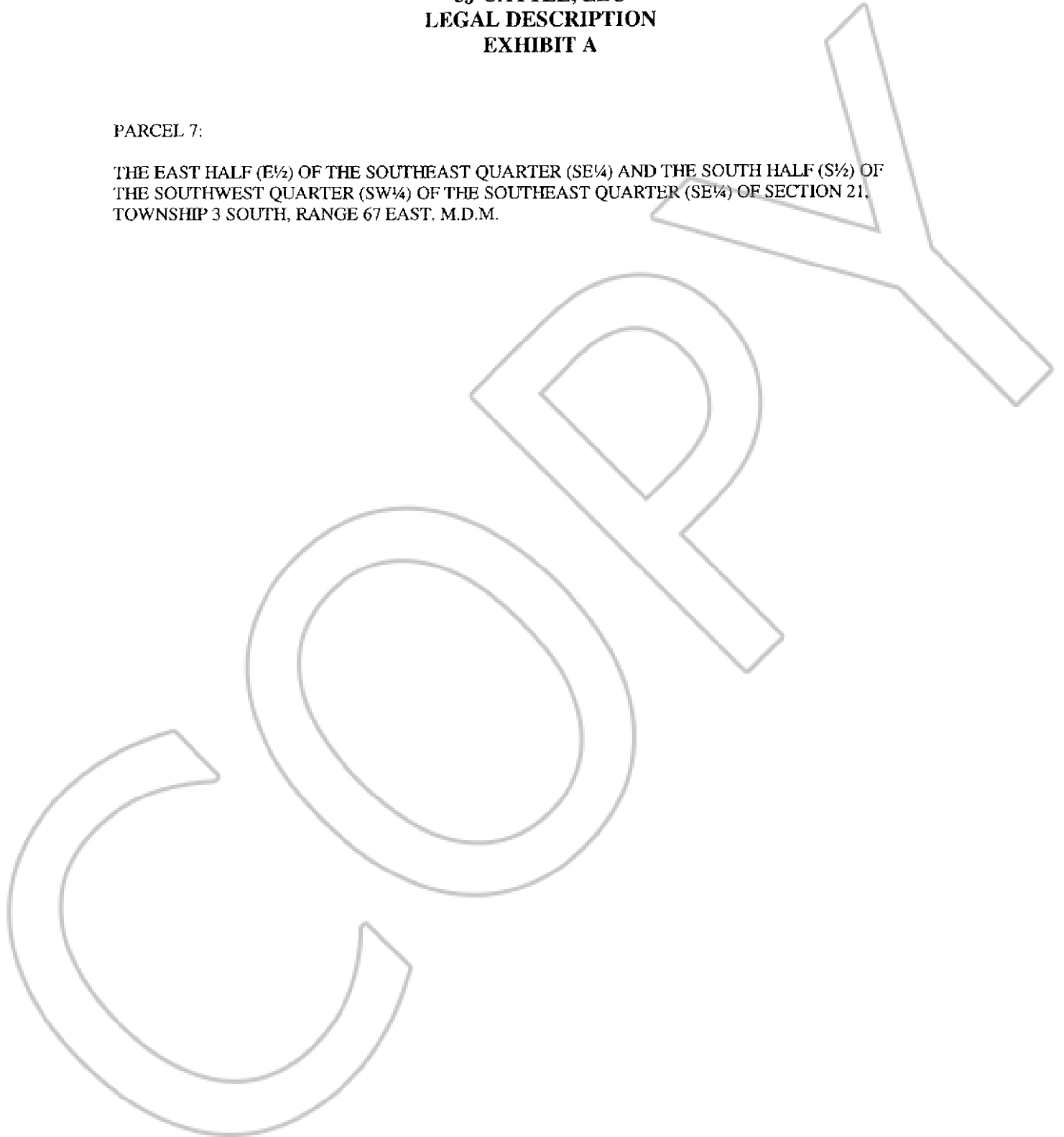



**3J CATTLE, LLC
COLLATERAL
EXHIBIT B**

All water and water rights of every kind and nature, including but not limited to any and all water and water rights received from or distributed by Permit Number 22477 (Certificate Number 7554), Permit Number 24327 (Certificate Number 14438), Permit Number 25873 (Certificate Number 9286), Permit Number 57679 (Certificate Number 16180) and Permit Number 57680 (Certificate Number 16181), now owned or hereafter acquired by Debtor, whether such water and water rights are riparian, appropriative or otherwise and whether or not appurtenant to the real estate described on Exhibit A attached hereto, all ditch and ditch rights and any shares of stock, licenses, permits and contracts evidencing such water or ditch rights, and all wells, reservoirs, dams, embankments or fixtures relating thereto, together with all replacements, substitutions, accessions thereto and proceeds derived therefrom.

All irrigation equipment of every kind and nature, including but not limited to center irrigation pivots, wheel lines, hand lines, pumps, pvc pipe, sprinklers, gearheads, motors and windmills, now owned or hereafter acquired by Debtor and wheresover located and situated, including but not limited to the foregoing described equipment now or hereafter installed on, affixed to, placed upon or used in connection with the real estate described on Exhibit A attached hereto, together with all replacements, renewals, substitutions and proceeds derived therefrom.

All of the Debtor's rights, title and interest in and to any and all federal government leases, licenses and permits now or hereafter owned by the Debtor including but not limited to BLM Authorization Number 2703733, Allotment Number 01036 (Highway) and Allotment Number 01055 (Peck), together with any and all other leases, licenses and permits of every kind and nature, by and between Debtor and the United States of America, by and through its agencies, which are connected to or pertain to the real estate described on Exhibit A attached hereto, together with all replacements, renewals, substitutions and proceeds derived therefrom.

All fixtures of every kind and nature, now owned or hereafter acquired by Debtor and now or hereafter located and situated on the real estate described on Exhibit A attached hereto, together with all replacements, substitutions, accessions thereto and proceeds derived therefrom.

DISPOSITION OF THE COLLATERAL IS NOT AUTHORIZED HEREBY.