

R70E MDB&M

22
(Unsur.)

23
(Unsur.)

24
(Unsur.)

Found Brass Cap
 NW Cor., Sec. 7
 T1S-R71E MDB&M

N4° 27' 10"W
 14,709 ft.

BS 159 BS 166 BS 185 BS 204 BS 223 BS 248
 BS 158 BS 165 BS 184 BS 203 BS 222 BS 247
 East - 10,500 ft.

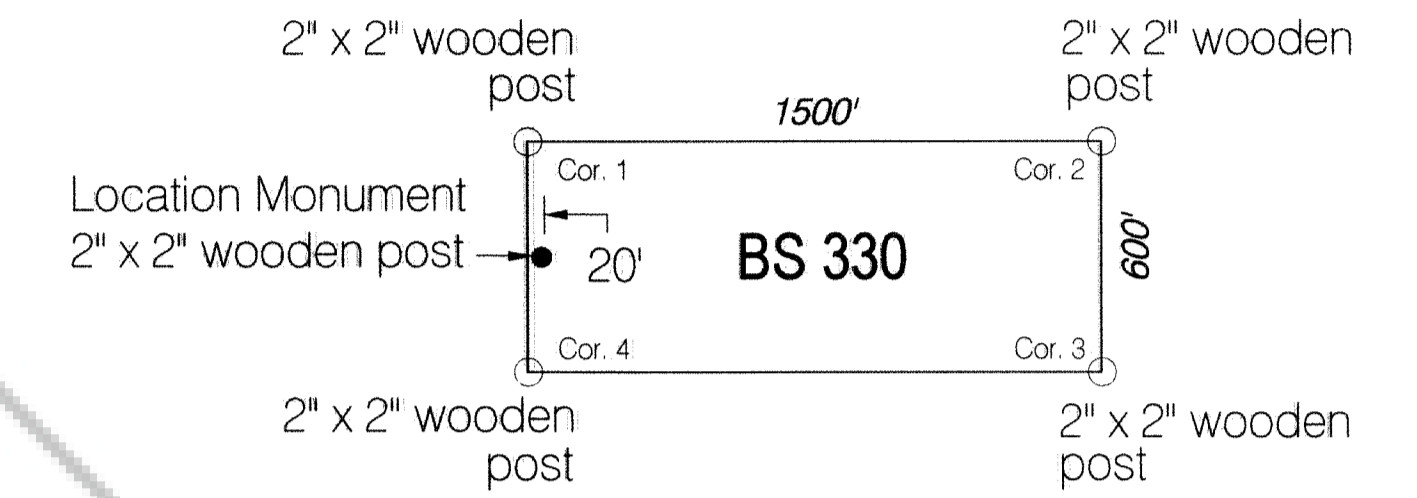

Typical Lode Claim

Location Dates:

BS 296 thru BS 327 located April 20, 2013
 BS 328 thru BS 351 located April 19, 2013

Locator:

Nevada High Desert Gold, LLC
 2696 S. Colorado Blvd.
 Suite 240
 Denver, Colorado 80222

T
1
S

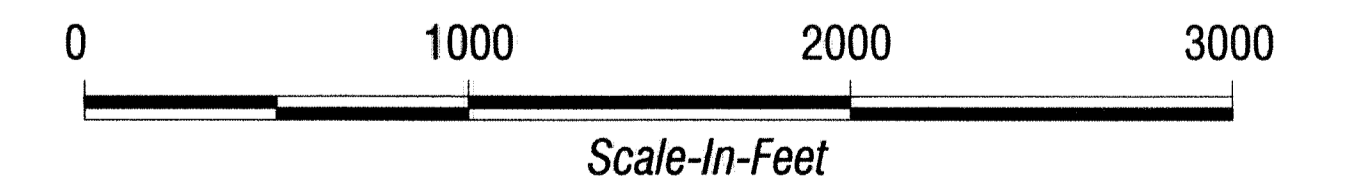
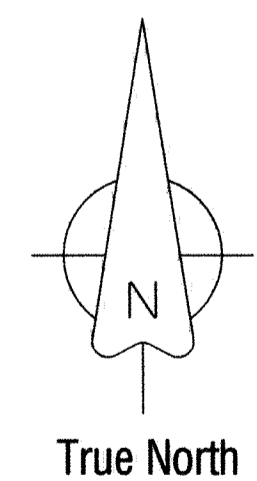

West - 10,500 ft.

North - 4,800 ft.

South - 4,800 ft.

27
(Unsur.)

26
(Unsur.)

25
(Unsur.)

• BS 344	• BS 329	•• BS 328	• BS 313	•• BS 312	• BS 297	•• BS 296
• BS 345	• BS 331	•• BS 330	• BS 315	•• BS 314	• BS 299	•• BS 298
• BS 346	• BS 333	•• BS 332	• BS 317	•• BS 316	• BS 301	•• BS 300
• BS 347	• BS 335	•• BS 334	• BS 319	•• BS 318	• BS 303	•• BS 302
• BS 348	• BS 337	•• BS 336	• BS 321	•• BS 320	• BS 305	•• BS 304
• BS 349	• BS 339	•• BS 338	• BS 323	•• BS 322	• BS 307	•• BS 306
• BS 350	• BS 341	•• BS 340	• BS 325	•• BS 324	• BS 309	•• BS 308
• BS 351	• BS 343	•• BS 342	• BS 327	•• BS 326	• BS 311	•• BS 310

HIGH DESERT High Desert Gold Corp. 2696 S. Colorado Blvd. Suite 240 Denver, Colorado 80222		<h2>Gold Springs Project</h2> <h3>BS Lode Mining Claims</h3> <p>Lincoln County, Nevada</p>	
DRAWN BY:	DATE	PROJECT NO.:	MINING DISTRICT:
GEOLOGY BY:	DATE	SCALE: 1"=500'	SHEET 1 OF 1
LAST REVISION:	DATE	REV A MINING CLAIMS	