

SURVEYOR'S CERTIFICATE

I, Lenard D. Smith, a Professional Land Surveyor licensed in the State of Nevada, certify that:

1. This plat represents the results of a survey conducted under my direct supervision at the instance of Joseph Sharp
2. The lands surveyed lie within Section 5, Township 7 South, Range 61 East, M.D.M. The survey was completed on May 25, 2012
3. This plat complies with the applicable state statutes and any local ordinances in effect on the date that the governing body gave its final approval.
4. The monuments depicted on the plat are of the character shown, occupy the positions indicated and are of sufficient number and durability.

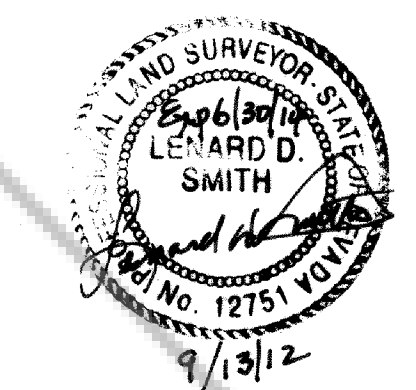

Lenard D. Smith P.L.S. 12751 Exp. June 30, 2014

OWNER'S CERTIFICATE

We certify that we are the owners of the properties shown on this plat, we have requested Lenard D. Smith, a Professional Land Surveyor to prepare it, we authorize the recording thereof, and we approve any easements as shown

Joseph L. Sharp 9-17-12
 Joseph Sharp - Trustee Date

ACKNOWLEDGEMENT

STATE OF NEVADA) ss
 COUNTY OF LINCOLN)
 This instrument was acknowledged before me on Sept 17, 2012 by Joseph Sharp, freely and voluntarily for the purposes stated.

Robin E. Simmers My commission expires NOV 6 2014
 Notary public

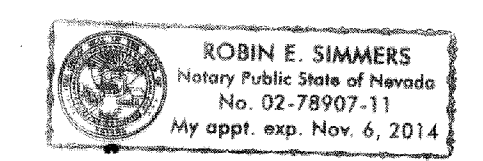

PLANNING COMMISSION

This is to certify that the zoning and comprehensive planning, of the County of Lincoln, Nevada on this 13th day of September, 2012 did approve for the purpose of land division and do hereby accept in behalf of the public, this plat and any easements offered for public use.

Dorlene Sharp 9/18/12
 Lincoln County Planning Commission Date

LINCOLN COUNTY ASSESSOR APPROVAL

I hereby certify that the ownership information contained hereon is correct and all owners have signed.
Melanie McBride 9-18-12
 Lincoln County Assessor Date

LINCOLN COUNTY TREASURER APPROVAL

Pursuant to NRS 278.468 I hereby certify that the taxes for the fiscal year 2011-2012 on Assessor Parcel Number 004-071-06 are paid in full.
Shawn Fisher 9/18/12
 Lincoln County Treasurer and Ex-officio Tax Receiver Date

LINCOLN COUNTY RECORDER APPROVAL

Pursuant to NRS 278.467 and 278.468, I hereby certify that this map was recorded within 1 year of the Lincoln County Planning Commission approval, the map is in an acceptable form for recording, the treasurer signature date matches the recorder date and that all fees have been paid for the recording of this document.
Joseph L. Smith 9-18-2012
 Lincoln County Recorder Date

MAP NOTE

All record bearing and distances are taken from parcel map in Plat Book C, Page 239 except the distances of the parcel being divided which distances are taken from the Deeds as referenced.

BASIS OF BEARING

The South line of Section 5, Township 7 South, Range 61 East, M.D.M. monumented as shown on this plat, given in Plat Book C, Page 239, Lincoln County, Nevada Records as N 89°51'46" E

REFERENCES

Plat Book A, Page 41, Alamo Townsite
 Plat Book A, Page 98A
 Plat Book C, Page 239
 Deed, Book M-1, Page 102
 Deed, Book 92, Page 135-137, Document # 094875
 All in Lincoln County, Nevada Records

LEGEND

- ⊙ Set rebar with plastic cap stamped L SMITH PLS 12751
- ⊙ Set rebar with plastic cap stamped REF MONUMENT PLS 12751
- ⊙ Found rebar with cap stamped L SMITH PLS 12751 RM
- ⊙ Parcel corner lands in middle of canal, not set
- Street right of way
- Broken tie
- Parcel Line
- (N 00°00'00" W 000.00') Record Bearing and Distances

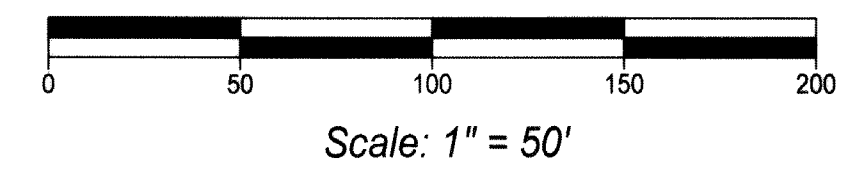
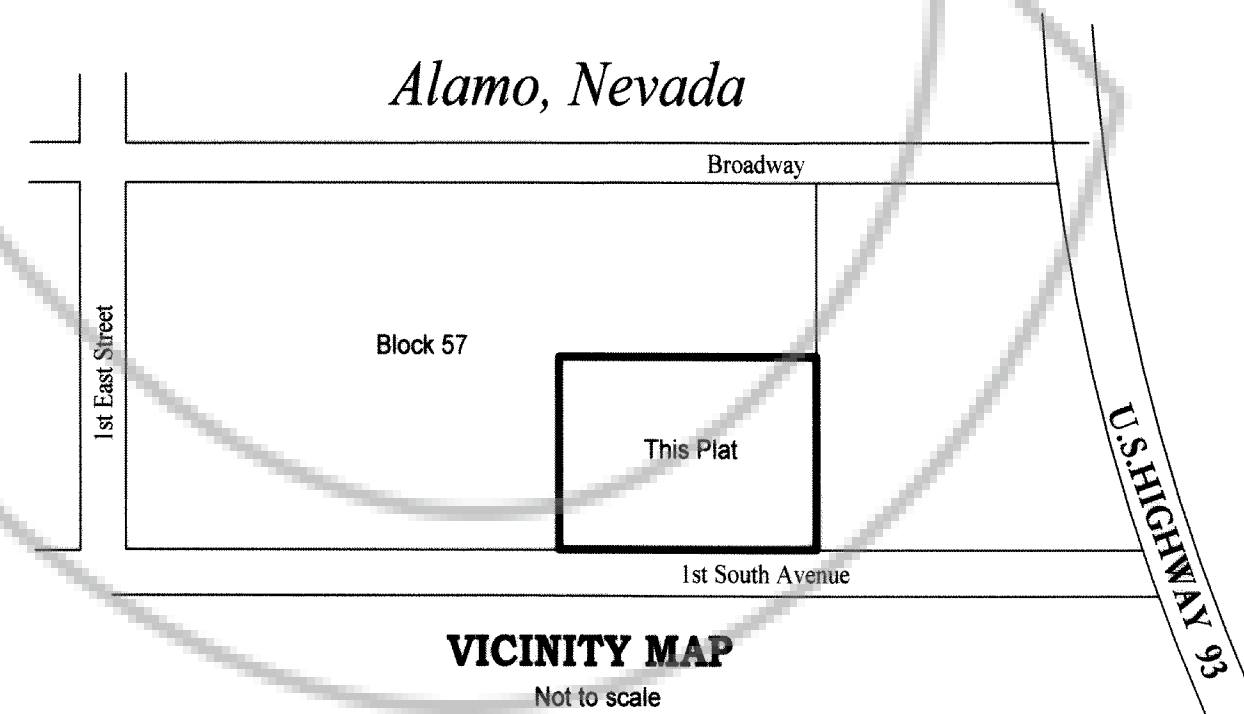
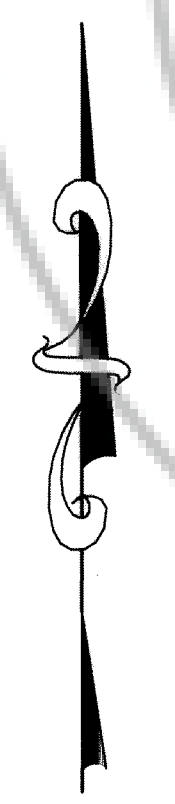

Parcel Map for Joseph & Dorlene Sharp Trust, executed 23 August 1990, in the SW 1/4 of SE 1/4 of Section 5, Township 7 South, Range 61 East, MDM APN # 004-071-06

Lenard Smith Land Survey
 509 Main Street
 P.O. Box 443
 Caliente, Nevada 89008
 Phone/Fax 775 726 3365
 Cell Phone 775 962 1196

Sheet 1 of 1