

Official Record

Recording requested By
A W E.

Lincoln County - NV
Leslie Boucher - Recorder

Fee \$15.00 Page 1 of 2
RPTT: Recorded By LB
Book- 270 Page- 0628



Mail Recorded Deed and Tax Bill to:
Stonewood Trust
29676 Avante
Laguna Niguel, CA 92677-7962

For Recorder's Use Only

QUITCLAIM DEED

FOR VALUABLE CONSIDERATION, receipt of which is acknowledged, **COLOR CLAIMS, INC.** "Grantor"), does hereby release and forever quitclaim to **STONEWOOD TRUST, C/O WILLIAM G. STANLEY** ("Grantee"), all that right, title and interest of the undersigned in and to the real property situate in the County of Lincoln, State of Nevada, as described in **Exhibit A**, attached hereto and incorporated herein.

TOGETHER with all and singular the tenements, hereditaments and appurtenances hereunto belonging or otherwise appertaining.

WITNESS my hand this 29th day of March, 2012.

By: *Wayne Aiken*
WAYNE AIKEN
President

STATE OF NEVADA *Utah*)
) ss.
COUNTY OF ~~CLARK~~ *Iron*)

On this 29th day of March, 2012, personally appeared before me, a Notary Public, *Wayne Aiken*, and known to me to be the persons whose names are subscribed to the above instrument and acknowledged to me that they executed the above instrument for the purposes stated therein

Jennifer Downs
NOTARY PUBLIC in and for said County and State

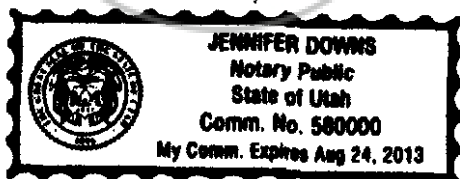



EXHIBIT A

LEGAL DESCRIPTION

The LAKES CLAIMS Group:

Tropic: NMC0933946. Southwest corner is 5280' true north of northwest corner of section 4, Township 3N, Range 63E, Mt. Diablo Meridian. From southwest corner it runs 2640' west to east and then 1320' true north and then 2640' from east to west and then 1320' south to form 80 acre rectangle.

Duck Creek: NMC0933948. Southwest corner is 3960' true north of northwest corner of section 4, Township 3N, Range 63E, Mt. Diablo Meridian. From southwest corner it runs 2640' west to east and then 1320' true north and then 2640' from east to west and then 1320' south to form 80 acre rectangle.

Newcastle: NMC0933950. Southwest corner is 2640' true north of northwest corner of section 4, Township 3N, Range 63E, Mt. Diablo Meridian. From southwest corner it runs 2640' west to east and then 1320' true north and then 2640' from east to west and then 1320' south to form 80 acre rectangle.

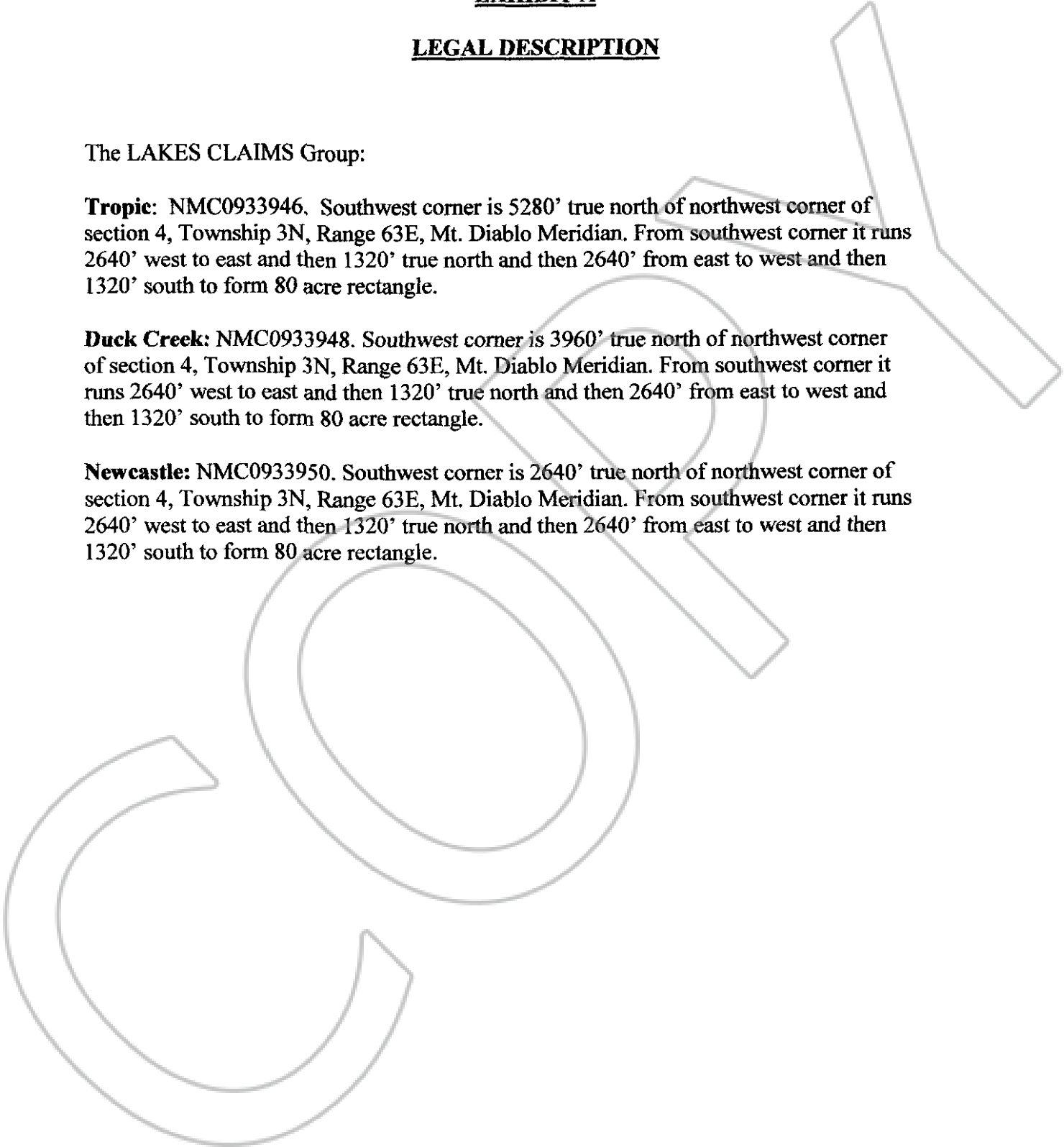

STATE OF NEVADA
DECLARATION OF VALUE FORM

Recording requested By
A.W.E.

Lincoln County - NV
Leslie Boucher - Recorder

Page 1 of 1 Fee: \$15.00
Recorded By: LB RPTT.
Book- 270 Page- 0628

1. Assessor Parcel Number(s)

- a) NMC0933946
- b) NMC0933948
- c) NMC0933950
- d) _____

2. Type of Property:

- a) Vacant Land
- b) Single Fam. Res.
- c) Condo/Twnhse
- d) 2-4 Plex
- e) Apt. Bldg
- f) Comm'l/Ind'l
- g) Agricultural
- h) Mobile Home
- Other Unpatented mining claims

| | |
|----------------------------------|-------------|
| FOR RECORDER'S OPTIONAL USE ONLY | |
| Book: _____ | Page: _____ |
| Date of Recording: _____ | |
| Notes: _____ | |

3. Total Value/Sales Price of Property

Deed in Lieu of Foreclosure Only (value of property) \$ 0

Transfer Tax Value: \$ 0

Real Property Transfer Tax Due \$ 0

4. If Exemption Claimed:

- a. Transfer Tax Exemption per NRS 375.090, Section # B
- b. Explain Reason for Exemption: Unpatented Mining Claims ownership being transferred.

5. Partial Interest: Percentage being transferred: 100 %

The undersigned declares and acknowledges, under penalty of perjury, pursuant to NRS 375.060 and NRS 375.110, that the information provided is correct to the best of their information and belief, and can be supported by documentation if called upon to substantiate the information provided herein. Furthermore, the parties agree that disallowance of any claimed exemption, or other determination of additional tax due, may result in a penalty of 10% of the tax due plus interest at 1% per month. Pursuant to NRS 375.030, the Buyer and Seller shall be jointly and severally liable for any additional amount owed.

Signature _____ Capacity Buyer

Signature [Signature] Capacity Seller

SELLER (GRANTOR) INFORMATION
(REQUIRED)

Print Name: Color Claims, Inc.

Address: 637 S. 400 East

City: Cedar City

State: Utah Zip: 84720

BUYER (GRANTEE) INFORMATION
(REQUIRED)

Print Name: Stonewood Trust C/O William G. Stanely

Address: 29676 Avante

City: Laguna Niguel

State: California Zip: 92677-7962

COMPANY/PERSON REQUESTING RECORDING (required if not seller or buyer)

Print Name: _____ Escrow #: _____

Address: _____

City: _____ State: _____ Zip: _____