

10.56' = 1 mi.

NEVADA NRC
1066701

NEVADA NRC
1066725

NE CORNER OF
T7N, R69E, Sec 28

RECEIVED
FEB 13 2012
BLM/NVSO IAC

MAP OF THE "ROKN" CLAIMS

ATLANTA MINING DISTRICT
LINCOLN COUNTY, NEVADA
T7N, R69E, S27, 28, 34 (MT. DIABLO MEF)

ROKN-1 THRU ROKN-19 LOCATED 4 JANUARY 2012
ROKN-19 THRU ROKN-25 LOCATED 9 FEBRUARY 2012

CLAIMANT:
G. MAYNARD
P.O. Box 11233
RENO, NV 89510

THIS DOCUMENT CONFORMS TO NRS 603A.040
G.M. Maynard 13 FEB 2012

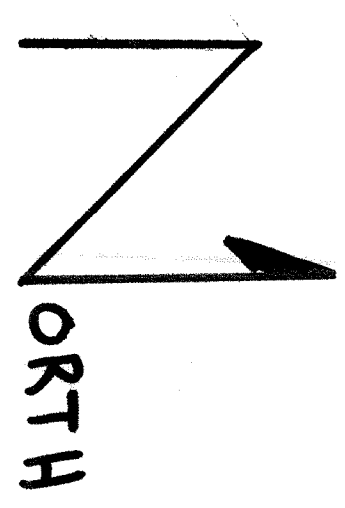

0 500 1000 1500 FT
SCALE: 1:6000

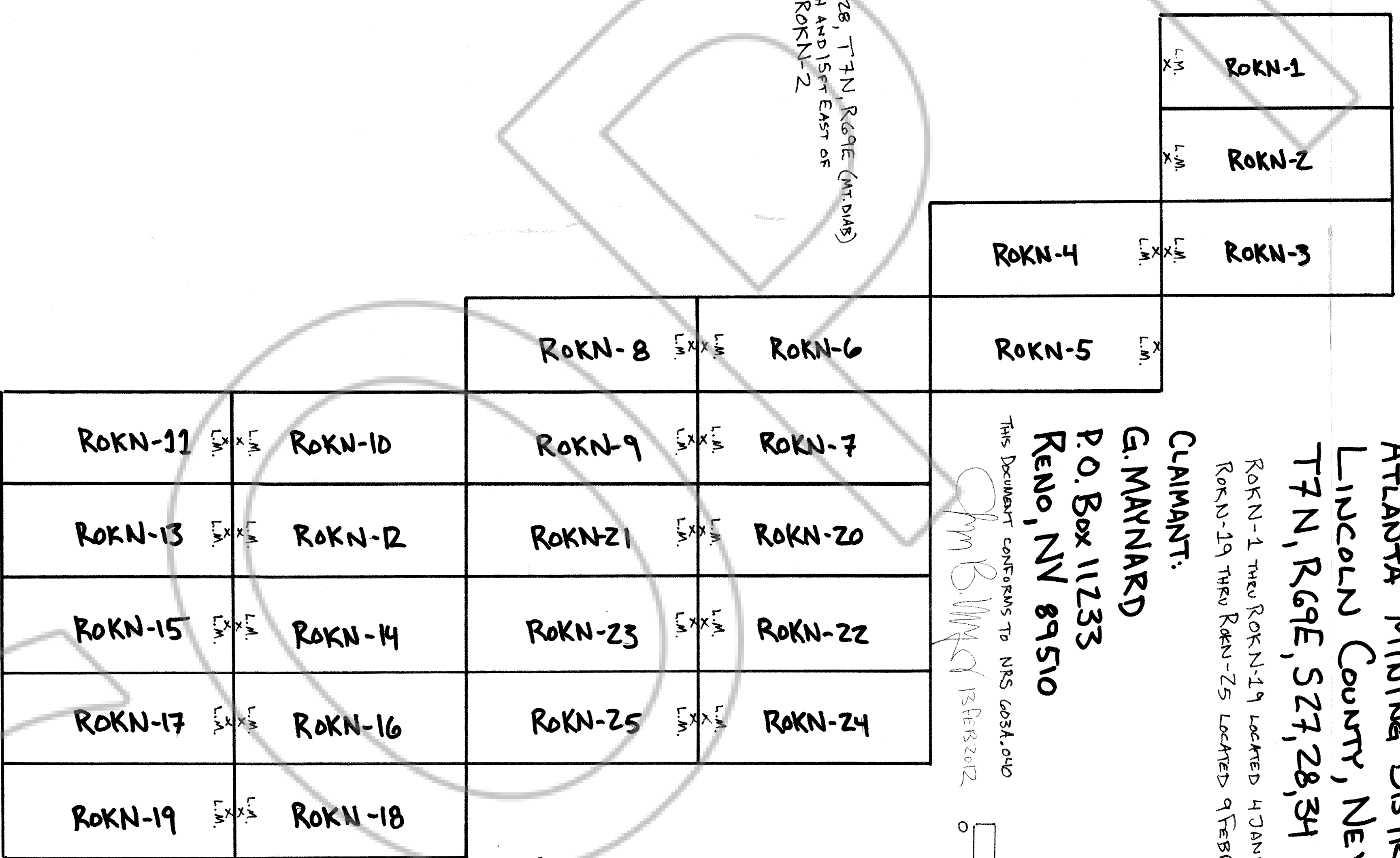
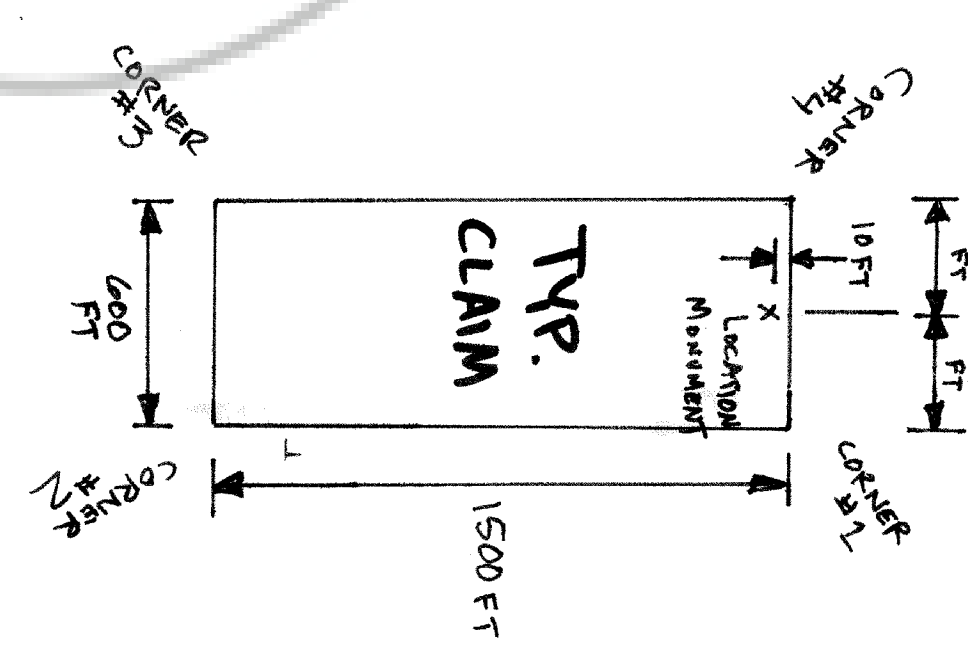

TE:
NE COR. SECTION 28, T7N, R69E (MT. DIABLO)
LIES 229 FT NORTH AND 15 FT EAST OF
NE COR. CLAIM ROKN-2

DOC # 0140842
OFFICIAL RECORD
02/28/2012 04:18 PM
RECORDED BY: [unclear]
Lincoln County - NV
Linda A. Baehler - Recorder
Fee: \$35.00
Book - 210 Page - 0228
0140842