

SNO #14	SNO #15	SNO #16	SNO #17	SNO #18	SNO #19	SNO #20	SNO #21	SNO #22	SNO #23
LM	LM	LM	LM	LM	LM	LM	LM	LM	LM
SNO #24	SNO #25	SNO #26	SNO #27	SNO #28	SNO #29	SNO #30	SNO #31	SNO #32	SNO #33
LM	LM	LM	LM	LM	LM	LM	LM	LM	LM
SNO #34	SNO #35	SNO #36	SNO #37	SNO #38	SNO #39	SNO #40	SNO #41	SNO #42	SNO #43
LM	LM	LM	LM	LM	LM	LM	LM	LM	LM

33

34

35

T. 8 N., R. 68 E  
 T. 7 N., R. 68 E

T. 8 N., R. 68 E  
 T. 7 N., R. 68 E

4

3

2

9

10

11

15,469' N 13° 30' W  
 10,648' N 7° 0' E

USLM 4843  
 UTM-NAD27 11S 732937 4260923

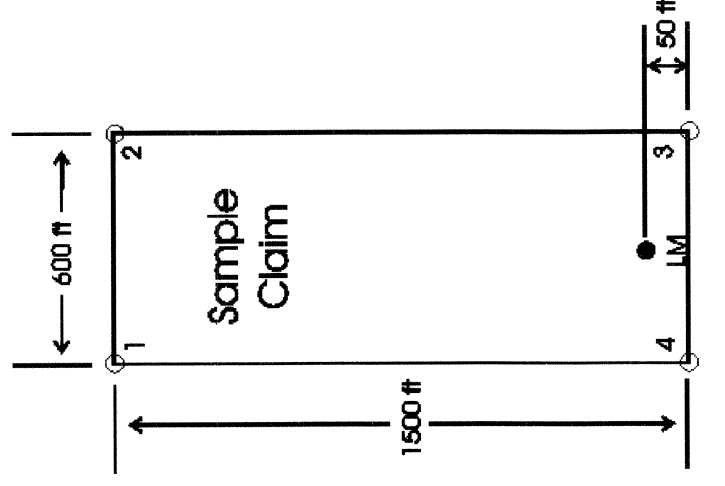

Note: Unsurveyed townships, no original PLSS corners  
 Section corners herein were derived from data encoded  
 in Garmin US TOPO 24k West map software

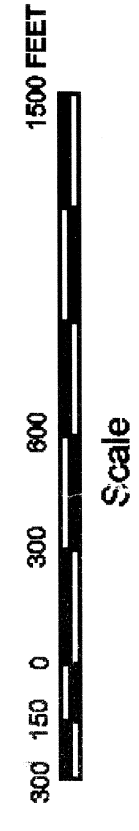
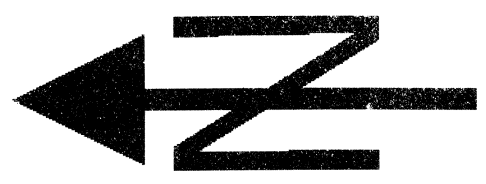

Claims #1 thru #13 located  
 in Lincoln County, Texas  
 Surveyed by  
 Doug Oiler  
 4812 Brenneford Rd.  
 Coleville, Texas 75604

Desert Hawk Resources Inc.  
 HC 10, Box 15, Pioche NV, 89043

Completed	Date	Drafted	Date
Doug Oiler 0111		Tom Mearns 0111	
Tom Mearns 7111			

MAP OF THE SNO-14  
 THRU SNO-40  
 LOSE CLAIMS  
 LINCOLN COUNTY, NEVADA  
 T. 7 N., R. 68 E., SEC. 2, 3, 11  
 T. 8 N., R. 68 E., SEC. 33, 34, 35  
 DATE: 8/15/2011 Scale: 1 inch = 500 feet