

14

13

21,537' N 82° 5' E

USLM 4843

UTM-NAD27 11S 732937 4260923

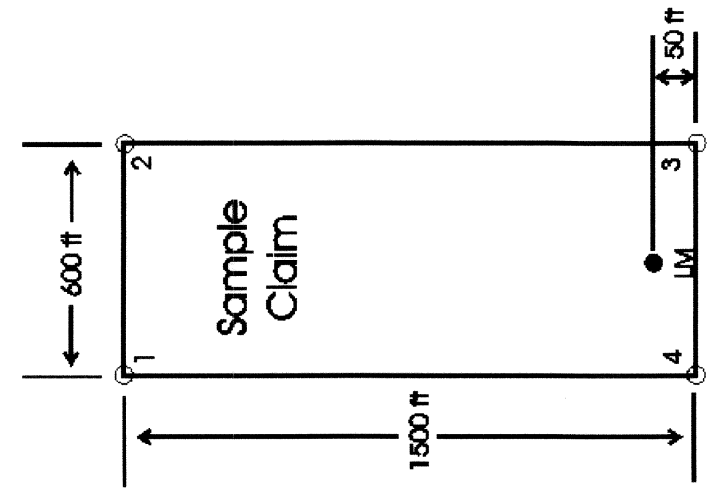
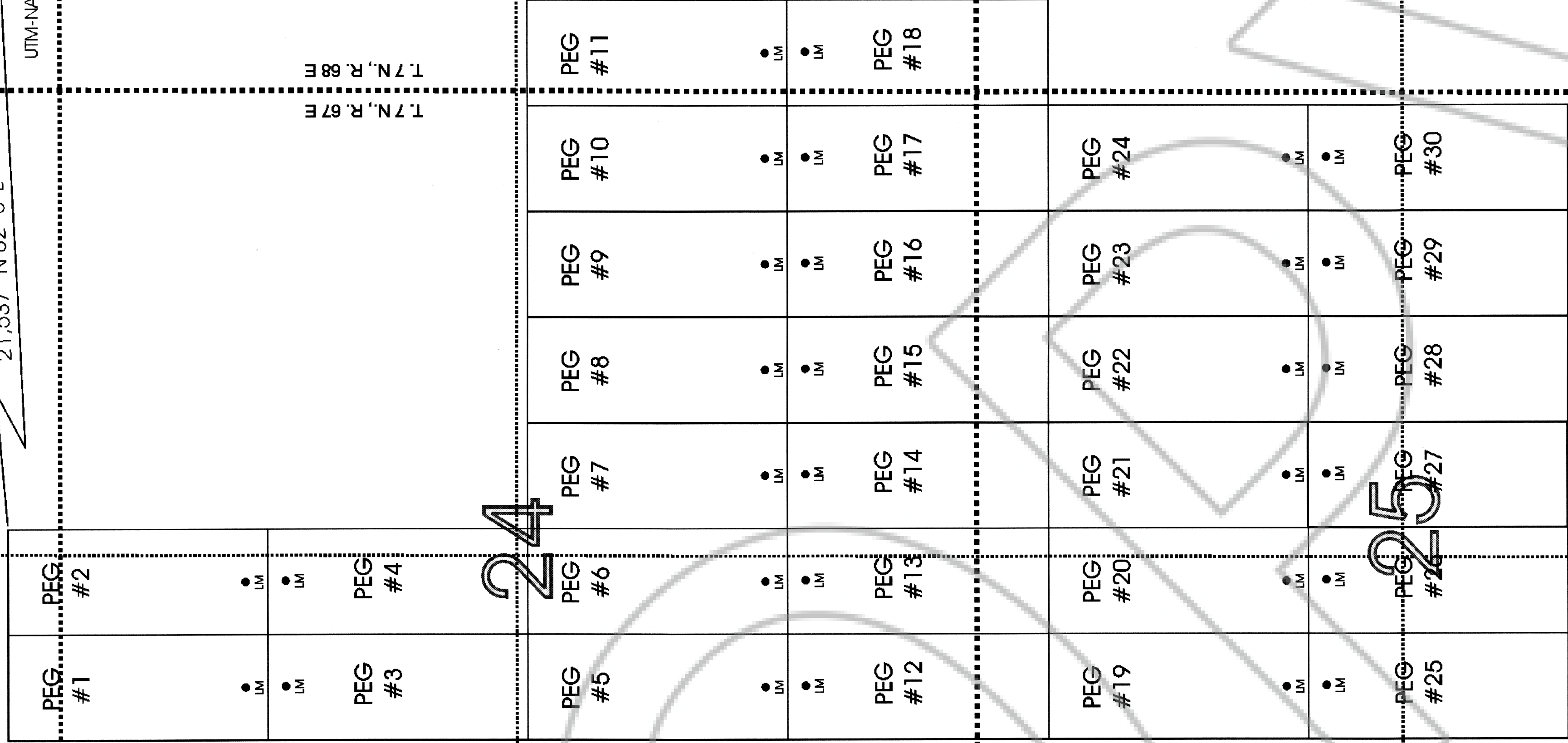

Note: Unsurveyed townships, no original PLSS corners section corners herein were derived from data encoded in Garmin US TOPO 24k West map software

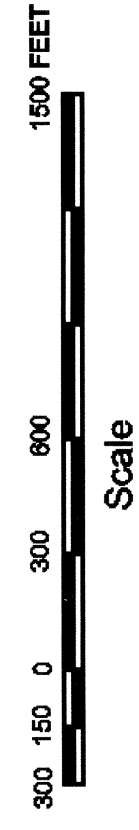

All claims located
 April 29, 2011
 by
 Tom Manning
 2892 Powell St
 Springdale, AR 72764

Desert Hawk Resources Inc.
 HC-10, Box 15, Pioche NV 89043

Completed	Date	Drawn	Date
Drawn	04/11/11	Tom Manning	04/11
Reviewed	04/11/11	Tom Manning	04/11

MAP OF THE PEG-1
 THRU PEG-30
 LOSE CLAIMS
 LINCOLN COUNTY, NEVADA
 T. 7 N., R. 66 E., SEC 19, 30
 T. 7 N., R. 67 E., SEC 13, 24, 25
 DATE: 04/15/2011 Scale: 1 inch = 500 feet

31

36

26

30

23

24

19

17 N, R 87 E
 17 N, R 88 E

17 N, R 87 E
 17 N, R 88 E