

T. 8N., R. 68 E.
T. 7N., R. 68 E

T. 8N., R. 68 E.
T. 7N., R. 68 E

33

34

35

4

3

2

9

10

11

SNO #14	SNO #15	SNO #16	SNO #17	SNO #18	SNO #19	SNO #20	SNO #21	SNO #22	SNO #23
SNO #24	SNO #25	SNO #26	SNO #27	SNO #28	SNO #29	SNO #30	SNO #31	SNO #32	
SNO #33	SNO #34	SNO #35	SNO #36	SNO #37	SNO #38	SNO #39	SNO #40		

SNO #1	SNO #2	SNO #3	SNO #4	SNO #5	SNO #6	SNO #7
SNO #8	SNO #9	SNO #10	SNO #11	SNO #12	SNO #13	

15,469' N 13° 30' W
10,646' N 7° 0' E

USLM 4843
UTM-NAD27 11S 732937 4260923

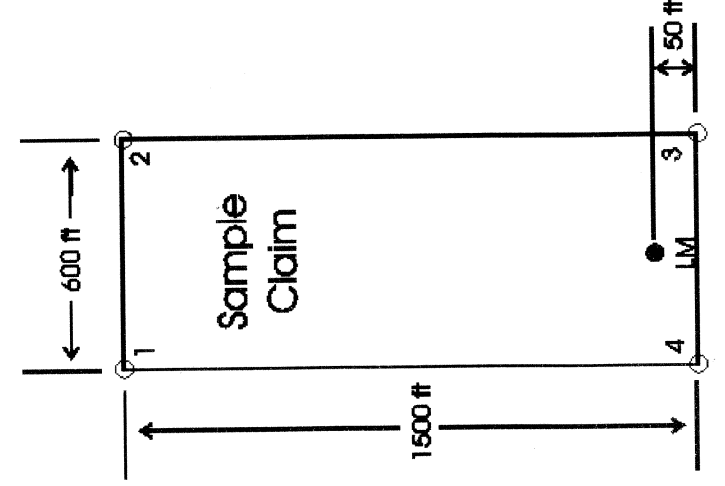

Claim #4 thru #40 located:
July 10, 2011 by
Tom Mattinger, S.I.
2882 Powell St.
Springdale, AR 72764

Note: Unsurveyed townships, no original PLSS corners
Section corners herein were derived from data encoded
in Garmin US TOPO 24K West map software

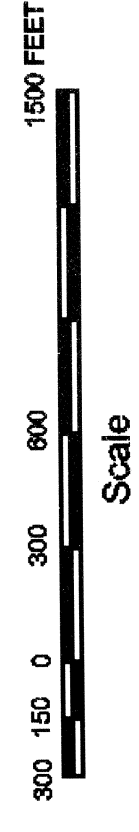

LOCATED BY: DESERT HAWK RESOURCES, INC.

DOC # 0139192
Official Record
Lincoln County - NV
Leslie Baucher - Recorder
Book - 256 Page - 0088

Completed	Date	Drawn	Date
Tom Mattinger 5/11		Tom Mattinger 5/11	
Tom Mattinger 7/11			

MAP OF THE SNO-1
THRU SNO-13
LODE CLAIMS
LINCOLN COUNTY, NEVADA
T. 7 N., R. 68 E., SEC 2, 3, 11
DATE: 8/15/2011 Scale: 1 inch = 500 feet