

LEGAL DESCRIPTION MESQUITE CITY CORPORATE LIMITS

DECREE IN THE EIGHTH JUDICIAL DISTRICT COURT

BEGINNING AT THE NORTHEAST CORNER OF SECTION 18, TOWNSHIP 13 SOUTH, RANGE 71 EAST, MOUNT DIABLO BASE AND MERIDIAN AND RUNNING;
 THENCE WEST 2195.82 FEET ALONG THE SECTION LINE TO THE CORNER OF SECTION 9 AND SECTION 10, TOWNSHIP 13 SOUTH, RANGE 71 EAST;
 THENCE NORTH 89°59'00" WEST, 5286.60 FEET ALONG THE SECTION LINE TO THE CORNER OF SECTION 8 AND SECTION 9, TOWNSHIP 13 SOUTH, RANGE 71 EAST;
 THENCE NORTH 89°54'00" WEST, 5278.68 FEET ALONG THE SECTION LINE TO THE CORNER OF SECTION 7 AND SECTION 8, TOWNSHIP 13 SOUTH, RANGE 71 EAST;
 THENCE NORTH 89°58'00" WEST, 5265.48 FEET TO THE NORTHWEST CORNER OF SECTION 7, AND THE RANGE LINE OF RANGE 70 AND RANGE 71;
 THENCE SOUTH 2640.00 FEET ALONG THE RANGE LINE TO THE EAST QUARTER CORNER OF SECTION 12, TOWNSHIP 13 SOUTH, RANGE 70 EAST, MOUNT DIABLO BASE AND MERIDIAN;
 THENCE SOUTH 89°57'00" WEST, 5276.95 FEET ALONG THE CENTER SECTION TO THE WEST QUARTER CORNER OF SECTION 12, TOWNSHIP 13 SOUTH, RANGE 70 EAST;
 THENCE SOUTH 0°01'00" EAST, 5280.00 FEET ALONG THE SECTION LINES TO THE QUARTER CORNER OF SECTION 13 AND SECTION 14, TOWNSHIP 13 SOUTH, RANGE 70 EAST;
 THENCE NORTH 89°57'00" WEST, 5272.08 FEET ALONG THE CENTER OF SECTION LINE TO THE WEST QUARTER OF SECTION 14, TOWNSHIP 13 SOUTH, RANGE 70 EAST;
 THENCE SOUTH 0°01'00" EAST, 2640.00 FEET ALONG THE SECTION LINE TO THE SOUTHWEST CORNER OF SECTION 14, TOWNSHIP 13 SOUTH, RANGE 71 EAST;
 THENCE SOUTH 0°01'00" EAST, 5280.00 FEET ALONG THE SECTION LINE TO THE SOUTHWEST CORNER OF SECTION 23, TOWNSHIP 13 SOUTH, RANGE 70 EAST;
 THENCE SOUTH 0°01'00" EAST, 3925.02 FEET ALONG THE SECTION LINE TO A POINT PLUS OR MINUS IN THE VIRGIN RIVER;
 THENCE FOLLOWING THE VIRGIN RIVER AS FOLLOWS; THENCE NORTH 48°30'00" EAST, 5800.00 FEET;
 THENCE NORTH 66°00'00" EAST, 5500.00 FEET;
 THENCE NORTH 79°30'00" EAST, 6000.00 FEET FROM RANGE 70 EAST INTO RANGE 71 EAST;
 THENCE NORTH 89°00'00" EAST, 1800.00 FEET;
 THENCE NORTH 73°00'00" EAST, 10,500.00 FEET;
 THENCE NORTH 86°00'00" EAST, 1503.30 FEET TO THE NEVADA AND ARIZONA STATE LINES;
 THENCE NORTH 0°28'00" WEST, 4089.52 FEET ALONG THE EAST LINE OF SECTION 15, TOWNSHIP 13 SOUTH, RANGE 71 EAST AND THE STATE LINE TO THE NORTHEAST CORNER OF SECTION 15, TOWNSHIP 13 SOUTH, RANGE 71 EAST;
 THENCE NORTH 0°03'00" WEST, 5281.98 FEET ALONG THE SECTION LINE AND THE STATE LINE TO THE POINT OF BEGINNING.

CONTAINS 11,508 SQUARE MILES.

TOGETHER WITH:

ANNEXATION BY MESQUITE CITY COUNCIL No. 105

TOWNSHIP 13 SOUTH, RANGE 71 EAST, M.D. MERIDIAN, NEVADA
 SECTION 3; LOTS 6 THROUGH 12 SW 1/4, NW 1/4, W 1/2, SW 1/4;
 SECTION 4; LOTS 5 AND 12, SE 1/4, NE 1/4, E 1/2, SE 1/4;
 CONTAINS 516.45 ACRES, MORE OR LESS.

REFERENCE DOCUMENTS

- 1) CASE No. A 228184, DEPT. No. XI, CIVIL DOCKET "S", EIGHTH JUDICIAL DISTRICT COURT OF THE STATE OF NEVADA.
- 2) ORDINANCE No. 105, CITY OF MESQUITE, COUNTY OF CLARK, STATE OF NEVADA.
- 3) LOCAL GOVERNMENT MAP, FILE LG, PAGE 66
- 4) ORDINANCE No. 283, CITY OF MESQUITE, COUNTY OF CLARK, STATE OF NEVADA.
- 5) LOCAL GOVERNMENT MAP, FILE LG, PAGE 104
- 6) ORDINANCE No. 409, CITY OF MESQUITE, COUNTY OF CLARK, STATE OF NEVADA.
- 7) BUREAU OF LAND MANAGEMENT PLATS OF INDEPENDENT RESURVEYS OF TOWNSHIP 12 SOUTH, RANGE 70 AND 71 EAST, BOTH ACCEPTED ON JULY 24, 2001.

LEGAL DESCRIPTION CITY OF MESQUITE 2003 ANNEXATION

UNITED STATES GOVERNMENT LAND, WITHIN CLARK COUNTY, NEVADA, LYING SOUTH OF THE THIRD STANDARD PARALLEL SOUTH, AND BEING PORTIONS OF TOWNSHIP 13 SOUTH, RANGE 71 EAST, TOWNSHIP 13 SOUTH, RANGE 70 EAST, TOWNSHIP 13 SOUTH, RANGE 69 EAST, TOWNSHIP 14 SOUTH, RANGE 70 EAST, AND TOWNSHIP 14 SOUTH, RANGE 69 EAST, MOUNT DIABLO BASE AND MERIDIAN AND BEING MORE PARTICULARLY DESCRIBED AS:

ALL OF GOVERNMENT LOTS 6, 7, 8, 9, 10 AND 11, THE WEST HALF (W1/2) OF THE SOUTH HALF (S1/2) OF THE NORTHEAST QUARTER (NE1/4), THE WEST HALF (W1/2) OF THE SOUTHWEST QUARTER (SW1/4), THE SOUTH HALF (S1/2) OF THE NORTHWEST QUARTER (NW1/4) AND THE SOUTHWEST QUARTER (SW1/4) OF SECTION 4, ALL OF SECTION 5 AND ALL OF SECTION 6, TOWNSHIP 13 SOUTH, RANGE 71 EAST, MOUNT DIABLO BASE AND MERIDIAN AS SHOWN ON THE GOVERNMENT LAND OFFICE OFFICIAL PLAT OF THE INDEPENDENT RESURVEY WITH TRACT SEGREGATIONS APPROVED APRIL 17, 1935. CONTAINS 2,150.94 ACRES

TOGETHER WITH:

ALL OF SECTIONS 1 THROUGH 3, ALL OF SECTIONS 10 AND 11, THE NORTH HALF (N1/2) OF SECTION 12, THE NORTH HALF (N1/2) OF SECTION 14, ALL OF SECTION 15, THE EAST HALF (E1/2) OF SECTION 16, THE EAST HALF (E1/2) OF SECTION 21, ALL OF SECTION 22, THE NORTHEAST QUARTER (NE1/4) AND THE SOUTHWEST QUARTER (SW1/4) OF SECTION 28, THE SOUTHWEST QUARTER (SW1/4) OF THE SOUTHWEST QUARTER (SW1/4), THE EAST HALF (E1/2) OF THE NORTHEAST QUARTER (NE1/4) OF THE SOUTHWEST QUARTER (SW1/4) AND THAT PORTION OF THE SOUTHWEST QUARTER (SW1/4) THAT LIES SOUTH OF THE NORTH RIGHT-OF-WAY LINE OF INTERSTATE 15 OF SECTION 29, THAT PORTION OF THE NORTHWEST QUARTER (NW1/4) THAT LIES NORTH OF THE SOUTH RIGHT-OF-WAY LINE OF INTERSTATE 15 OF SECTION 34, TOWNSHIP 13 SOUTH, RANGE 70 EAST, MOUNT DIABLO BASE AND MERIDIAN AS SHOWN ON THE GOVERNMENT LAND OFFICE OFFICIAL PLAT OF THE INDEPENDENT RESURVEY WITH TRACT SEGREGATIONS APPROVED MAY 16, 1935. THE NORTHWEST QUARTER (NW1/4), THE NORTH HALF (N1/2) OF THE NORTHEAST QUARTER (NE1/4), THE NORTHWEST QUARTER (NW1/4) OF THE SOUTHWEST QUARTER (SW1/4) AND ALL OF GOVERNMENT LOTS 4, 5, 6, 7, 9, 11, 12, 13, 14, 15, 16, 18 AND 20 OF SECTION 27, THE NORTH HALF (N1/2) OF THE SOUTHWEST QUARTER (SW1/4), THE SOUTHWEST QUARTER (SW1/4) OF THE SOUTHWEST QUARTER (SW1/4) AND ALL OF GOVERNMENT LOTS 1 AND 2 OF SECTION 28, ALL OF GOVERNMENT LOTS 10, 11, 13, 15 AND 17 OF SECTION 30, ALL OF SECTION 31, THE SOUTH HALF (S1/2), THE SOUTH HALF (S1/2) OF THE NORTHWEST QUARTER (NW1/4), THE SOUTHWEST QUARTER (SW1/4) OF THE NORTHEAST QUARTER (NE1/4) AND ALL OF GOVERNMENT LOTS 1, 2, 3, 4, 5, 7, 8, 10, 11, 12 AND 13 OF SECTION 32, ALL OF GOVERNMENT LOTS 2, 3, 4, 5, 6, 7, 8, 9, 10, 12, 14 AND 16 OF SECTION 33, TOWNSHIP

13 SOUTH, RANGE 70 EAST, MOUNT DIABLO BASE AND MERIDIAN AS SHOWN ON THE BUREAU OF LAND MANAGEMENT OFFICIAL SUPPLEMENTAL PLATS OF THE RESPECTIVE SECTIONS APPROVED JULY 31, 2001.

CONTAINS 8,685.06 ACRES

TOGETHER WITH:

ALL OF GOVERNMENT LOTS 2, 4, 5, 6, 7, 8, 10, 11, 13 AND 14 OF SECTION 25, ALL OF SECTION 36, TOWNSHIP 13 SOUTH, RANGE 69 EAST, MOUNT DIABLO BASE AND MERIDIAN AS SHOWN ON THE BUREAU OF LAND MANAGEMENT OFFICIAL PLATS OF THE INDEPENDENT RESURVEY APPROVED MAY 31, 2001.

CONTAINS 803.77 ACRES

TOGETHER WITH:

THE NORTHERLY ONE (1.0) MILE OF THE EASTERLY ONE (1.0) MILE OF TOWNSHIP 14 SOUTH, RANGE 69 EAST, MOUNT DIABLO BASE AND MERIDIAN THAT WAS SURVEYED BY W.H. MYRICK IN 1881 AND SUSPENDED BY THE BUREAU OF LAND MANAGEMENT, STATE DIRECTOR OF NEVADA ON APRIL 7, 2000.

CONTAINS 640 ACRES

TOGETHER WITH THE NORTHERLY ONE-HALF (N1/2) MILE OF THE WESTERLY ONE (1.0) MILE OF TOWNSHIP 14 SOUTH, RANGE 69 EAST, MOUNT DIABLO BASE AND MERIDIAN AS SURVEYED BY W.H. MYRICK IN 1881 AND SUSPENDED BY THE BUREAU OF LAND MANAGEMENT STATE DIRECTOR OF NEVADA ON APRIL 7, 2002.

CONTAINS 320 ACRES

THE MESQUITE CITY CORPORATE LIMITS CONTAINS 7365.09 ACRES, 11,508 SQUARE MILES ANNEXATION BY MESQUITE CITY COUNCIL No. 105 CONTAINS 516.45 ACRES, 0.80 SQUARE MILES 2003 ANNEXATION CONTAINS 12,599.77 ACRES, 19.69 SQUARE MILES 2008 ANNEXATION CONTAINS 52.76 ACRES, 0.08 SQUARE MILES 2010 ANNEXATION PHASE 1 CONTAINS 2598 ACRES, 4.06 SQUARE MILES 2010 ANNEXATION PHASE 2 CONTAINS 2,802 ACRES, 4.38 SQUARE MILES THE CITY OF MESQUITE CORPORATE LIMITS CONTAIN 40.52 SQUARE MILES (2010)

LEGAL DESCRIPTION CITY OF MESQUITE 2008 ANNEXATION

ALL OF GOVERNMENT LOT 1 LOCATED IN THE NORTHWEST QUARTER OF THE NORTHWEST QUARTER OF SUSPENDED SECTION 7, TOWNSHIP 14 SOUTH, RANGE 70 EAST, MOUNT DIABLO BASE AND MERIDIAN, CLARK COUNTY, NEVADA AND BEING MORE PARTICULARLY DESCRIBED AS:

BEGINNING AT THE NORTHWEST CORNER OF SECTION 7, TOWNSHIP 14 SOUTH, RANGE 70 EAST, MOUNT DIABLO BASE AND MERIDIAN, SAID NORTHWEST CORNER BEING S00°58'17"W 5,282.71 FEET FROM THE BLM BRASS CAP MONUMENT AT THE SOUTHWEST CORNER OF SECTION 31, TOWNSHIP 13 SOUTH, RANGE 70 EAST AS RECORDED ON THE RECORD OF SURVEY FOR JERRY WATERS IN FILE 46, PAGE 18 OF SURVEYS IN THE OFFICIAL RECORDS OF CLARK COUNTY, NEVADA AND RUNNING;

THENCE N89°08'43"E 1,329.19 FEET ALONG THE NORTH LINE OF SAID GOVERNMENT LOT 1;
 THENCE S00°56'49"W 1,320.61 FEET ALONG THE EAST LINE OF SAID GOVERNMENT LOT 1;
 THENCE S89°08'35"W 1,329.76 FEET ALONG THE SOUTH LINE OF SAID GOVERNMENT LOT 1;
 THENCE N00°58'16"E 1,320.68 FEET ALONG THE EAST LINE OF SAID GOVERNMENT LOT 1 TO THE POINT OF BEGINNING.

TOGETHER WITH:

LOCATED IN THE NORTHEAST QUARTER OF SUSPENDED SECTION 12, TOWNSHIP 14 SOUTH, RANGE 69 EAST, MOUNT DIABLO BASE AND MERIDIAN, CLARK COUNTY, NEVADA AND BEING MORE PARTICULARLY DESCRIBED AS:

BEGINNING AT THE NORTHEAST CORNER OF SECTION 12, TOWNSHIP 14 SOUTH, RANGE 69 EAST, MOUNT DIABLO BASE AND MERIDIAN, SAID NORTHEAST CORNER BEING S00°58'17"W 5,282.71 FEET FROM THE BLM BRASS CAP MONUMENT AT THE SOUTHWEST CORNER OF SECTION 31, TOWNSHIP 13 SOUTH, RANGE 70 EAST AS RECORDED ON THE RECORD OF SURVEY FOR JERRY WATERS IN FILE 46, PAGE 18 OF SURVEYS IN THE OFFICIAL RECORDS OF CLARK COUNTY, NEVADA AND RUNNING;

THENCE S00°58'16"W 1,320.68 FEET ALONG THE EAST LINE OF SAID SECTION 12;
 THENCE S89°58'47"W 46.42 FEET ALONG THE SOUTH LINE OF THE NORTHEAST QUARTER OF THE NORTHEAST QUARTER OF SAID SECTION 12 TO THE CENTER LINE OF STATE ROUTE 170 AS DESCRIBED IN THE JUDGMENT AND FINAL ORDER OF CONDEMNATION RECORDED MARCH 13, 2008 AS INSTRUMENT NUMBER 20080313:0000090;
 THENCE N30°09'29"W 362.27 FEET ALONG THE CENTER LINE OF SAID STATE ROUTE 170;
 THENCE NORTHWESTERLY 291.79 FEET ALONG THE ARC OF 1,190.00 FOOT RADIUS CURVE TO THE RIGHT WITH A CENTRAL ANGLE OF 14°02'57" AND CENTER BEARS N59°50'31"E, ALONG THE CENTER LINE OF SAID STATE ROUTE 170;
 THENCE NORTHWESTERLY 689.66 FEET ALONG THE ARC OF 1,190.00 FOOT RADIUS CURVE TO THE LEFT WITH A CENTRAL ANGLE OF 33°12'20" AND CENTER BEARS S73°53'28"W, ALONG THE CENTER LINE OF SAID STATE ROUTE 170;
 THENCE N49°18'52"W 233.02 FEET ALONG THE CENTER LINE OF SAID STATE ROUTE 170 TO THE NORTH LINE OF SAID SECTION 12;
 THENCE N88°58'18"E 909.51 FEET ALONG THE NORTH LINE OF SAID SECTION 12 TO THE POINT OF BEGINNING.

CONTAINS 52.76 ACRES

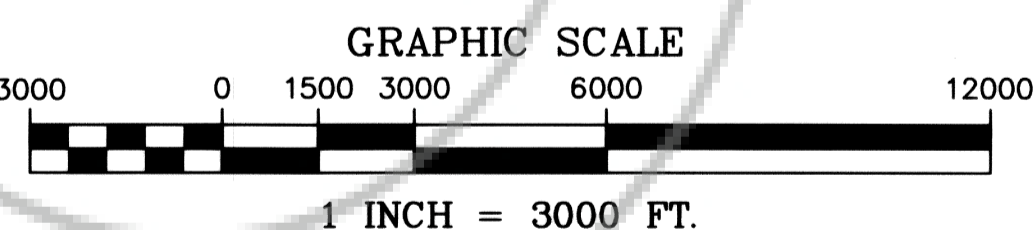

RECORDER'S STATEMENT

ANY SUBSEQUENT CHANGES TO THIS MAP SHOULD BE EXAMINED AND MAY BE DETERMINED BY REFERENCE TO THE COUNTY RECORDERS CUMULATIVE MAP INDEX. NRS 278.5695.

CERTIFICATION BY THE CITY OF MESQUITE

THIS IS TO CERTIFY THAT THIS AMENDED OFFICIAL MAP OF THE CITY OF MESQUITE CORPORATE LIMITS, CLARK COUNTY, NEVADA, PREPARED UNDER MY SUPERVISION CORRECTLY DELINEATES THE BOUNDARY OF THE CITY OF MESQUITE. THE CITY OF MESQUITE 2010 ANNEXATION, ORDINANCE NUMBER No. 440 ADOPTED BY THE CITY COUNCIL AT THE REGULAR MEETING ON JANUARY 11, 2011. THIS ANNEXATION BECAME EFFECTIVE ON FEBRUARY 10, 2011.

Kent B. Anderson
 KENT B. ANDERSON, P.E.
 CITY ENGINEER
 CITY OF MESQUITE
 NEVADA LICENSE No. 6991
 EXPIRATION DATE: DECEMBER 31, 2012

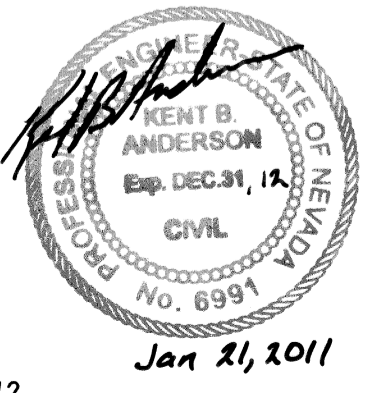

Jan 21, 2011

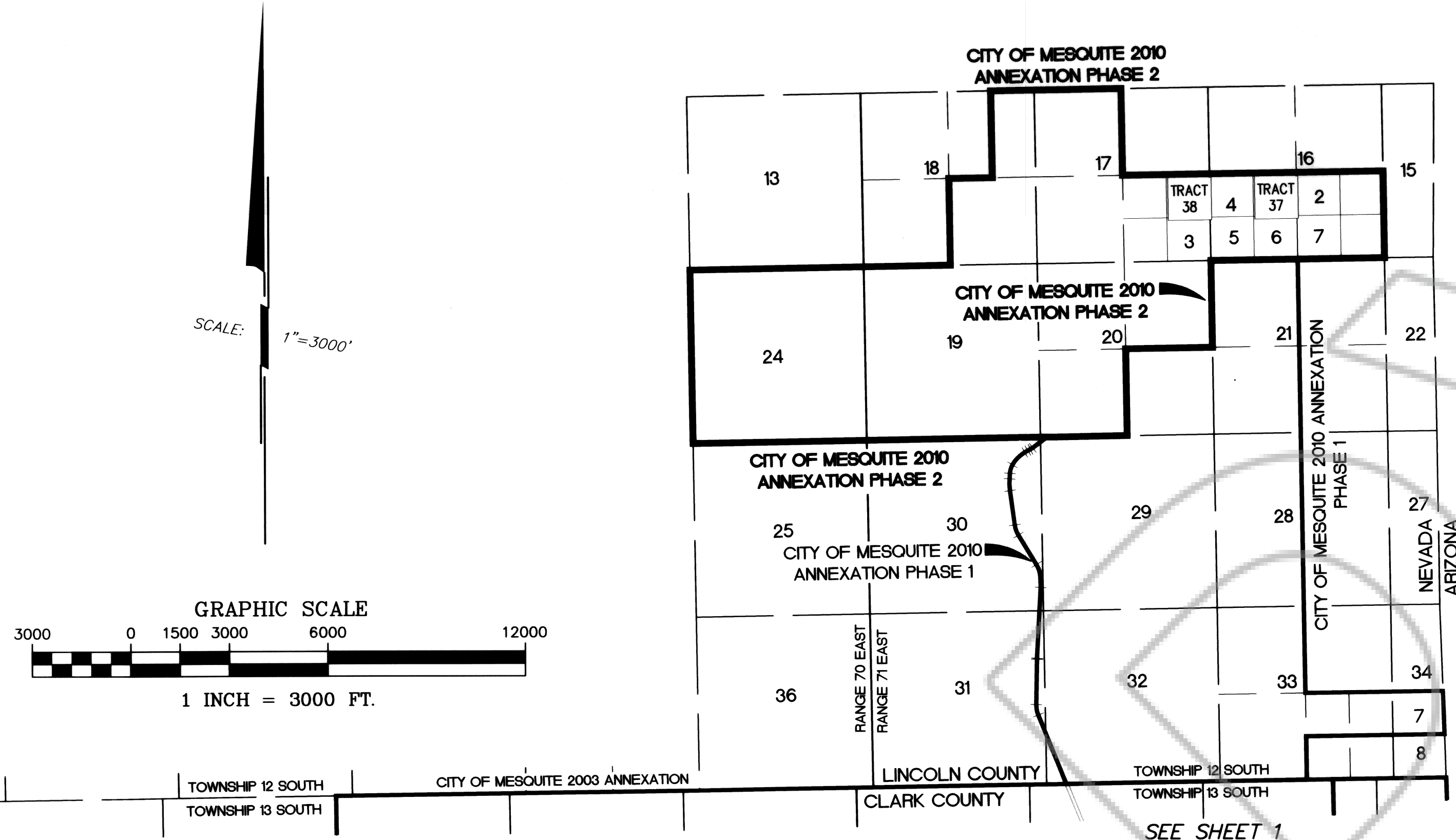

LEGAL DESCRIPTION CITY OF MESQUITE 2010 ANNEXATION PHASE 1

PORTIONS OF SECTIONS 20, 21, 28, 29, 30, 31, 32, 33 AND 34 OF TOWNSHIP 12 SOUTH, RANGE 71 EAST, M.D.M., LINCOLN COUNTY, NEVADA, DESCRIBED AS FOLLOWS:

COMMENCING AT MILE POST 311 ON THE NEVADA-ARIZONA STATE LINE, AS SHOWN IN THE PLAT BY THE BUREAU OF LAND MANAGEMENT (BLM) INDEPENDENT RESURVEY OF TOWNSHIP 12 SOUTH, RANGE 71 EAST, ACCEPTED ON JULY 24, 2001;

THENCE ALONG SAID STATE LINE NORTH 01°08'00" WEST A DISTANCE OF 116.09 FEET TO THE SOUTHEAST CORNER OF GOVERNMENT LOT 8 OF SAID SECTION 34;

THENCE DEPARTING SAID STATE LINE, ALONG THE SOUTH LINE OF SAID LOT 8, NORTH 89°57'30" WEST A DISTANCE OF 1,598.39 FEET TO THE SOUTHEAST CORNER OF THE SOUTHEAST QUARTER (SE 1/4) OF SAID SECTION 33;

THENCE DEPARTING SAID SOUTH LINE OF LOT 8, ALONG THE SOUTH LINE OF SAID SE 1/4 OF SECTION 33 NORTH 89°54'50" WEST A DISTANCE OF 2,639.08 FEET TO THE SOUTHEAST CORNER OF THE SOUTHWEST QUARTER (SW 1/4) OF SAID SECTION 33, SAID CORNER BEING THE POINT OF BEGINNING;

THENCE DEPARTING SAID SOUTH LINE OF THE SE 1/4 OF SECTION 33, ALONG SAID SOUTH LINE OF THE SW 1/4 OF SECTION 33, NORTH 90°00'00" WEST A DISTANCE OF 2,640.00 FEET TO THE SOUTHEAST CORNER OF SAID SECTION 32;

THENCE DEPARTING SAID SOUTH LINE OF THE SW 1/4 OF SECTION 33, ALONG SAID SOUTH LINE OF THE SE 1/4 OF SECTION 32 SOUTH 90°00'00" WEST A DISTANCE OF 2,640.00 FEET TO THE SOUTHEAST CORNER OF THE SW 1/4 OF SAID SECTION 32;

THENCE DEPARTING SAID SOUTH LINE OF THE SE 1/4 OF SECTION 32, ALONG SAID SOUTH LINE OF THE SW 1/4 OF SECTION 32 NORTH 89°56'30" WEST A DISTANCE OF 2,041.12 FEET TO THE CENTERLINE OF THE 60.00 FEET WIDE BLM GRANT N-57508 AS SHOWN IN SAID BLM PLAT;

THENCE DEPARTING SAID SOUTH LINE OF THE SE 1/4 OF SECTION 32 AND ALONG SAID CENTERLINE THE FOLLOWING NINETEEN (19) COURSES;

ONE (1), NORTH 21°09'40" WEST A DISTANCE OF 2,263.60 FEET TO THE BEGINNING OF A CURVE TO THE RIGHT HAVING A RADIUS OF 800.00 FEET;

TWO (2), NORTHERLY ALONG SAID CURVE A DISTANCE OF 321.72 FEET THROUGH A CENTRAL ANGLE OF 23°02'30";

THREE (3), NORTH 01°52'50" EAST A DISTANCE OF 1,382.24 FEET TO THE BEGINNING OF A CURVE TO THE RIGHT HAVING A RADIUS OF 800.00 FEET;

FOUR (4), NORTHERLY ALONG SAID CURVE A DISTANCE OF 29.63 FEET THROUGH A CENTRAL ANGLE OF 02°07'20";

FIVE (5), NORTH 04°00'10" EAST A DISTANCE OF 2,159.78 FEET TO THE BEGINNING OF A CURVE TO THE LEFT HAVING A RADIUS OF 800.00 FEET;

SIX (6), NORTHERLY ALONG SAID CURVE A DISTANCE OF 78.42 FEET THROUGH A CENTRAL ANGLE OF 05°37'00";

SEVEN (7), NORTH 01°36'50" WEST A DISTANCE OF 239.05 FEET TO THE BEGINNING OF A CURVE TO THE LEFT HAVING A RADIUS OF 800.00 FEET;

EIGHT (8), NORTHERLY ALONG SAID CURVE A DISTANCE OF 403.40 FEET THROUGH A CENTRAL ANGLE OF 28°53'30";

NINE (9), NORTH 30°30'20" WEST A DISTANCE OF 1,049.00 FEET TO THE BEGINNING OF A CURVE TO THE RIGHT HAVING A RADIUS OF 800.00 FEET;

TEN (10), NORTHERLY ALONG SAID CURVE A DISTANCE OF 329.71 FEET THROUGH A CENTRAL ANGLE OF 23°36'50";

ELEVEN (11), NORTH 08°53'30" WEST A DISTANCE OF 1,053.29 FEET TO THE BEGINNING OF A CURVE TO THE RIGHT HAVING A RADIUS OF 1,817.13 FEET;

TWELVE (12), NORTHERLY ALONG SAID CURVE A DISTANCE OF 360.40 FEET THROUGH A CENTRAL ANGLE OF 11°21'50";

THIRTEEN (13), NORTH 04°28'20" EAST A DISTANCE OF 168.30 FEET TO THE BEGINNING OF A NON-TANGENT CURVE TO THE RIGHT HAVING A RADIUS OF 600.09 FEET, OF WHICH THE RADIUS POINT LIES SOUTH 84°42'30" EAST;

FOURTEEN (14), NORTHERLY ALONG SAID CURVE A DISTANCE OF 270.31 FEET, THROUGH A CENTRAL ANGLE OF 25°48'30", TO THE BEGINNING OF A COMPOUND CURVE TO THE RIGHT HAVING A RADIUS OF 1,050.00 FEET;

FIFTEEN (15), NORTHEASTERLY ALONG SAID CURVE A DISTANCE OF 538.32 FEET, THROUGH A CENTRAL ANGLE OF 29°22'30";

SIXTEEN (16), NORTH 60°28'30" EAST A DISTANCE OF 107.51 FEET TO THE BEGINNING OF A CURVE TO THE RIGHT HAVING A RADIUS OF 836.81 FEET;

SEVENTEEN (17), NORTHEASTERLY ALONG SAID CURVE A DISTANCE OF 86.49 FEET THROUGH A CENTRAL ANGLE OF 05°55'20" TO THE BEGINNING OF A REVERSE CURVE TO THE LEFT HAVING A RADIUS OF 394.85 FEET;

EIGHTEEN (18), NORTHEASTERLY ALONG SAID CURVE A DISTANCE OF 86.24 FEET THROUGH A CENTRAL ANGLE OF 12°30'50";

NINETEEN (19), NORTH 53°53'00" EAST A DISTANCE OF 543.72 FEET TO THE SOUTH LINE OF SAID SECTION 20;

THENCE DEPARTING SAID CENTERLINE, ALONG SAID SOUTH LINE OF SECTION 20, SOUTH 89°58'15" EAST A DISTANCE OF 2,440.55 FEET TO THE SOUTHWEST CORNER OF THE SE 1/4 OF SAID SECTION 20;

THENCE DEPARTING SAID SOUTH LINE OF SECTION 20, ALONG THE WEST LINE OF SAID SE 1/4 OF SECTION 20, NORTH 00°01'00" EAST A DISTANCE OF 2,640.00 FEET TO THE NORTHWEST CORNER OF SAID SE 1/4 OF SECTION 20;

THENCE DEPARTING SAID WEST LINE OF THE SE 1/4, ALONG THE NORTH LINE OF SAID SE 1/4, SOUTH 89°58'15" EAST A DISTANCE OF 2,641.68 FEET TO THE WEST LINE OF SAID SECTION 21;

THENCE DEPARTING SAID NORTH LINE OF THE SE 1/4 OF SECTION 20, ALONG SAID WEST LINE OF SAID SECTION 21, NORTH 00°01'20" EAST A DISTANCE OF 2,640.00 FEET TO THE NORTHWEST CORNER OF SAID SECTION 21;

THENCE DEPARTING SAID WEST LINE, ALONG THE NORTH LINE OF SECTION 21, SOUTH 89°57'25" EAST A DISTANCE OF 2,641.07 FEET TO THE NORTHEAST CORNER OF THE WEST HALF (W 1/2) OF SAID SECTION 21;

THENCE DEPARTING SAID NORTH LINE OF SECTION 21, ALONG THE EAST LINE OF SAID W 1/2, SOUTH 00°01'40" WEST A DISTANCE OF 5,280.00 FEET TO THE NORTHEAST CORNER OF THE W 1/2 OF SAID SECTION 28;

THENCE DEPARTING SAID EAST LINE OF THE W 1/2 OF SECTION 21, ALONG THE EAST LINE OF THE W 1/2 OF SECTION 28, SOUTH 00°01'40" WEST A DISTANCE OF 5,280.00 FEET TO THE NORTHEAST CORNER OF THE NW 1/4 OF SAID SECTION 33;

THENCE DEPARTING SAID EAST LINE OF THE W 1/2 OF SECTION 28, ALONG THE EAST LINE OF SAID NW 1/4 OF SECTION 33, SOUTH 00°01'22" WEST A DISTANCE OF 2,640.00 FEET TO THE NORTH LINE OF THE NORTH HALF (N 1/2) OF SAID SE 1/4 OF SECTION 33;

THENCE DEPARTING SAID EAST LINE OF THE NW 1/4 OF SECTION 33, ALONG SAID NORTH LINE OF SAID N 1/2 OF THE SE 1/4, SOUTH 89°57'25" EAST A DISTANCE OF 2,639.56 FEET TO THE NORTHWEST CORNER OF GOVERNMENT LOT 7 OF SAID SECTION 34;

THENCE DEPARTING SAID NORTH LINE OF SAID N 1/2 OF THE SE 1/4, ALONG THE NORTH LINE OF SAID LOT 7, SOUTH 89°58'37" EAST A DISTANCE OF 1,544.61 FEET TO THE NORTHEAST CORNER OF SAID LOT 7;

THENCE DEPARTING SAID NORTH LINE OF LOT 7, ALONG THE EAST LINE OF SAID LOT 7, SOUTH 01°08'00" EAST A DISTANCE OF 1,320.53 FEET TO THE SOUTHEAST CORNER OF SAID LOT 7;

THENCE DEPARTING SAID EAST LINE OF LOT 7, ALONG THE SOUTH LINE OF SAID LOT 7, NORTH 89°58'03" WEST A DISTANCE OF 1,571.50 FEET TO THE SOUTHEAST CORNER OF SAID N 1/2 OF THE SE 1/4 OF SECTION 33;

THENCE DEPARTING SAID SOUTH LINE OF LOT 7, ALONG THE SOUTH LINE OF SAID N 1/2 OF THE SE 1/4 OF SECTION 33, NORTH 89°56'08" WEST A DISTANCE OF 2,639.32 FEET TO THE EAST LINE OF SAID SW 1/4 OF SECTION 33;

THENCE DEPARTING SAID SOUTH LINE OF SAID N 1/2, ALONG SAID EAST LINE OF THE SW 1/4 OF SECTION 33, SOUTH 00°01'22" WEST A DISTANCE OF 1,319.01 FEET TO THE POINT OF BEGINNING, CONTAINING 2,598 ACRES, MORE OR LESS.

BASIS OF BEARINGS
PLATS OF THE BLM IN DEPENDANT RESURVEYS OF TOWNSHIP 12 SOUTH, RANGE 70 AND 71 EAST ACCEPTED ON JULY 24, 2001.

LEGAL DESCRIPTION CITY OF MESQUITE 2010 ANNEXATION PHASE 2

SECTION 24 OF TOWNSHIP 12 SOUTH, RANGE 70 EAST, SECTIONS 19 AND PORTIONS OF SECTIONS 16, 17, 18, AND 20 OF TOWNSHIP 12 SOUTH, RANGE 71 EAST, M.D.M. LINCOLN COUNTY/ NEVADA, DESCRIBED AS FOLLOWS:

BEGINNING AT THE POINT OF INTERSECTION OF THE SOUTH LINE OF SAID SECTION 20 AND THE CENTERLINE OF THE 60.00 FEET WIDE BUREAU OF LAND MANAGEMENT (BLM) ROADWAY GRANT N-57508 AS SHOWN IN THE PLAT OF THE BLM INDEPENDENT RESURVEY OF T. 12 S., R. 71 E., ACCEPTED ON JULY 24, 2001;

THENCE DEPARTING SAID CENTERLINE, ALONG SAID SOUTH LINE OF SECTION 20, NORTH 89°58'15" WEST A DISTANCE OF 200.87 FEET TO THE SOUTHEAST CORNER OF SAID SECTION 19;

THENCE DEPARTING SAID SOUTH LINE OF SECTION 20, ALONG SAID SOUTH LINE OF SAID SECTION 19, NORTH 90°00'00" WEST A DISTANCE OF 5,282.05 FEET TO THE SOUTHWEST CORNER OF SAID SECTION 24 OF TOWNSHIP 12 SOUTH, RANGE 70 EAST;

THENCE DEPARTING SAID SOUTH LINE OF SECTION 19, ALONG THE SOUTH LINE OF SAID SECTION 24, SOUTH 90°00'00" WEST A DISTANCE OF 5,282.05 FEET TO THE SOUTHWEST CORNER OF SAID SECTION 24;

THENCE DEPARTING SAID SOUTH LINE OF SECTION 24, ALONG THE WEST LINE OF SAID SECTION 24, NORTH 00°00'00" WEST A DISTANCE OF 5,280.00 FEET TO THE NORTHWEST CORNER OF SAID SECTION 24;

THENCE DEPARTING SAID WEST LINE OF SECTION 24, ALONG THE NORTH LINE OF SAID SECTION 24, NORTH 90°00'00" EAST A DISTANCE OF 5,283.07 FEET TO THE NORTHWEST CORNER OF SAID SECTION 19;

THENCE DEPARTING SAID NORTH LINE OF SECTION 19, ALONG THE WEST LINE OF SAID SE 1/4 OF SECTION 18, NORTH 00°00'20" EAST A DISTANCE OF 2,640.00 FEET TO THE NORTHWEST CORNER OF SAID SE 1/4;

THENCE DEPARTING SAID WEST LINE OF SAID SE 1/4 OF SECTION 18, ALONG THE NORTH LINE OF SAID SE 1/4 OF SECTION 18, SOUTH 90°00'00" EAST A DISTANCE OF 1,320.90 FEET TO THE SOUTHWEST CORNER OF THE EAST HALF (E 1/2) OF THE NORTHEAST QUARTER (NE 1/4) OF SAID SECTION 18;

THENCE DEPARTING THE NORTH LINE OF SAID SE 1/4 OF SECTION 18, ALONG THE WEST LINE OF SAID E 1/2, NORTH 00°00'30" EAST A DISTANCE OF 2,640.00 FEET TO THE NORTH LINE OF SAID SECTION 18;

THENCE DEPARTING SAID WEST LINE OF THE E 1/2 ALONG SAID NORTH LINE OF SECTION 18, SOUTH 90°00'00" EAST A DISTANCE OF 1,321.02 FEET TO THE NORTHWEST CORNER OF SAID SECTION 17;

THENCE DEPARTING THE NORTH LINE OF SAID SECTION 18, ALONG THE NORTH LINE OF SAID SECTION 17, SOUTH 89°58'15" EAST A DISTANCE OF 2,642.44 FEET TO THE NORTHEAST CORNER OF THE NORTHWEST QUARTER (NW 1/4) OF SAID SECTION 17;

THENCE DEPARTING SAID NORTH LINE OF SECTION 17, ALONG THE EAST LINE OF SAID NW 1/4 OF SECTION 17, SOUTH 00°01'00" WEST A DISTANCE OF 2,640.00 FEET TO THE NORTHWEST CORNER OF THE SE 1/4 OF SAID SECTION 17;

THENCE DEPARTING SAID EAST LINE OF THE NW 1/4 OF SECTION 17, ALONG THE NORTH LINE OF SAID SE 1/4 OF SECTION 17, SOUTH 89°58'15" EAST A DISTANCE OF 2,642.19 FEET TO THE NORTHWEST CORNER OF GOVERNMENT LOT 4 OF SAID SECTION 16;

THENCE DEPARTING SAID NORTH LINE OF THE SE 1/4 OF SECTION 17, ALONG THE NORTH LINE OF SAID LOT 4 AND GOVERNMENT LOT 3 OF SAID SECTION 16, SOUTH 89°57'25" EAST A DISTANCE OF 2,641.33 FEET TO THE NORTHWEST CORNER OF GOVERNMENT LOT 2 OF SAID SECTION 16;

THENCE DEPARTING SAID NORTH LINE OF LOT 3, ALONG THE NORTH LINE OF SAID LOT 2 AND THE NE 1/4 OF THE SE 1/4 OF SAID SECTION 16, SOUTH 89°57'25" EAST A DISTANCE OF 2,641.33 FEET TO THE EAST LINE OF SAID SECTION 16;

THENCE DEPARTING SAID NORTH LINE OF THE NE 1/4 OF THE SE 1/4 OF SAID SECTION 16, ALONG SAID EAST LINE OF SECTION 16, SOUTH 00°02'00" WEST A DISTANCE OF 2,640.00 FEET TO THE SOUTHEAST CORNER OF SAID SECTION 16;

THENCE DEPARTING SAID EAST LINE OF SECTION 16, ALONG THE SOUTH LINE OF SAID SECTION 16, NORTH 89°57'25" WEST A DISTANCE OF 5,282.15 FEET TO THE NORTHEAST CORNER OF THE NE 1/4 OF SAID SECTION 20;

BASIS OF BEARINGS:
PLATS OF THE BLM IN DEPENDANT RESURVEYS OF TOWNSHIP 12 SOUTH, RANGE 70 AND 71 EAST ACCEPTED ON JULY 24, 2001.

CONTAINING 2,802 ACRES, MORE OR LESS.