

Official Record

Recording requested By  
COW COUNTY TITLE

Lincoln County - NV  
Leslie Boucher - Recorder

Fee: \$15.00 Page 1 of 2  
RPTT: Recorded By: LB  
Book- 258 Page- 0550

A.P.N. #	002-113-17
R.P.T.T.	-0- Exempt # 5
Escrow No.	40124
Recording Requested By:	
	40124
Mail Tax Statements To:	
Same as Below	
When Recorded Mail To:	
Cow County Title Co	
P O Box 610	
Hawthorne, NV 89415	



0136511

QUITCLAIM DEED

FOR VALUABLE CONSIDERATION, receipt of which is hereby acknowledged, CHRISTINE PATRICK, an unmarried woman hereby does REMISE, RELEASE AND FOREVER QUITCLAIM to CHRISTINE PATRICK, an unmarried woman and QUENTIN GILPATRICK and VICTORIA GILPATRICK, husband and wife, as joint tenants, all as joint tenants with rights of survivorship the following described real property situated in the County of Lincoln, State of Nevada:

See Exhibit "A" attached hereto and by reference made a part hereof for complete legal description.

Dated: September 23, 2010

*Christine Patrick*  
CHRISTINE PATRICK

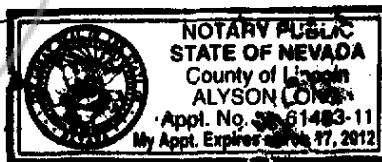

State of Nevada

County of Lincoln } ss

This instrument was acknowledged before me on 9-24, 2010  
by: CHRISTINE PATRICK

Signature: *Alyson Long*  
Notary Public



**Exhibit A**

**File Number: 40124**

**All that certain real property situate in the County of Lincoln, State of Nevada, described as follows:**

**That portion of Lot 2 in Block 16 of the Town of Panaca, lying within Sections 8 and 9, Township 2 South, Range 68 East, M.D.B.& M., more particularly described as follows:**

**Parcel 2 of that certain parcel map for Quentin F. and Victoria A. Gilpartick recorded October 31, 2007 in the Office of the County Recorder of Lincoln County, Nevada in Book C of Plats, page 362 as File No. 130137, Lincoln County, Nevada records.**

**ASSESSOR'S PARCEL NUMBER FOR 2010 – 2011: 002-113-17**

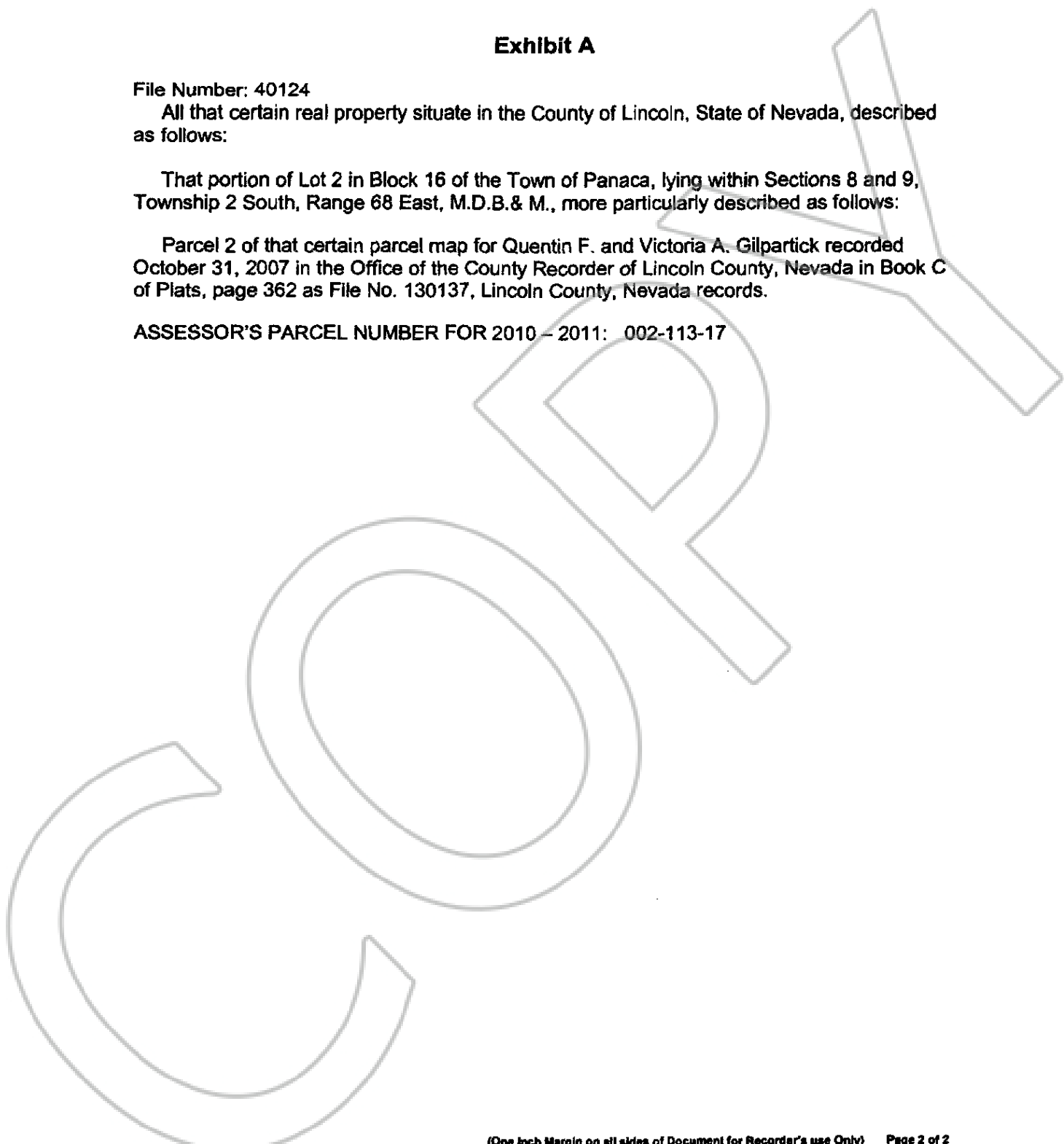



**STATE OF NEVADA  
DECLARATION OF VALUE**

**1. Assessor Parcel Number(s)**

- a) 002-113-17
- b) \_\_\_\_\_
- c) \_\_\_\_\_
- d) \_\_\_\_\_

FOR RECORDER'S OPTIONAL USE ONLY	
Document/Instrument No.	_____
Book	_____ Page _____
Date of Recording:	_____
Notes:	_____

**2. Type of Property**

- a)  Vacant Land
- b)  Single Family Residence
- c)  Condo/Twnhse
- d)  2-4 Plex
- e)  Apartment Bldg.
- f)  Commercial/Industrial
- g)  Agricultural
- h)  Mobile Home
- i)  Other \_\_\_\_\_

**3. Total Value/Sales Price of Property**

Deed in Lieu of Foreclosure Only (Value of Property) ( \_\_\_\_\_ )

Transfer Tax Value \_\_\_\_\_

Real Property Transfer Tax Due: \_\_\_\_\_ -0-

**4. If Exemption Claimed:**

- a. Transfer Tax Exemption, per NRS 375.090, Section: #5
  - b. Explain Reason for Exemption: Daughter adding parents to title
5. Partial Interest: Percentage being transferred: 100 %

The undersigned declares and acknowledges, under penalty of perjury, pursuant to NRS 375.060 and NRS 375.110 that the information provided is correct to the best of their information and belief, and can be supported by documentation if called upon to substantiate the information provided herein. Furthermore, the disallowance of any claimed exemption or other determination of additional tax due, may result in a penalty of 10% of the tax due plus interest at 1% per month. Pursuant to NRS 375.030, the Buyer and Seller shall be jointly and severally liable for any additional amount owed.

Signature: *Christine Patrick* Capacity: Seller/Grantor

Signature: *Victoria Gilpatrick* Capacity: Buyer/Grantee

**SELLER (GRANTOR) INFORMATION**

Print Name: CHRISTINE PATRICK

Address: P O BOX 452

City/State/Zip , PANACA, NV 89042

**BUYER (GRANTEE) INFORMATION**

Print Name: VICTORIA GILPATRICK

Address: P O Box 452

City/State/Zip Panaca, NV 89042

**COMPANY/PERSON REQUESTING RECORDING (required if not the Seller or Buyer)**

Company Name: Cow County Title Co. Escrow No 40124

Address: P.O. Box 610  
904 E Street  
Hawthorne, Nevada 89415

Recording requested By  
COW COUNTY TITLE

Lincoln County - NV  
Leslie Boucher - Recorder

STATE OF NEVADA  
DECLARATION OF VALUE

1. Assessor Parcel Number(s)

- a) 002-113-17
- b) \_\_\_\_\_
- c) \_\_\_\_\_
- d) \_\_\_\_\_

<b>FOR RECORDER</b>	
Document/Instru	Page 1 of 2 Fee: \$15.00
Book	Recorded By: LB RPTT:
Date of Recording:	Book- 258 Page- 0550
Notes:	

2. Type of Property

- a)  Vacant Land
- b)  Single Family Residence
- c)  Condo/Twnhse
- d)  2-4 Plex
- e)  Apartment Bldg.
- f)  Commercial/Industrial
- g)  Agricultural
- h)  Mobile Home
- i)  Other \_\_\_\_\_

3. Total Value/Sales Price of Property

Deed in Lieu of Foreclosure Only (Value of Property) ( \_\_\_\_\_ )  
 Transfer Tax Value \_\_\_\_\_  
 Real Property Transfer Tax Due: \_\_\_\_\_

4. If Exemption Claimed:

- a. Transfer Tax Exemption, per NRS 375.090, Section: \_\_\_\_\_
- b. Explain Reason for Exemption: \_\_\_\_\_

5. Partial Interest: Percentage being transferred: 100 %

The undersigned declares and acknowledges, under penalty of perjury, pursuant to NRS 375.060 and NRS 375.110 that the information provided is correct to the best of their information and belief, and can be supported by documentation if called upon to substantiate the information provided herein. Furthermore, the disallowance of any claimed exemption or other determination of additional tax due, may result in a penalty of 10% of the tax due plus interest at 1% per month.

Pursuant to NRS 375.030, the Buyer and Seller shall be jointly and severally liable for any additional amount owed.

Signature: *Victoria Gilpatrick* Capacity: Seller/Grantor

Signature: *Christine Patrick* Capacity: Buyer/Grantee

**SELLER (GRANTOR) INFORMATION**

Print Name: VICTORIA GILPATRICK  
 Address: P O BOX 452  
 City/State/Zip PANACA, NV 89042,

**BUYER (GRANTEE) INFORMATION**

Print Name: CHRISTINE PATRICK  
 Address: P O Box 452  
 City/State/Zip Panaca, NV 89042

**COMPANY/PERSON REQUESTING RECORDING (required if not the Seller or Buyer)**

Company Name: Cow County Title Co. Escrow No 40124  
P.O. Box 610  
904 E Street  
 Address: Hawthorne, Nevada 89415