



Exhibit A

File Number: 39497

All that certain real property situate in the County of Lincoln, State of Nevada, described as follows:

Northwest one-quarter of the Southwest one-quarter of section 15, Township 5 North, Range 69 East, Mount Diablo Meridian.

ASSESSOR'S PARCEL NUMBER FOR 2010-2011: 05-161-06

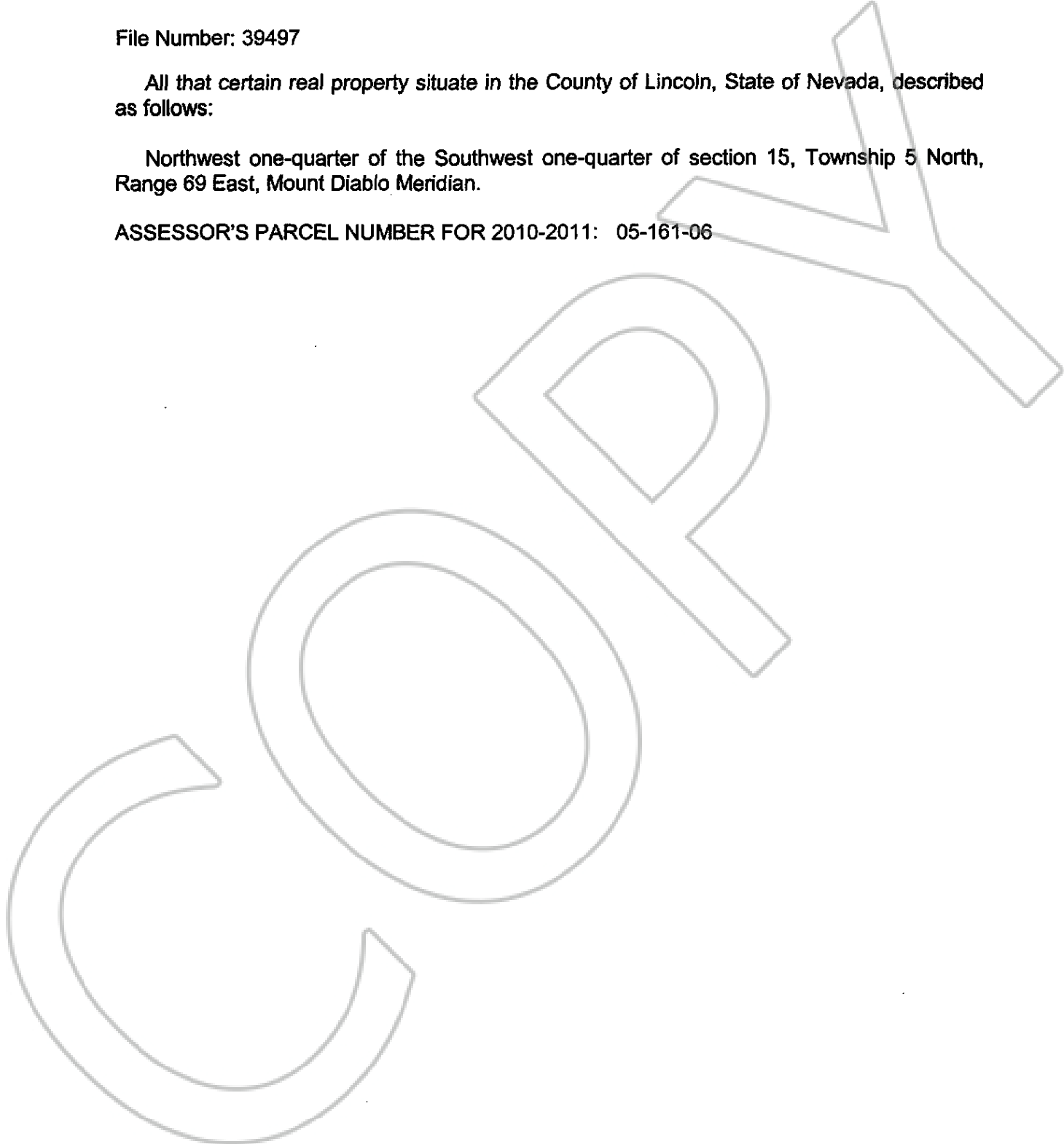

Recording requested By
COW COUNTY TITLE

STATE OF NEVADA
DECLARATION OF VALUE

Lincoln County - NV

Leslie Boucher - Recorder

1. Assessor Parcel Number(s)

- a) 05-161-06
- b) _____
- c) _____
- d) _____

FOR RECORDER'S USE	
Document/Instrument	_____
Book	_____
Date of Recording:	_____
Notes:	_____

Page 1 of 1 Fee: \$15.00
Recorded By: DP RPTT: \$487.50
Book- 257 Page- 0309

2. Type of Property

- a) Vacant Land
- b) Single Family Residence
- c) Condo/Twnhse
- d) 2-4 Plex
- e) Apartment Bldg.
- f) Commercial/Industrial
- g) Agricultural
- h) Mobile Home
- i) Other _____

3. Total Value/Sales Price of Property

Total Value/Sales Price of Property	\$125,000.00
Deed in Lieu of Foreclosure Only (Value of Property)	(_____)
Transfer Tax Value	\$125,000.00
Real Property Transfer Tax Due:	\$487.50

4. If Exemption Claimed:

- a. Transfer Tax Exemption, per NRS 375.090, Section: _____
- b. Explain Reason for Exemption: _____

5. Partial Interest: Percentage being transferred: 100 %

The undersigned declares and acknowledges, under penalty of perjury, pursuant to NRS 375.060 and NRS 375.110 that the information provided is correct to the best of their information and belief, and can be supported by documentation if called upon to substantiate the information provided herein. Furthermore, the disallowance of any claimed exemption or other determination of additional tax due, may result in a penalty of 10% of the tax due plus interest at 1% per month. Pursuant to NRS 375.030, the Buyer and Seller shall be jointly and severally liable for any additional amount owed.

Signature: _____ Capacity: Seller/Grantor

Signature: [Signature] Capacity: Buyer/Grantee

SELLER (GRANTOR) INFORMATION

BUYER (GRANTEE) INFORMATION

Print Name: WILD CREEK, LLC
Address: 1563 Betty Lane
City/State/Zip Las Vegas, NV 89110

Print Name: H. CRAIG CLOWARD
Address: 8805 S. 400 E.
City/State/Zip Salem, UT 84653

COMPANY/PERSON REQUESTING RECORDING (required if not the Seller or Buyer)

Company Name: Cow County Title Co. Escrow No 39497
P.O. Box 610
904 E Street
Address: Hawthorne, Nevada 89415