

QUIT CLAIM DEED

DOC # 0134946

12/04/2009

01:33 PM

Official Record

Recording requested By
KEITH E. LARSON

Lincoln County - NV
Leslie Boucher - Recorder

Fee: \$42.00 Page 1 of 4
RPT: \$5.85 Recorded By: AE
Book- 252 Page- 0498



THIS INDENTURE WITNESSETH: That

Charles W. Culverwell, Steven Culverwell,
Sandra Culverwell Webster, and Valerie Kay
Culverwell

receipt of which is acknowledged, do
hereby remise, release, and forever quitclaim to

Keith E. Larson

all that real property situate in
the county of Lincoln, State of Nevada, bounded
and described as follows:

A PORTION OF 003-178-01
See EXHIBIT A included herein

Together with all and singular the tenements, hereditaments and appurtenances thereon
belonging or in anywise appertaining.

Witness _____ hand _____ this _____ day of _____, 2008

Charles W. Culverwell
Charles W. Culverwell

Steven Culverwell
Steven Culverwell

Sandra Culverwell Webster

Valerie Kay Culverwell
Valerie Kay Culverwell

STATE OF NEVADA

STATE OF NEVADA

COUNTY OF LINCOLN }

COUNTY OF CLARK }

On 14th, January, 2009,

On _____, _____, 200 ,

Charles W. Culverwell, Steven Culverwell,
And Valerie Kay Culverwell personally
appeared before me, a Notary Public
and acknowledged that he
executed the above instrument.

Sandra Culverwell Webster personally
appeared before me, a Notary Public
acknowledged that he
executed the above instrument.

Signature Patrice Lytle
Notary Public

Signature _____
Notary Public

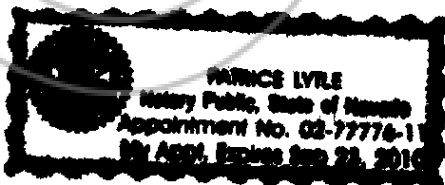



EXHIBIT A

DESCRIPTION

The result of a boundary line adjustment being added to the property a Record of Survey, Boundary Line Adjustment filed Plat Book C at Page 93-93A for Keith Larson, recorded at Lincoln County, Nevada Records, and located in the NE1/4 SW1/4 Section 8, T. 4 S., R. 67 E., M.D.M., and more fully described as follows:

Beginning at the southeast corner of said area of Boundary Line Adjustment from which the southwest corner of Section 8 bears S 41°12'27" W 2231.62';
Thence N 29°52'19" W 39.97' to a rebar with cap stamped L SMITH PLS 12751;
Thence N 60°08'17" E 104.39' to a rebar & cap stamped PLS 6204;
Thence S 29°51'43" E 39.97' to a rebar & plastic cap stamped PLS 12751;
Thence S 60°08'17" W 104.38' to the point of beginning.
Containing 4,172 square feet more or less.

The Basis of bearings is the south line of Section 7, T. 4 S., R. 67 E., M.D.M. as given in the B.L.M. Dependent Resurvey as N. 88°52'20" E.
End of Description

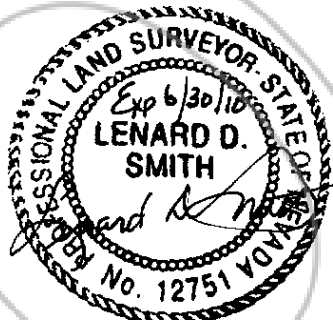

7/31/08



0134946

Book: 252
Page: 501

12/04/2009
Page 1 of 4

JURAT

State of Nevada

County of Lincoln

Subscribed and sworn/affirmed to before me this 19th day of May

20 09, by JAKIE KAY Culverwell

Jakie Kay Culverwell

Victoria Carter

Notary Public

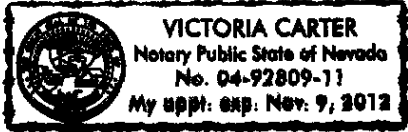

My Commission Expires: Nov 9, 2012

Attribution Clause: This Certificate is prepared for, and exclusively belongs to, the accompanying document entitled Quit Claim Deed, which consists of 2 page(s) and is dated January 14, 2009 ^{No Date on Document}

If this Certificate is appropriated to any document other than the one described herein, it shall be deemed null and void.

Copyright 2001 by the Notary Law Institute. Unauthorized reproduction of any kind of this form is strictly prohibited.

#04022

JURAT

State of Nevada

County of Lincoln

Subscribed and sworn/affirmed to before me this 2nd day of December

20 09, by Steve T Culverwell

Steve T Culverwell

Victoria Carter

Notary Public

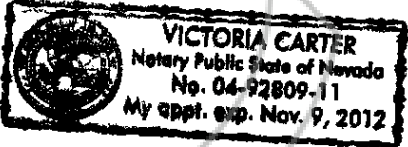

My Commission Expires: Nov 9, 2012

Attribution Clause: This Certificate is prepared for, and exclusively belongs to, the accompanying document entitled Quit Claim Deed, which consists of 2 page(s) and is dated December 2, 2009 ^{No Date on Document}

If this Certificate is appropriated to any document other than the one described herein, it shall be deemed null and void.

Copyright 2001 by the Notary Law Institute. Unauthorized reproduction of any kind of this form is strictly prohibited.

#04022

State of Nevada Declaration of Value

DOC # DV-134946
12/04/2009 01:33 PM
Official Record

Recording requested By
KEITH E. LARSON

Lincoln County - NV
Leslie Boucher - Recorder

Page 1 of 1 Fee: \$42.00
Recorded By: AE RPTT: \$5.85
Book- 252 Page- 0498

1. Assessor Parcel Number(s)

- a) PORTION OF 003-178-01
- b) _____
- c) _____
- d) _____

2. Type of Property

- a) Vacant Land
- b) Single Family Res.
- c) Condo/Townhouse
- d) 2-4 Plex
- e) Apartment Building
- f) Commercial /Ind'l
- g) Agriculture
- h) Mobile Home
- i) other _____

FOR RECORDERS OPTIONAL USE ONLY

Document / Instrument # _____
Book: _____ Page: _____
Date of Recording: _____
Notes: _____

3. Total Value / Sales Price of Property

\$ 1,500.00

Deed In Lieu Only (value of forgiven debt)

\$ _____

Taxable Value

\$ _____

Real Property Transfer Tax Due:

\$ 5.85

4. If Exemption Claimed:

- a. Transfer Tax Exemption, per NRS 375.090, section: _____
- b. Explain Reason for Exemption: _____

5. Partial Interest: Percentage being transferred: _____ %

The undersigned Seller (Grantor)/Buyer (Grantee), declares and acknowledges, under penalty of perjury, pursuant to NRS 375.060 and NRS 375.110, that the information provided is correct to the best of their information and belief, and can be supported by documentation if called upon to substantiate the information provided herein. Furthermore, the parties agree that disallowance of any claimed exemption, or other determination of additional tax due, may result in a penalty of 10% of the tax due plus interest at 1 1/2% per month. Pursuant to NRS 375.030, the Buyer and Seller shall be jointly and severally liable for any additional amount owed.

Signature Keith Larson Capacity AGENT FOR CHARLES W. CULVERWELL

Signature Keith Larson Capacity _____

SELLER (GRANTOR) INFORMATION

BUYER (GRANTEE) INFORMATION

Print Name CHARLES CULVERWELL

Print Name KEITH LARSON

Address _____

Address P.O. Box 742

City CALIENTE

City CALIENTE

State NEVADA Zip 89008

State NEVADA Zip 89008

COMPANY/PERSON REQUESTING RECORDING (REQUIRED IF NOT BUYER OR SELLER)

Co. Name _____ Esc. # _____

Address _____

City _____ State: _____ Zip _____

(As a public record, this form may be recorded / microfilmed)