

1" = 500'

MAP OF THE CROSS  
LODE CLAIMS

LINCOLN COUNTY, NV.

LOCATED APRIL 1, 2009

By KEN BROOK  
2305 PLEASURE DR  
RENO NV 89509

CLAIMS ARE IN THE  
NW & SW 1/4  
SECTION 13, T4N  
R63E MDBM.

ALL MONUMENTS ARE  
1/2" x 1/2" x 60" WOODEN  
MONUMENTS

DOC # 0133795

05/19/2009 04:27 PM

Official Record  
Recording requested by  
KEN BROOK

Lincoln County - NV  
Leslie Boucher - Recorder

Fee: \$124.00 Page 1 of 1  
RPTT: Recorded By: AE  
Book- 248 Page- 0503



0133795

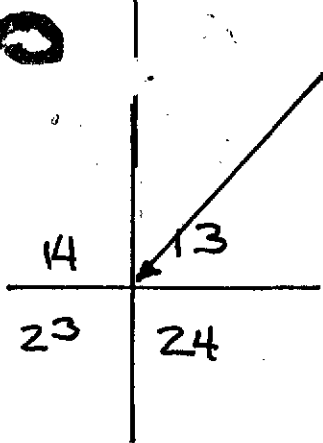
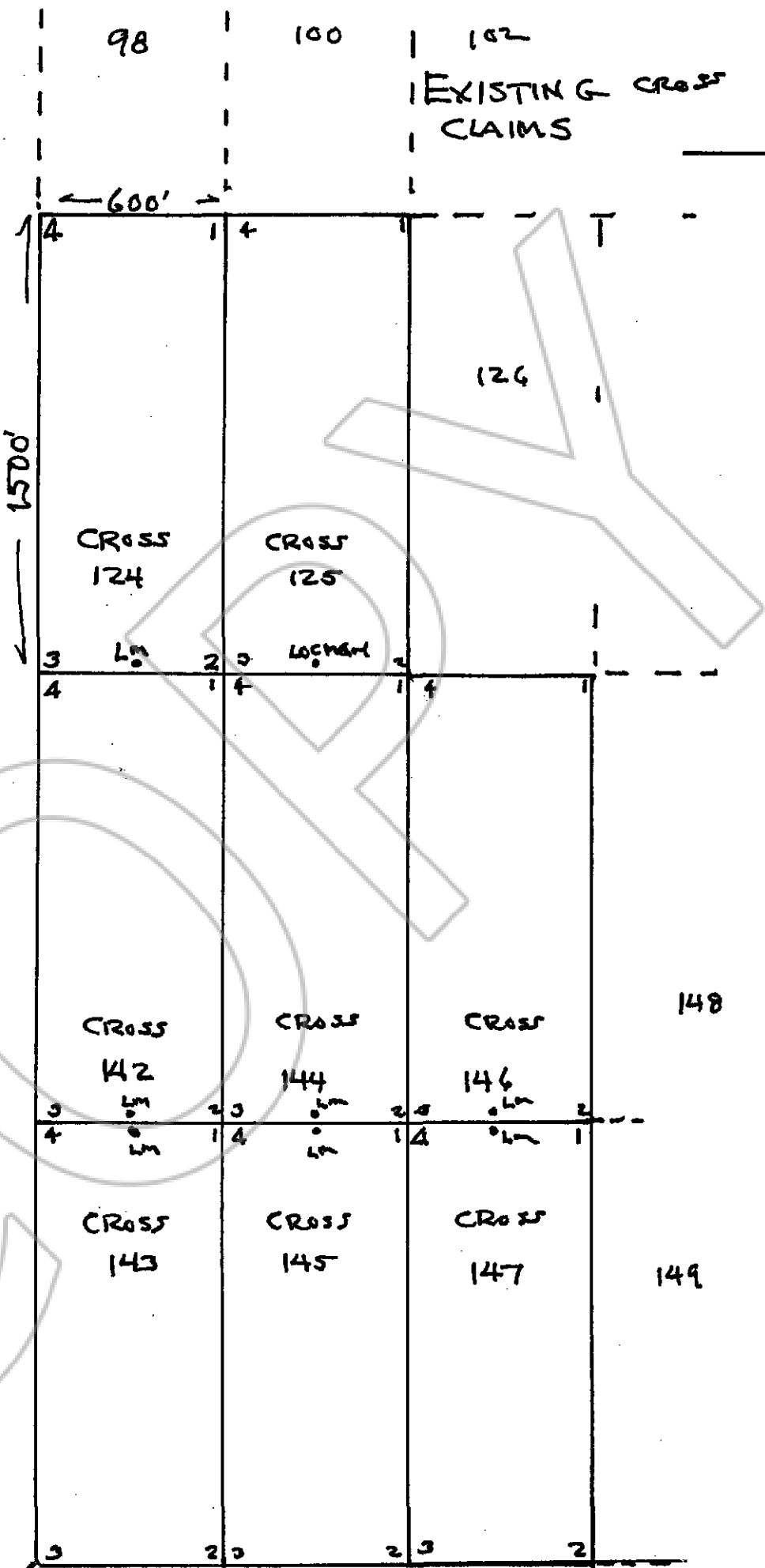

THE SOUTHWEST CORNER OF CROSS 143  
IS 750 FT IN A NORTH 45° EAST DIRECTION  
FROM THE <sup>SW</sup> UNSURVEYED CORNER OF SECTION 13  
T4N R63E MDBM