

DOC # 0132941

11/21/2008

03 17 PM

Official Record

Recording requested By
PARSONS BEHLE & LATIMER

Lincoln County - NV

Leslie Boucher - Recorder

Fee: \$73.00

Page 1 of 35

RPTT:

Recorded By: AE

Book- 245 Page- 0672



0132941

After Recording Return to:

Jackie Pope
Certified Legal Assistant
Parsons Behle & Latimer
P.O. Box 45898
Salt Lake City, UT 84145-0898

Assessor's Parcel No.: N/A

This document does not contain any
Social Security numbers

Space above for Recorder's Use

Assignment and Assumption Agreement

Address of Assignee and Grantee:

Great Basin Transmission, LLC
Two Tower Center, 11th Floor
East Brunswick, NJ 08816



ASSIGNMENT AND ASSUMPTION AGREEMENT

ASSIGNMENT AND ASSUMPTION AGREEMENT dated as of May 30, 2008 (this "Assignment Agreement") by and among Idaho Power Company, an Idaho corporation (the "Seller"), and Great Basin Transmission, LLC, a Delaware limited liability company (the "Buyer").

WITNESSETH

WHEREAS, pursuant to that certain Asset Purchase Option Agreement, dated as of March 31, 2005 (as amended by Amendment No. 1 to Asset Purchase Option Agreement dated March 28, 2008, the "Asset Purchase Option Agreement"), by and among Seller and Buyer, Seller is selling, assigning, conveying, transferring and delivering to Buyer the Southern Project Assets and the Common Project Assets (as defined in the Asset Purchase Option Agreement); and

WHEREAS, in partial consideration therefor, the Asset Purchase Option Agreement requires that Seller will assign to Buyer and Buyer assume and agree to pay, perform or discharge or cause to be paid, performed or discharged certain Liabilities of Seller.

NOW, THEREFORE, in consideration of these premises and for other good and valuable consideration, the receipt and adequacy of which is hereby acknowledged, Buyer and Seller agree as follows:

1 Capitalized terms that are used in this Assignment Agreement (including Appendix A hereto) but are not defined in this Assignment Agreement shall have the meanings ascribed to such terms in the Asset Purchase Option Agreement.

2 Seller hereby assigns, sells, conveys, transfers and sets over to Buyer, its successors and assigns, free and clear of all liens and encumbrances other than the Permitted Liens, all of the right, title and interest of Seller in the Southern Project Assets and the Common Project Assets that are not covered and transferred by the Bill of Sale by and between Seller and Buyer of even date herewith, including without limitation, the assets and contracts set forth on Appendix A hereto.

3 Buyer hereby assumes and agrees to pay, perform or discharge in accordance with their terms, to the extent not heretofore paid, performed or discharged and subject to the limitations contained in this Assignment Agreement, the Assumed Liabilities relating to the Southern Project Assets and the Common Project Assets.

4 It is understood and agreed that nothing in this Assignment Agreement or in Section 3.03 of the Asset Purchase Option Agreement shall constitute a waiver or release of any claims arising out of the contractual relationships between Seller and Buyer.

5 The assumption by Buyer of the Assumed Liabilities relating to the Southern Project Assets and the Common Project Assets shall not be construed to defeat, impair or limit in any way the rights, claims or remedies of Buyer under the Asset Purchase Option Agreement.



6 Other than as specifically set forth in this Assignment Agreement or in Section 3.03 of the Asset Purchase Option Agreement, Buyer shall not assume or be obligated to pay, perform or otherwise discharge any Liabilities of Seller, other than the Assumed Liabilities, including, without limitation, any Liabilities in respect of any Excluded Assets.

7 This Assignment Agreement shall be binding upon and shall inure to the benefit of the parties hereto and their respective successors and assigns.

8 This Assignment Agreement shall be governed by and construed in accordance with the laws of the State of New York (without giving effect to conflict of law principles).

9 This Assignment Agreement is delivered pursuant to and is subject to the Asset Purchase Option Agreement. In the event of any conflict between the terms of the Asset Purchase Option Agreement and the terms of this Assignment Agreement, the terms of the Asset Purchase Option Agreement shall prevail.

REMAINDER OF THIS PAGE INTENTIONALLY LEFT BLANK



IN WITNESS WHEREOF, this Assignment Agreement has been duly executed and delivered by the duly authorized representatives of the parties hereto as of the date first above written.

IDAHO POWER COMPANY

By: [Signature]
Name: Daniel B. Minor
Title: Senior Vice President, Delivery

GREAT BASIN TRANSMISSION, LLC

By: _____
Name:
Title:

STATE OF Idaho

COUNTY OF Arda

On this 30th day of May, before me Christa S. Bearry, a Notary Public in and for said State, personally appeared Daniel B. Minor identified to me to be the person whose name is subscribed to the foregoing instrument as Senior Vice President, Delivery of Idaho Power Company, an Idaho corporation, and acknowledged to me that he executed the same in his capacity as Senior Vice President, Delivery on behalf of the corporation.

STATE OF _____

COUNTY OF _____

On this ___ day of _____, before me _____, a Notary Public in and for said State, personally appeared _____ identified to me to be the person whose name is subscribed to the foregoing instrument as _____ of Great Basin Transmission, LLC, a Delaware limited liability company, and acknowledged to me that he executed the same in his capacity as _____ on behalf of the company.

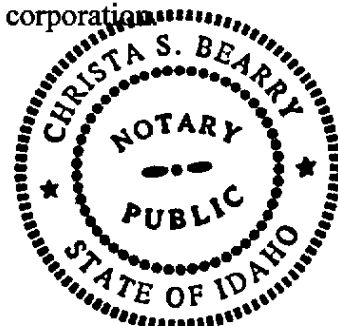



IN WITNESS WHEREOF, this Assignment Agreement has been duly executed and delivered by the duly authorized representatives of the parties hereto as of the date first above written.

IDAHO POWER COMPANY

By: _____
Name: Daniel B. Minor
Title: Senior Vice President, Delivery

GREAT BASIN TRANSMISSION, LLC

By: 
Name: MARK BRENNAN
Title: Treasurer

STATE OF _____

COUNTY OF _____

On this ____ day of _____, before me _____, a Notary Public in and for said State, personally appeared _____ identified to me to be the person whose name is subscribed to the foregoing instrument as _____ of Idaho Power Company, an Idaho corporation, and acknowledged to me that he executed the same in his capacity as _____ on behalf of the corporation.

STATE OF New Jersey

COUNTY OF Middlesex

On this 30th day of May, before me Dina Burkhardt, a Notary Public in and for said State, personally appeared Mark Brennan identified to me to be the person whose name is subscribed to the foregoing instrument as Treasurer of Great Basin Transmission, LLC, a Delaware limited liability company, and acknowledged to me that he executed the same in his capacity as Treasurer on behalf of the company.

DINA F. BURKHARDT
NOTARY PUBLIC OF NEW JERSEY
Commission Expires 4/27/2011



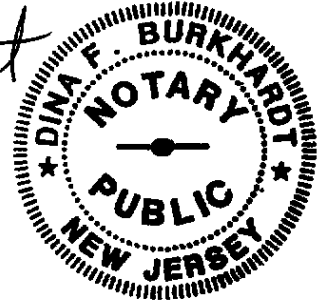



APPENDIX A

Common Project Assets

Southwest Intertie Project Record of Decision and Approved Land Use Plan Amendment dated November 1994;

Southwest Intertie Project Final Environmental Impact Statement and Proposed Plan Amendment dated July 1993;

Southwest Intertie Project Final Environmental Impact Statement and Proposed Plan Amendment Appendices dated July 1993;

Draft Environmental Impact Statement Draft Plan Amendment dated June 1992;

Draft Environmental Impact Statement Draft Plan Amendment Appendices dated June 1992;

Draft Environmental Impact Statement Draft Plan Amendment - Map Volume dated June 1992;

Southwest Intertie Project Technical Report Volume I – Objectives, Procedures and Results dated June 1992;

Southwest Intertie Project Technical Report Volume II– Natural Environment dated June 1992;

Southwest Intertie Project Technical Report Volume III – Human Environment dated June 1992;

Southwest Intertie Project Technical Report Volume IV – Cultural Environment dated June 1992;

U.S. Dept. of the Interior Fish and Wildlife Service – Biological Opinion for Southwest Intertie Project dated May 12, 1993

U.S. Dept. of the Interior Fish and Wildlife Service – Biological Opinion for Southwest Intertie Project dated March 23, 1994.

Cultural Resource Programmatic Agreement for the Southwest Intertie Project (among various parties) transmitted to the Seller from U.S. Dept. of the Interior, BLM via letter dated June 21, 1990;

Southwest Intertie Project Technical Report - Data Tables for Natural Environment dated June 1992;



Southwest Intertie Project Technical Report - Data Tables for Human Environment dated June 1992;

Southwest Intertie Project Technical Report - Data Tables for Human Environment - Visual Resource Volume I dated June 1992;

Southwest Intertie Project Technical Report - Data Tables for Human Environment - Visual Resources Vol. II dated June 1992;

SWIP Visual Resource Vol. III – June 1992;

SWIP Technical Report – Data Tables for Human Environment - Land Use Resources dated June 1992;

Southwest Intertie Project Technical Report - Data Tables for Cultural Environment dated June 1992;

Letter from the Seller to BLM – Ely District dated July 23, 2004 requesting a five year extension of time to commence construction of the Southwest Intertie Project;

Letter from BLM – Ely District to the Seller dated August 4, 2004 granting the Seller’s request for a five year extension of time to commence construction of the Southwest Intertie Project;

Letter from the Seller to BLM – Ely District dated October 1, 1999 requesting a five year extension of time to commence construction of the Southwest Intertie Project;

Letter from BLM – Ely District to the Seller dated December 2, 1999 granting the Seller’s request for a five year extension of time to commence construction of the Southwest Intertie Project; and

All other documents, data, studies, reports and other materials (whether written or in electronic or other media) related to the Project Assets (as defined in that certain Asset Purchase Option Agreement dated as of March 31, 2005 between the Company and White Pine Energy Associates, LLC, as amended by that certain Amendment No. 1 to the Asset Purchase Option Agreement dated as of March 28, 2008 between the Company and Great Basin Transmission, LLC (as so amended, the "Option Agreement")) that (i) the Company owns or controls which the Company can transfer using commercially reasonable efforts and (ii) have been used in the past or could reasonably be expected to become useful for the development or completion of the Project as a whole (but excluding any such material that is used or useful in the Company's ongoing operations); together with

Southern Project Assets

United States Department of the Interior Bureau of Land Management Right-of-Way Grant, Serial Numbers IDI-26446, NVN-49781, UTU-73363, effective date December 8, 1994, to the extent applicable to the Southern Project Assets (as defined in the Option Agreement), including, but not limited to that portion of Right-of-Way Grant NVN-49781 (as currently described in the form attached hereto as Exhibit A as amended from time to time) that extends from the southern boundary of Section 7 of Township 17 South, Range 64 East, M.D.B.&M., Clark County, Nevada, to the northern boundary of Section 2 of Township 21 North, Range 63 East, M.D.B.&M., White Pine County, Nevada., and further including:

- Robinson Summit Substation Site, SW1/4 Sect 20, T18N, R61E, MDB&M
 - Dry Lake Substation Site, SW1/4 Sect 7, T17S, R64E, MDB&M
 - Copper Communication Site, SW1/4 NE1/4 Sect 27, T17N, R61E, MDB&M
 - Highland Peak Communication Site, NW1/4 NE1/4 Sect 3, T1S, R66E, MDB&M
 - Glendale Communication Site, SE1/4 Sect 29, T14S, R67E, MDB&M
- Delamar Valley Series Compensation Station; and

All other documents, data, studies, reports and other materials (whether written or in electronic or other media) related to the Project Assets that (i) Seller owns or controls which Seller can transfer using commercially reasonable efforts and (ii) have been used in the past or could reasonably be expected to become useful for the development or completion of the Southern Project Portion (but excluding any such material that is used or useful in Seller's ongoing operations).



0132941

Book 245
Page 080

11/21/2009
Page 9 of 31

BOOK 213 PAGE 411

EXHIBIT A

Right-of-Way Grant NVN-49781

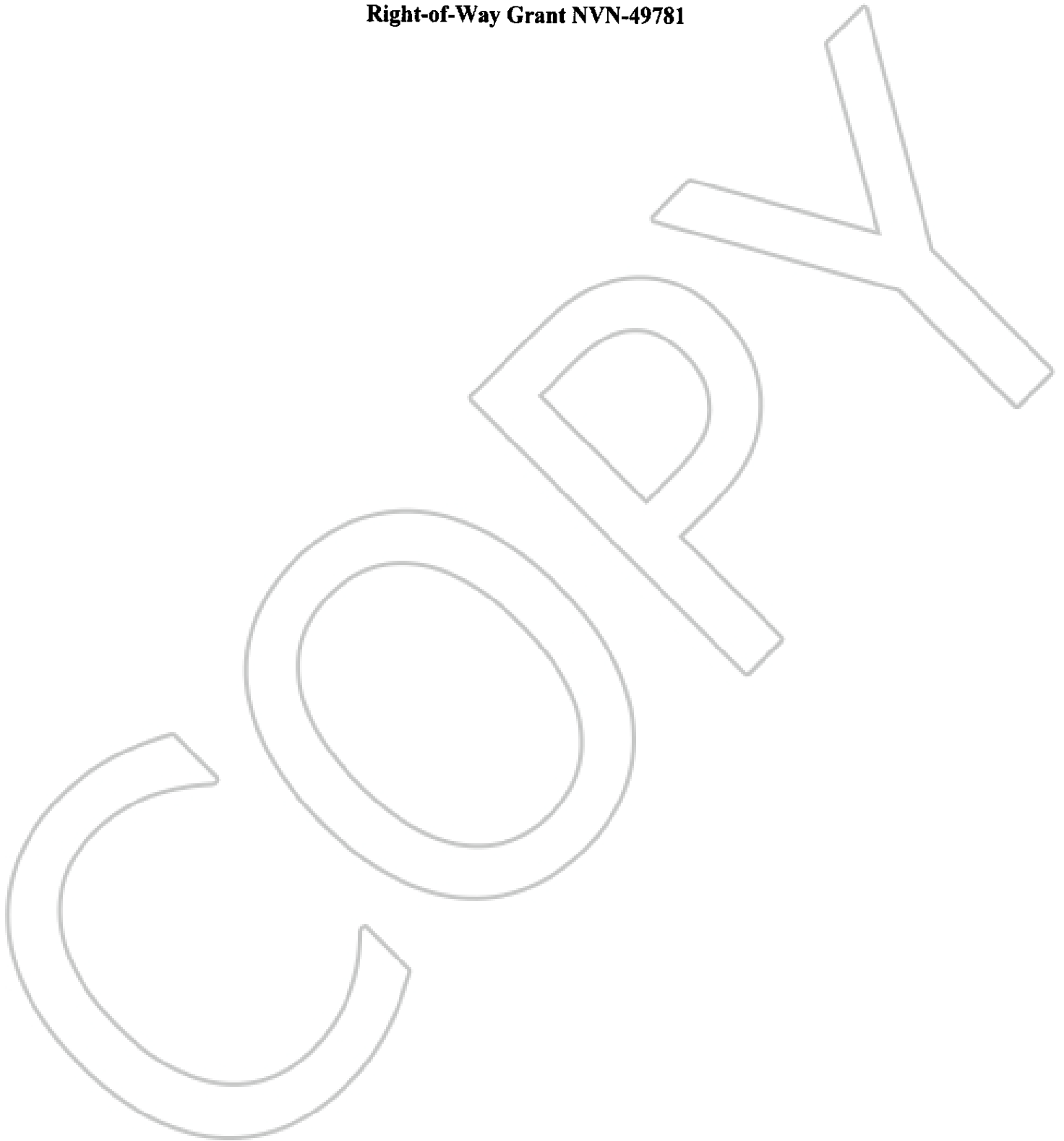



0132941

Book 245
Page: 681

11/21/2008
Page 12 of 24

BOOK 513 PAGE 418



United States Department of the Interior

BUREAU OF LAND MANAGEMENT
Ely District Office
HC33 Box 33500 (702 N. Industrial Way)
Ely, Nevada 89301-9408
http://www.blm.gov/nv/st/en/fo/ely_field_office.html



2850 (NV-043)
NVN-49781, IDI-26446, NVN-85210

CERTIFIED MAIL NO. 7006 0810 0005 7120 7138 - RETURN RECEIPT REQUESTED

DECISION

MAY 30 2008

Assignee

Great Basin Transmission, LLC
c/o LS Power Development, LLC
400 Chesterfield Center, Ste. 110
St. Louis, Missouri 63017

: FLPMA Title V
: Transmission Power Line
: Right-of-Way

Assignor

Idaho Power Company
1221 West Idaho
Boise, ID 83702

PARTIAL ASSIGNMENT ISSUED

On December 8, 1994 Right-of-Way Grant (ROW) NVN-49781 was issued to Idaho Power Company (IPC) for an electrical transmission line, substation sites, series compensation station sites, and communication sites, for the Southwest Intertie Project (SWIP). On May 23, 2008, the Bureau of Land Management (BLM) received a letter from IPC requesting a partial assignment of the above mentioned ROW Grant to Great Basin Transmission, LLC (GBT). Also received was an application (SF299) from GBT to process the partial assignment of the same ROW Grant to their company.

This assignment covers the portion of the ROW that extends from the SWIP ROW's southern terminus at the southern boundary of T. 17 S., R. 64 E., Section 7, located in Clark County, Nevada to the northern boundary of T. 18 N., R. 61 E., Sections 19 and 20, located in White Pine County, Nevada. Also included in this assignment is the application for amendment submitted by IPC in July, 2007, which will be completed upon approval of the Environmental Assessment (EA) and Decision Record, Finding of no Significant Impacts (DRFONSI). Attached to the Assignment Decision is the legal description of the section of the SWIP ROW being assigned. Also attached are the original stipulations contained in the IPC ROW, along with additional stipulations (Exhibit B) that have been added to the new ROW Grant.



You must pay a fee to BLM for the costs we will incur in monitoring the construction and operation of your authorized use. These fees will be charged to the Cost Recovery Account set up for this project.

Rent for use of public lands must also be paid in advance of such use and prior to issuance of the ROW grant. Rent for a linear right-of-way is based on a schedule that is adjusted annually based on the Implicit Price Deflator (IPD), an inflation index. Rent will be billed on January 1 of each year and will be due within 30 days of receipt of the statement.

If you have any questions, please call Brenda Linnell at (775) 289-1808 or e-mail to Brenda_Linnell@nv.blm.gov.

Sincerely,

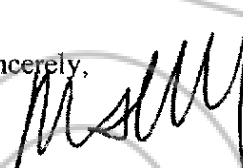
for 

John F. Ruhs
District Manager
Ely District Office

Cc: Idaho Power Company
Frederick Marcell (NV-060), Las Vegas DO
Allen Mariluch (NV-010), Elko DO

Enclosures

Map
Exhibit A, Legal Description
Exhibit B, Stipulations



| | | | |
|------------------------------------|----|----|----|
| 13 | 18 | 17 | 16 |
| White Pine County 24 18N 01E | 19 | 20 | 21 |
| 25 | 30 | 29 | 28 |

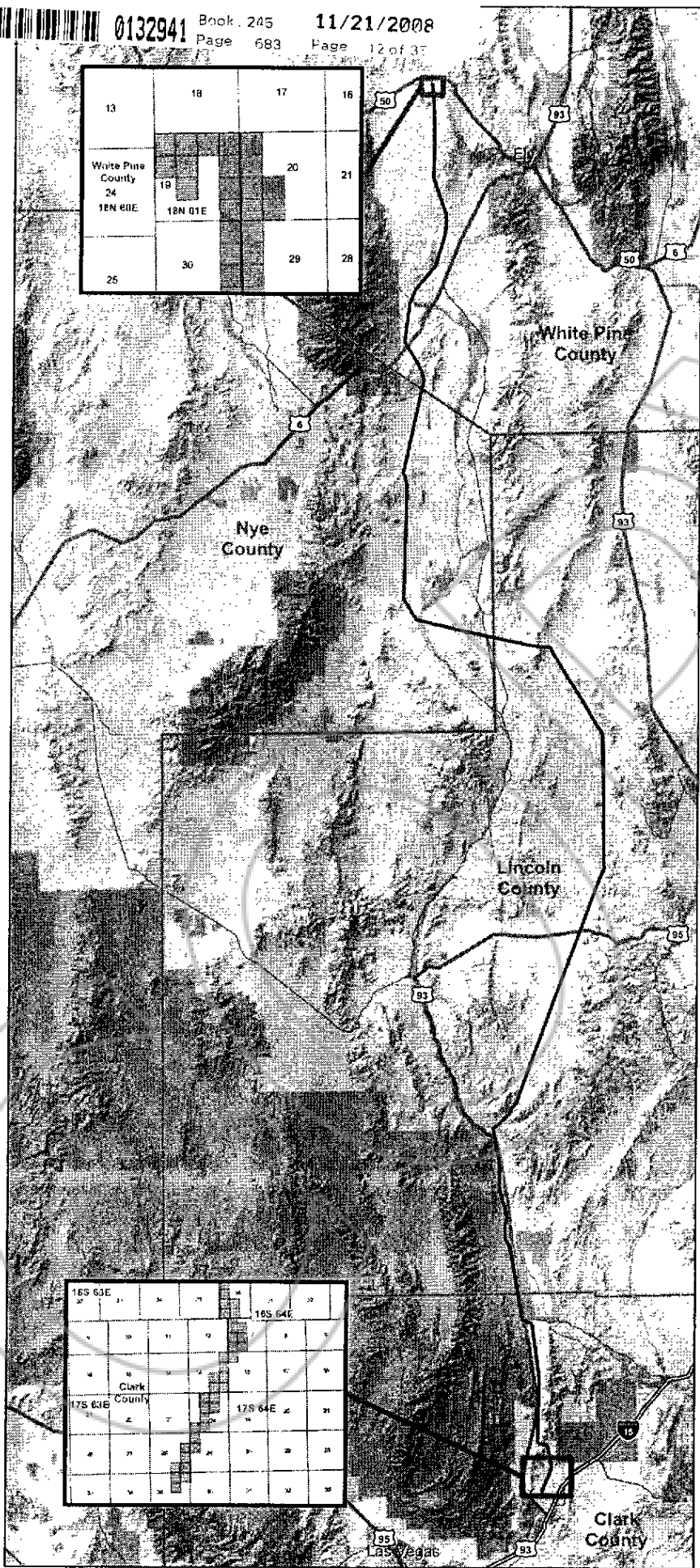

**SWIP South
 Great Basin Transmission
 N-85210**

May 2008

Legend

- SWIP South
- ROW Grant QQ Sections
- July 2007 Amendment Application
- BLM Land
- Township
- Section

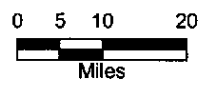

| | | | | | | | | | | | |
|--------------|----|----|----|----|----|----|----|----|----|----|----|
| 16S 63E | 30 | 31 | 32 | 33 | 34 | 35 | 36 | 37 | 38 | 39 | 40 |
| | 1 | 2 | 3 | 4 | 5 | 6 | 7 | 8 | 9 | 10 | 11 |
| Clark County | 12 | 13 | 14 | 15 | 16 | 17 | 18 | 19 | 20 | 21 | 22 |
| 17S 63E | 23 | 24 | 25 | 26 | 27 | 28 | 29 | 30 | 31 | 32 | 33 |
| | 34 | 35 | 36 | 37 | 38 | 39 | 40 | 41 | 42 | 43 | 44 |
| | 45 | 46 | 47 | 48 | 49 | 50 | 51 | 52 | 53 | 54 | 55 |



EXHIBIT A
Southwest Intertie Project
Great Basin Transmission, LLC
N-85210

| Township | Range | Section | Subdivision | County |
|----------|-------|---------|----------------------|--------|
| 17S | 64E | 07 | SENW,E2SW; | CLARK |
| 17S | 64E | 07 | 10,11; | CLARK |
| 17S | 64E | 07 | 8,9; | CLARK |
| 16S | 63E | 03 | E2SW; | CLARK |
| 16S | 63E | 03 | 2; | CLARK |
| 16S | 63E | 03 | 3; | CLARK |
| 16S | 63E | 03 | SENW,E2SW; | CLARK |
| 16S | 63E | 03 | SENW,NESW; | CLARK |
| 16S | 63E | 10 | W2NE; | CLARK |
| 16S | 63E | 10 | E2W2; | CLARK |
| 16S | 63E | 15 | E2W2,SWSE; | CLARK |
| 16S | 63E | 22 | N2NE; | CLARK |
| 16S | 63E | 23 | SWNE,N2NW,SENW,W2SE; | CLARK |
| 16S | 63E | 23 | NENE,NWNE,SENE; | CLARK |
| 16S | 63E | 23 | NESE,SESE; | CLARK |
| 16S | 63E | 25 | SWSW; | CLARK |
| 16S | 63E | 25 | SWNW,NWSW; | CLARK |
| 16S | 63E | 26 | E2E2,NWNE; | CLARK |
| 16S | 63E | 36 | SWSW; | CLARK |
| 16S | 63E | 36 | W2NW,N2SW,SESW; | CLARK |
| 15S | 63E | 03 | E2E2; | CLARK |
| 15S | 63E | 03 | W2E2; | CLARK |
| 15S | 63E | 10 | NWSE; | CLARK |
| 15S | 63E | 10 | W2NE; | CLARK |
| 15S | 63E | 10 | E2NE,NESE,SWSE; | CLARK |
| 15S | 63E | 15 | W2E2; | CLARK |
| 15S | 63E | 22 | W2E2; | CLARK |
| 15S | 63E | 27 | W2E2; | CLARK |
| 15S | 63E | 27 | NESW,SESW; | CLARK |
| 15S | 63E | 34 | W2E2; | CLARK |
| 15S | 63E | 34 | NESW,SESW; | CLARK |
| 15S | 63E | 34 | NENW,SENW; | CLARK |
| 14S | 63E | 03 | W2W2; | CLARK |
| 14S | 63E | 10 | NENW; | CLARK |
| 14S | 63E | 10 | NWSW; | CLARK |
| 14S | 63E | 10 | W2NW,SENW,E2SW; | CLARK |
| 14S | 63E | 15 | E2W2,SWSE; | CLARK |
| 14S | 63E | 22 | W2E2,NENW; | CLARK |
| 14S | 63E | 22 | SENW,NESW; | CLARK |
| 14S | 63E | 27 | SESE; | CLARK |
| 14S | 63E | 27 | W2E2; | CLARK |
| 14S | 63E | 34 | E2E2; | CLARK |
| 14S | 63E | 34 | NWNE,SWNE; | CLARK |
| 14S | 63E | 34 | NWSE,SWSE; | CLARK |
| 13½S | 63E | 33 | NENE; | CLARK |
| 13½S | 63E | 33 | E2NE,NESE; | CLARK |
| 13½S | 63E | 34 | W2NW; | CLARK |
| 13½S | 63E | 34 | W2SW; | CLARK |

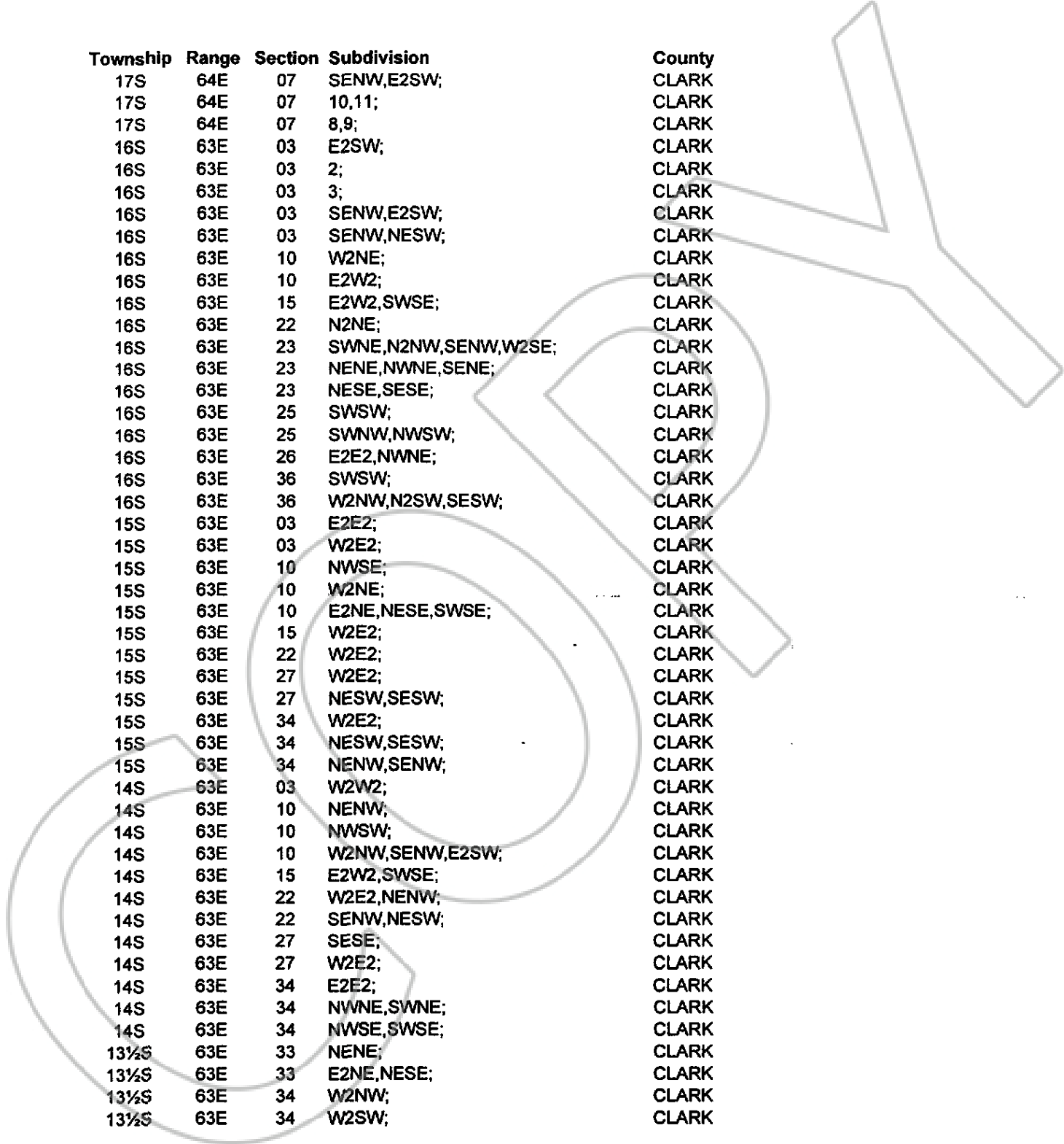



0132941

Book 245
Page: 685

11/21/2008
Page: 12 of 35

BOOK 513 PAGE 482

EXHIBIT A
Southwest Intertie Project
Great Basin Transmission, LLC
N-85210

| Township | Range | Section | Subdivision | County |
|----------|-------|---------|--------------------------|---------|
| 13½S | 63E | 34 | NWNW,SWNW; | CLARK |
| 13S | 63E | 05 | SWNW; | CLARK |
| 13S | 63E | 05 | 2,5,6,7,8,9,10,11,12,13; | CLARK |
| 13S | 63E | 05 | 4,14,15; | CLARK |
| 13S | 63E | 05 | 16,17,18; | CLARK |
| 13S | 63E | 05 | 6,7,13,16; | CLARK |
| 13S | 63E | 08 | 16,17,18; | CLARK |
| 13S | 63E | 08 | 2,3,4,7,8,9,11,12,13; | CLARK |
| 13S | 63E | 08 | 5,6,14; | CLARK |
| 13S | 63E | 08 | 4,7,8,12,17; | CLARK |
| 13S | 63E | 17 | E2NW,W2SE; | CLARK |
| 13S | 63E | 17 | 1,2,3,4,5,6,7,8; | CLARK |
| 13S | 63E | 17 | NESW,SESW; | CLARK |
| 13S | 63E | 20 | W2E2; | CLARK |
| 13S | 63E | 20 | 3; | CLARK |
| 13S | 63E | 20 | 1,2,7,8,9,10; | CLARK |
| 13S | 63E | 20 | W2SE,SE,SE; | CLARK |
| 13S | 63E | 21 | 3; | CLARK |
| 13S | 63E | 27 | W2SW; | CLARK |
| 13S | 63E | 27 | SWNW; | CLARK |
| 13S | 63E | 28 | E2E2; | CLARK |
| 13S | 63E | 28 | W2NE,N2NW; | CLARK |
| 13S | 63E | 29 | NENE; | CLARK |
| 13S | 63E | 34 | W2W2; | CLARK |
| 12S | 62E | 01 | 1; | LINCOLN |
| 12S | 62E | 01 | SENE,NESE; | LINCOLN |
| 12S | 63E | 06 | 4,5,6,7; | LINCOLN |
| 12S | 63E | 06 | 3; | LINCOLN |
| 12S | 63E | 06 | SENW,E2SW; | LINCOLN |
| 12S | 63E | 07 | 1,2,3,4; | LINCOLN |
| 12S | 63E | 07 | E2NW,SWNE,W2SE; | LINCOLN |
| 12S | 63E | 07 | NESW,SESW; | LINCOLN |
| 12S | 63E | 18 | 1; | LINCOLN |
| 12S | 63E | 18 | NESW,SESW; | LINCOLN |
| 12S | 63E | 18 | W2E2,SESE; | LINCOLN |
| 12S | 63E | 18 | NENW,SENW; | LINCOLN |
| 12S | 63E | 19 | NESW,SESW; | LINCOLN |
| 12S | 63E | 19 | NWNE,E2E2; | LINCOLN |
| 12S | 63E | 19 | SWNE,NENW,SENW; | LINCOLN |
| 12S | 63E | 19 | NWSE,SWSE; | LINCOLN |
| 12S | 63E | 30 | E2E2; | LINCOLN |
| 12S | 63E | 30 | NWSE,SWSE; | LINCOLN |
| 12S | 63E | 30 | NWNE,SWNE; | LINCOLN |
| 12S | 63E | 31 | NENE; | LINCOLN |
| 12S | 63E | 31 | NESE,NWSE,SESE; | LINCOLN |
| 12S | 63E | 31 | NWNE,SENE,SWNE; | LINCOLN |
| 12S | 63E | 32 | W2W2; | LINCOLN |
| 11S | 62E | 01 | 2,3; | LINCOLN |

EXHIBIT A
Southwest Intertie Project
Great Basin Transmission, LLC
N-85210

| Township | Range | Section | Subdivision | County |
|----------|-------|---------|-----------------|---------|
| 11S | 62E | 01 | NESW,SESW; | LINCOLN |
| 11S | 62E | 01 | SWNE,SENW,W2SE; | LINCOLN |
| 11S | 62E | 12 | W2E2; | LINCOLN |
| 11S | 62E | 12 | NENW,SENW,SWNW; | LINCOLN |
| 11S | 62E | 12 | SESW,SWSW; | LINCOLN |
| 11S | 62E | 12 | NESW,NWSW; | LINCOLN |
| 11S | 62E | 13 | NE,E2SE; | LINCOLN |
| 11S | 62E | 13 | NWNW,SWNW; | LINCOLN |
| 11S | 62E | 13 | NWSW,SWSW; | LINCOLN |
| 11S | 62E | 24 | E2E2; | LINCOLN |
| 11S | 62E | 24 | NWSW,SWSW; | LINCOLN |
| 11S | 62E | 24 | NWNW,SWNW; | LINCOLN |
| 11S | 62E | 25 | SWSE,NESW; | LINCOLN |
| 11S | 62E | 25 | SENW,NWSE,SESE; | LINCOLN |
| 11S | 62E | 25 | SWNE,NENW,NWNW; | LINCOLN |
| 11S | 62E | 36 | NENE,NWNE,SENE; | LINCOLN |
| 11S | 62E | 36 | NESE,SESE; | LINCOLN |
| 11S | 63E | 18 | W2NE,SENE; | LINCOLN |
| 11S | 63E | 18 | 4; | LINCOLN |
| 11S | 63E | 19 | 1,2,3,4; | LINCOLN |
| 11S | 63E | 20 | W2SW; | LINCOLN |
| 11S | 63E | 30 | 1,2,3,4; | LINCOLN |
| 11S | 63E | 31 | SESW; | LINCOLN |
| 11S | 63E | 31 | 1,2,3,4; | LINCOLN |
| 11S | 63E | 31 | 16; | LINCOLN |
| 11S | 63E | 32 | W2NW,SENW; | LINCOLN |
| 10S | 62E | 02 | E2SE; | LINCOLN |
| 10S | 62E | 02 | 2; | LINCOLN |
| 10S | 62E | 02 | 3; | LINCOLN |
| 10S | 62E | 02 | SWNE,NWSE; | LINCOLN |
| 10S | 62E | 02 | SENW,SWSE; | LINCOLN |
| 10S | 62E | 02 | NESW,SESW; | LINCOLN |
| 10S | 62E | 11 | SE; | LINCOLN |
| 10S | 62E | 11 | E2NE; | LINCOLN |
| 10S | 62E | 11 | NWNE,SWNE,NENW; | LINCOLN |
| 10S | 62E | 11 | SENW,NESW,SESW; | LINCOLN |
| 10S | 62E | 14 | SWSE; | LINCOLN |
| 10S | 62E | 14 | W2NE,E2NW; | LINCOLN |
| 10S | 62E | 14 | NESW,S2SW; | LINCOLN |
| 10S | 62E | 23 | NWSE,SESE; | LINCOLN |
| 10S | 62E | 23 | N2NW,SENW; | LINCOLN |
| 10S | 62E | 23 | E2SW,SWSE; | LINCOLN |
| 10S | 62E | 23 | NWNE,SWNE; | LINCOLN |
| 10S | 62E | 25 | SWSW; | LINCOLN |
| 10S | 62E | 26 | NE,E2SE; | LINCOLN |
| 10S | 62E | 35 | NENE; | LINCOLN |
| 10S | 62E | 36 | E2NE,NWSE; | LINCOLN |
| 10S | 62E | 36 | SENW,NWSW,SWSW; | LINCOLN |



0132941

Book 245
Page 687

11/21/2008
Page: 15 of 35

EXHIBIT A
Southwest Intertie Project
Great Basin Transmission, LLC
N-85210

| Township | Range | Section | Subdivision | County |
|----------|-------|---------|----------------------|---------|
| 10S | 62E | 36 | W2NW,SESW,E2SW; | LINCOLN |
| 10S | 62E | 36 | W2NW,SESW,E2SW; | LINCOLN |
| 10S | 62E | 36 | SENW,NWSW,SWSW; | LINCOLN |
| 09S | 62E | 03 | SWNE,W2SE,SESE; | LINCOLN |
| 09S | 62E | 03 | 2; | LINCOLN |
| 09S | 62E | 03 | SENE,NESE; | LINCOLN |
| 09S | 62E | 10 | E2E2; | LINCOLN |
| 09S | 62E | 11 | SWSW; | LINCOLN |
| 09S | 62E | 14 | W2W2; | LINCOLN |
| 09S | 62E | 15 | NENE; | LINCOLN |
| 09S | 62E | 15 | SENE; | LINCOLN |
| 09S | 62E | 23 | W2NW,SENW,E2SW; | LINCOLN |
| 09S | 62E | 23 | NWSW,SWSW; | LINCOLN |
| 09S | 62E | 26 | NWNW; | LINCOLN |
| 09S | 62E | 26 | E2W2,SWSE; | LINCOLN |
| 09S | 62E | 35 | W2NE,NWSE; | LINCOLN |
| 09S | 62E | 35 | 3; | LINCOLN |
| 09S | 62E | 35 | L 2, SENW, NESW | LINCOLN |
| 09S | 62E | 35 | NENW | LINCOLN |
| 09S | 63E | 14 | SWNW; | LINCOLN |
| 09S | 63E | 35 | NENW; | LINCOLN |
| 08S | 62E | 24 | NENE,S2NE,SESW,W2SE; | LINCOLN |
| 08S | 62E | 24 | NESE,SESE; | LINCOLN |
| 08S | 62E | 25 | N2NW,SWNW; | LINCOLN |
| 08S | 62E | 25 | NWNE,SENW,NWSW; | LINCOLN |
| 08S | 62E | 26 | SESE; | LINCOLN |
| 08S | 62E | 26 | SENE,SESW,N2SE,SWSE; | LINCOLN |
| 08S | 62E | 34 | SENE,SESW,N2SE,SWSE; | LINCOLN |
| 08S | 62E | 35 | NWNE; | LINCOLN |
| 08S | 62E | 35 | N2NW,SWNW; | LINCOLN |
| 08S | 63E | 05 | NESW; | LINCOLN |
| 08S | 63E | 05 | NENW,S2NW,W2SW; | LINCOLN |
| 08S | 63E | 05 | NENE,NWNE,SWNE; | LINCOLN |
| 08S | 63E | 05 | NWSE,SESW; | LINCOLN |
| 08S | 63E | 07 | SESE; | LINCOLN |
| 08S | 63E | 07 | E2NE,N2SE,SWSE; | LINCOLN |
| 08S | 63E | 08 | NWNW; | LINCOLN |
| 08S | 63E | 08 | NWSW,SWSW; | LINCOLN |
| 08S | 63E | 08 | NENW,SENW,SWNW; | LINCOLN |
| 08S | 63E | 18 | NWNE,E2NW,N2SW,SWSW; | LINCOLN |
| 08S | 63E | 18 | NWSE,SESW; | LINCOLN |
| 08S | 63E | 18 | NENE,SENE,SWNE; | LINCOLN |
| 08S | 63E | 19 | NWNW; | LINCOLN |
| 08S | 63E | 19 | SWNW,NWSW; | LINCOLN |
| 07S | 63E | 2 | NWNW | LINCOLN |
| 07S | 63E | 03 | SENE; | LINCOLN |
| 07S | 63E | 03 | NENE,W2E2,SESW; | LINCOLN |
| 07S | 63E | 03 | NESE,SESE; | LINCOLN |



EXHIBIT A
Southwest Intertie Project
Great Basin Transmission, LLC
N-85210

| Township | Range | Section | Subdivision | County |
|----------|-------|---------|----------------------|---------|
| 07S | 63E | 10 | E2NW,N2SW,SWSW; | LINCOLN |
| 07S | 63E | 10 | NWNE,SWNE; | LINCOLN |
| 07S | 63E | 10 | NWSE,SESW; | LINCOLN |
| 07S | 63E | 15 | W2NW; | LINCOLN |
| 07S | 63E | 15 | NENW,NWSW,SWSW; | LINCOLN |
| 07S | 63E | 16 | SWSE; | LINCOLN |
| 07S | 63E | 16 | SENE,E2SE; | LINCOLN |
| 07S | 63E | 21 | NESW; | LINCOLN |
| 07S | 63E | 21 | NENE,W2E2; | LINCOLN |
| 07S | 63E | 21 | SENE,SWSE; | LINCOLN |
| 07S | 63E | 21 | SESW | LINCOLN |
| 07S | 63E | 28 | NENW,S2NW,W2SW; | LINCOLN |
| 07S | 63E | 28 | NWNE,NESW; | LINCOLN |
| 07S | 63E | 29 | SESE; | LINCOLN |
| 07S | 63E | 32 | NENE,S2NE,SESW,W2SE; | LINCOLN |
| 07S | 63E | 32 | NESE,SESE; | LINCOLN |
| 07S | 63E | 33 | NWNW,SWNW; | LINCOLN |
| 06S | 62E | 35 | 2; | LINCOLN |
| 06S | 62E | 35 | SENW,NESW; | LINCOLN |
| 06S | 63E | 01 | NESE; | LINCOLN |
| 06S | 63E | 01 | SESE; | LINCOLN |
| 06S | 63E | 02 | NWNW; | LINCOLN |
| 06S | 63E | 12 | SESW; | LINCOLN |
| 06S | 63E | 12 | NESE; | LINCOLN |
| 06S | 63E | 12 | NENE,S2NE,W2SE; | LINCOLN |
| 06S | 63E | 13 | NWNE,E2NW,N2SW,SWSW; | LINCOLN |
| 06S | 63E | 13 | SWNE,SESW; | LINCOLN |
| 06S | 63E | 23 | NENE; | LINCOLN |
| 06S | 63E | 23 | SENE,NESE,S2SE; | LINCOLN |
| 06S | 63E | 24 | NWSW; | LINCOLN |
| 06S | 63E | 24 | W2NW; | LINCOLN |
| 06S | 63E | 26 | W2NE,E2SW,NWSE; | LINCOLN |
| 06S | 63E | 26 | NENE,SWSE; | LINCOLN |
| 06S | 63E | 34 | SESE; | LINCOLN |
| 06S | 63E | 35 | N2NW,SWNW,NWSW; | LINCOLN |
| 06S | 63E | 35 | SENW,NESW,SWSW; | LINCOLN |
| 06S | 64E | 06 | SENW; | LINCOLN |
| 06S | 64E | 06 | 3,5-7; | LINCOLN |
| 06S | 64E | 06 | 4; | LINCOLN |
| 06S | 64E | 07 | NWNW; | LINCOLN |
| 05S | 64E | 04 | SWSW; | LINCOLN |
| 05S | 64E | 04 | NWSE; | LINCOLN |
| 05S | 64E | 04 | SWNE,SENW,E2SW; | LINCOLN |
| 05S | 64E | 04 | 2; | LINCOLN |
| 05S | 64E | 08 | E2SE; | LINCOLN |
| 05S | 64E | 09 | N2NW,SWNW,NWSW; | LINCOLN |
| 05S | 64E | 09 | SENW,SWSW; | LINCOLN |
| 05S | 64E | 17 | SESW; | LINCOLN |

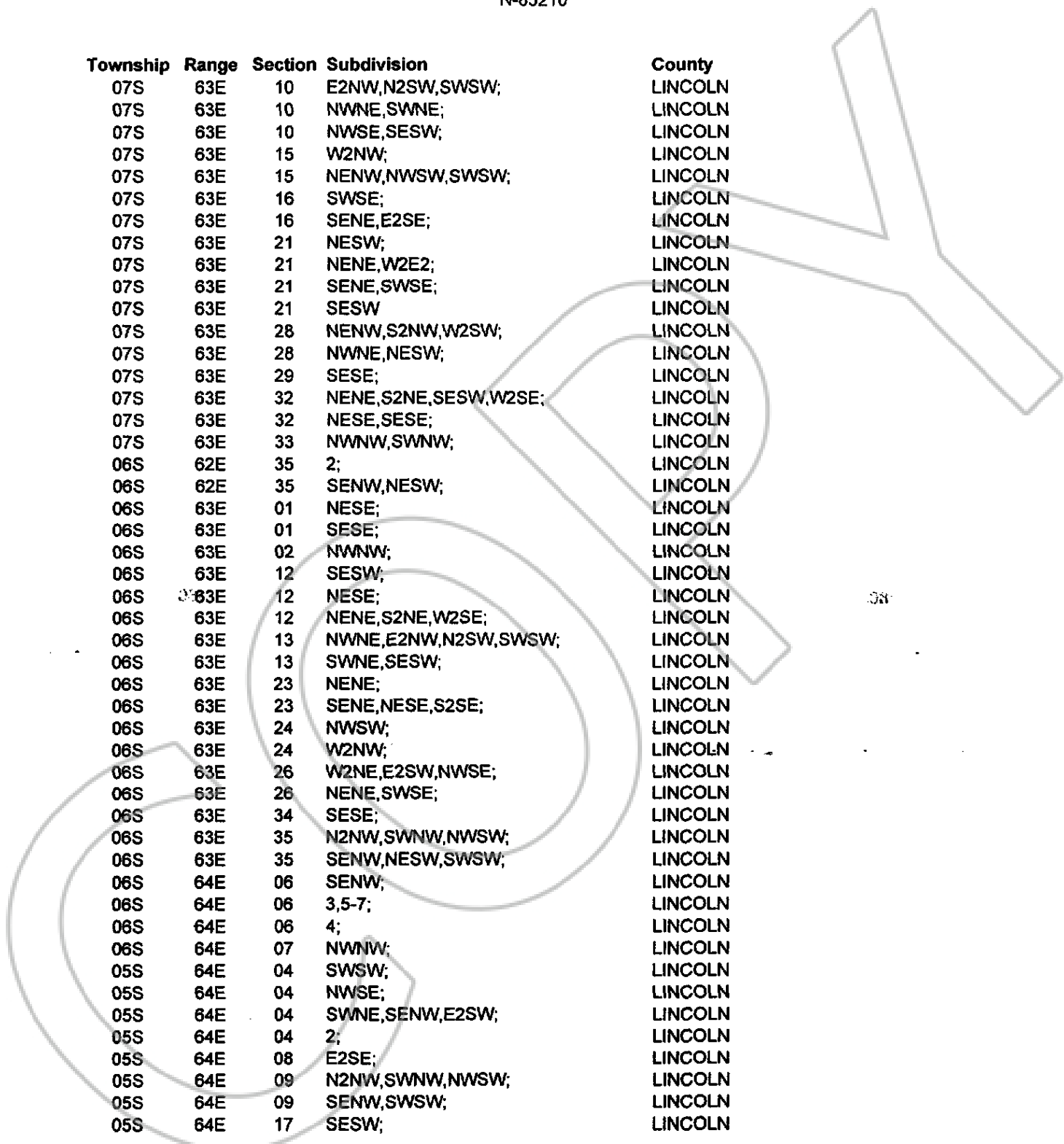



0132941

Book 245
Page: 689

11/21/2008
Page: 18 of 30

EXHIBIT A
Southwest Intertie Project
Great Basin Transmission, LLC
N-85210

| Township | Range | Section | Subdivision | County |
|----------|-------|---------|----------------------|---------|
| 05S | 64E | 17 | NENE,S2NE,W2SE; | LINCOLN |
| 05S | 64E | 17 | NESE; | LINCOLN |
| 05S | 64E | 20 | NWNE; | LINCOLN |
| 05S | 64E | 20 | E2NW,N2SW,SWSW; | LINCOLN |
| 05S | 64E | 20 | SESW; | LINCOLN |
| 05S | 64E | 29 | W2NW; | LINCOLN |
| 05S | 64E | 29 | SWNW; | LINCOLN |
| 05S | 64E | 30 | SENE,NESE,S2SE; | LINCOLN |
| 05S | 64E | 30 | SENW; | LINCOLN |
| 05S | 64E | 30 | NENE; | LINCOLN |
| 05S | 64E | 31 | W2NE,E2SW,NWSE; | LINCOLN |
| 05S | 64E | 31 | NENE,SWSE; | LINCOLN |
| 04S | 64E | 02 | SWNE,SENW,NESW,S2SW; | LINCOLN |
| 04S | 64E | 02 | 2; | LINCOLN |
| 04S | 64E | 10 | E2SE; | LINCOLN |
| 04S | 64E | 11 | W2NW,NWSW; | LINCOLN |
| 04S | 64E | 11 | NENW,SWSW; | LINCOLN |
| 04S | 64E | 15 | SENE; | LINCOLN |
| 04S | 64E | 15 | NENE,W2E2,SESW; | LINCOLN |
| 04S | 64E | 22 | NENW,S2NW,W2SW; | LINCOLN |
| 04S | 64E | 22 | NWNE,NESW; | LINCOLN |
| 04S | 64E | 27 | NWNW; | LINCOLN |
| 04S | 64E | 27 | SWNW; | LINCOLN |
| 04S | 64E | 28 | E2NE,N2SE,SWSE; | LINCOLN |
| 04S | 64E | 28 | SESE; | LINCOLN |
| 04S | 64E | 33 | W2NE,SENW,NESW,S2SW; | LINCOLN |
| 04S | 64E | 33 | NWSE; | LINCOLN |
| 03S | 64E | 13 | E2SE; | LINCOLN |
| 03S | 64E | 24 | N2NE,SWNE,SESW,NWSE; | LINCOLN |
| 03S | 64E | 24 | SENE,SWSE; | LINCOLN |
| 03S | 64E | 25 | NENW,S2NW,W2SW; | LINCOLN |
| 03S | 64E | 25 | NESW; | LINCOLN |
| 03S | 64E | 35 | SESE; | LINCOLN |
| 03S | 64E | 35 | E2NE,N2SE,SWSE; | LINCOLN |
| 03S | 64E | 36 | NWNW; | LINCOLN |
| 03S | 65E | 06 | S2NE,W2SE; | LINCOLN |
| 03S | 65E | 06 | NESE; | LINCOLN |
| 03S | 65E | 06 | NESW; | LINCOLN |
| 03S | 65E | 06 | 1; | LINCOLN |
| 03S | 65E | 07 | SESW; | LINCOLN |
| 03S | 65E | 07 | NWNE,E2NW,NESW; | LINCOLN |
| 03S | 65E | 07 | SWNE; | LINCOLN |
| 03S | 65E | 07 | 3,4; | LINCOLN |
| 03S | 65E | 18 | 3; | LINCOLN |
| 03S | 65E | 18 | 1,2; | LINCOLN |
| 02S | 65E | 05 | SENE,E2SE; | LINCOLN |
| 02S | 65E | 05 | 1; | LINCOLN |
| 02S | 65E | 08 | E2E2; | LINCOLN |

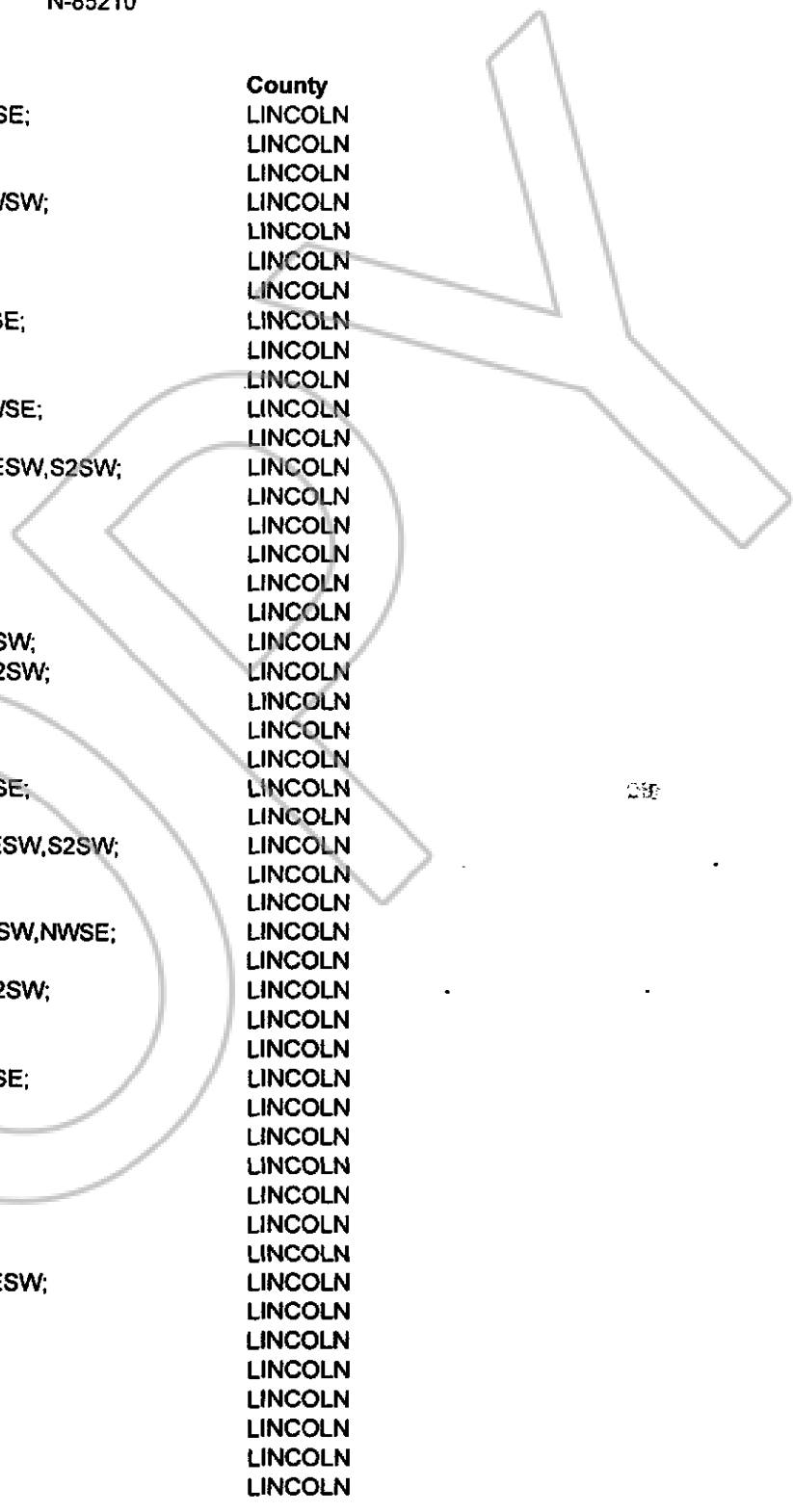
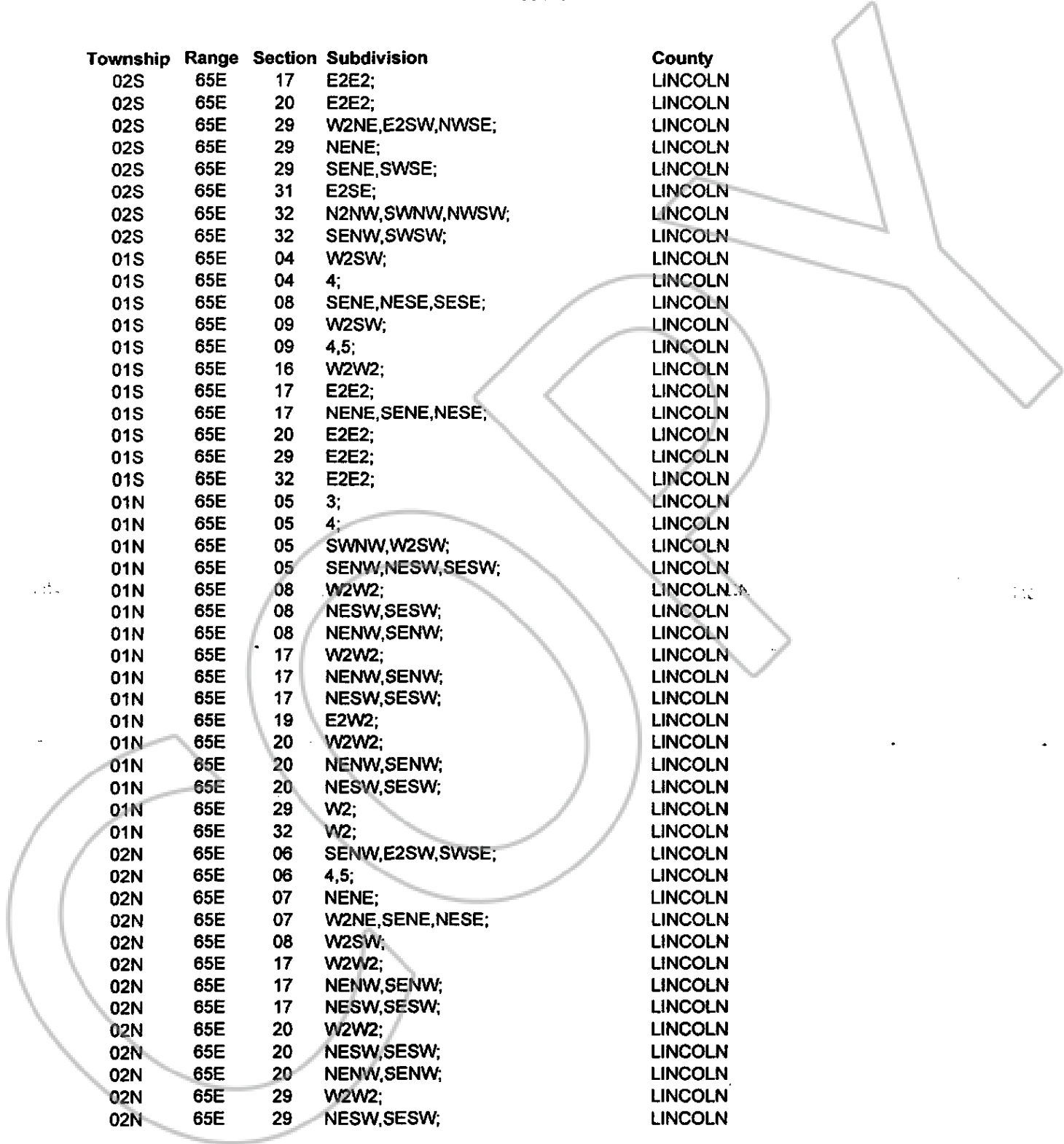



EXHIBIT A
Southwest Intertie Project
Great Basin Transmission, LLC
N-85210

| Township | Range | Section | Subdivision | County |
|----------|-------|---------|-----------------|---------|
| 02S | 65E | 17 | E2E2; | LINCOLN |
| 02S | 65E | 20 | E2E2; | LINCOLN |
| 02S | 65E | 29 | W2NE,E2SW,NWSE; | LINCOLN |
| 02S | 65E | 29 | NENE; | LINCOLN |
| 02S | 65E | 29 | SENE,SWSE; | LINCOLN |
| 02S | 65E | 31 | E2SE; | LINCOLN |
| 02S | 65E | 32 | N2NW,SWNW,NWSW; | LINCOLN |
| 02S | 65E | 32 | SENW,SWSW; | LINCOLN |
| 01S | 65E | 04 | W2SW; | LINCOLN |
| 01S | 65E | 04 | 4; | LINCOLN |
| 01S | 65E | 08 | SENE,NESE,SESE; | LINCOLN |
| 01S | 65E | 09 | W2SW; | LINCOLN |
| 01S | 65E | 09 | 4,5; | LINCOLN |
| 01S | 65E | 16 | W2W2; | LINCOLN |
| 01S | 65E | 17 | E2E2; | LINCOLN |
| 01S | 65E | 17 | NENE,SENE,NESE; | LINCOLN |
| 01S | 65E | 20 | E2E2; | LINCOLN |
| 01S | 65E | 29 | E2E2; | LINCOLN |
| 01S | 65E | 32 | E2E2; | LINCOLN |
| 01N | 65E | 05 | 3; | LINCOLN |
| 01N | 65E | 05 | 4; | LINCOLN |
| 01N | 65E | 05 | SWNW,W2SW; | LINCOLN |
| 01N | 65E | 05 | SENW,NESW,SESW; | LINCOLN |
| 01N | 65E | 08 | W2W2; | LINCOLN |
| 01N | 65E | 08 | NESW,SESW; | LINCOLN |
| 01N | 65E | 08 | NENW,SENW; | LINCOLN |
| 01N | 65E | 17 | W2W2; | LINCOLN |
| 01N | 65E | 17 | NENW,SENW; | LINCOLN |
| 01N | 65E | 17 | NESW,SESW; | LINCOLN |
| 01N | 65E | 19 | E2W2; | LINCOLN |
| 01N | 65E | 20 | W2W2; | LINCOLN |
| 01N | 65E | 20 | NENW,SENW; | LINCOLN |
| 01N | 65E | 20 | NESW,SESW; | LINCOLN |
| 01N | 65E | 29 | W2; | LINCOLN |
| 01N | 65E | 32 | W2; | LINCOLN |
| 02N | 65E | 06 | SENW,E2SW,SWSE; | LINCOLN |
| 02N | 65E | 06 | 4,5; | LINCOLN |
| 02N | 65E | 07 | NENE; | LINCOLN |
| 02N | 65E | 07 | W2NE,SENE,NESE; | LINCOLN |
| 02N | 65E | 08 | W2SW; | LINCOLN |
| 02N | 65E | 17 | W2W2; | LINCOLN |
| 02N | 65E | 17 | NENW,SENW; | LINCOLN |
| 02N | 65E | 17 | NESW,SESW; | LINCOLN |
| 02N | 65E | 20 | W2W2; | LINCOLN |
| 02N | 65E | 20 | NESW,SESW; | LINCOLN |
| 02N | 65E | 20 | NENW,SENW; | LINCOLN |
| 02N | 65E | 29 | W2W2; | LINCOLN |
| 02N | 65E | 29 | NESW,SESW; | LINCOLN |





0132941

Book 245
Page 691

11/21/2008
Page 20 of 35

BOOK 53 PAGE 488

EXHIBIT A
Southwest Intertie Project
Great Basin Transmission, LLC
N-85210

Page 8 of 13

| Township | Range | Section | Subdivision | County |
|----------|-------|---------|-------------------------|---------|
| 02N | 65E | 29 | NENW, SENW; | LINCOLN |
| 02N | 65E | 32 | W2W2; | LINCOLN |
| 02N | 65E | 32 | NESW, SESW; | LINCOLN |
| 02N | 65E | 32 | NENW, SENW; | LINCOLN |
| 03N | 63E | 05 | NESE; | LINCOLN |
| 03N | 64E | 03 | NWSW; | LINCOLN |
| 03N | 64E | 03 | SWSW; | LINCOLN |
| 03N | 64E | 04 | S2NE, E2SE; | LINCOLN |
| 03N | 64E | 04 | 1; | LINCOLN |
| 03N | 64E | 04 | 2; | LINCOLN |
| 03N | 64E | 10 | W2NW, SENW, NESW, W2SE; | LINCOLN |
| 03N | 64E | 10 | NENW; | LINCOLN |
| 03N | 64E | 10 | SWNE, SESE; | LINCOLN |
| 03N | 64E | 14 | SWNW; | LINCOLN |
| 03N | 64E | 14 | W2SW, SESW; | LINCOLN |
| 03N | 64E | 15 | N2NE, SENE, NESE; | LINCOLN |
| 03N | 64E | 23 | SWNE, E2NW, W2SE, SESE; | LINCOLN |
| 03N | 64E | 23 | NWNE, NESE; | LINCOLN |
| 03N | 64E | 25 | SWSE; | LINCOLN |
| 03N | 64E | 25 | W2NW, N2SW, SESW; | LINCOLN |
| 03N | 64E | 26 | NENE; | LINCOLN |
| 03N | 64E | 36 | NENW; | LINCOLN |
| 03N | 64E | 36 | NWSE; | LINCOLN |
| 03N | 64E | 36 | W2NE, SENE, E2SE; | LINCOLN |
| 03N | 65E | 31 | SWSW; | LINCOLN |
| 04N | 62E | 01 | NENE; | LINCOLN |
| 04N | 63E | 01 | SWSW; | LINCOLN |
| 04N | 63E | 01 | SWSE, SESW; | LINCOLN |
| 04N | 63E | 02 | S2S2; | LINCOLN |
| 04N | 63E | 03 | N2S2; | LINCOLN |
| 04N | 63E | 03 | SESE, SWSE; | LINCOLN |
| 04N | 63E | 03 | SESW, SWSW; | LINCOLN |
| 04N | 63E | 04 | S2N2, NESE; | LINCOLN |
| 04N | 63E | 04 | NESW, NWSW; | LINCOLN |
| 04N | 63E | 04 | NWSE, SESE; | LINCOLN |
| 04N | 63E | 05 | W2NE, SENE, N2NW; | LINCOLN |
| 04N | 63E | 05 | SENW, SWNW; | LINCOLN |
| 04N | 63E | 06 | N2NE; | LINCOLN |
| 04N | 63E | 06 | SENE, NENW, NWNW; | LINCOLN |
| 04N | 63E | 11 | NENE; | LINCOLN |
| 04N | 63E | 12 | N2N2, SENE; | LINCOLN |
| 04N | 64E | 07 | SWNW, W2SW, SESW; | LINCOLN |
| 04N | 64E | 18 | SWNE, E2NW, W2SE, SESE; | LINCOLN |
| 04N | 64E | 18 | NWNE, NESE; | LINCOLN |
| 04N | 64E | 19 | E2NE; | LINCOLN |
| 04N | 64E | 20 | SWNW, N2SW, SESW; | LINCOLN |
| 04N | 64E | 20 | NWNW, SWSE; | LINCOLN |
| 04N | 64E | 28 | SWSW; | LINCOLN |



EXHIBIT A
Southwest Intertie Project
Great Basin Transmission, LLC
N-85210

| Township | Range | Section | Subdivision | County |
|----------|-------|---------|----------------------|---------|
| 04N | 64E | 29 | SENE; | LINCOLN |
| 04N | 64E | 29 | W2NE,NENW,N2SE,SESE; | LINCOLN |
| 04N | 64E | 32 | NENE; | LINCOLN |
| 04N | 64E | 33 | NWSE; | LINCOLN |
| 04N | 64E | 33 | W2NW,N2SW,SESW; | LINCOLN |
| 04N | 64E | 33 | SENW,SWSE; | LINCOLN |
| 05N | 62E | 34 | S2NE; | LINCOLN |
| 05N | 62E | 34 | SWNE,W2NW,SENW; | LINCOLN |
| 05N | 62E | 34 | NESE,NWSE; | LINCOLN |
| 05N | 62E | 35 | S2NW,NESW,N2SE; | LINCOLN |
| 05N | 62E | 35 | SESE,SWSE,NWSW; | LINCOLN |
| 05N | 62E | 36 | SWSW; | LINCOLN |
| 05N | 62E | 36 | N2SW,SESW,S2SE; | LINCOLN |
| 05N | 63E | 31 | S2SW; | LINCOLN |
| 05N | 60E | 03 | W2SW,SESW; | NYE |
| 05N | 60E | 03 | SWNW; | NYE |
| 05N | 60E | 04 | SENE; | NYE |
| 05N | 60E | 04 | 1,2; | NYE |
| 05N | 60E | 10 | NWNE; | NYE |
| 05N | 60E | 10 | SWNE,E2NW,N2SE,SESE; | NYE |
| 05N | 60E | 13 | S2S2,NWSW; | NYE |
| 05N | 60E | 13 | S2NW,NESW,N2SE; | NYE |
| 05N | 60E | 14 | W2NW,SENW,NESW,NWSE; | NYE |
| 05N | 60E | 14 | NWNE,SENE; | NYE |
| 05N | 60E | 14 | NWSW,S2S2; | NYE |
| 05N | 60E | 15 | NENE; | NYE |
| 05N | 61E | 18 | 4; | NYE |
| 05N | 61E | 19 | N2NE,NENW; | NYE |
| 05N | 61E | 19 | 1; | NYE |
| 05N | 61E | 20 | S2N2,NWNW; | NYE |
| 05N | 61E | 21 | N2S2,SWNW; | NYE |
| 05N | 61E | 22 | S2S2,NWSW; | NYE |
| 05N | 61E | 23 | SWSW; | NYE |
| 05N | 61E | 25 | N2NW; | NYE |
| 05N | 61E | 25 | SWNW,SENW,SWNE,SENE | NYE |
| 05N | 61E | 26 | N2N2; | NYE |
| 05N | 62E | 28 | SWSW; | NYE |
| 05N | 62E | 29 | S2S2; | NYE |
| 05N | 62E | 30 | SESW; | NYE |
| 05N | 62E | 30 | NESW,N2SE,SESE; | NYE |
| 05N | 62E | 30 | NWSW,SWSE; | NYE |
| 05N | 62E | 32 | NENE; | NYE |
| 05N | 62E | 32 | NWNE,NENW; | NYE |
| 05N | 62E | 33 | N2N2; | NYE |
| 05N | 62E | 33 | SENE,SWNE; | NYE |
| 05N | 62E | 34 | S2NE; | NYE |
| 05N | 62E | 34 | SWNE,W2NW,SENW; | NYE |
| 05N | 62E | 34 | NESE,NWSE; | NYE |

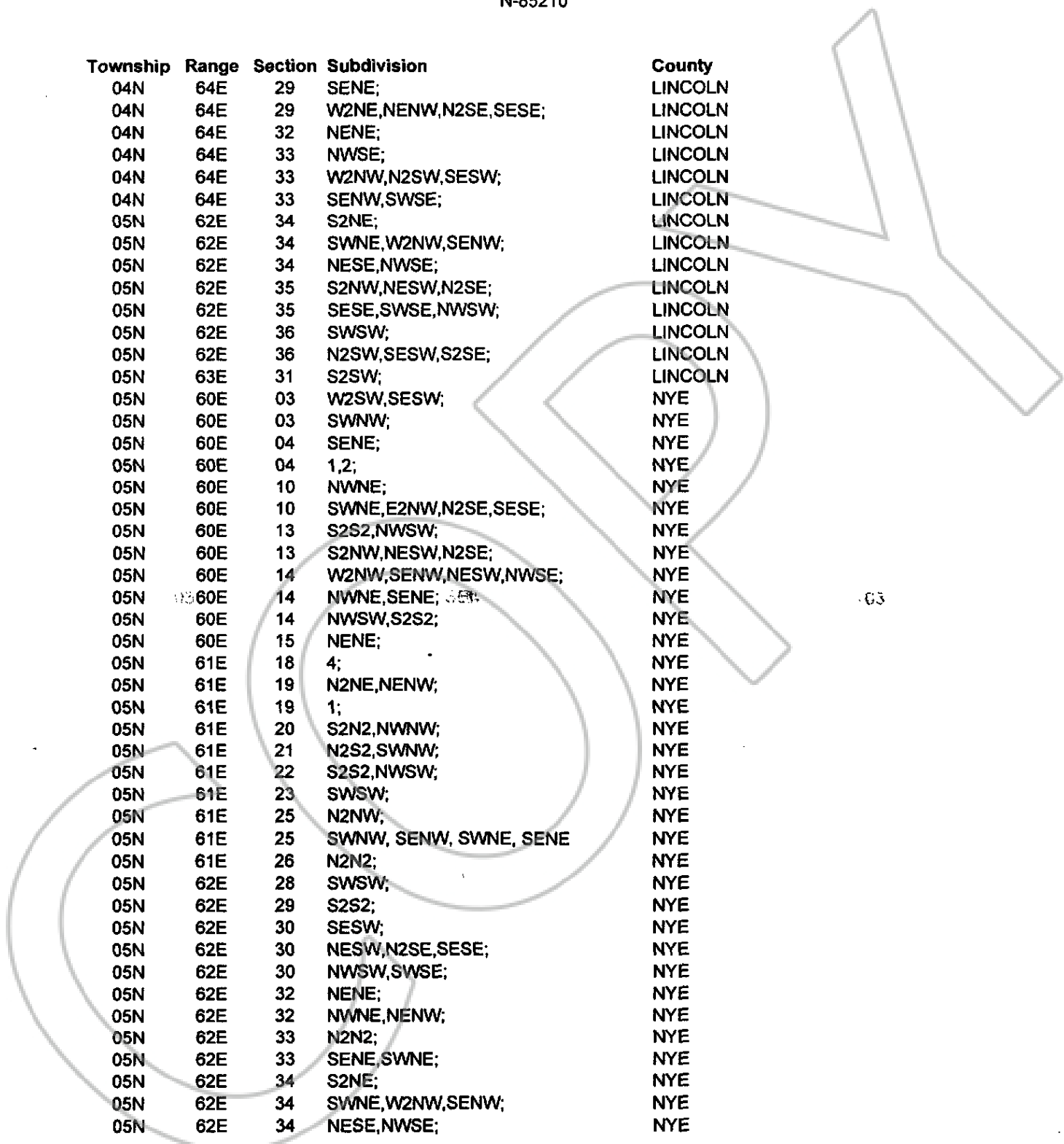

63



EXHIBIT A
Southwest Intertie Project
Great Basin Transmission, LLC
N-85210

| Township | Range | Section | Subdivision | County |
|----------|-------|---------|-----------------|--------|
| 06N | 60E | 04 | SENW,E2SW; | NYE |
| 06N | 60E | 04 | 2,3; | NYE |
| 06N | 60E | 04 | SWNE,NWSE,SWSE; | NYE |
| 06N | 60E | 09 | E2W2; | NYE |
| 06N | 60E | 16 | E2W2; | NYE |
| 06N | 60E | 21 | E2W2; | NYE |
| 06N | 60E | 28 | E2W2; | NYE |
| 06N | 60E | 33 | E2W2,SWSE; | NYE |
| 07N | 60E | 04 | SWNE,W2SE; | NYE |
| 07N | 60E | 04 | 1; | NYE |
| 07N | 60E | 04 | 2; | NYE |
| 07N | 60E | 04 | SENE,NESE; | NYE |
| 07N | 60E | 09 | W2E2; | NYE |
| 07N | 60E | 16 | W2E2; | NYE |
| 07N | 60E | 21 | W2E2; | NYE |
| 07N | 60E | 28 | W2E2; | NYE |
| 07N | 60E | 33 | W2E2; | NYE |
| 07N | 60E | 33 | SESW; | NYE |
| 08N | 60E | 04 | NENE; | NYE |
| 08N | 60E | 04 | W2NE,SENE,E2SE; | NYE |
| 08N | 60E | 09 | E2E2; | NYE |
| 08N | 60E | 16 | E2E2; | NYE |
| 08N | 60E | 21 | E2E2; | NYE |
| 08N | 60E | 28 | E2NE; | NYE |
| 08N | 60E | 28 | W2E2; | NYE |
| 08N | 60E | 28 | NESE,SESE; | NYE |
| 08N | 60E | 33 | W2E2; | NYE |
| 08N | 60E | 33 | NENE,SENE; | NYE |
| 09N | 60E | 03 | NESW; | NYE |
| 09N | 60E | 03 | W2E2,SESW; | NYE |
| 09N | 60E | 10 | NWSW; | NYE |
| 09N | 60E | 10 | E2W2,SWSW; | NYE |
| 09N | 60E | 15 | W2W2; | NYE |
| 09N | 60E | 16 | NESE; | NYE |
| 09N | 60E | 16 | SESE; | NYE |
| 09N | 60E | 21 | NWSE; | NYE |
| 09N | 60E | 21 | E2E2,SWSE; | NYE |
| 09N | 60E | 28 | NESW; | NYE |
| 09N | 60E | 28 | W2E2,SESW; | NYE |
| 09N | 60E | 33 | NESW; | NYE |
| 09N | 60E | 33 | SWNE,E2NW,NWSE; | NYE |
| 09N | 60E | 33 | SWSE; | NYE |
| 10N | 60E | 01 | NWSW; | NYE |
| 10N | 60E | 01 | SWNW; | NYE |
| 10N | 60E | 01 | NWNW; | NYE |
| 10N | 60E | 02 | E2E2; | NYE |
| 10N | 60E | 11 | SENE; | NYE |
| 10N | 60E | 11 | NESE; | NYE |



EXHIBIT A
Southwest Intertie Project
Great Basin Transmission, LLC
N-85210

| Township | Range | Section | Subdivision | County |
|----------|-------|---------|----------------------|------------|
| 10N | 60E | 11 | NENE,W2E2; | NYE |
| 10N | 60E | 14 | NWSE; | NYE |
| 10N | 60E | 14 | W2NE,SENW,E2SW; | NYE |
| 10N | 60E | 23 | NENW,S2NW,W2SW; | NYE |
| 10N | 60E | 26 | W2NW,NWSW; | NYE |
| 10N | 60E | 27 | SENE; | NYE |
| 10N | 60E | 27 | E2SE; | NYE |
| 10N | 60E | 34 | SWNE; | NYE |
| 10N | 60E | 34 | E2NE,N2SE,SWSE; | NYE |
| 11N | 60E | 12 | SWSW; | NYE |
| 11N | 60E | 13 | W2W2,SESW; | NYE |
| 11N | 60E | 13 | NESW; | NYE |
| 11N | 60E | 24 | E2W2; | NYE |
| 11N | 60E | 24 | NWSE,SWSE; | NYE |
| 11N | 60E | 25 | E2W2,SWSW; | NYE |
| 11N | 60E | 35 | SESE; | NYE |
| 11N | 60E | 36 | W2W2; | NYE |
| 11N | 60E | 02 | SWNW,N2SW,SESW; | WHITE PINE |
| 11N | 60E | 02 | 4; | WHITE PINE |
| 11N | 60E | 03 | SENE; | WHITE PINE |
| 11N | 60E | 03 | 1; | WHITE PINE |
| 11N | 60E | 11 | W2NE,NENW,E2SE; | WHITE PINE |
| 11N | 60E | 11 | SENE,NWSE; | WHITE PINE |
| 11N | 60E | 12 | SWSW; | WHITE PINE |
| 11N | 60E | 13 | NESW; | WHITE PINE |
| 11N | 60E | 13 | W2W2,SESW; | WHITE PINE |
| 11N | 60E | 24 | E2W2; | WHITE PINE |
| 11N | 60E | 24 | NWSE,SWSE; | WHITE PINE |
| 11N | 60E | 36 | W2W2; | WHITE PINE |
| 12N | 60E | 03 | SENW,E2SW; | WHITE PINE |
| 12N | 60E | 03 | 2,3; | WHITE PINE |
| 12N | 60E | 03 | SWNW,NWSW,SWSW; | WHITE PINE |
| 12N | 60E | 09 | SESE; | WHITE PINE |
| 12N | 60E | 10 | NENW,S2NW,W2SW; | WHITE PINE |
| 12N | 60E | 10 | NWNW; | WHITE PINE |
| 12N | 60E | 15 | W2NW; | WHITE PINE |
| 12N | 60E | 16 | NENE; | WHITE PINE |
| 12N | 60E | 16 | SENE,E2SE; | WHITE PINE |
| 12N | 60E | 21 | SESE; | WHITE PINE |
| 12N | 60E | 21 | E2NE,N2SE,SWSE; | WHITE PINE |
| 12N | 60E | 27 | W2SW,SESW; | WHITE PINE |
| 12N | 60E | 28 | N2NE,SENE,NESE; | WHITE PINE |
| 12N | 60E | 34 | SWNE,E2NW,W2SE,SESE; | WHITE PINE |
| 12N | 60E | 34 | NWNW; | WHITE PINE |
| 13N | 60E | 01 | NESE; | WHITE PINE |
| 13N | 60E | 01 | SESE; | WHITE PINE |
| 13N | 60E | 11 | SESE; | WHITE PINE |
| 13N | 60E | 12 | N2NE,SWNE,NESW,S2SW; | WHITE PINE |

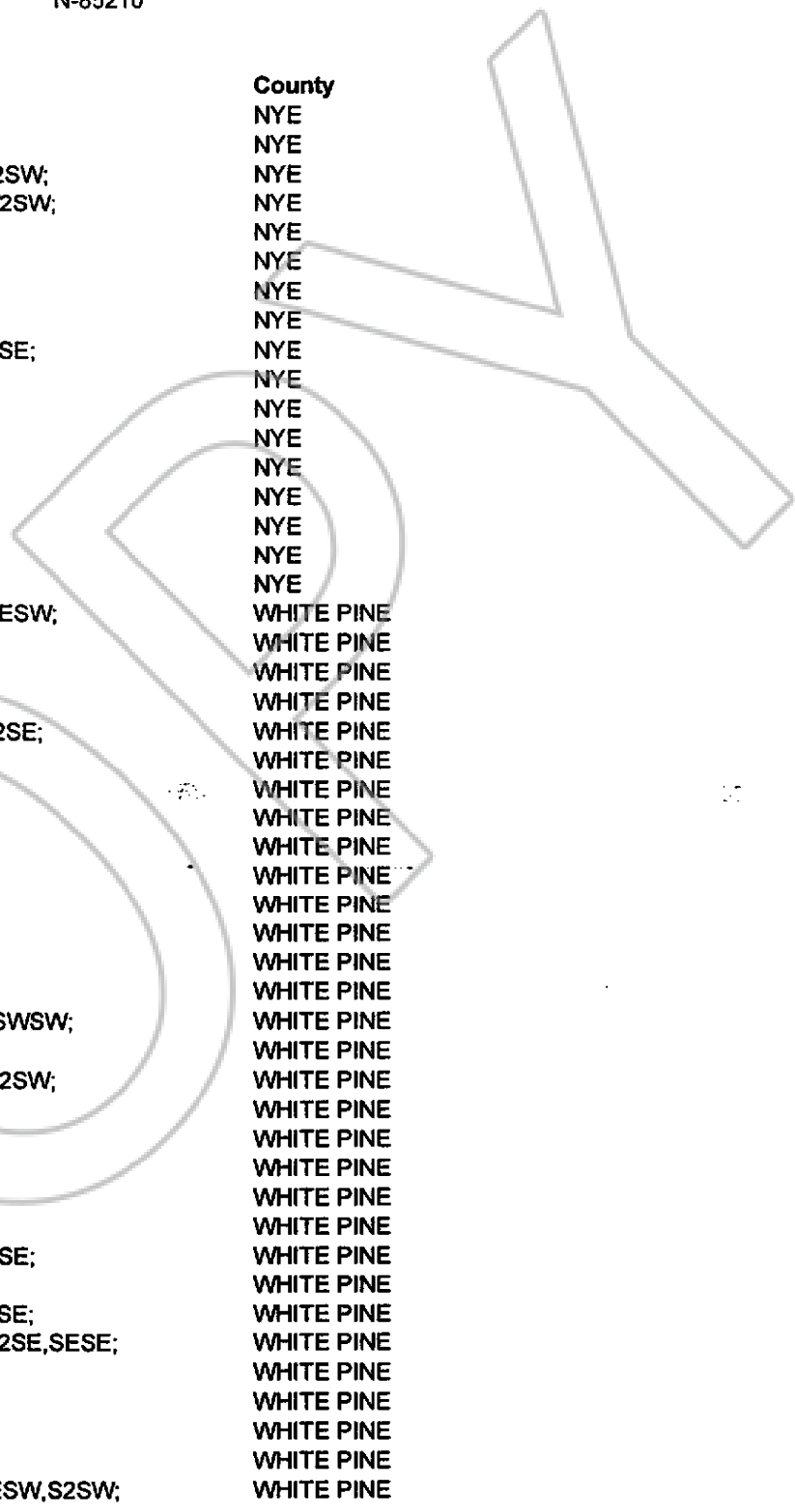



EXHIBIT A

Southwest Intertie Project
Great Basin Transmission, LLC
N-85210

| Township | Range | Section | Subdivision | County |
|----------|-------|---------|----------------------|------------|
| 13N | 60E | 12 | SENW,NWSW; | WHITE PINE |
| 13N | 60E | 13 | NWNW; | WHITE PINE |
| 13N | 60E | 14 | E2NE,N2SE,SWSE; | WHITE PINE |
| 13N | 60E | 14 | NESW,SESW,SWSW; | WHITE PINE |
| 13N | 60E | 14 | NWNE,SWNE,SENW; | WHITE PINE |
| 13N | 60E | 22 | SENE,NESE,SESE; | WHITE PINE |
| 13N | 60E | 23 | NWNE,E2NW,NESW,SWSW; | WHITE PINE |
| 13N | 60E | 23 | NWSW; | WHITE PINE |
| 13N | 60E | 23 | NWNW,SWNW; | WHITE PINE |
| 13N | 60E | 26 | NWNW; | WHITE PINE |
| 13N | 60E | 27 | SENE,E2SE; | WHITE PINE |
| 13N | 60E | 27 | NWNE,SWNE,NWSE; | WHITE PINE |
| 13N | 60E | 27 | NENE,E2SE; | WHITE PINE |
| 13N | 60E | 27 | SWSE,NESW,SESW; | WHITE PINE |
| 13N | 60E | 34 | NENE,S2NE,W2SE; | WHITE PINE |
| 13N | 60E | 34 | NENW,SENW; | WHITE PINE |
| 13N | 60E | 34 | NWNE,E2SW; | WHITE PINE |
| 13N | 61E | 06 | SENW; | WHITE PINE |
| 13N | 61E | 06 | 2,3,6,7; | WHITE PINE |
| 13N | 61E | 06 | 5; | WHITE PINE |
| 14N | 61E | 04 | SESE; | WHITE PINE |
| 14N | 61E | 04 | SENE,N2SE,SWSE; | WHITE PINE |
| 14N | 61E | 04 | 1,8; | WHITE PINE |
| 14N | 61E | 09 | E2SW; | WHITE PINE |
| 14N | 61E | 09 | NWSE; | WHITE PINE |
| 14N | 61E | 09 | W2NE,SENW; | WHITE PINE |
| 14N | 61E | 16 | SENW; | WHITE PINE |
| 14N | 61E | 16 | NENW,W2W2; | WHITE PINE |
| 14N | 61E | 17 | SESE; | WHITE PINE |
| 14N | 61E | 20 | E2NE,NESE,SWSE; | WHITE PINE |
| 14N | 61E | 20 | SESE; | WHITE PINE |
| 14N | 61E | 21 | NWNW; | WHITE PINE |
| 14N | 61E | 29 | W2NE,E2SW,NWSE; | WHITE PINE |
| 14N | 61E | 31 | SENE,NESE,SWSE; | WHITE PINE |
| 14N | 61E | 31 | SESE; | WHITE PINE |
| 14N | 61E | 32 | NWSW; | WHITE PINE |
| 14N | 61E | 32 | N2NW,SWNW; | WHITE PINE |
| 15N | 61E | 04 | NWSW; | WHITE PINE |
| 15N | 61E | 04 | SWSW; | WHITE PINE |
| 15N | 61E | 05 | SWNE; | WHITE PINE |
| 15N | 61E | 05 | E2E2,NWNE; | WHITE PINE |
| 15N | 61E | 09 | SENW; | WHITE PINE |
| 15N | 61E | 09 | W2NW,N2SW,SESW; | WHITE PINE |
| 15N | 61E | 16 | SWNE,E2NW,W2SE; | WHITE PINE |
| 15N | 61E | 16 | NWNE,SESE; | WHITE PINE |
| 15N | 61E | 21 | E2E2,NWNE; | WHITE PINE |
| 15N | 61E | 22 | NWSW,SWSW; | WHITE PINE |
| 15N | 61E | 27 | NWNW,SWNW; | WHITE PINE |

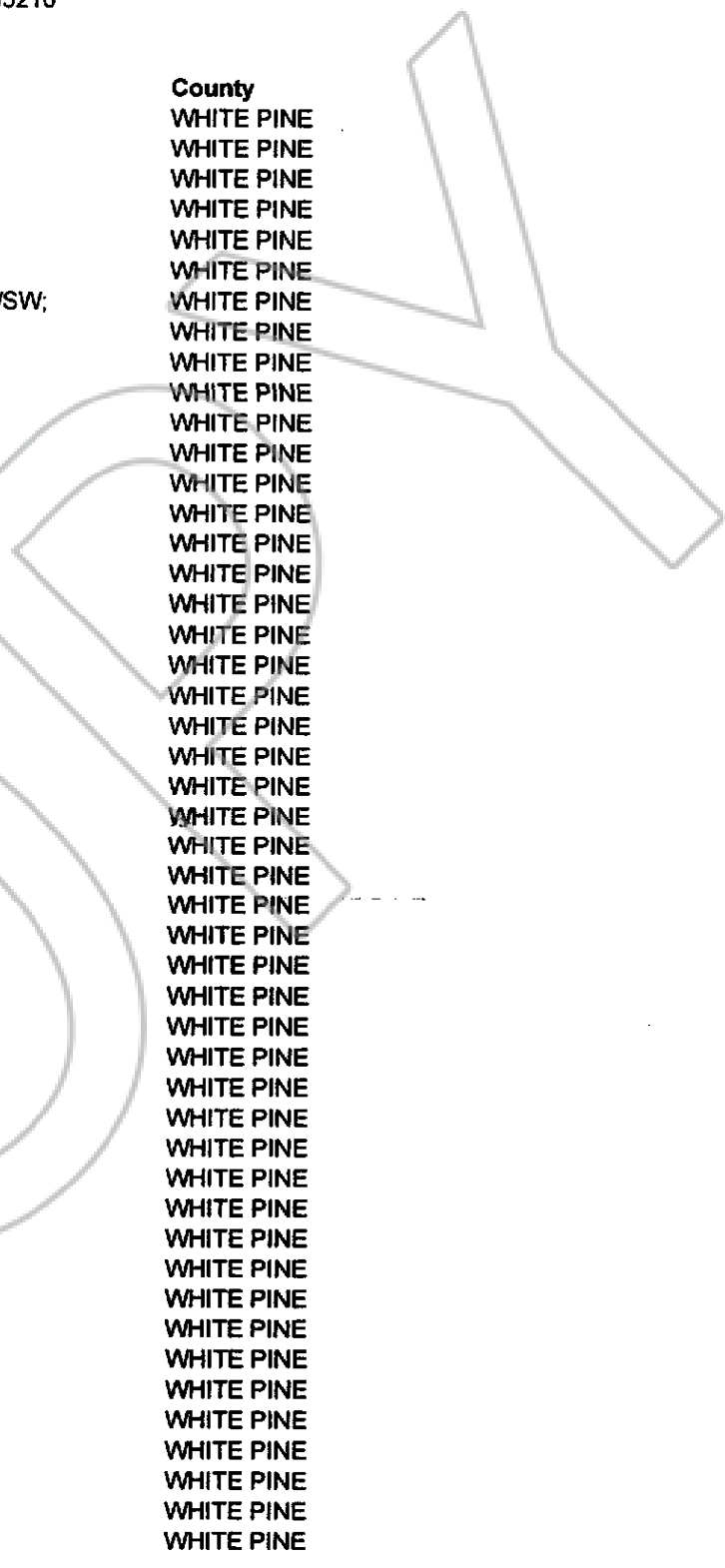



EXHIBIT A
Southwest Intertie Project
Great Basin Transmission, LLC
N-85210

| Township | Range | Section | Subdivision | County |
|----------|-------|---------|-------------------------------|------------|
| 15N | 61E | 28 | E2E2; | WHITE PINE |
| 15N | 61E | 33 | E2E2; | WHITE PINE |
| 15N | 64E | 10 | W2NW, SENW, NESW, W2SE, SESE; | WHITE PINE |
| 16N | 61E | 06 | SENE, E2SE; | WHITE PINE |
| 16N | 61E | 06 | 1; | WHITE PINE |
| 16N | 61E | 07 | E2E2; | WHITE PINE |
| 16N | 61E | 18 | E2E2; | WHITE PINE |
| 16N | 61E | 19 | E2E2; | WHITE PINE |
| 16N | 61E | 19 | NWSE, SWSE; | WHITE PINE |
| 16N | 61E | 19 | NWNE, SWNE; | WHITE PINE |
| 16N | 61E | 30 | E2E2; | WHITE PINE |
| 16N | 61E | 30 | NWNE, SWNE; | WHITE PINE |
| 16N | 61E | 30 | NWSE, SWSE; | WHITE PINE |
| 16N | 61E | 31 | NENE; | WHITE PINE |
| 16N | 61E | 31 | NESE; | WHITE PINE |
| 16N | 61E | 31 | SENE; | WHITE PINE |
| 16N | 61E | 32 | SWNW, W2SW; | WHITE PINE |
| 17N | 61E | 06 | SENE, E2SE; | WHITE PINE |
| 17N | 61E | 06 | 1; | WHITE PINE |
| 17N | 61E | 07 | E2E2; | WHITE PINE |
| 17N | 61E | 18 | E2E2; | WHITE PINE |
| 17N | 61E | 19 | E2E2; | WHITE PINE |
| 17N | 61E | 30 | E2E2; | WHITE PINE |
| 17N | 61E | 31 | E2NE, NESE; | WHITE PINE |
| 17N | 61E | 31 | 4; | WHITE PINE |
| 18N | 61E | 19 | NENE, SENE; | WHITE PINE |
| 18N | 61E | 19 | NESE, SESE; | WHITE PINE |
| 18N | 61E | 20 | W2W2; | WHITE PINE |
| 18N | 61E | 29 | W2W2; | WHITE PINE |
| 18N | 61E | 30 | NESE, SESE; | WHITE PINE |
| 18N | 61E | 30 | NENE, SENE; | WHITE PINE |
| 18N | 61E | 31 | 6, 7, 14; | WHITE PINE |
| 18N | 61E | 31 | NENE, SENE; | WHITE PINE |
| 18N | 61E | 32 | W2NW; | WHITE PINE |
| 18N | 61E | 32 | 12; | WHITE PINE |
| 18N | 61E | 32 | 4, 5; | WHITE PINE |

This grant also includes the following:

- Robinson Summit Substation Site, SW1/4 Sect 20, T18N, R61E, MDB&M
- Dry Lake Substation Site, SW1/4 Sect 7, T17S, R64E, MDB&M
- Copper Communication Site, SW1/4 NE1/4 Sect 27, T17N, R61E, MDB&M
- Highland Peak Communication Site, NW1/4 NE1/4 Sect 3, T1S, R66E, MDB&M
- Glendale Communication Site, SE1/4 Sect 29, T14S, R67E, MDB&M
- Delamar Valley Series Compensation Station – If station required, specific location to be selected and a separate environmental assessment to be prepared.



STANDARD STIPULATIONS
EXHIBIT B
GREAT BASIN TRANSMISSION (GBT), (N-85210, N-85211)
SWIP POWERLINE

1. Hereinafter, holder means any party granted this right-of-way and/or temporary use permit, its agents, contractors, representatives, or other persons directed by holder to construct, maintain, repair, restore, relinquish, abandon, modify, rehabilitate, or terminate this right-of-way, and holder's successors, or assigns.
2. This grant is subject to all valid rights existing on the effective date of this grant.
3. There is reserved to the authorized officer, the right to grant additional rights-of-way or permits for compatible use on, over, under, or adjacent to the land involved in this grant.
4. The holder shall maintain the right-of-way in a sanitary condition at all times during construction, maintenance or other operations during the term of this right-of-way. Any waste material, to include all discarded matter, will be disposed of promptly at a State of Nevada approved sanitary landfill site by the holder. "Waste" means all discarded matter including human waste, trash, garbage, refuse, oil drums, petroleum products, ashes, and equipment.
5. The holder shall comply with all applicable Federal laws and regulations existing or hereafter enacted or promulgated. In any event, the holder shall comply with the Toxic Substances Control Act of 1976 as amended, 15 U.S.C. 2601 et. seq. (1982) with regards to any toxic substances that are used, generated by, or stored on the right-of-way or on facilities authorized under this right-of-way grant. (See 40 CFR, Part 702-799 and especially, provisions on polychlorinated biphenyls, 40 CFR 761.1-761.193.) Additionally, any release of toxic substances (leaks, spills, etc.) in excess of the reportable quantity established by 40 CFR, Part 117 shall be reported as required by the Comprehensive Environmental Response, Compensation, and Liability Act, Section 102b. A copy of any report required or requested by any Federal agency or State government as a result of a reportable release or spill of any toxic substances shall be furnished to the authorized officer concurrent with the filing of the reports to the involved Federal agency or State government.
6. Any relocation, additional construction, or use that is not in accord with the right-of-way grant, shall not be initiated without prior written approval of the authorized officer.
7. Holder may not construct or make new access roads or travel cross-country by vehicle to reach the grant area unless prior written approval is given by the Authorized Officer.
8. The holder shall conduct all activities directly or indirectly associated with the construction, maintenance, operation, and termination of the right-of-way within the authorized limits of the right-of-way.
9. Any cultural and/or paleontological resource (historic or prehistoric site or object) discovered by the holder, or any person working on his behalf, on public or Federal land shall be immediately reported to the authorized officer. Holder shall suspend all operations in the immediate area of such discovery until written authorization to proceed is issued by the authorized officer. An evaluation of the discovery will be made by the authorized officer to determine appropriate actions to prevent the loss of significant cultural or scientific values. The holder will be responsible for the cost of evaluation and any decision as to proper mitigation measures will be made by the authorized officer after consulting with the holder.



10. The holder shall be fully liable to the United States for any damage or injury incurred by the United States in connection with the use and occupancy of the right-of-way area by the holder. The holder shall fully indemnify the United States for liability, damage, or claims arising in connection with the holder's use and occupancy of the right-of-way area.
11. No less than 60 days prior to termination of the right-of-way, the holder shall contact the authorized officer to arrange a joint inspection of the right-of-way. The inspection will be held to agree to an acceptable termination (and rehabilitation) plan. The authorized officer must approve the plan in writing prior to the holder commencing any termination activities.

SPECIAL STIPULATIONS

1. GBT will comply with and be bound by all terms and conditions of the original ROW grant (casefile N-49781) issued to Idaho Power Co. on December 8, 1994, which are applicable to the portion being assigned to GBT.
2. GBT will comply with the Construction, Operation and Maintenance Plan as approved by BLM for each portion of the ROW grant being assigned to GBT in compliance with the stipulations for casefile N-49781.



0132941

Book: 245 11/21/2008
Page: 690 Page: 28 of 28

BOOK513 **PAGE**496

COPY



United States Department of the Interior

BUREAU OF LAND MANAGEMENT
Ely District Office
HC33 Box 33500 (702 N. Industrial Way)
Ely, Nevada 89301-9408
http://www.blm.gov/nv/st/en/fo/cly_field_office.html



2850 (NV-043)
NVN-49781, IDI-26446, NVN-85211

CERTIFIED MAIL NO. 7006 0810 0005 7120 7145 - RETURN RECEIPT REQUESTED

DECISION

MAY 30 2008

Assignee

Great Basin Transmission, LLC
c/o LS Power Development, LLC
400 Chesterfield Center, Ste. 110
St. Louis, Missouri 63017

: FLPMA Title V
: Transmission Power Line
: Right-of-Way

Assignor

Idaho Power Company
1221 West Idaho
Boise, ID 83702

PARTIAL ASSIGNMENT ISSUED

On December 8, 1994 Right-of-Way Grant (ROW) NVN-49781 was issued to Idaho Power Company (IPC) for an electrical transmission line, substation sites, series compensation station sites, and communication sites for the Southwest Intertie Project (SWIP). On May 23, 2008, the Bureau of Land Management (BLM) received a letter from Idaho Power Company requesting a partial assignment of the above mentioned ROW Grant to Great Basin Transmission, LLC (GBT). Also received was an application (SF299) from GBT requesting partial assignment of the same ROW Grant.

This assignment covers the portion of the ROW that extends north from the southern boundary of T. 18 N., R. 61 E., Sections 17 and 18 to the northern boundary of T. 21. N., R. 63 E., Section 2, which is all located in White Pine County, Nevada. Attached to the Assignment Decision is the legal description (Exhibit A) of the section of the SWIP line being assigned. Also attached are the original stipulations contained in the IPC ROW, along with additional stipulations (Exhibit B) that have been added to the new ROW Grant.

You must pay a fee to BLM for the costs we will incur in monitoring the construction and operation of your authorized use. These fees will be charged to the Cost Recovery Account set up for this project.



Rent for use of public lands must also be paid in advance of such use and prior to issuance of the ROW grant. Rent for a linear right-of-way is based on a schedule that is adjusted annually based on the Implicit Price Deflator (IPD), an inflation index. Rent will be billed on January 1 of each year and will be due within 30 days of receipt of the statement.

If you have any questions, please call Brenda Linnell at (775) 289-1808 or e-mail to Brenda_Linnell@nv.blm.gov.

Sincerely,
for [Signature]

John F. Ruhs
District Manager
Ely District Office

Cc: Idaho Power Company
Frederick Marcell (NV-060), Las Vegas DO
Allen Marituch (NV-010), Elko DO

Enclosures

Map
Exhibit A, Legal Description
Exhibit B, Stipulations

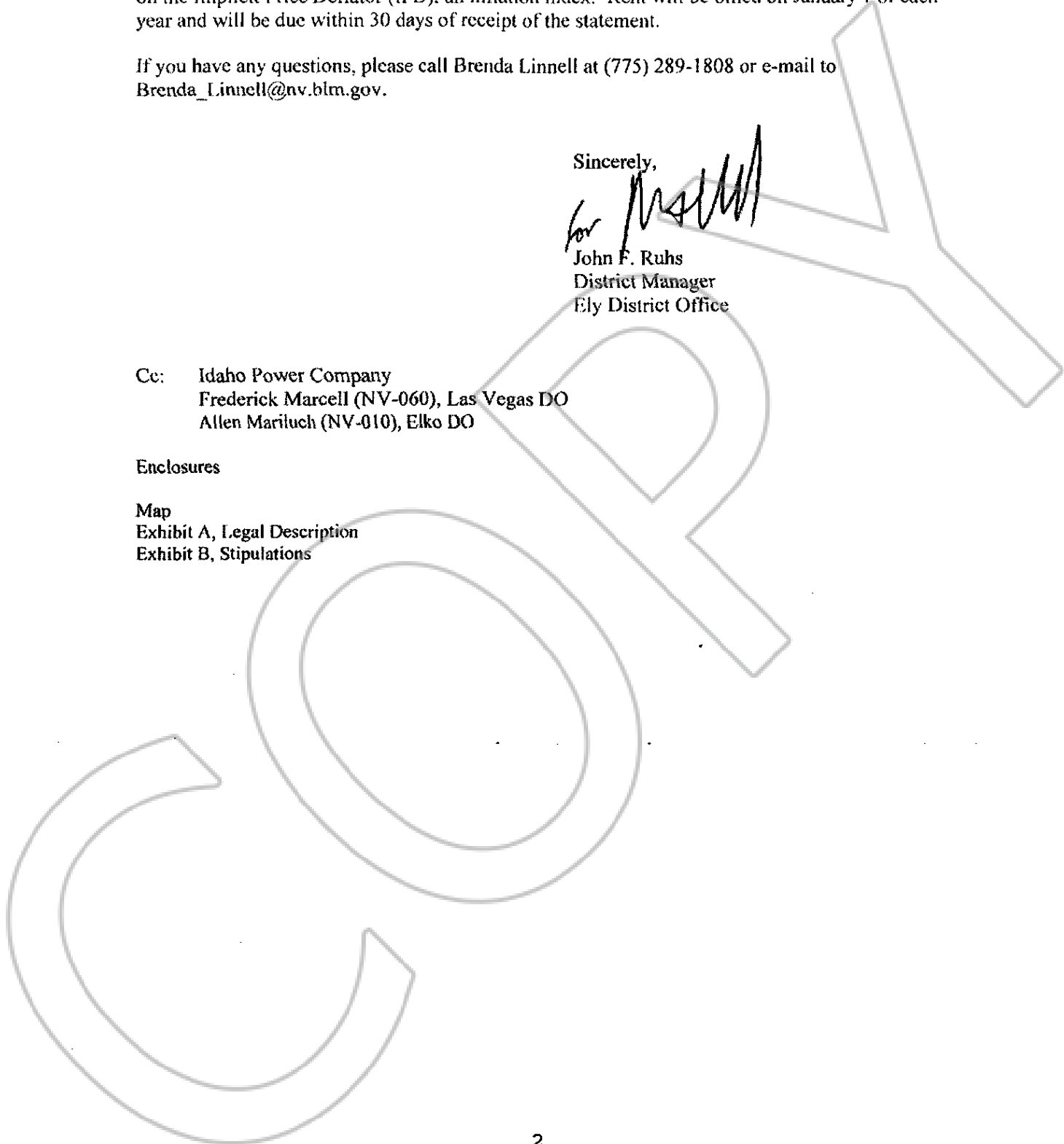



0132941

Book 245

11/21/2008

Page: 702

Page 31 of 35

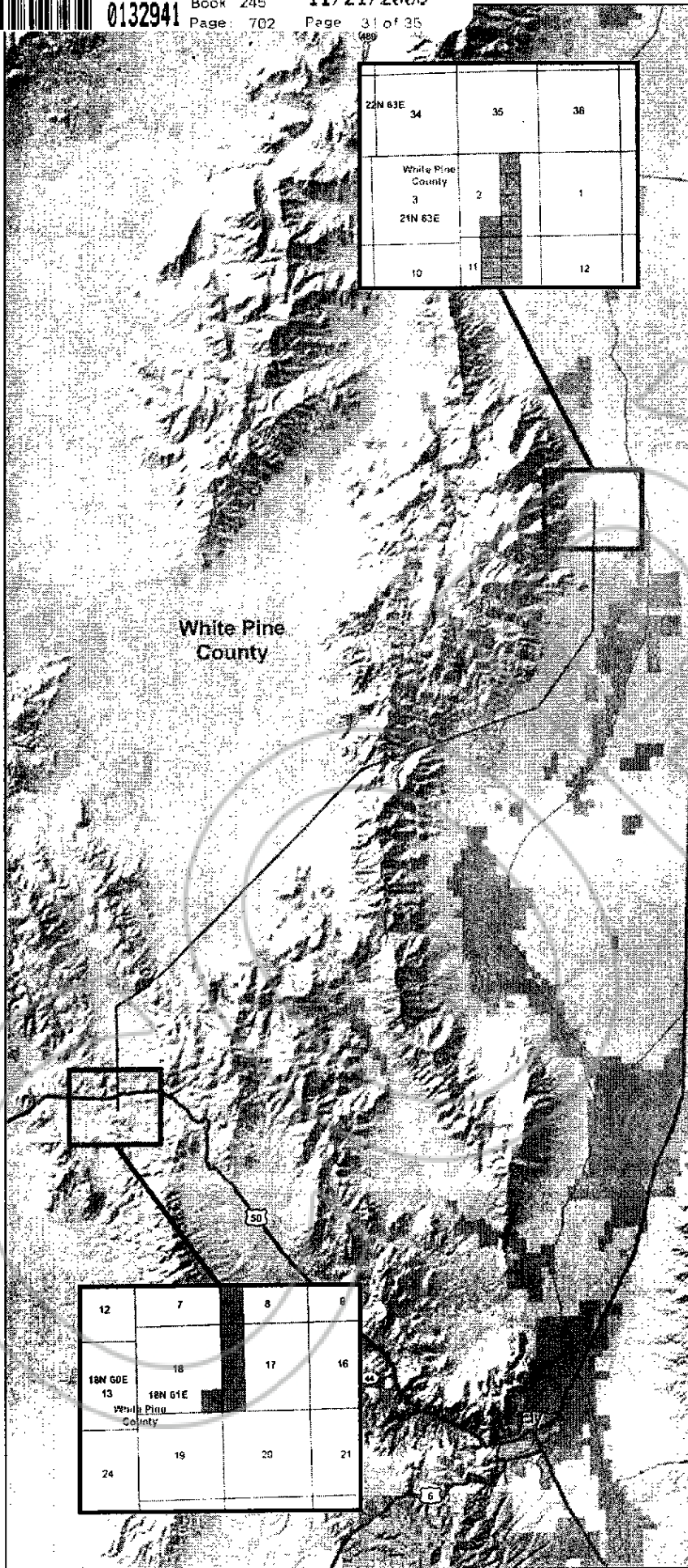

**SWIP Middle
Great Basin Transmission
N-85211**

May 2008

Legend

- SWIP Middle
- ROW Grant QQ Sections
- BLM Land
- Township
- Section

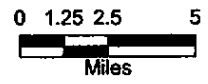



EXHIBIT A
Southwest Intertie Project
Great Basin Transmission, LLC
N-85211

| Township | Range | Section | Subdivision | County |
|----------|-------|---------|---------------------------|------------|
| 18N | 61E | 05 | W2W2; | WHITE PINE |
| 18N | 61E | 08 | W2W2; | WHITE PINE |
| 18N | 61E | 17 | W2W2; | WHITE PINE |
| 18N | 61E | 18 | SESE; | WHITE PINE |
| 19N | 61E | 01 | SESE; | WHITE PINE |
| 19N | 61E | 11 | SESE; | WHITE PINE |
| 19N | 61E | 12 | N2NE,SWNE,N2SW,SWSW; | WHITE PINE |
| 19N | 61E | 12 | SENE,SESW; | WHITE PINE |
| 19N | 61E | 12 | NWSE,SESW; | WHITE PINE |
| 19N | 61E | 13 | NWNW; | WHITE PINE |
| 19N | 61E | 14 | N2NE,SWNE; | WHITE PINE |
| 19N | 61E | 14 | SENE,SESW,NWSE; | WHITE PINE |
| 19N | 61E | 14 | SENE,NESW,NWSW; | WHITE PINE |
| 19N | 61E | 14 | SESW,SWSW; | WHITE PINE |
| 19N | 61E | 15 | SESE; | WHITE PINE |
| 19N | 61E | 21 | SESE; | WHITE PINE |
| 19N | 61E | 22 | SWNE,N2SW,SWSW; | WHITE PINE |
| 19N | 61E | 22 | N2NE,SENE,SESW; | WHITE PINE |
| 19N | 61E | 22 | NWSE,SESW; | WHITE PINE |
| 19N | 61E | 23 | NWNW; | WHITE PINE |
| 19N | 61E | 27 | NWNW | WHITE PINE |
| 19N | 61E | 28 | SESW; | WHITE PINE |
| 19N | 61E | 28 | N2NE,SWNE,N2SW,SWSW; | WHITE PINE |
| 19N | 61E | 29 | S2S2; | WHITE PINE |
| 19N | 61E | 32 | W2W2; | WHITE PINE |
| 19N | 61E | 32 | NWNE,NENW,SESW; | WHITE PINE |
| 19N | 62E | 05 | 4; | WHITE PINE |
| 19N | 62E | 06 | S2NE,E2SW,NWSE; | WHITE PINE |
| 19N | 62E | 06 | 1,7; | WHITE PINE |
| 19N | 62E | 07 | 1; | WHITE PINE |
| 20N | 62E | 13 | SWSE; | WHITE PINE |
| 20N | 62E | 13 | NESW,S2SW,N2SE; | WHITE PINE |
| 20N | 62E | 14 | S2SE; | WHITE PINE |
| 20N | 62E | 22 | NENE; | WHITE PINE |
| 20N | 62E | 22 | S2NE,NESW,S2SW,NWSE; | WHITE PINE |
| 20N | 62E | 23 | NENE; | WHITE PINE |
| 20N | 62E | 23 | NWNE,N2NW; | WHITE PINE |
| 20N | 62E | 27 | NWNW; | WHITE PINE |
| 20N | 62E | 28 | NENE,S2NE,NESW,S2SW,NWSE; | WHITE PINE |
| 20N | 62E | 32 | NWSE | WHITE PINE |
| 20N | 62E | 32 | SESW; | WHITE PINE |
| 20N | 62E | 32 | N2NE,SWNE,N2SW,SWSW; | WHITE PINE |
| 20N | 62E | 32 | SENE,SESW,NESE; | WHITE PINE |
| 20N | 62E | 33 | NWNW; | WHITE PINE |
| 20N | 63E | 02 | NWNE; | WHITE PINE |
| 20N | 63E | 02 | NWSE; | WHITE PINE |
| 20N | 63E | 02 | NENE,S2NE,NESW,S2SW,NESE; | WHITE PINE |
| 20N | 63E | 08 | SESW,S2SE; | WHITE PINE |

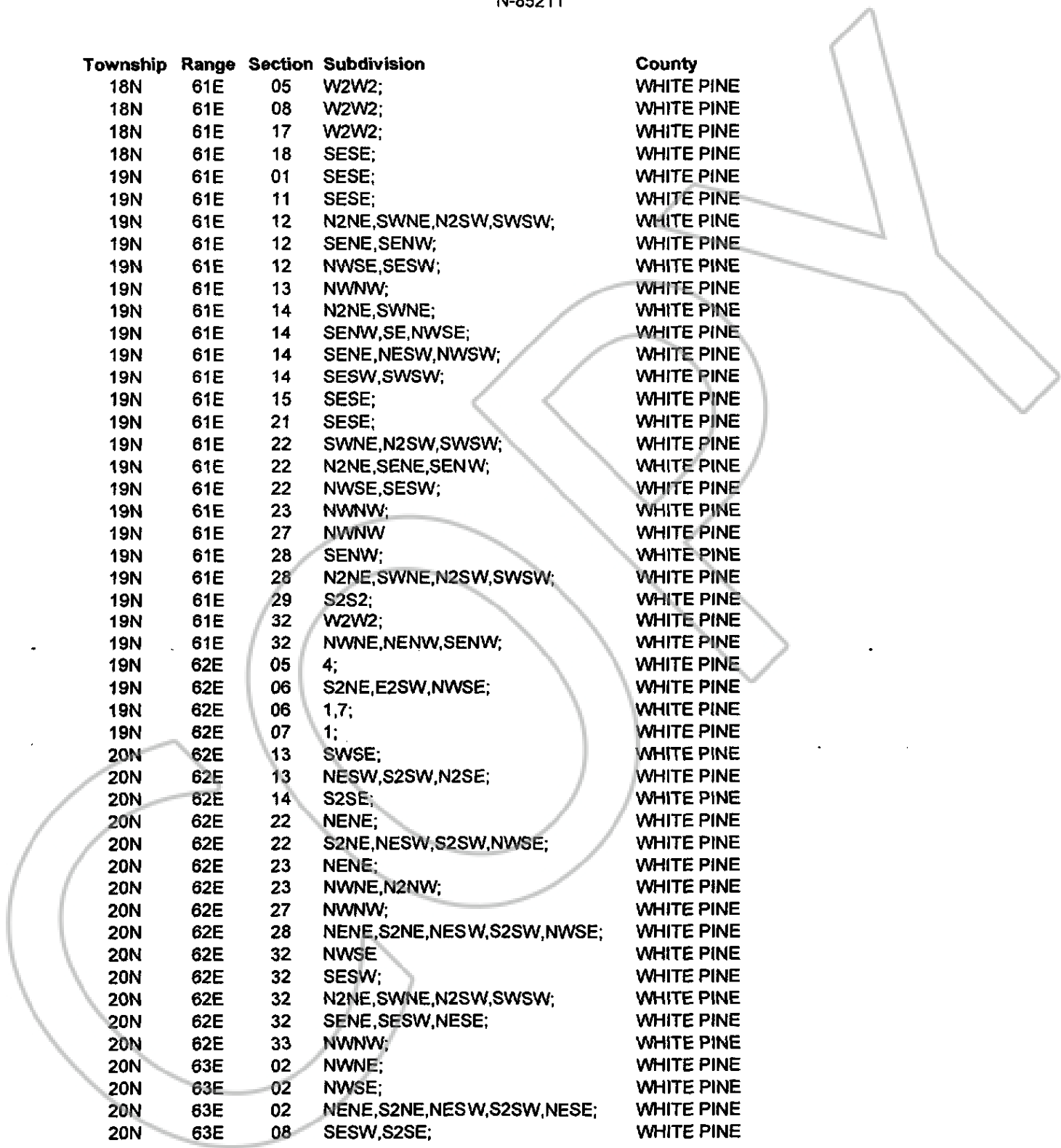
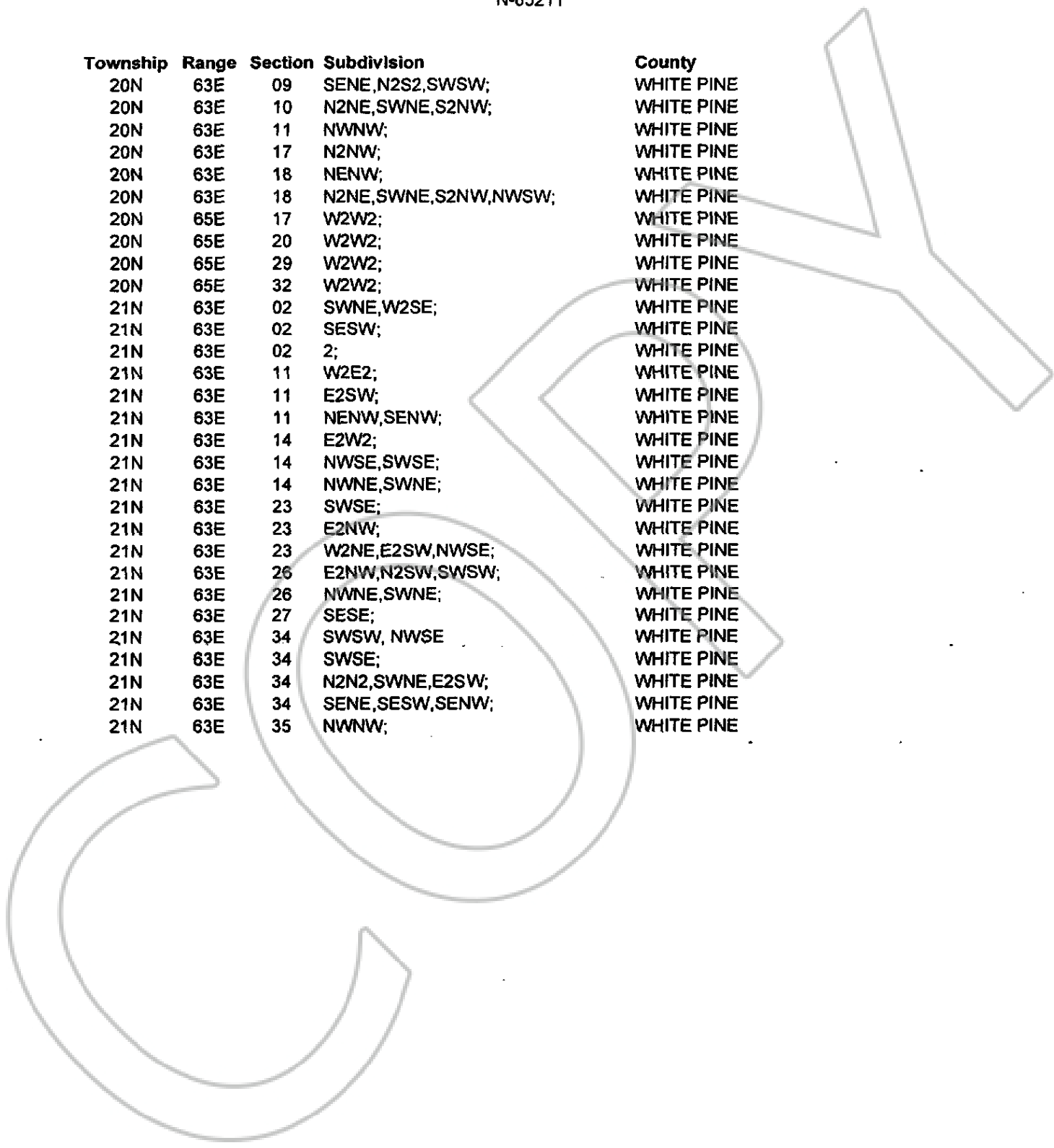



EXHIBIT A
 Southwest Intertie Project
 Great Basin Transmission, LLC
 N-85211

| Township | Range | Section | Subdivision | County |
|----------|-------|---------|----------------------|------------|
| 20N | 63E | 09 | SENE,N2S2,SWSW; | WHITE PINE |
| 20N | 63E | 10 | N2NE,SWNE,S2NW; | WHITE PINE |
| 20N | 63E | 11 | NWNW; | WHITE PINE |
| 20N | 63E | 17 | N2NW; | WHITE PINE |
| 20N | 63E | 18 | NENW; | WHITE PINE |
| 20N | 63E | 18 | N2NE,SWNE,S2NW,NWSW; | WHITE PINE |
| 20N | 65E | 17 | W2W2; | WHITE PINE |
| 20N | 65E | 20 | W2W2; | WHITE PINE |
| 20N | 65E | 29 | W2W2; | WHITE PINE |
| 20N | 65E | 32 | W2W2; | WHITE PINE |
| 21N | 63E | 02 | SWNE,W2SE; | WHITE PINE |
| 21N | 63E | 02 | SESW; | WHITE PINE |
| 21N | 63E | 02 | 2; | WHITE PINE |
| 21N | 63E | 11 | W2E2; | WHITE PINE |
| 21N | 63E | 11 | E2SW; | WHITE PINE |
| 21N | 63E | 11 | NENW,SENW; | WHITE PINE |
| 21N | 63E | 14 | E2W2; | WHITE PINE |
| 21N | 63E | 14 | NWSE,SWSE; | WHITE PINE |
| 21N | 63E | 14 | NWNE,SWNE; | WHITE PINE |
| 21N | 63E | 23 | SWSE; | WHITE PINE |
| 21N | 63E | 23 | E2NW; | WHITE PINE |
| 21N | 63E | 23 | W2NE,E2SW,NWSE; | WHITE PINE |
| 21N | 63E | 26 | E2NW,N2SW,SWSW; | WHITE PINE |
| 21N | 63E | 26 | NWNE,SWNE; | WHITE PINE |
| 21N | 63E | 27 | SESE; | WHITE PINE |
| 21N | 63E | 34 | SWSW, NWSE | WHITE PINE |
| 21N | 63E | 34 | SWSE; | WHITE PINE |
| 21N | 63E | 34 | N2N2,SWNE,E2SW; | WHITE PINE |
| 21N | 63E | 34 | SENE,SESW,SENW; | WHITE PINE |
| 21N | 63E | 35 | NWNW; | WHITE PINE |





STANDARD STIPULATIONS
EXHIBIT B
GREAT BASIN TRANSMISSION (GBT), (N-85210, N-85211)
SWIP POWERLINE

1. Hereinafter, holder means any party granted this right-of-way and/or temporary use permit, its agents, contractors, representatives, or other persons directed by holder to construct, maintain, repair, restore, relinquish, abandon, modify, rehabilitate, or terminate this right-of-way, and holder's successors, or assigns.
2. This grant is subject to all valid rights existing on the effective date of this grant.
3. There is reserved to the authorized officer, the right to grant additional rights-of-way or permits for compatible use on, over, under, or adjacent to the land involved in this grant.
4. The holder shall maintain the right-of-way in a sanitary condition at all times during construction, maintenance or other operations during the term of this right-of-way. Any waste material, to include all discarded matter, will be disposed of promptly at a State of Nevada approved sanitary landfill site by the holder. "Waste" means all discarded matter including human waste, trash, garbage, refuse, oil drums, petroleum products, ashes, and equipment.
5. The holder shall comply with all applicable Federal laws and regulations existing or hereafter enacted or promulgated. In any event, the holder shall comply with the Toxic Substances Control Act of 1976 as amended, 15 U.S.C. 2601 et. seq. (1982) with regards to any toxic substances that are used, generated by, or stored on the right-of-way or on facilities authorized under this right-of-way grant. (See 40 CFR, Part 702-799 and especially, provisions on polychlorinated biphenyls, 40 CFR 761.1-761.193.) Additionally, any release of toxic substances (leaks, spills, etc.) in excess of the reportable quantity established by 40 CFR, Part 117 shall be reported as required by the Comprehensive Environmental Response, Compensation, and Liability Act, Section 102b. A copy of any report required or requested by any Federal agency or State government as a result of a reportable release or spill of any toxic substances shall be furnished to the authorized officer concurrent with the filing of the reports to the involved Federal agency or State government.
6. Any relocation, additional construction, or use that is not in accord with the right-of-way grant, shall not be initiated without prior written approval of the authorized officer.
7. Holder may not construct or make new access roads or travel cross-country by vehicle to reach the grant area unless prior written approval is given by the Authorized Officer.
8. The holder shall conduct all activities directly or indirectly associated with the construction, maintenance, operation, and termination of the right-of-way within the authorized limits of the right-of-way.
9. Any cultural and/or paleontological resource (historic or prehistoric site or object) discovered by the holder, or any person working on his behalf, on public or Federal land shall be immediately reported to the authorized officer. Holder shall suspend all operations in the immediate area of such discovery until written authorization to proceed is issued by the authorized officer. An evaluation of the discovery will be made by the authorized officer to determine appropriate actions to prevent the loss of significant cultural or scientific values. The holder will be responsible for the cost of evaluation and any decision as to proper mitigation measures will be made by the authorized officer after consulting with the holder.



10. The holder shall be fully liable to the United States for any damage or injury incurred by the United States in connection with the use and occupancy of the right-of-way area by the holder. The holder shall fully indemnify the United States for liability, damage, or claims arising in connection with the holder's use and occupancy of the right-of-way area.
11. No less than 60 days prior to termination of the right-of-way, the holder shall contact the authorized officer to arrange a joint inspection of the right-of-way. The inspection will be held to agree to an acceptable termination (and rehabilitation) plan. The authorized officer must approve the plan in writing prior to the holder commencing any termination activities.

SPECIAL STIPULATIONS

1. GBT will comply with and be bound by all terms and conditions of the original ROW grant (casefile N-49781) issued to Idaho Power Co. on December 8, 1994, which are applicable to the portion being assigned to GBT.
2. GBT will comply with the Construction, Operation and Maintenance Plan as approved by BLM for each portion of the ROW grant being assigned to GBT in compliance with the stipulations for casefile N-49781.