

OWNER'S CERTIFICATE

We, of the Clover Creek Properties, certify that we are the owners of the lands being divided within the boundary shown herein, consent to the preparation and recordation of this final plat and have caused the same to be surveyed and platted into lots, streets and easements as shown herein and do hereby offer to dedicate to the City of Caliente and its successors and assigns all public streets, public rights of ways or easements of drainage or access, which the Caliente City Council accept in whole or in part at any time.

Samuel L. Moore *Paul Steed*

Samuel L. Moore Paul Steed

Lane Truman Title *8/12/08* Date

ACKNOWLEDGEMENT

STATE OF NEVADA) ss
COUNTY OF LINCOLN)

This instrument was acknowledged before me on 7th Aug. 2008 by Lane Truman, freely and voluntarily for the purposes stated.

Crystal Boudreau My commission expires Nov. 30, 2011

Notary public



SURVEYOR'S CERTIFICATE

I, Lenard D. Smith, a Professional Land Surveyor licensed in the State of Nevada, certify that:

- This plat represents the results of a survey conducted under my direct supervision at the instance of Clover Creek Properties LLC.
- The lands surveyed lie within Section 7, Township 4 South, Range 67 East, M.D.M. The survey was completed on Aug 24, 2008.
- This plat complies with the applicable state statutes and any local ordinances in effect on the date that the governing body gave its final approval.
- The monuments depicted on the plat are of the character shown, occupy the positions indicated and are of sufficient number and durability.

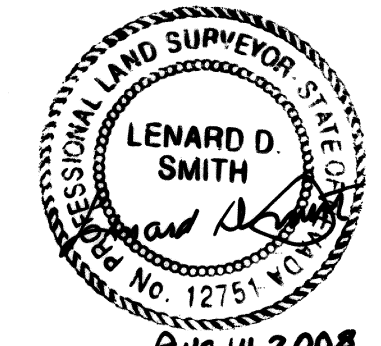

Lenard D. Smith P.L.S. 12751 Exp. June 30, 2009
Aug 14, 2008
2010

RECORDERS CERTIFICATE

DOC # 0132544
08/25/2008 07:36 AM
Official Record
Recording requested by
LCSW: 59111
Lincoln County - NV
Leslie Boucher - Recorder
Fee: \$21.00 Page: 1 of 1
Recorded By: DP
Book: C Page: 0425
0132544

CALIENTE CITY PLANNING COMMISSION

At the regular meeting of the Caliente City Planning Commission meeting held this 12 day of August, 2008, this map was examined and recommended for approval.

[Signature]
Chairman

CALIENTE CITY COUNCIL

At the regular meeting of the Caliente City Council meeting held this 21st day of August, 2008, this map was examined and approved for recordation.

Kurt J. Phillips, Mayor
Chairman

Patricia Kelly Attest
City Clerk

BASIS OF BEARINGS

The Basis of bearings is the south line of sec. 7 T. 4 S., R. 67 E., M.D.M. based on BLM Dependent Resurvey approved October 2, 2001 given as N 88°52'20" W

MAP REFERENCES

Record of Survey by Owen's Surveying Outfit Inc. found Plat Book B, Page 266A of Lincoln County, Nevada Records
BLM Dependent Resurvey conducted in 1994-5
Record of Survey by Lenard Smith Land Survey, Plat Book C, Page 132 of Lincoln County, Nevada Records
Parcel Map by Lenard Smith Land Survey, Plat Book C, Page 161
Merger and Reparceling Map Plat Book C, Page 406

LINCOLN COUNTY ASSESSOR APPROVAL

I hereby certify that the ownership information contained hereon is correct and all owners have signed.

Melanie K. McBride 7-29-08
Lincoln County Assessor Date

LINCOLN COUNTY TREASURER APPROVAL

Pursuant to NRS 278.468 I hereby certify that the taxes for the fiscal year 2007-2008 on Assessor Parcel Number 003-151-17 Assessed \$ 172,622 are paid in full.

Kathy C. New 8-29-08
Lincoln County Treasurer and Ex-officio Tax Receiver Date

LINCOLN COUNTY RECORDER APPROVAL

Pursuant to NRS 278.467 and 278.468, I hereby certify that this map was recorded within 1 year of the Lincoln County Planning Commission approval, the map is in an acceptable form for recording, the treasurer's signature date matches the fiscal year of recordation and that all fees have been paid for the recordation of this document.

Dorothy R. Porter, Deputy 8-29-08
Lincoln County Recorder Date

APN 003-151-17

Subsequent Parcel Map, Dividing Parcel 5 of the Parcel Map Merger and Reparceling Map, Plat Book C at Page 406

For Clover Creek Properties LLC

In Section 7, Township 4 South, Range 67 East, Mount Diablo Meridian, in the City of Caliente, Lincoln County, Nevada



Lenard Smith Land Survey
509 Main Street
P.O. Box 443
Caliente, Nevada 89008
Phone/Fax 775 726 3365
Cell Phone 775 962 1196