

**OWNER'S CERTIFICATE**

We, of the Clover Creek Properties, certify that we are the owners of the lands being divided within the boundary shown herein, consent to the preparation and recording of this final plat and have caused the same to be surveyed and platted into lots, streets and easements as shown herein and do hereby offer to dedicate to the City of Caliente and its successors and assigns all public streets, public rights of ways or easements of drainage or access, which the Caliente City Council accept in whole or in part at any time.

*Samuel L. Moore* 8/2/08 *Paul Steed* 8/2/08  
 Samuel L. Moore Paul Steed  
 Lane Truman Title Date

**ACKNOWLEDGEMENT**

STATE OF NEVADA )  
 COUNTY OF LINCOLN ) ss  
 This instrument was acknowledged before me on 7th Aug 2008 by Lane Truman, freely and voluntarily for the purposes stated.  
*Crystal Boudreau* My commission expires Mar 26, 2011  
 Notary Public

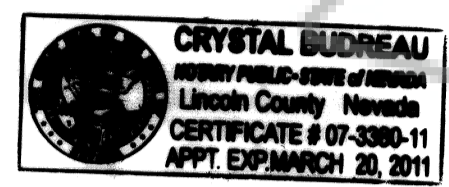

**SURVEYOR'S CERTIFICATE**

I, Lenard D. Smith, a Professional Land Surveyor licensed in the State of Nevada, certify that:  
 1. This plat represents the results of a survey conducted under my direct supervision at the instance of Clover Creek Properties LLC.  
 2. The lands surveyed lie within Section 7, Township 4 South, Range 67 East, M.D.M. The survey was completed on Aug 25, 2008.  
 3. This plat complies with the applicable state statutes and any local ordinances in effect on the date that the governing body gave its final approval.  
 4. The monuments depicted on the plat are of the character shown, occupy the positions indicated and are of sufficient number and durability.

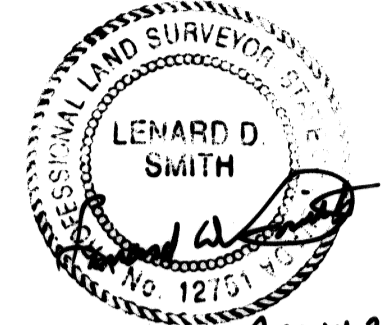

Lenard D. Smith P.L.S. 12751 Exp. June 30, 2010

**RECORDERS CERTIFICATE**

DOC # 0132543  
 01:25 PM  
**Official Record**  
 Recording requested by  
 Lenard D. Smith  
 Lincoln County - NV  
 Leslie Boucher - Recorder  
 Fee \$21.00 Page 1 of 1  
 RPT# Recorded By DP  
 Book - C Page - 0424  
 0132543

**CALIENTE CITY PLANNING COMMISSION**

At the regular meeting of the Caliente City Planning Commission held this 12 day of August, 2008, this map was examined and recommended for approval.

*Chairman*

**CALIENTE CITY COUNCIL**

At the regular meeting of the Caliente City Council meeting held this 21 day of August, 2008, this map was examined and approved for recording.

*Kevin J. Phillips, Mayor*  
 Chairman

*Patricia Lytle, Attest*  
 City Clerk

**BASIS OF BEARINGS**

The Basis of bearings is the south line of sec. 7 T. 4 S. R. 67 E., M.D.M. based on BLM Dependent Resurvey approved October 2, 2001 given as N 88° 52' 20" W

**MAP REFERENCES**

Record of Survey by Owen's Surveying Outfit Inc. found Plat Book B, Page 266A of Lincoln County, Nevada Records  
 BLM Dependent Resurvey conducted in 1994-5  
 Record of Survey by Lenard Smith Land Survey, Plat Book C, Page 132 of Lincoln County, Nevada Records  
 Parcel Map by Lenard Smith Land Survey, Plat Book C, Page 161

**LINCOLN COUNTY ASSESSOR APPROVAL**

I hereby certify that the ownership information contained hereon is correct and all owners have signed.  
*Stelanie K. McBride* 8-29-08  
 Lincoln County Assessor

**LINCOLN COUNTY TREASURER APPROVAL**

Pursuant to NRS 278.468 I hereby certify that the taxes for the fiscal year 2007-2008 on Assessor Parcel Number 003-151-16 Assessed \$ 323.76 are paid in full.  
*Kathy C. Hest* 8-29-08  
 Lincoln County Treasurer and Ex-officio Tax Receiver

**LINCOLN COUNTY RECORDER APPROVAL**

Pursuant to NRS 278.467 and 278.468, I hereby certify that this map was recorded within 1 year of the Lincoln County Planning Commission approval, the map is in an acceptable form for recording, the treasurer signature date matches the fiscal year of recordation and that all fees have been paid for the recordation of this document.  
*Darby R. Porter, Deputy* 8-29-08  
 Lincoln County Recorder

**LEGEND**

- Property line
- Property line on chain link fence
- - - center of section line
- - - centerline of U.S. Highway 93
- ○ ○ ○ ○ highway 93 guardrail for bridge
- SS-SS-SS-SS-SS sanitary sewer (lines between manholes assumed straight)
- W-W-W-W-W water line as noted
- - - power line
- Found #4 rebar with plastic cap stamped PLS 2884
- sanitary sewer manhole
- power pole
- ⊕ water box
- △ Found NDOT right of way monument
- Found #5 rebar & plastic cap stamped L SMITH PLS 12751
- Set #5 rebar & plastic cap stamped L SMITH PLS 12751
- R Recorded in Plat Book B, Page 266A

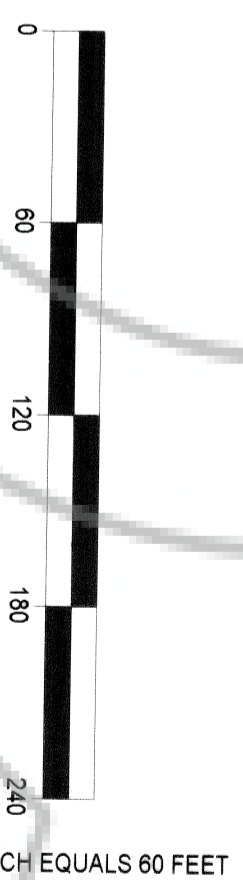

SCALE: 1 INCH EQUALS 60 FEET

Id	Delta	Radius	Length	Tangent
C6	05°34'11"	1040.00'	101.10'	50.59'
C7	05°34'11"	1040.00'	101.10'	50.59'
C8	0°10'29"	1040.00'	3.17'	1.59'
C9	05°34'11"	1040.00'	101.10'	50.59'
C10	3°34'31"	1040.00'	64.89'	32.46'

**Basis of Bearing**  
 N 88° 52' 20" W 5222.48'  
 BLM N 88° 52' 20" W 5222.45'

APN 003-151-16

**Subsequent Parcel Map, Dividing Parcel 6 of the Parcel Map merger and Reparceling Map, Plat Book C at Page 406**

**For Clover Creek Properties LLC**

In Section 7, Township 4 South, Range 67 East, Mount Diablo Meridian, in the City of Caliente, Lincoln County, Nevada

**Lenard Smith Land Survey**  
 509 Main Street  
 P.O. Box 443  
 Caliente, Nevada 89008  
 Phone/Fax 775 726 3365  
 Cell Phone 775 962 1196

Sheet 1 of 1