

R 56 E

R 57 E

TIE POINT: 1430 FEET SOUTH

707 FEET WEST

26

25

30

XX 30	XX 38	XX 46
XX 31	XX 39	XX 47
XX 32	XX 40	XX 48
XX 33	XX 41	XX 49
XX 34	XX 42	XX 50
XX 35	XX 43	XX 51
XX 36	XX 44	XX 52
XX 37	XX 45	XX 53
		XX 54
		XX 55
		XX 56

U.S.M.M. 326

35

36

31

XX 1	XX 7	XX 26	XX 19	XX 22	XX 58
XX 2	XX 8	XX 27	XX 20	XX 23	XX 59
XX 3	XX 9	XX 28	XX 21	XX 24	
XX 4	XX 10	XX 29	XX 25		
XX 5	XX 11				
XX 6	XX 12				
	XX 13				
	XX 14				
	XX 15				
	XX 16				
	XX 17				
	XX 18				

R 56 E
R 57 E

T 3 S

T 4 S

T 3 S

T 4 S

2

6

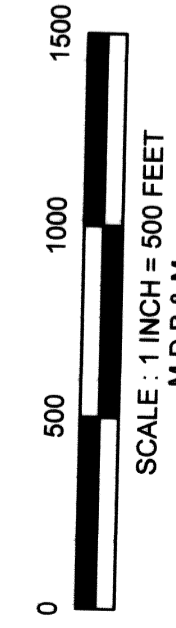
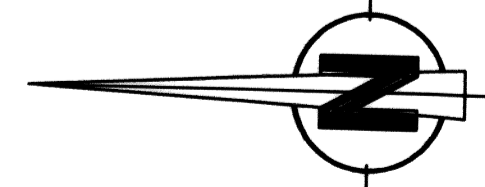

LOCATION DATES:

- MAY 27, 2008 XX 30-57
- MAY 28, 2008 XX 1-6, 11-25, & 58-59
- MAY 29, 2008 XX 7-10 & 26-29

TYPICAL CLAIM & CORNER NUMBERS

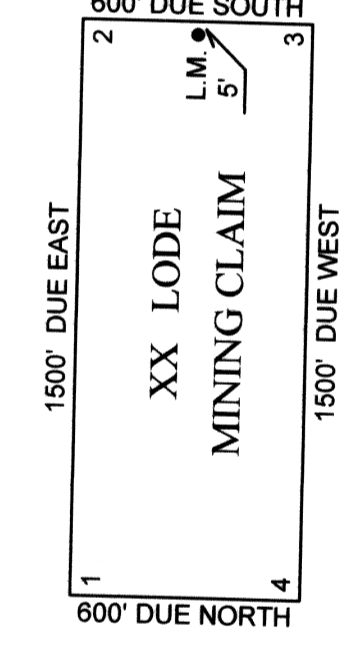

INDICATES A FOUND SECTION CORNER.

SECTION LINES ARE CONSTRUCTED FROM BLM CADASTRAL SURVEY (GCDB)
 TIE POINT FROM THE NE CORNER OF SECTION 25, T 3 S, R 56 E BEAR
 SOUTH 1430 FEET THEN WEST 707 FEET TO THE NW CORNER OF XX 30.

ALL CLAIMS ARE 600' WIDE X 1500' LONG UNLESS NOTED.
 ALL LOCATION MONUMENTS ARE 5' IN FROM THE END CENTER UNLESS NOTED.
 ALL LOCATION MONUMENTS AND CLAIM CORNERS ARE 1.5" X 1.5" X 4' WOOD POST.

WOLFRAM JACK MINING CORP
 15900 CASWELL LANE
 RENO, NEVADA 89511

DOC # 0132449
 of Record
 Lincoln County - NV
 Leslie Boucher - Recorder
 Page 1 of 1
 Book-253 Page-0550



XX LODGE MINING CLAIMS
 NUMBERS [1-59]
 SECTIONS 25, 35, 36; T3S, R56E M.D.B.&M.
 SECTIONS 30 & 31; T3S, R57E, M.D.B.&M.
 SECTIONS 1 & 2; T4S, R56E, M.D.B.&M.

LINCOLN COUNTY, NEVADA