

731000 732000 733000 734000 735000

EXPLANATION

- Public Land Survey
- Corner Post
- Location Monument
- Claim Boundary

Typical Claim
(not to scale)

Corner Posts are 1.5" x 1.5" x 4" wooden posts with scribed metal tag describing corner.

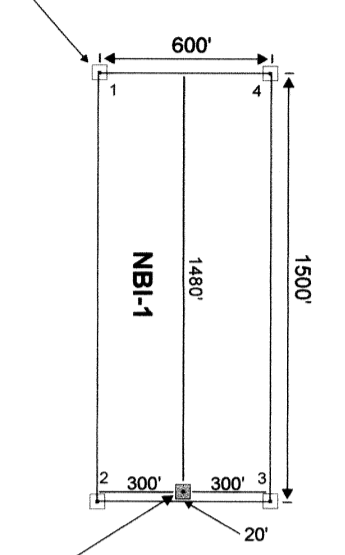

Location Monument is a 1.5" x 1.5" x 4" wooden post with location notice attached.

Claims NBI-6 through NBI-20, claims NBI-29 through NBI-41, claims NBI-65 through NBI-68, claims NBI-101 through NBI-104, claims NBI-141 through NBI-143, and claims NBI-177 through NBI-179 were located on January 13, 2008

Claims NBI-69 through NBI-77, claims NBI-105 through NBI-113, claims NBI-137 through NBI-140, claims NBI-144 through NBI-149, claims NBI-173 through NBI-176, and claims NBI-180 through NBI-182 were located on January 14, 2008

Claims NBI-129 through NBI-136, and claims NBI-165 through NBI-172 were located on January 15, 2008

DOC # 0131357

04/08/2008 10:11 AM
Official Record
 Recording Provided By
 ATNA RESOURCES, INC.
 Lincoln County - NV
 Leslie Boucher - Recorder
 Fee: \$1,369.00 Page: 1 of 1
 RPT: Recorded By: RE
 Book- 240 Page- 0471



NBI Claims
 Located in Unsurveyed
 Township 7N, Range 68E,
 M.D.B. & M.
 Sections 2, 3, 9, 10, 11, 14, 15, and 16
 Lincoln County, Nevada
 by:
 Atna Resources Inc.
 1575 Delucchi Lane, Suite 115
 Reno, NV 89502

Tick Marks and Grid based on the UTM projection system, Zone 11N, using the North American Datum of 1927.

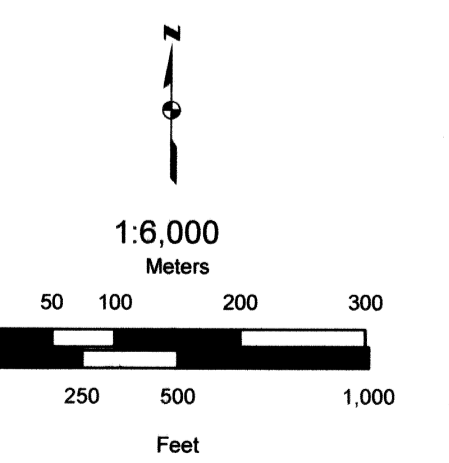

ATNA RESOURCES INC.

NBI Claim Group
Claim Map

Author: GPE Date: 03/24/08
 File: claim_cert_map_North_Mar08.MXD



All Claims located in unsurveyed Township 7N, Range 68E, M.D.B. & M.

731000 732000 733000 734000 735000

4284000 4283000 4282000 4281000