

- EXPLANATION**
- Public Land Survey
 - Corner Post
 - Location Monument
 - Claim Boundary

Typical Claim
(not to scale)

Corner Posts are 1.5" x 1.5" x 4' wooden posts with scribed metal tag describing corner.

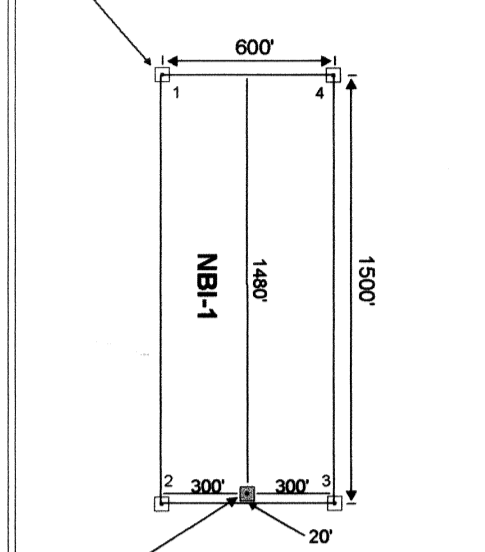

Location Monument is a 1.5" x 1.5" x 4' wooden post with location notice attached.

Claims NBI-206 through NBI-207 and claims NBI-232 through NBI-233 were located on January 15, 2008

Claims NBI-198 through NBI-205 and claims NBI-223 through NBI-231 were located on January 16, 2008

DOC # 0131265
 04/08/2008 09:52 AM
Official Record
 Recording requested by
 ATNA RESOURCES, INC.
 Lincoln County - NV
 Leslie Boucher - Recorder
 Fee: \$364.00 Page: 1 of 1
 RPT: Recorded By: RE
 Book - 240 Page - 0379



NBI Claims
 Located in Unsurveyed
 Township 7N, Range 68 E,
 M.D.B. & M.
 Sections 17, and 20
 Lincoln County, Nevada
 by:
 Atna Resources Inc.
 1575 Delucchi Lane, Suite 115
 Reno, NV 89502

Tick Marks and Grid based on the UTM projection system, Zone 11N, using the North American Datum of 1927.

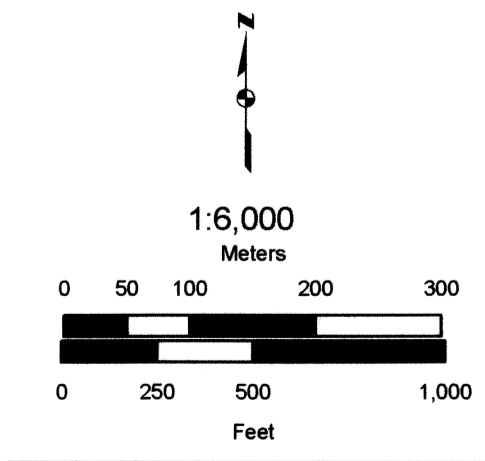

ATNA RESOURCES INC.
NBI Claim Group
Claim Map
 Author: GPE Date: 03/10/08
 File: claim_cert_map_North_Mar08.MXD

All Claims located in unsurveyed Township 7N, Range 68E, M.D.B. & M.