

394

# Record of Survey

DOC # 0131204  
 03/24/2008 02:03 PM  
**Official Record**  
 Recording Requested By  
 LEWARD SMITH  
 Lincoln County - NV  
 Leslie Boucher - Recorder  
 Fee: \$21.00 Page: 1 of 1  
 Book: C Page: 0394  
 0131204

### SURVEYOR'S CERTIFICATE

I, Lenard D. Smith, a Professional Land Surveyor licensed in the State of Nevada certify that:

- This plat represents the results of a survey conducted under my direct supervision at the instance of Raymond Larid Whipple
- The lands surveyed lie within Sections 5 & 8, Township 2 South, Range 68 East, M.D.M. The survey was completed on March 7, 2008
- The monuments depicted on the plat are of the character shown, occupy the positions indicated, and are of sufficient number and durability.

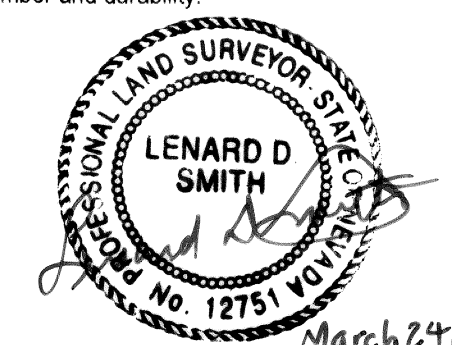

Lenard D. Smith PLS 12751, Exp. June 30, 2008

### BASIS OF BEARING

The west line of the SW1/4, Section 5, Township 2 South, Range 68 East, M.D.M. Show in Plat Book A, Page 258 as S 0°11'05" E

### LEGEND

- ⊙ Set #5 rebar 24" long in concrete with 2 1/2" aluminum cap stamped L. SMITH PLS 12751
- ◇ Section corner, found 3" brass cap stamped "L. SMITH PLS 12751" in large concrete base
- ◆ Quarter section corner, found standard BLM brass cap
- Highway centerline
- - - Highway right of way

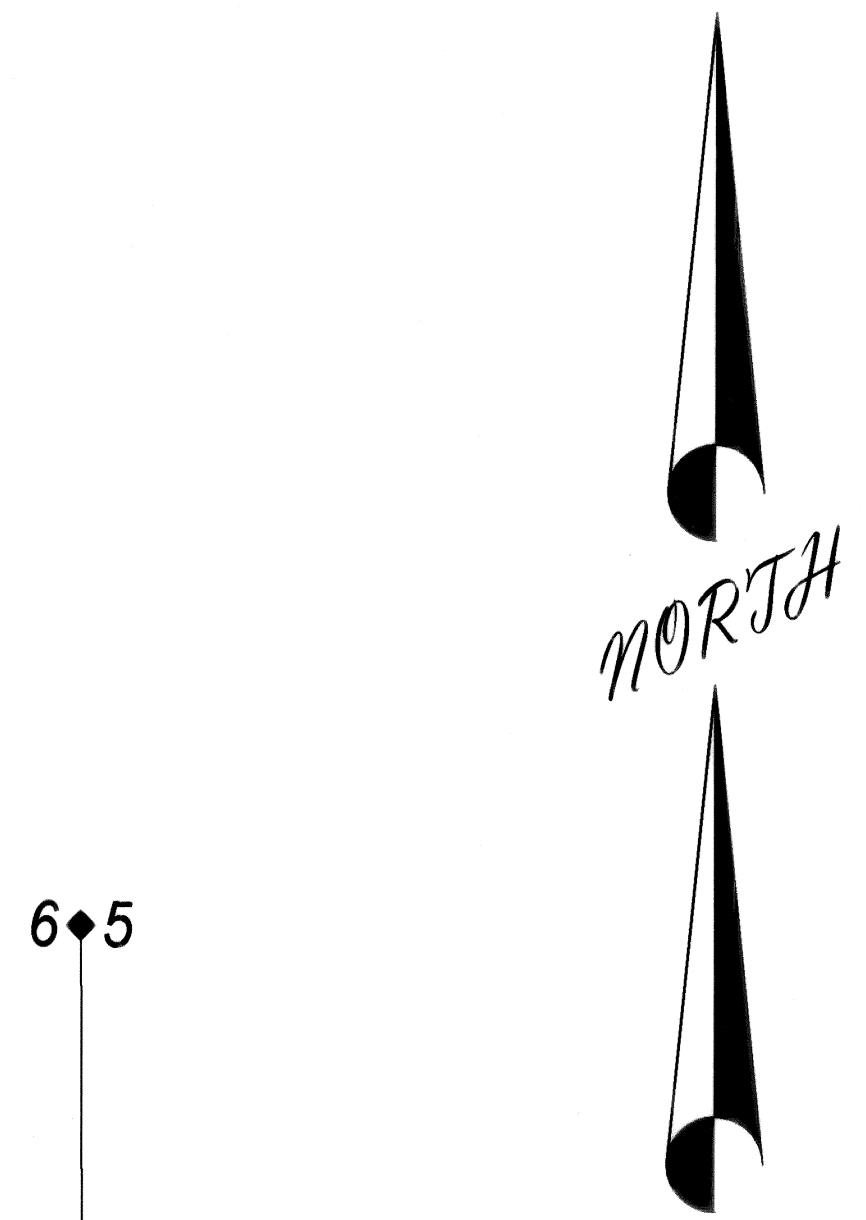

6 5  
 N 00°11'05" W 2635.43'  
**BASIS OF BEARING**  
 6 5  
 7 8

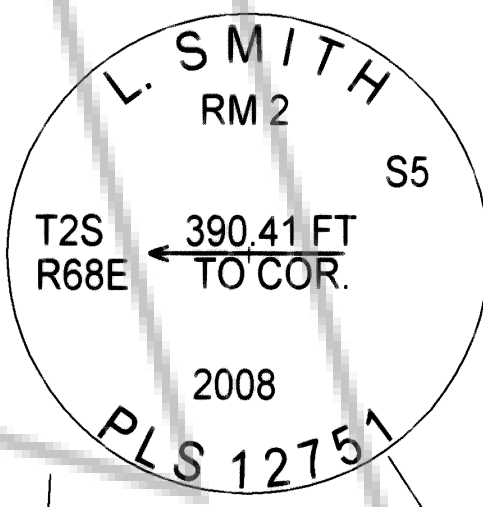

US Highway 93

N 74°45'03" E 390.41'

S 66°29'08" E 395.93'

N 02°59'27" E 261.01'

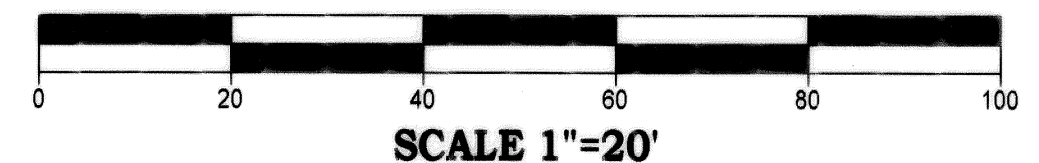
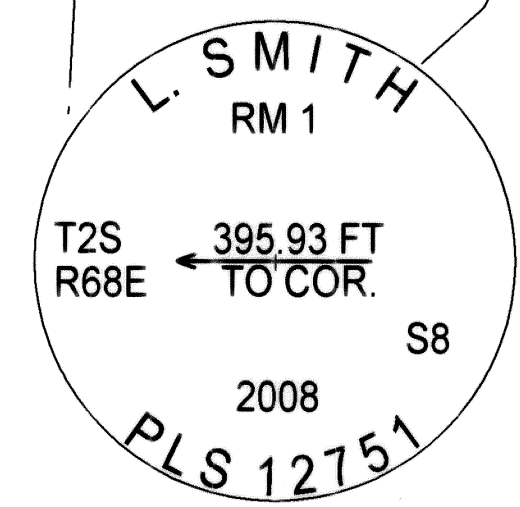

**Record of Survey**  
 For  
**Raymond Larid Whipple**  
 In Sections 5 & 8, Township 2 South, Range 68 East, Mount Diablo Meridian,  
 Lincoln County, Nevada

**Lenard Smith Land Survey**  
 509 Main Street  
 P.O. Box 443  
 Caliente, Nevada 89008  
 Phone/Fax 775 726 3365  
 Cell Phone 775 962 1196

Sheet  
1 of 1