

The undersigned hereby affirms that this document submitted for recording does not contain a Social Security Number.

Assessor Parcel No(s): 02-113-04



0130621

**WHEN RECORDED MAIL TO:**

Bank of Nevada, West Sahara Regional Office, 2700 W. Sahara Avenue, Las Vegas, NV 89102

**SEND TAX NOTICES TO:**

**FOR RECORDER'S USE ONLY**

**REQUEST FOR NOTICE**  
Nevada Revised Section 107.090

In accordance with Nevada Revised Section 107.090, request is hereby made that a copy be sent to Bank of Nevada of any Notice of Default or Notice of Sale under Deed of Trust recorded as:

Document No: 120985

Recorded on: 09-29-2003

Book: 178

Page: 299

Official Records: LINCOLN County, State of Nevada, and describing land therein as:

Legal Description: SEE ATTACHED EXHIBIT "A"

Address: The Real Property or its address is commonly known as 95 NORTH 3RD STREET, PANACA, NV 89042. The Real Property tax identification number is 02-113-04.

Trustor: QUENTIN F. GILPATRICK and VICTORIA A. GILPATRICK, HUSBAND AND

**REQUEST FOR NOTICE  
(Continued)**

**Loan No: 1812337685**

**Page 2**

WIFE AS JOINT TENANTS

**Beneficiary:** SILVER STATE SCHOOLS CREDIT UNION, A STATE CHARTERED CREDIT UNION, A NEVADA CORPORATION

**Trustee:** FIRST AMERICAN TITLE COMPANY

**Mail Notices to:** Bank of Nevada West Sahara Regional Office 2700 W. Sahara Avenue Las Vegas, NV 89102

who is a person with an interest in the subject real property as evidenced by a deed of trust being recorded concurrently with this document.

**Dated:** November 13, 2007

**LENDER:**

**BANK OF NEVADA**

  
Authorized Signer



**REQUEST FOR NOTICE  
(Continued)**

Loan No: 1812337685

Page 3

**LENDER ACKNOWLEDGMENT**

STATE OF Nevada

COUNTY OF Clark

)  
) SS  
)

This instrument was acknowledged before me on November 19<sup>2007</sup> by Lisa Cook, Vice President of Bank of Nevada, as designated agent of Bank of Nevada.

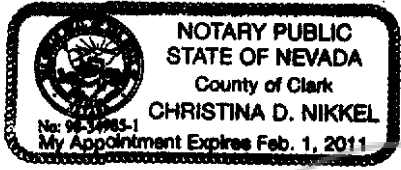

(Seal, if any)

Christina D. Nikkel  
(Signature of notarial officer)

Notary Public in and for State of Nevada



Order Number: 35270

**EXHIBIT "A"**

Lot 2 in Block 16 in the TOWN OF PANACA, County of Lincoln, State of Nevada as shown on the Official Map thereof recorded in the Book of Plats, page 34, Lincoln County, Nevada records.

ASSESSOR'S PARCEL NUMBER FOR 2007 - 2008: 02-113-04

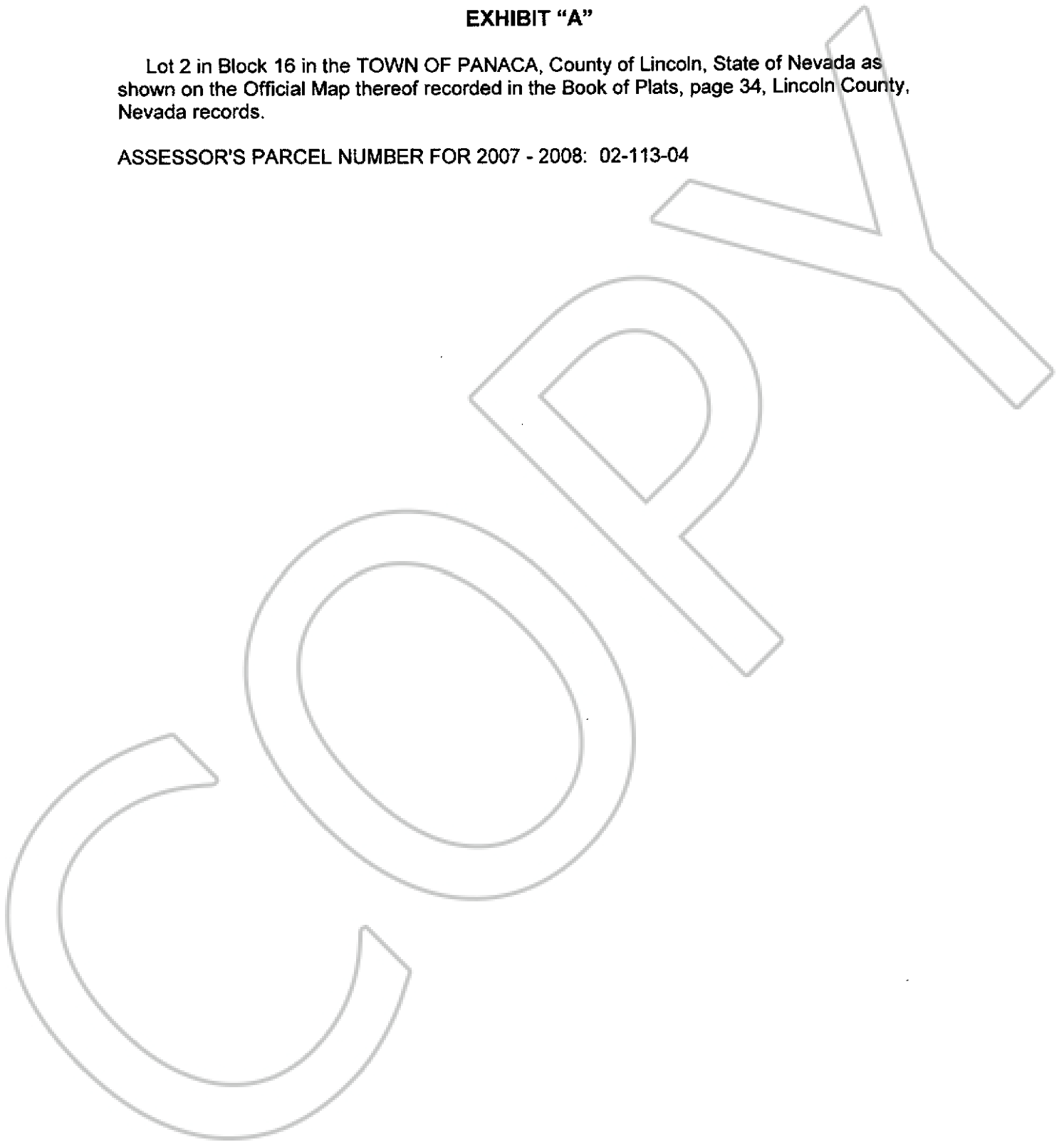



0130621

Book: 237  
Page: 655

11/28/2007  
Page 5 of 5

**EXHIBIT "A"**

Lot 2 in Block 16 in the TOWN OF PANACA, County of Lincoln, State of Nevada as shown on the Official Map thereof recorded in the Book of Plats, page 34, Lincoln County, Nevada records.

ASSESSOR'S PARCEL NUMBER FOR 2007 - 2008: 02-113-04

