

SURVEYOR'S CERTIFICATE
 I, Lenard D. Smith, a Professional Land Surveyor licensed in the State of Nevada, certify that:
 1. This plat represents the results of a survey conducted under my direct supervision at the instance of David Love.
 2. The lands surveyed lie within Section 18 & 19, T. 2 S., R. 68 E., M.D.M. The survey was completed on August 22, 2007.
 3. This plat complies with the applicable state statutes, and not in conflict with the provisions of NRS 278.010 to 278.630 inclusive and local ordinances in effect including the Lincoln County Planning Code Section 13-29-7 (1), (2), & (3) on the date that the governing body gave its final approval. It will not create any new parcels.
 4. The monuments depicted on the plat are of the character shown, occupy the positions indicated and are of sufficient number and durability.

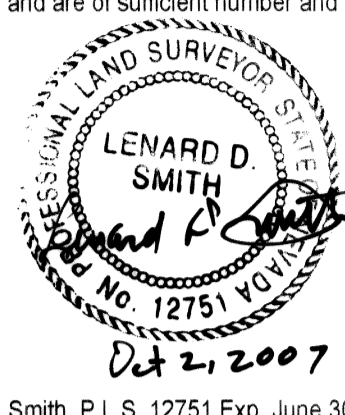

OWNER'S CERTIFICATE
 We, David & Jean Love, Laird & Dee Ann Whipple certify that we are the owner's of the lands as shown on this map
 1. We have examined the plat and approve and authorize the recording thereof
 2. We agree to execute the required documents creating any easement which is shown
 3. We agree to execute the required documents abandoning any existing easement pursuant to the provisions of NRS 278.010 to 278.630, inclusive
 4. All property taxes on the land for the fiscal year have been paid
 5. Any lender with an impound account for the payment of taxes has been notified of the adjustment of the boundary line or the transfer of the land.
 6. We agree to execute documents for the exchange of adjusted boundaries as shown.

David Love, Jean Love, Laird Whipple, Dee Ann Whipple

ACKNOWLEDGEMENT
 STATE OF NEVADA)
 COUNTY OF LINCOLN) ss
 This instrument was acknowledged before me on Oct 4, 2007 by David Love, Jean Love, Laird Whipple, and Dee Ann Whipple, freely and voluntarily for the purposes stated.
 Victoria Ann Carter, Notary Public, My commission expires Nov 9, 2008

PLANNING COMMISSION
 This is to certify that the zoning and comprehensive planning, of the County of Lincoln, Nevada on this 11th day of October, 2007 did approve for the purpose of land division and do hereby accept in behalf of the public, this plat and any easements offered for public use.
 Clint West, Lincoln County Planning Commission, 10-11-07, Date

LINCOLN COUNTY ASSESSOR APPROVAL
 I hereby certify that the ownership information contained hereon is correct and all owners have signed.
 Dale Perestwich Deputy, Lincoln County Assessor, 11-27-07, Date

LINCOLN COUNTY TREASURER APPROVAL
 Pursuant to NRS 278.468 I hereby certify that the taxes for the fiscal year 2006-2007 on Assessor Parcel Number _____ are paid in full.
 Kelly C. Han, Lincoln County Treasurer and Ex-officio Tax Receiver, 11-27-07, Date

LINCOLN COUNTY RECORDER APPROVAL
 Pursuant to NRS 278.467 and 278.468, I hereby certify that this map was recorded within 1 year of the Lincoln County Planning Commission approval, the map is in an acceptable form for recording, the treasurer signature date matches the recorder date and that all fees have been paid for the recording of this document.
 _____, Lincoln County Recorder, 11-27-07, Date

AMENDED RECORD OF SURVEY, BOUNDARY LINE ADJUSTMENT OF MAP PLAT BOOK B, PAGE 395
 For David & Jean Love and Laird & Dee Ann Whipple
 Sections 18 and 19 of T. 2 S., R. 68 E., Mount Diablo Meridian, Lincoln County, Nevada

Lenard Smith Land Survey
 509 Main Street
 P.O. Box 443
 Caliente, Nevada 89008
 Phone/Fax 775 726 3365
 Cell Phone 775 962 1196

VICINITY MAP
 NO SCALE

T. 2 S., R. 67 E.	T. 2 S., R. 68 E.		
1	6	5	4
12	7	8	PANACA
13	18	17	16
24	19	20	21
25	30	29	28

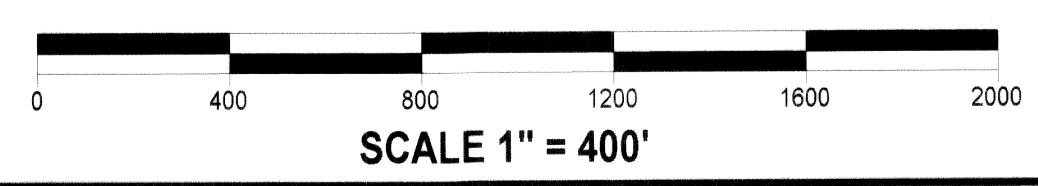

- LEGEND**
- Set #5 rebar & plastic cap stamped L SMITH PLS 12751
 - Found #5 rebar & alum cap stamped L SMITH PLS 12751
 - Found Nevada Dept. of Trans. brass cap as described
 - Ownership line (after adjustment)
 - Ownership line along highway centerline
 - Assessor's line (same ownership)
 - Highway right of way line
 - Ownership line prior to boundary line adjustment
 - Adjusted boundary line on existing fence