

Official Record

Recording requested By
FIRST AMERICAN TITLE

Lincoln County - NV
Leslie Boucher - Recorder

Fee: \$19.00

Page 1 of 6

RPTT:

Recorded By: LB

Book- 237 Page- 0171



0130346

APN #: 005-241-02, 005-231-17

Escrow # NCS-264045-HHLV (ak)

Short Form Deed of Trust

(Title on Document)

***Rerecord to correct legal

Recording requested by:

First American Title Company

Return to:

Name First American Title

Address 3960 Howard Hughes Pkwy #380

City/State/Zip Las Vegas, NV 89169

Attn: Amy Klinzing

This page added to provide additional information required by NRS 111.312 Sections 1-2 (Additional recording fee applies).

This cover page must be typed or printed clearly in black ink only.



0130346

Book: 237
Page: 172

11/13/2007
Page: 2 of 6

DOC # 0128450

02/28/2007

04:29 PM

Official Record

Recording requested By
FIRST AMERICAN TITLE

Lincoln County - NV
Leslie Boucher - Recorder

Fee: \$17.00

Page 1 of 4
Recorded By: AE

Book- 229 Page- 0189



0128450

APN #: 005-241-02 & 005-231-17 **C**

ESCROW #NCS - 264045-HHLV (ak)

SHORT FORM DEED OF TRUST

(Title on Document)

Recording requested by:

First American Title Company

Return to:

Name BIGELOW COMPANIES

Address 4640 S. EASTERN AVENUE

City/State/Zip LAS VEGAS, NV 89119

This page added to provide additional information required by NRS 111.312 Sections 1-2 (Additional recording fee applies).

This cover page must be typed or printed clearly in black ink only.

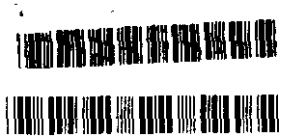

0128450 Book: 229 02/28/2007
Page: 198 Page: 2 of 4



0130346 Book: 237 11/13/2007
Page: 173 Page: 3 of 5

RECORDING REQUESTED BY: Darcy Green, Esq.
Escrow # NCS-264045-HBLV(ak)
AND WHEN RECORDED MAIL TO:

Engelow Companies
4640 S. Eastern Ave.
Las Vegas, Nevada 89119

APN NO. 005-241-02 &
005-231-17

SHORT FORM DEED OF TRUST

This Deed of Trust, made this 9th day of February, 2007, between Jeffrey T. MacBurnie, herein called Trustor, whose address is 8100 Ivy Hollow Court, Las Vegas, Nevada and Mt. Wilson Ranch LLC, 4640 South Eastern Ave., Las Vegas, Nevada 89119, herein called Beneficiary,

Witnesseth: That Trustors **IRREVOCABLY GRANTS, TRANSFERS AND ASSIGNS TO First American Title Insurance Company, Trustee, in trust, with power of sale, that property in Lincoln County, Nevada, described as:**

Commonly Referred to as: **Mt. Wilson Ranch and more particularly described in Exhibit "A" attached hereto and incorporated herein.**

TOGETHER WITH ALL APPURTENANCES in which Trustee has any interest, including water rights benefiting said reality, or otherwise; and

TOGETHER WITH the rents, issues and profits thereof, **SUBJECT, HOWEVER,** to the right, power and authority given to and conferred upon Beneficiary by paragraph (10) of the provisions incorporated herein by reference to collect and apply such rents, issues and profits.

For the Purpose of Securing: 1. Performance of each agreement of Trustors incorporated by reference or contained herein. 2. Payment of the indebtedness evidenced by one promissory note of even date herewith, and any extension or renewal thereof, in the principal sum of Three Hundred and Twelve Thousand Five Hundred Dollars (\$312,500) executed by Trustors in favor of Beneficiary or order. 3. Payment of such further sums as the then record owner of said property may borrow from Beneficiary, when evidenced by another note (or notes) reciting it is so secured.

To Protect the Security of This Deed of Trust, Trustor Agrees: By the execution and delivery of this Deed of Trust and the rate of twelve percent (12)% per annum, secured hereby, that, in the book and at the page of Official Records in the office of the county recorder of the County of Lincoln where said property is located, noted in BOOK _____ and PAGE _____ as Document No.: 0176382020000, of the Official Records in the Office of the Lincoln County Recorder, Pioche, Nevada and each and all are hereby incorporated herein by reference and made a part hereof as fully as though set forth herein.

The undersigned Trustors requests that a copy of any Notice of Default and of any Notice of Sale hereunder be mailed to them at the address hereinbefore set forth.

Signature: Jeffrey T. MacBurnie
Jeffrey T. MacBurnie

STATE OF NEVADA }
 } SS.
COUNTY OF CLARK }

On this 9th day of Feb 2007 before me Jeffrey T. MacBurnie, personally appeared and proved to me on the basis of satisfactory evidence to be the person whose name is subscribed to the within instrument and acknowledged to me that he executed the same in his authorized capacity, and that by his signature on the instrument the person upon behalf of which the person acted, executed the instrument

WITNESS my hand and official seal.
Signature: Christina A. Hooks
Notary Public

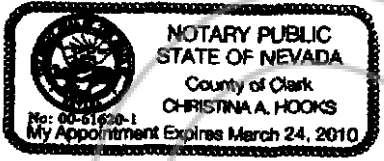

EXHIBIT "A"

PARCEL 1:

THE NORTHWEST QUARTER (NW 1/4) OF THE NORTHWEST QUARTER (NW 1/4) OF THE NORTHEAST QUARTER (NE 1/4) OF THE NORTHWEST QUARTER (NW 1/4) OF THE SOUTHWEST QUARTER (SW 1/4) OF THE NORTHWEST QUARTER (NW 1/4) OF SECTION 35, TOWNSHIP 5 NORTH, RANGE 67 EAST, M.D.B. & M.

PARCEL 2:

THE EAST HALF (E 1/2) OF THE SOUTHEAST QUARTER (SE 1/4) OF THE NORTHEAST QUARTER (NE 1/4) OF SECTION 34, TOWNSHIP 5 NORTH, RANGE 67 EAST, M.D.B. & M.

THE NORTH HALF (N 1/2) OF THE NORTHEAST QUARTER (NE 1/4) OF THE NORTHEAST QUARTER (NE 1/4) OF THE SOUTHEAST QUARTER (SE 1/4) OF SECTION 34, TOWNSHIP 5 NORTH, RANGE 67 EAST, M.D.B. & M.

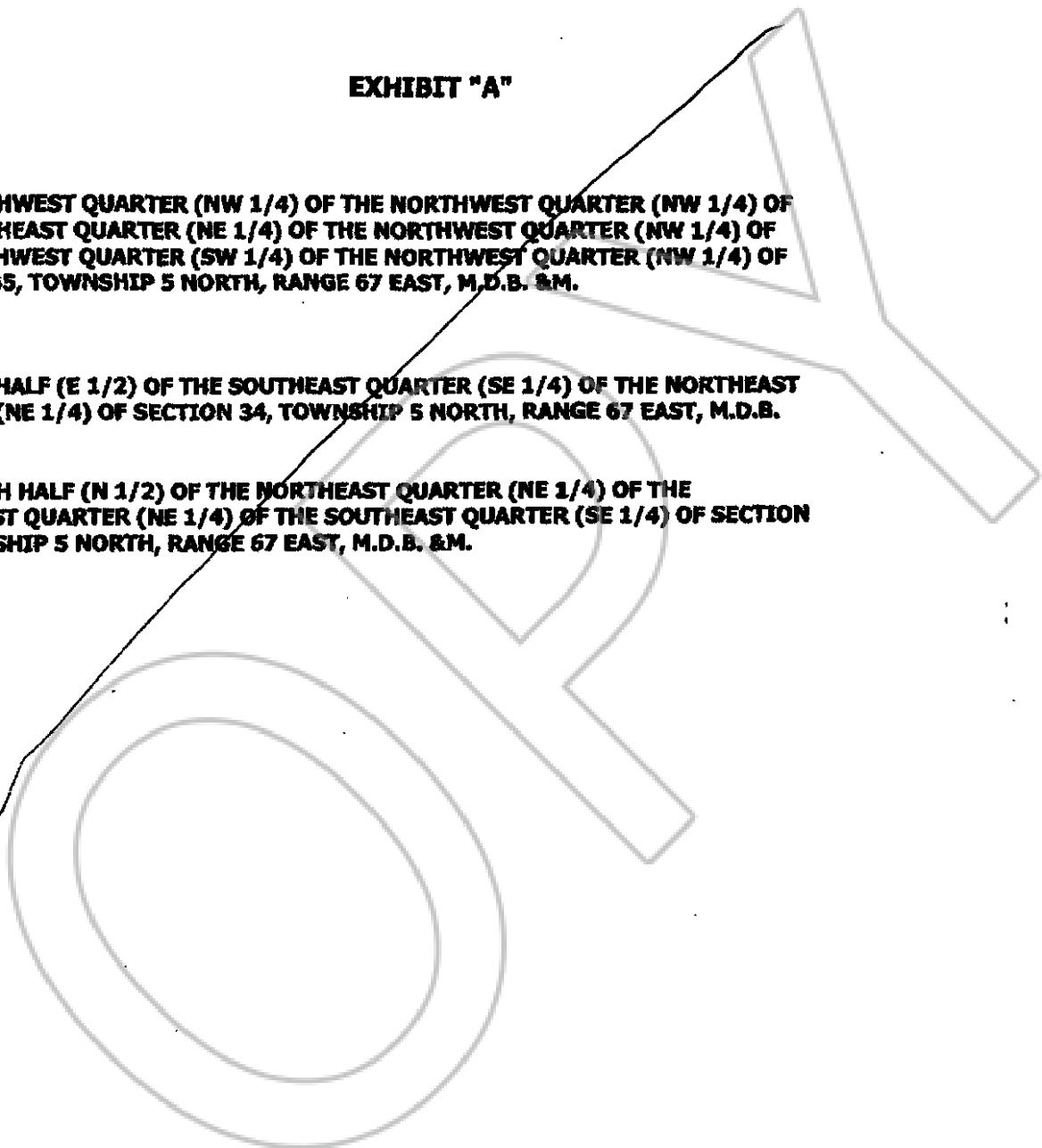

I hereby certify that the foregoing is a full and correct copy of the original document as of 10/29/07 at 11:10 AM

Now of record in this office, in book 229 of page 192 of Lincoln County Nevada Date October 29, 2007

Recorder Leslie Boucher

Leslie Boucher Deputy



0130346

Book: 237
Page: 176

11/13/2007
Page: 6 of 6

Exhibit "A"

Legal Description

Real property in the City of Pioche, County of Lincoln, State of Nevada, described as follows:

PARCEL 1:

THE NORTHWEST QUARTER (NW 1/4) OF THE NORTHWEST QUARTER (NW 1/4) AND THE NORTHEAST QUARTER (NE 1/4) OF THE NORTHWEST QUARTER (NW 1/4) AND THE SOUTHWEST QUARTER (SW 1/4) OF THE NORTHWEST QUARTER (NW 1/4) OF SECTION 35, TOWNSHIP 5 NORTH, RANGE 67 EAST, M.D.B. &M.

PARCEL 2:

THE EAST HALF (E 1/2) OF THE SOUTHEAST QUARTER (SE 1/4) OF THE NORTHEAST QUARTER (NE 1/4) OF SECTION 34, TOWNSHIP 5 NORTH, RANGE 67 EAST, M.D.B. &M.

THE NORTH HALF (N 1/2) OF THE NORTHEAST QUARTER (NE 1/4) OF THE NORTHEAST QUARTER (NE 1/4) OF THE SOUTHEAST QUARTER (SE 1/4) OF SECTION 34, TOWNSHIP 5 NORTH, RANGE 67 EAST, M.D.B. &M.

APN: 005-241-02 and 005-231-17 and 05-231-17 and 05-241-02