

Official Record

Recording requested By
LINCOLN COUNTY POWER DISTRICT

Lincoln County - NV
Leslie Boucher - Recorder

Fee: \$15.00 Page 1 of 2
RPTT: Recorded By: LB
Book- 232 Page- 0514



When Recorded Send to:
Lincoln County Power Distr. No 1
HC 74 Box 101
Pioche, NV 89043

AN EASEMENT FOR THE DISTRIBUTION OF ELECTRICAL ENERGY

THIS EASEMENT made this 22 day of June, 2007 By Gary & Maureen Mitchell Trust, do hereby grant to the LINCOLN COUTNY POWER DISTRICT NO. 1, a 20.00 foot Easement for the Distribution of Electrical Energy.

WITNESSETH:

THAT THE undersigned does hereby grant to the LINCOLN COUNTY POWER DISTRICT NO. 1, for the purposes of a Power Line Easement, for the location, construction and maintenance of utilities across certain real property of the undersigned, lying and being in the County of Lincoln, State of Nevada; said easement being more particularly described as follows:

Situated within APN 006-041-42

SEE EXHIBIT 'A' for Legal Description of Easement

In Witness Whereof the heretofore mentioned has hereunto signed on the date first above written

State of Nevada)
) SS
County of Lincoln)

Gary Mitchell
Gary Mitchell, ~~President~~ Trustee
Maureen Mitchell
Maureen Mitchell Trustee

This instrument was acknowledged before me on this 22 day of June, 2007, by Gary Mitchell

Louise M. Carlson
Notary Public in and for said County and State
My Commission Expires: 9/26/09



Lenard Smith Survey
 509 Main Street
 P.O. Box 443
 Caliente, Nevada 89008
 Phone/Fax 775 726 3365
 Cell Phone 775 962 1196

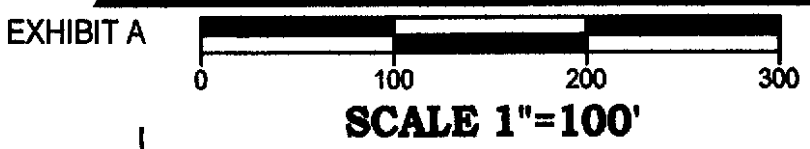

SURVEYOR'S CERTIFICATE

I, Lenard D. Smith, a Professional Land Surveyor licensed in the State of Nevada certify that: This plat represents the results of a survey conducted under my direct supervision at the instance of Lincoln County Power District; The lands surveyed lie within Section 2, Township 4 North, Range 67 East, M.D.M.; The survey was completed on June 12, 2007

Lenard D. Smith PLS 12751, Exp. June 30, 2008

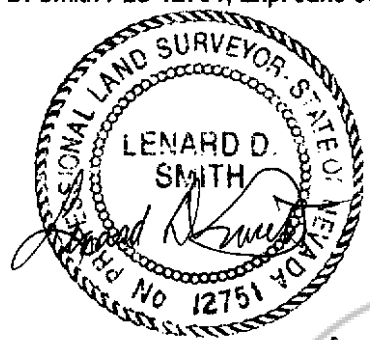

BASIS OF BEARING
 N 00°17'00" W 3381.53'

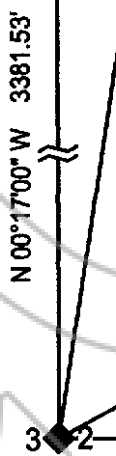
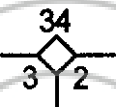

S 26°27'59" W 736.83'

LEGEND

- Found rebar with plastic cap stamped OWENS PLS 2884
- ⊙ Existing power pole
- v— Existing power line
- - - Easement

20' easement granted to Lincoln County Power District NO. 1 per Book 147, Page 50

DESCRIPTION OF EASEMENT

A strip of land 20 ft. wide in Lot 12, Section 2, Township 4 North, Range 67 East M.D.M., the east and north lines of the easement more particularly described as follows:

Beginning at a point along the east side of the E1/2 SW1/4, of said Lot 12, from which the west quarter corner of said Section 2 bears S 70°45'22" W 698.49 feet; thence N 00°01'47" E 428.08 feet to a rebar with plastic cap stamped OWENS PLS 2884; thence N 89°46'23" W 330.86 feet to a rebar with plastic cap stamped OWENS PLS 2884; from which point an area 30 feet radius in said E1/2 SW1/4.

The Basis of Bearing being:

The west line of the NW1/4, Section 2, Township 4 North, Range 67 East, M.D.M. shown in Plat Book A, Page 312 as N 00°17'00" W

End of Description.

