

SURVEYOR'S CERTIFICATE

I, Lenard D. Smith, a Professional Land Surveyor licensed in the State of Nevada, certify that:

- This plat represents the results of a survey conducted under my direct supervision at the instance of Lincoln County School District
- The lands surveyed lie within Block 25, Town of Panaca, Nevada, Section 9, Township 2 South, Range 68 East, M.D.M. The survey was completed on April 09, 2007
- This plat complies with the applicable state statutes and any local ordinances in effect on the date that the governing body gave its final approval.
- The monuments depicted on the plat are of the character shown, occupy the positions indicated and are of sufficient number and durability.

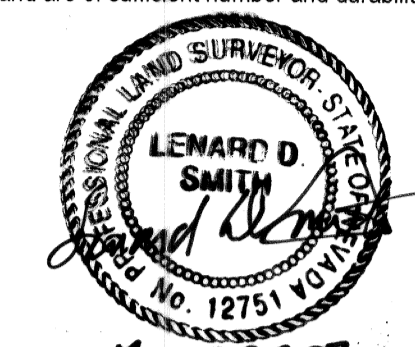

Lenard D. Smith P.L.S. 12751 Exp. June 30, 2008

PLANNING COMMISSION

This is to certify that the zoning and comprehensive planning has examined this plat and does approve it for recordation

Clint Weath 5-15-07
 Lincoln County Planning Commission Date

BASIS OF BEARING

The west line of the NW1/4, Section 9, Township 2 South, Range 68 East, M.D.M., monumented as shown on this plat, shown on the BLM Dependent Resurvey as N 0°06'10" W

REFERENCES

Deed, Recorded February 27, 1940 in Book E-1, Page 521, File no. 14854
 Deed, Recorded June 23, 1950 in Book H-1, Page 489, File no. 25752
 Deed, Recorded October 18, 1965 in Book M-1, Page 471, File no. 43282

LEGEND

- Set monument, #5 rebar and 1 1/4" plastic cap stamped L SMITH PLS 12751
- Set monument, PK nail & 1 1/2" disk stamped L SMITH PLS 12751
- ⊙ Found monument, PK nail & 1 1/2" disk stamped L SMITH PLS 12751
- Property line
- Building
- - - Chain-link fence
- - - Road right of way
- · · Sidewalk



RECORDERS CERTIFICATE

DOC # 0128927
 Official Record
 Lincoln County - NV
 Leslie Boucher - Recorder
 Fee: \$21.00 Page 1 of 1
 Book - C Page - 0333
 0128927

Record of Survey
 For Lincoln County School District
 of all property owned by Lincoln County School District in Block 25 Town of Panaca, State of Nevada, deeds as shown in Book E-1, Page 521, Book H-1, Page 489, and Book M-1, Page 471
 In Section 9, Township 2 South, Range 68 East, Mount Diablo Meridian, A.P.N. 002-121-01 Block 25, Town of Panaca, Lincoln County, Nevada

Lenard Smith Land Survey LTD
 509 Main Street
 P.O. Box 443
 Caliente, Nevada 89008
 Phone/Fax 775 726 3365
 Cell Phone 775 962 1196

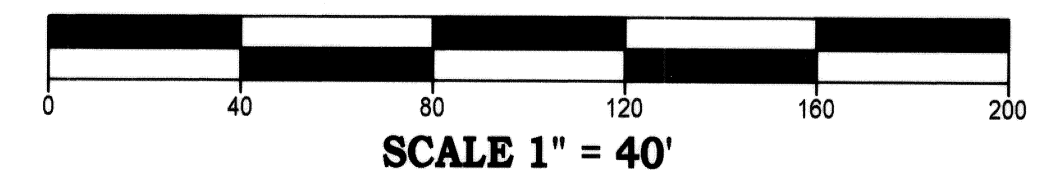

BASIS OF BEARING
 N 0°06'10" W 2637.51' (68.962 Chains)

Found standard
 BLM brass cap
 5 4
 8 9

Found standard
 BLM brass cap
 8 9