

Merger and Re-Parcel - Planning # 07-100-MSB-R1-PC

SURVEYOR'S CERTIFICATE

I, Lenard D. Smith, a Professional Land Surveyor licensed in the State of Nevada, certify that:

- This plat represents the results of a survey conducted under my direct supervision at the instance of Margie Gunn Nutman
- The lands surveyed lie within Section 8, Township 2 South, Range 68 East, M.D.M. The survey was completed on March 2007
- This plat complies with the applicable state statutes and any local ordinances in effect on the date that the governing body gave its final approval.
- The monuments depicted on the plat are of the character shown, occupy the positions indicated and are of sufficient number and durability.

DOC # 0128874
 05/07/2007 01:42 PM
Official Record
 Recording requested by
 LENARD D SMITH
 Lincoln County - NV
 Leslie Boucher - Recorder
 Fee: \$21.00 Page: 1 of 1
 gpr: J Recorded By: RE
 Book - C Page - 0331
 0128874

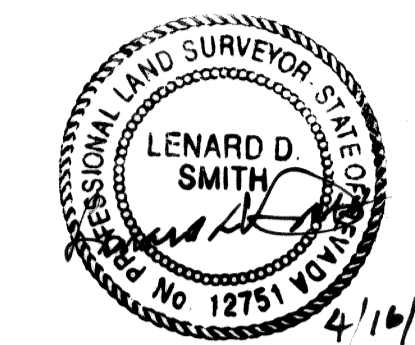

Lenard D. Smith P.L.S. 12751 Exp. 6/30/06

OWNER'S CERTIFICATE

I certify that I am the owner of the properties shown on this plat

- That I have requested Lenard D. Smith, a Professional Land Surveyor to prepare it.
- That I authorize the recordation thereof.

Margie Gunn Nutman
 Margie Gunn Nutman

ACKNOWLEDGEMENT

State of Nevada)
 County of Lincoln)
 This instrument was acknowledged before me on 4-27-07
 by Margie Gunn Nutman and executed freely and voluntarily for the purposes stated.

Debra Bradfield
 Notary Public
 My Commission Expires Feb. 1, 2009

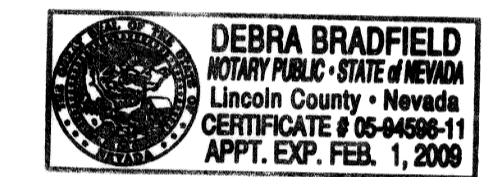

TOWN BOARD APPROVAL

This certifies that the town board has reviewed and approved this plat.
Approved per town board Clint Weir
 Chairman Date 4-27-07

PLANNING COMMISSION

This is to certify that the zoning and comprehensive planning, of the County of Lincoln, Nevada on this 16 day of April 2007 did approve for the purpose of land division and do hereby accept in behalf of the public, this plat and any easements offered for public use.
Yonkin & Higley 04-16-07
 Lincoln County Planning Commission Date

LINCOLN COUNTY ASSESSOR APPROVAL

I hereby certify that the ownership information contained hereon is correct and all owners have signed.
Debra Bradfield Deputy 4-27-07
 Lincoln County Assessor Date

LINCOLN COUNTY TREASURER APPROVAL

Pursuant to NRS 278.468 I hereby certify that the taxes for the fiscal year 2006-2007 on Assessor Parcel Numbers 02-083-08 + 09 Assessed M.G. Nutman are paid in full.
Judith Fehner Deputy 4-27-07
 Lincoln County Treasurer and Ex-officio Tax Receiver Date

LINCOLN COUNTY RECORDER APPROVAL

Pursuant to NRS 278.467 and 278.468, I hereby certify that this map was recorded within 1 year of the Lincoln County Planning Commission approval, the map is in an acceptable form for recording, the treasurer signature date matches the recorder date and that all fees have been paid for the recordation of this document.
Ann Hume Deputy 5/7/2007
 Lincoln County Recorder Date

BASIS OF BEARINGS

The North line of Section 8, Township 2 South, Range 68 East, M.D.M. recorded in Plat Book B, Page 90, Lincoln County, Nevada Records as S 89°17'58" W

BASIS OF BEARING
 S 89°17'58" W 5289.91'
 R. S 89°17'58" W 5290.22'

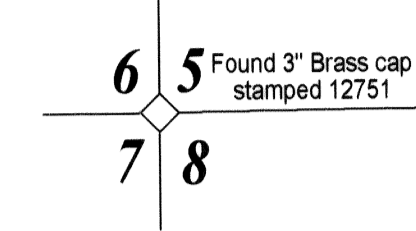

Revised Parcel 2
 Previously 8415 sq. ft. (0.193 acres)
 New merged area, 22,398 sq. ft. (0.514 acres)
 APN 002-083-09

Revised Parcel 1
 Previously 61,215 sq. ft. (1.405 acres)
 New merged area 47,232 sq. ft. (1.084 acres)
 APN002-083-08

AREA TABLE				
Parcel	Previous to merge sq. ft.	Previous to merge acres	Post merge sq. ft.	Post merge acres
Parcel 1	61,215	1.405	47,232	1.084
Parcel 2	8,415	0.193	22,398	0.514
totals	69,630	1.598	69,630	1.598

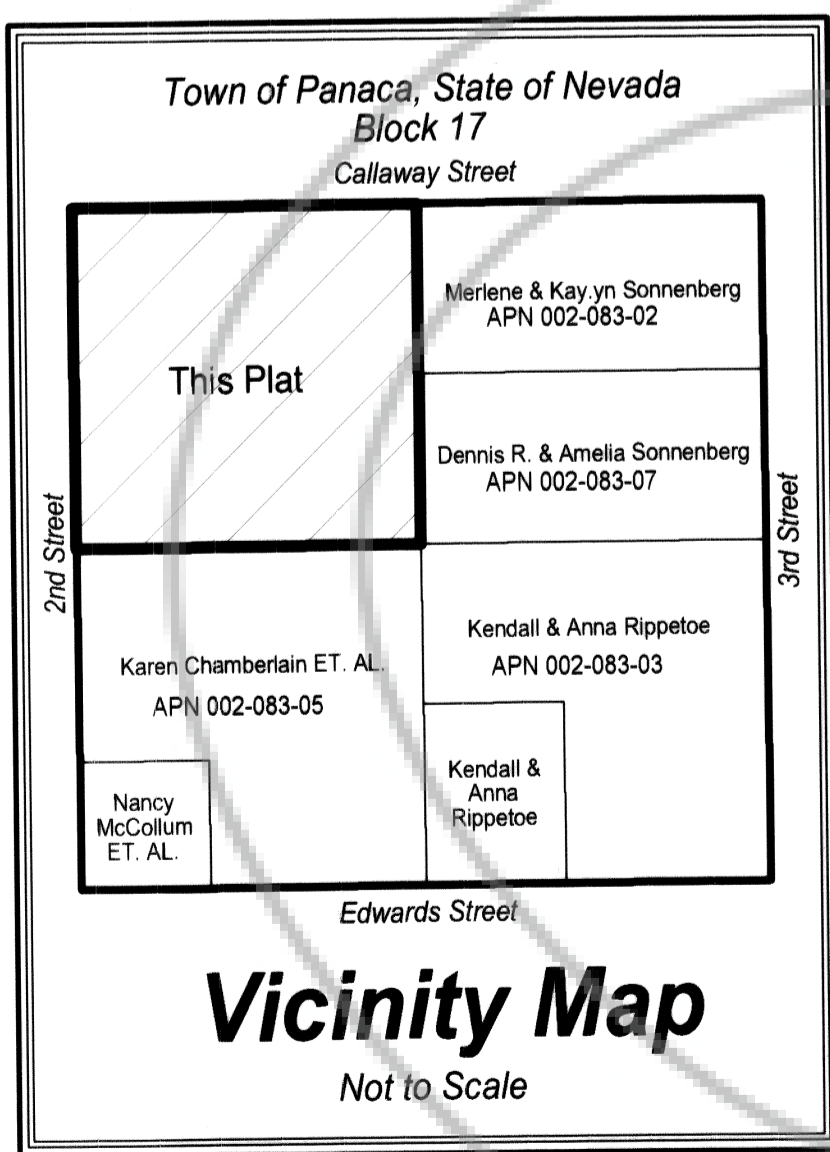

- LEGEND**
- Set #5 rebar with plastic cap stamped PLS 12751
 - Found #5 rebar with plastic cap stamped PLS 12751
 - Found B.L.M. brass cap - Section Corner unless noted otherwise
 - Parcel Line
 - Broken Tie
 - Building
 - R: Recorded in Plat Book B, Page 90, Lincoln County, Nevada Records

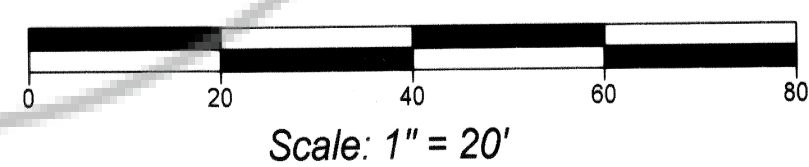

PLANNING STATEMENT

This property is being merged and re-parceled for the purpose of enlarging parcel 2 at the expense of Parcel 1 as shown.
 Zoning designation: Residential (R-1)

MAP REFERENCES

Parcel Map Plat Book C, Page 225, Lincoln County, Nevada Records
 Map of Panaca, Plat Book A, Page 34, Lincoln County, Nevada records
 Annexation Map, Plat Book B, Page 90, Lincoln County, Nevada records

Merger and Re-Parcel of
Plat Book C, Page
For Margie Gunn Nutman
 Lot 1, Block 17, Panaca Townsite
 In Section 8, Township 2 South, Range 68 East, M.D.M.



Lenard Smith Land Survey
 509 Main Street
 P.O. Box 443
 Caliente, Nevada 89008
 Phone/Fax 775 726 3365
 Cell Phone 775 962 1196