

SURVEYOR'S CERTIFICATE

I, Lenard D. Smith, a Professional Land Surveyor licensed in the State of Nevada certify that:

1. This plat represents the results of a survey conducted under my direct supervision at the instance of Pioche Fire District.
2. The lands surveyed lie within Section 15, Township 1 North, Range 67 East, M.D.M. in the Town of Pioche, Lincoln County, Nevada. The survey was completed on January 25, 2007.
3. The monuments depicted on the plat are of the character shown, occupy the positions indicated, and are of sufficient number and durability.

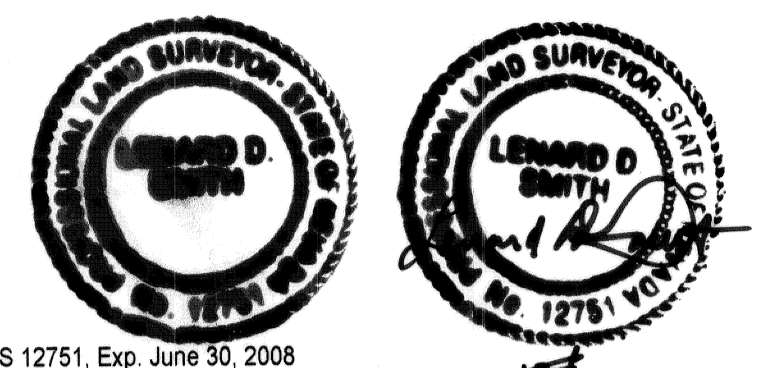

Lenard D. Smith PLS 12751, Exp. June 30, 2008

MAP REFERENCES

DEED: Ruby Lister, County Treasurer of Lincoln County, Nevada, Trustee as grantor to Vaughn K. Phillips et. al. as grantees, Recorded Book 82, Page 389 of Lincoln County, Nevada Records

Parcel Maps, recorded Plat Book A, Pages 174, 200, 225, 227, & 241, all of Lincoln County, Nevada Records.

Record of Survey Plat Book C, Page 40, Lincoln County, Nevada Records

BASIS OF BEARINGS

The north-south center of section 15 as given in Plats found in Plat Book A, Pages 174, 225, and 236, Lincoln County, Nevada Records, shown as N 0°27'30\"/>

PLANNING

The Lincoln County Planning Commission does hereby approve this map for recording

Clint West *Dwain Director*
Name Title

LEGEND

- Found rebar with plastic cap stamped L SMITH PLS 12751
- Existing under ground power line, telephone line, and center of easement.

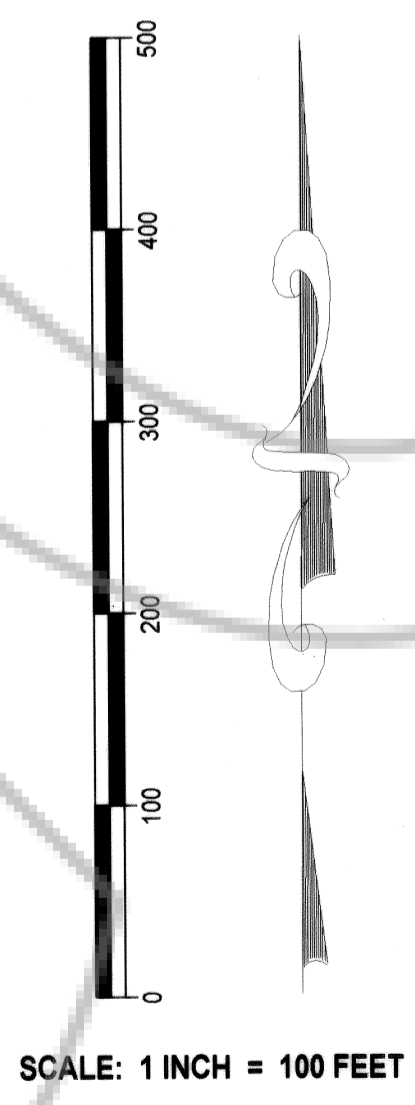

SCALE: 1 INCH = 100 FEET

DOC # 0128616
01/25/2007 11:14 AM
Official Record
Recording requested by
LENARD SMITH
Lincoln County - NV
Leslie Boucher - Recorder
Fee \$21.00 Page 1 of 1
2007 Recorded By: RE
Book - C Page - 0322
0128616

A.P.N. 001-201-09
001-201-14

RECORD OF SURVEY
SHOWING EASEMENT
**FOR VAUGHN & DONNA PHILLIPS TRUST
AND LINCOLN COUNTY**
IN THE TOWN OF PIOCHE, LINCOLN COUNTY, NEVADA
SECTION 15, T. 1 N., R. 67 E., M.D.M.

Lenard Smith
Land Survey
509 Main Street
P.O. Box 443
Caliente, Nevada 89008
Phone/Fax 775 726 3365
Cell Phone 775 962 1196

South quarter cor. section 15
brass cap in concrete monument
stamped RLS 3644