

319

SURVEYOR'S CERTIFICATE

I, Lenard D. Smith, a Professional Land Surveyor licensed in the State of Nevada, certify that:

1. This plat represents the results of a survey conducted under my direct supervision at the instance of Clark Maurice & Marian Louise Hardy, Clark Marion & Lorna Hardy, and Robert D. & Dee Ann Hansen.
2. The lands surveyed lie within Section 5, T.7 S., R.61 E., M.D.M. The survey was completed on September 6, 2006.
3. This plat complies with the applicable state statutes and any local ordinances in effect on the date that the governing body gave its final approval.
4. The monuments depicted on the plat are of the character shown, occupy the positions indicated and are of sufficient number and durability.

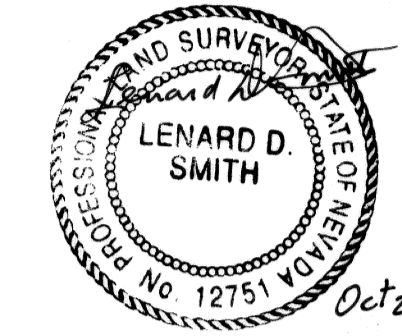

Lenard D. Smith P.L.S. 12751 Exp. 6/30/06

OWNER'S CERTIFICATE

We certify that we are the owners of the properties shown on this plat

1. That we have requested Lenard D. Smith, a Professional Land Surveyor to prepare it.
2. That we authorize the recording thereof.
3. That we approve any easements as shown.

Clark Maurice Hardy, Marian Louise Hardy
 Clark Marion Hardy, Lorna Hardy
 Robert D. Hansen, Dee Ann Hansen

ACKNOWLEDGEMENT

State of Nevada)
County of Lincoln)

This instrument was acknowledged before me on Jan 29, 2007

by Clark Maurice Hardy, Marian Louise Hardy, Clark Marion Hardy, Lorna Hardy, Robert D. Hansen and Dee Ann Hansen and executed freely and voluntarily for the purposes stated.

Notary Public, Betty Jo Jarvis

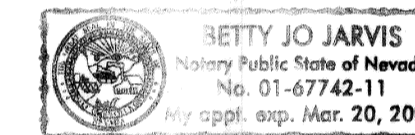

My Commission Expires March 20, 2009

MAP REFERENCES

Record of Survey, Boundary Line Adjustment, Plat Book B, Page 226 of Lincoln County, Nevada Records

Plat of Alamo Townsite, Plat Book A, Page 41 of Lincoln County, Nevada Records

Parcel Map, Plat Book C, Page

BASIS OF BEARINGS

The centerline of Main Street opposite Block 55 as given in Plat Book B, Page 226 to P-K nails in the street intersections with the bearing of S 01°23'00" E.

PLANNING COMMISSION

At the regular meeting of the Lincoln County Planning Commission held this 12 day of FEBRUARY, 2007, this map was examined and having been designated to represent the Lincoln County Commission, hereby does approve this map for recordation.

Shirley Zelt
Chairman attest
Clint Weitz 3-14-07



BASIS OF BEARINGS
N 01°23'00" W
577.54'

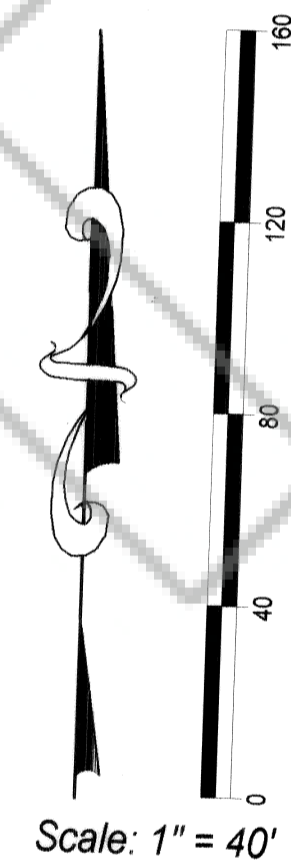

Scale: 1" = 40'

LEGEND

- Set #5 rebar & plastic cap stamped L SMITH PLS 12751
- ⊕ Found rebar & plastic cap stamped R HAFEN PLS 4428
- ⊙ Found P-K nail at street intersections
- Found P-K nail & stainless steel disk L SMITH PLS 12751
- Parcel boundary
- Block 55 street centerline
- N 00°00'00" E Line bearing Degrees-Minutes-Seconds

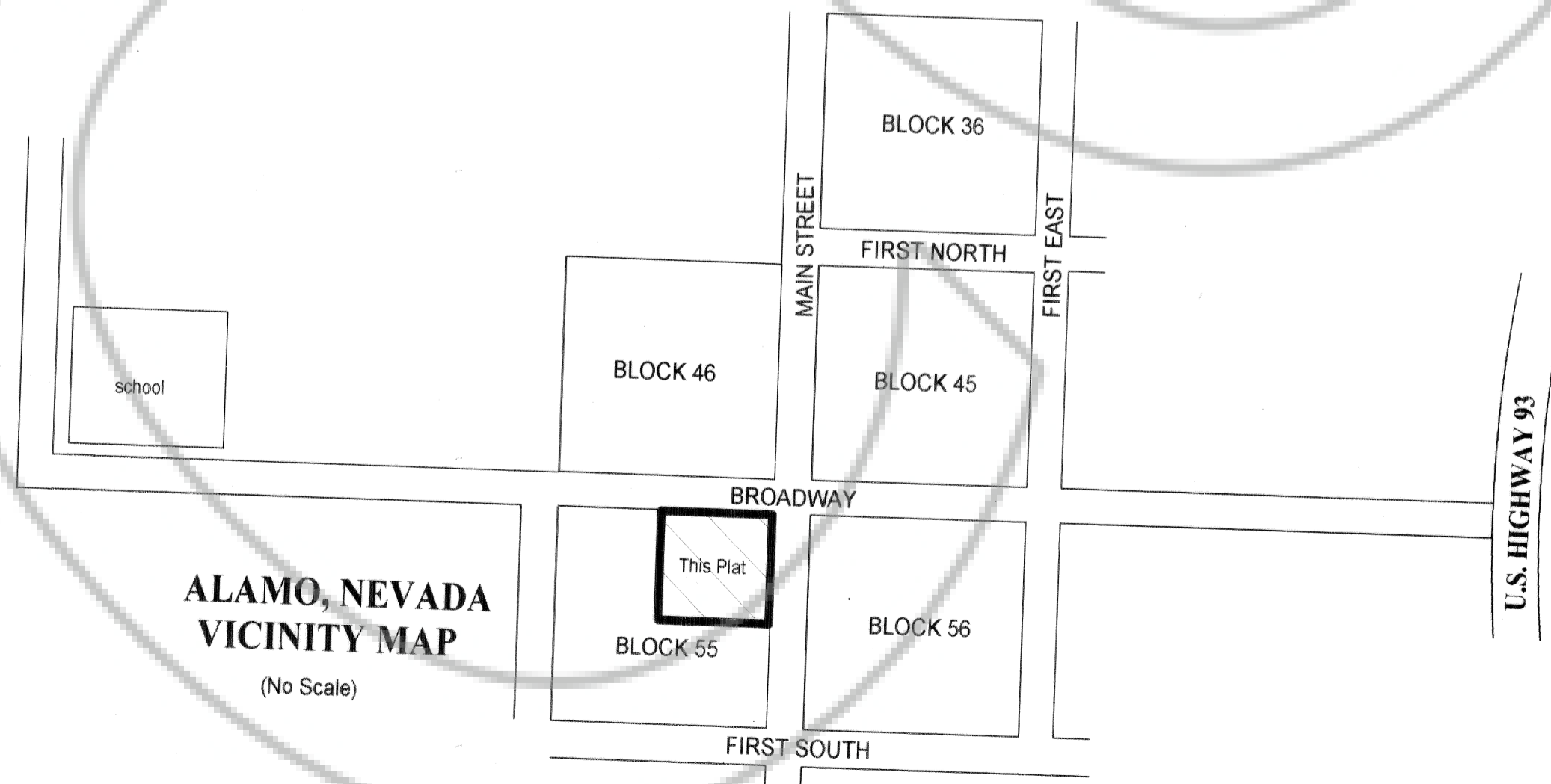

ALAMO, NEVADA
VICINITY MAP
(No Scale)

Lenard Smith
Land Survey
 509 Main Street
 P.O. Box 443
 Caliente, Nevada 89008
 Phone/Fax 775 726 3365
 Cell Phone 775 962 1196

RECORDER'S CERTIFICATE

DOC # 0128506
 03/14/2007 03:07 PM
 Official Record
 Recording Requested By
 LEONARD SMITH
 Lincoln County - NV
 Leslie Boucher - Recorder
 Fee \$21.00 Page 1 of 1
 89771 Recorded By: RE
 Book - C Page - 0319

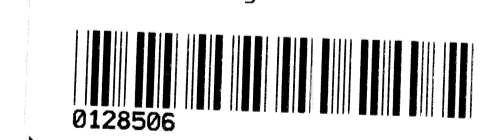

A.P.N. 004-062-07
 A.P.N. 004-062-08
 A.P.N. 004-062-14

Parcel Map

For Clark Maurice Hardy, Marian Louise Hardy, Clark Marion Hardy, Lorna Hardy, Robert D. Hansen, and Dee Ann Hansen

In Lot 1, Block 55 of the Alamo Townsite, Lincoln County, Nevada, Section 5, T.7 S., R.61 E., M.D.M.